

SECTION	COUNTY	TOTAL SHEETS	SHEET NO.
06-00052-00-LT	COOK	10	3
BUSSE RD. - STA. 1078+33 TO STA. 1089+30			
LIGHTING PLAN			

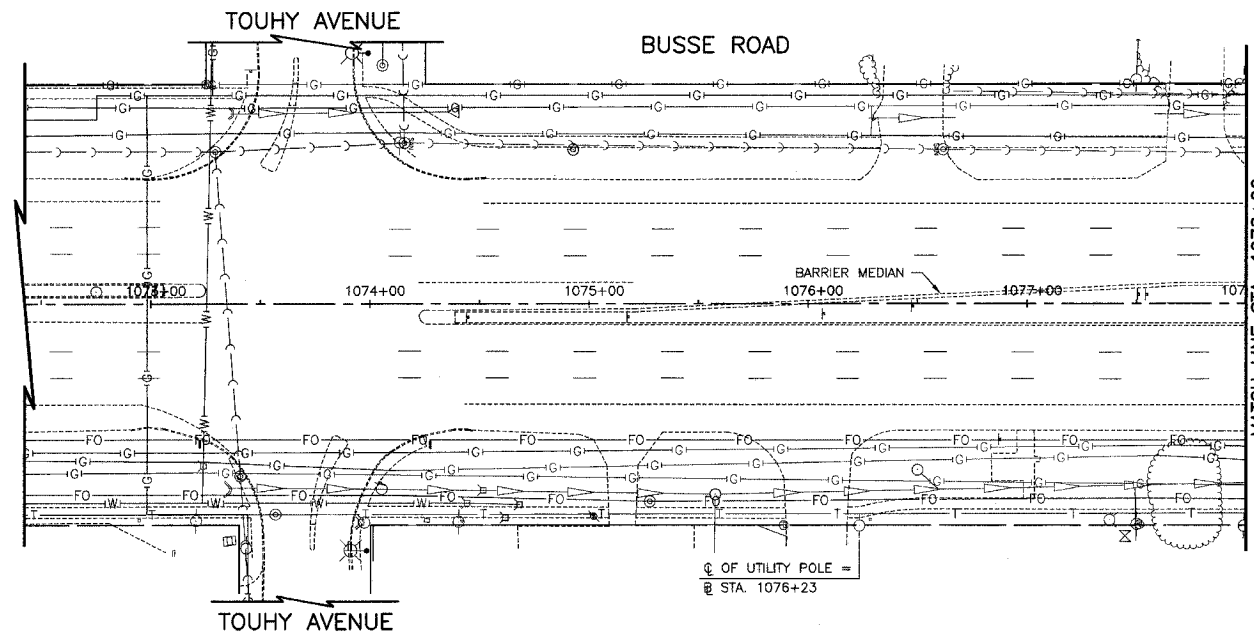

**BEGIN IMPROVEMENT
STA. 1078+33**

3 1/2" DIA. RACEWAY SHALL BE STUBBED AND END CAPPED FOR FUTURE EXTENSION. (MATERIAL AND INSTALLATION SHALL BE PART OF THE PAY ITEM FOR LIGHT POLE FOUNDATION)

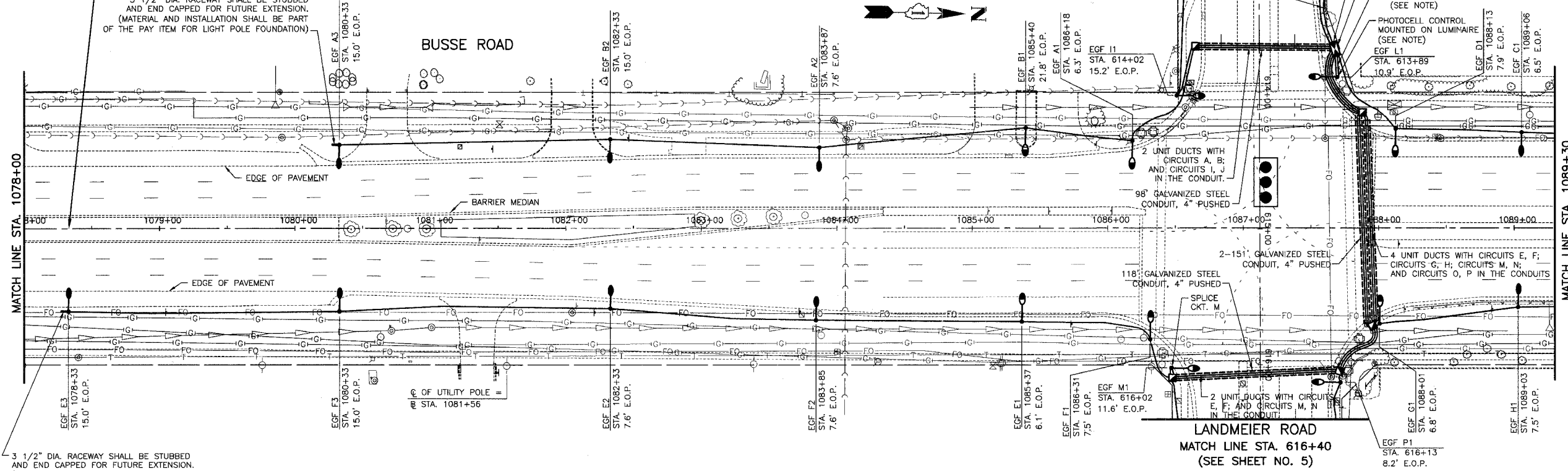

3 1/2" DIA. RACEWAY SHALL BE STUBBED AND END CAPPED FOR FUTURE EXTENSION. (MATERIAL AND INSTALLATION SHALL BE PART OF THE PAY ITEM FOR LIGHT POLE FOUNDATION)

NOTE:
ALL PHOTOCELL MATERIAL AND INSTALLATION SHALL BE PART OF THE PAY ITEM "LIGHTING CONTROLLER, SPECIAL".

REVISIONS	
NAME	DATE

ILLINOIS DEPARTMENT OF TRANSPORTATION
BUSSE ROAD (IL 83)
ROADWAY LIGHTING
LIGHTING PLAN
BUSSE ROAD
STA. 1078+33 TO STA. 1089+30

DATE: 07/10/2007
CHECKED BY: D.N.M.

SCALE IN FEET

