

# CONDUIT LAYOUT (FACILITIES REMOVED) SHOWING DUCT SECTION

F.A.U. RTE.	SECTION	COUNTY	TOTAL SHEETS	SHEET NO
1545	00-00115-00-BR	DUPAGE	97	72
STA. 1+31.77		TO STA. 5+50.00		
FED. ROAD DIST. NO.	ILLINOIS	FED. AID PROJECT		

CONTRACT 83961

### LEGEND

#### EXISTING

- E-POLE
- E-3-4/0 AAA PRI.
- E-ANCHOR & GUY ASSEMBLY
- E-SW. MOD., FUSE MOD.
- ▲ E-TRANSFORMER
- E-HANDHOLE
- E-1-1/0 STR. AL.
- E-3-4/0 STR. AL.
- E-3-1/0 STR. AL.
- E-DUCT BANK
- ⊙ E-TREES/BUSHES
- E-BOC/SIDEWALK

#### INSTALL

- UNDERGROUND
- I-SWITCH GEAR VAULT
- I-HANDHOLE
- I-DUCT BANK

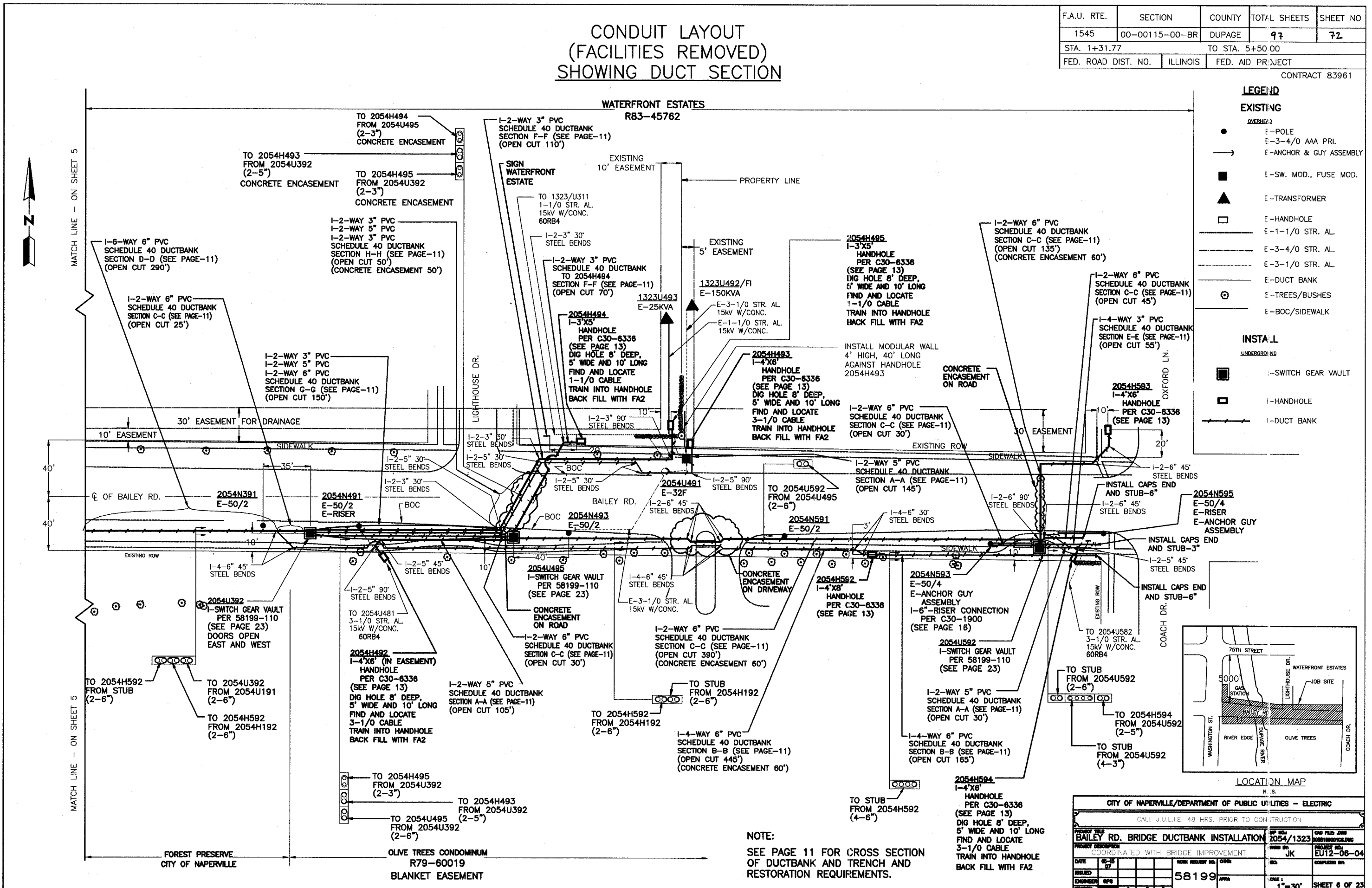

**NOTE:**  
SEE PAGE 11 FOR CROSS SECTION OF DUCTBANK AND TRENCH AND RESTORATION REQUIREMENTS.

CITY OF NAPERVILLE/DEPARTMENT OF PUBLIC UTILITIES - ELECTRIC			
CALL J.U.L.I.E. 48 HRS. PRIOR TO CONSTRUCTION			
PROJECT FILE NO.	PROJECT NO.	DATE	DATE
BAILEY RD. BRIDGE DUCTBANK INSTALLATION	2054/1323	06-15-07	07-15-07
PROJECT DESCRIPTION	OWNER	DESIGNER	DATE
COORDINATED WITH BRIDGE IMPROVEMENT	JK	RPS	07-15-07
DATE	WORK ORDER NO.	ISSUE	DATE
06-15-07	58199	07-15-07	07-15-07
ISSUED	BY	DATE	DATE
07-15-07	RPS	07-15-07	07-15-07
CHANGED	BY	DATE	DATE
07-15-07	RPS	07-15-07	07-15-07
REVISION	BY	DATE	DATE
07-15-07	RPS	07-15-07	07-15-07
SCALE: 1"=30'			SHEET 6 OF 23