

F.A.U. RTE.	SECTION	COUNTY	TOTAL SHEETS	SHEET NO.
3509	00-00173-00-FP	COOK	246	42
STA. 1004+42.60		TO STA. 1103+83.65		
FED. ROAD DIST. NO. 7		ILLINOIS		FED. AID PROJECT

- LEGEND**
- SIGN ON PORTABLE OR PERMANENT SUPPORT
 - ⊙ SIGN DESCRIPTION NUMBER
 - ⇄ TWO-WAY TRAFFIC FLOW
 - ⚡ FLASHING LIGHT (TYPE A)
 - DETOUR ROUTE
 - ▨ WORK AREA

PLOT DATE = 7/12/2007
 FILE NAME = g:\projects\83964\road\shades\DETDIR81.plt
 PLOT SCALE = 3/8"=1'-0"
 USER NAME = b.johnson

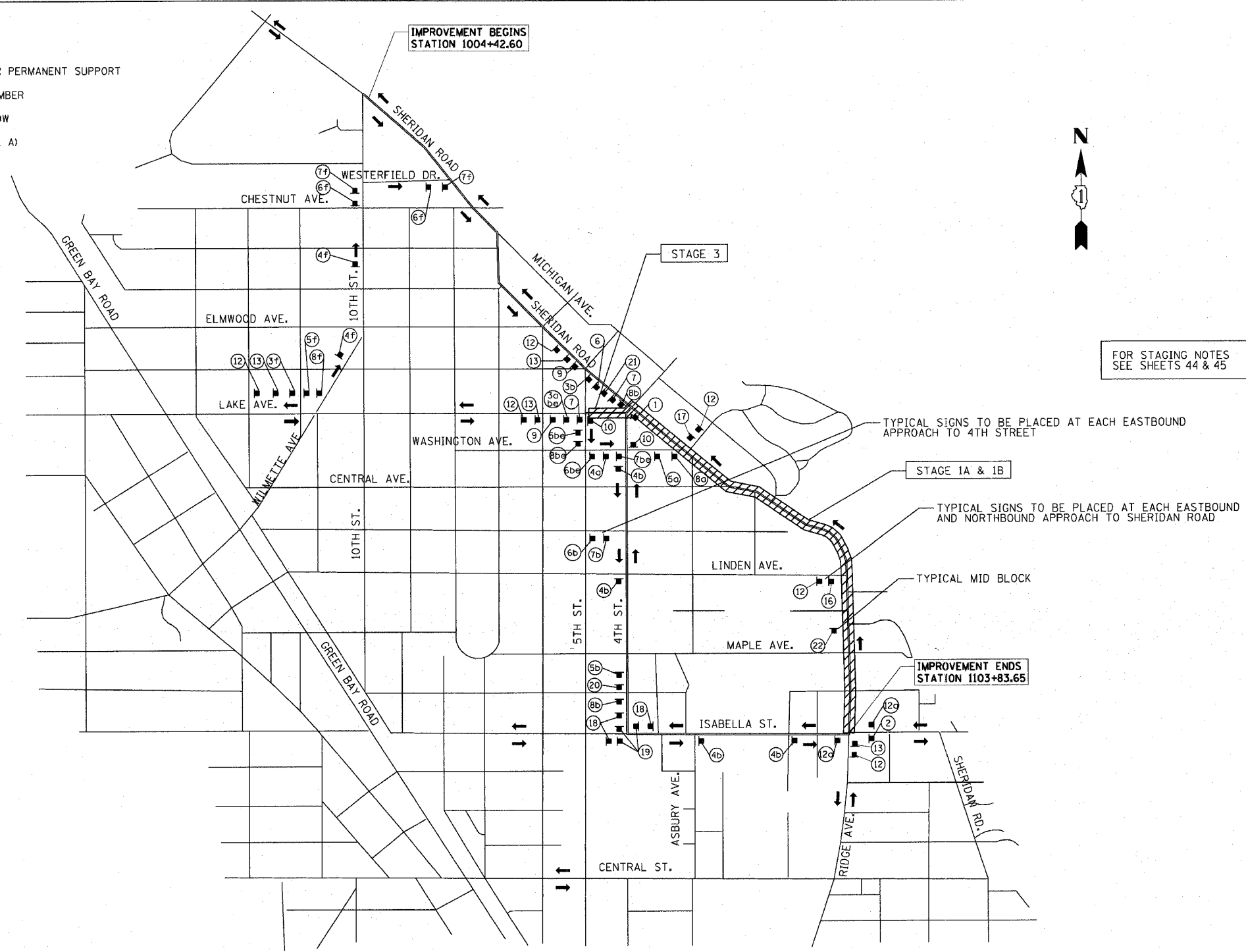

FOR STAGING NOTES SEE SHEETS 44 & 45

NOTES:

1. SEE STATE STANDARDS AND DETOUR PLANS FOR SIGNING AND BARRICADES ALONG SHERIDAN ROAD.
2. LOCAL ACCESS FOR ALL RESIDENTS AND BUSINESSES SHALL BE MAINTAINED AT ALL TIMES.
3. ALL DETOUR SIGNING AND TRAFFIC CONTROL DEVICES FOR ALL CONSTRUCTION STAGES SHALL BE INCLUDED IN THE CONTRACT LUMP SUM PRICE FOR TRAFFIC CONTROL AND PROTECTION.
4. DETOUR ROUTE FOR EASTBOUND LAKE AVE. USE WILMETTE AVE., 10TH ST. AND WESTERFIELD DR.
5. SIDEWALKS SHALL BE MAINTAINED AT ALL TIMES USING AGGREGATE FOR TEMPORARY ACCESS, TO BE PAID FOR AS "TEMPORARY ACCESS (SIDEWALK)".
6. BICYCLISTS ARE TO FOLLOW THE ROADWAY DETOUR. BICYCLE DETOUR SIGNS ARE TO BE PLACED AS SHOWN.
7. THE CITY OF EVANSTON AND VILLAGE OF WILMETTE ARE TO BE INVOLVED IN THE TIMING OF THE INSTALLATION AND REMOVAL OF THE TEMPORARY STOP SIGNS AT THE INTERSECTION OF 4TH ST. AND ISABELLA ST.

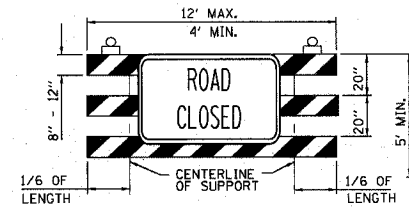

- ① ROAD CLOSED TO ALL TRAFFIC
 TYPE III BARRICADE
 STANDARD FLASHING
 (DOT HWY STD 702001)
 W/ R11-2 (48" x 30")

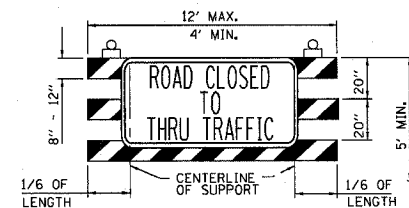

- ⑩ ROAD CLOSED TO THRU TRAFFIC
 TYPE III BARRICADE
 STANDARD FLASHING
 (DOT HWY STD 702001)
 W/ R11-4 (60" x 30")

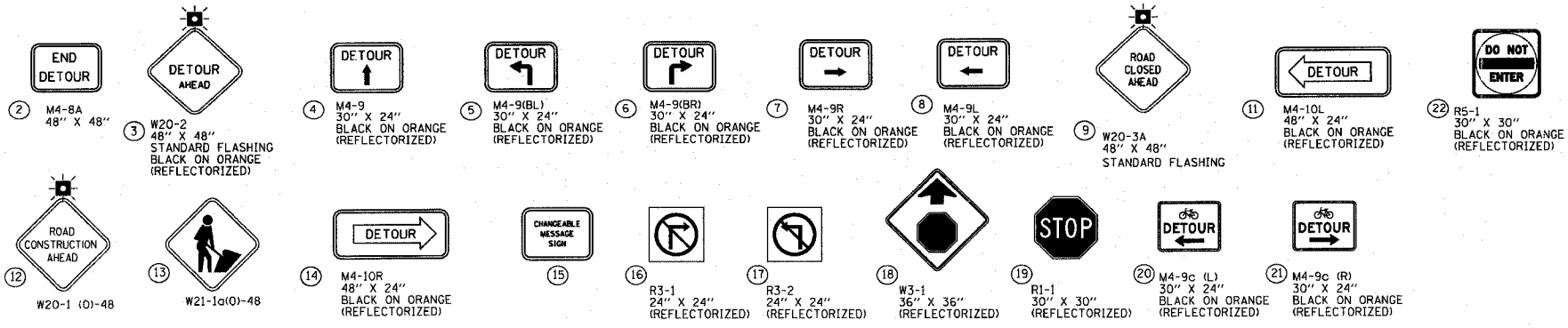

SHERIDAN RD. NORTHBOUND	ISABELLA ST. WESTBOUND	FOURTH ST. SOUTHBOUND	LAKE AVE. EASTBOUND
a. W17-1100 (2 EACH) 24" X 12" BLACK ON ORANGE (REFLECTORIZED)	c. W17-1100 (2 EACH) 24" X 12" BLACK ON ORANGE (REFLECTORIZED)	e. W17-1100 (2 EACH) 24" X 12" BLACK ON ORANGE (REFLECTORIZED)	f. W17-1100 (2 EACH) 24" X 12" BLACK ON ORANGE (REFLECTORIZED)
SHERIDAN RD. SOUTHBOUND	ISABELLA ST. EASTBOUND		
b. W17-1100 (2 EACH) 24" X 12" BLACK ON ORANGE (REFLECTORIZED)	d. W17-1100 (2 EACH) 24" X 12" BLACK ON ORANGE (REFLECTORIZED)		

REVISIONS	
NAME	DATE

ILLINOIS DEPARTMENT OF TRANSPORTATION

**DETOUR PLAN
CONSTRUCTION STAGE 1**

DATE 7/13/07
 DRAWN BY LTD
 CHECKED BY BJL