

F.A.U. RTE.	SECTION	COUNTY	TOTAL SHEETS	SHEET NO.
3509	00-00173-00-FP	COOK	246	43
STA. 1004+42.60		TO STA. 1103+83.65		
FED. ROAD DIST. NO. 7 ILLINOIS FED. AID PROJECT				

- LEGEND**
- SIGN ON PORTABLE OR PERMANENT SUPPORT
 - ⊙ SIGN DESCRIPTION NUMBER
 - ⇄ TWO-WAY TRAFFIC FLOW
 - ⚡ FLASHING LIGHT (TYPE A)
 - DETOUR ROUTE
 - ▨ WORK AREA

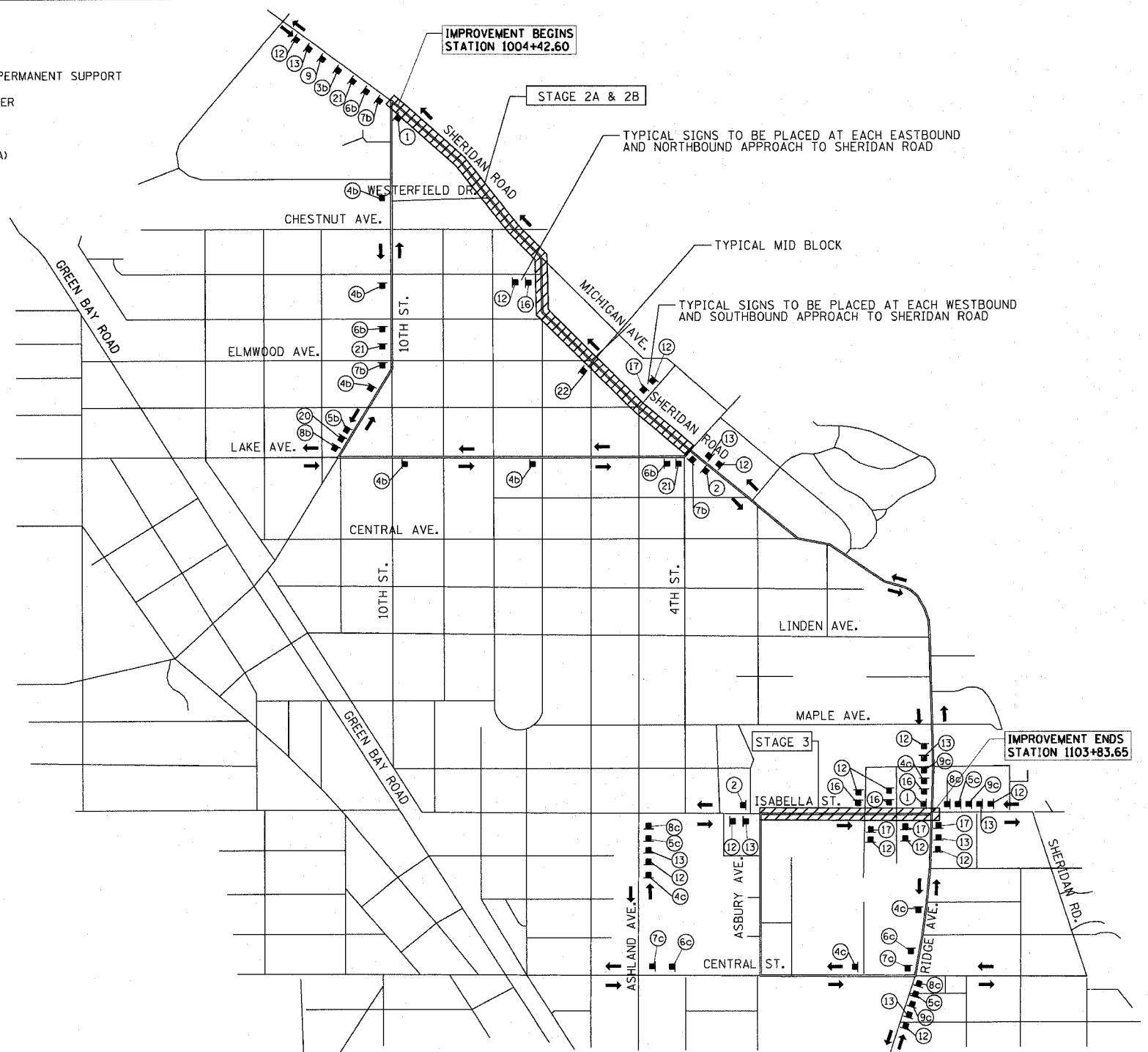

FOR STAGING NOTES
SEE SHEETS 44 & 45

- NOTES:**
- SEE STATE STANDARDS AND DETOUR PLANS FOR SIGNING AND BARRICADES ALONG SHERIDAN ROAD.
 - LOCAL ACCESS FOR ALL RESIDENTS AND BUSINESSES SHALL BE MAINTAINED AT ALL TIMES.
 - ALL DETOUR SIGNING AND TRAFFIC CONTROL DEVICES FOR ALL CONSTRUCTION STAGES SHALL BE INCLUDED IN THE CONTRACT LUMP SUM PRICE FOR TRAFFIC CONTROL AND PROTECTION.
 - DETOUR ROUTE FOR EASTBOUND LAKE AVE. USE WILMETTE AVE., 10TH ST. AND WESTERFIELD DR.
 - DETOUR ROUTE FOR WESTBOUND ISABELLA STREET SHALL USE RIDGE AVE., CENTRAL ST., AND ASHLAND AVE.
 - SIDEWALKS SHALL BE MAINTAINED AT ALL TIMES USING AGGREGATE FOR TEMPORARY ACCESS, TO BE PAID FOR AS "TEMPORARY ACCESS (SIDEWALK)".
 - BICYCLISTS ARE TO FOLLOW THE ROADWAY DETOUR. BICYCLE DETOUR SIGNS ARE TO BE PLACED AS SHOWN.
 - THE CITY OF EVANSTON AND VILLAGE OF WILMETTE ARE TO BE INVOLVED IN THE TIMING OF THE INSTALLATION AND REMOVAL OF THE TEMPORARY STOP SIGNS AT THE INTERSECTION OF 4TH ST. AND ISABELLA ST.

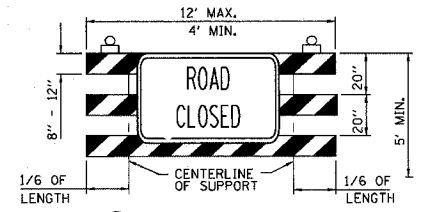

- ① ROAD CLOSED TO ALL TRAFFIC
TYPE III BARRICADE
STANDARD FLASHING
(DOT HWY STD 702001)
W/ R11-2 (48" x 30")

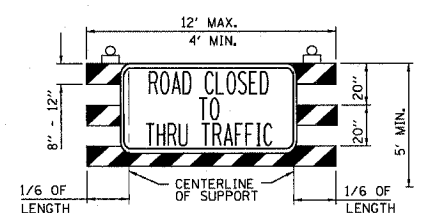

- ⑩ ROAD CLOSED TO THRU TRAFFIC
TYPE III BARRICADE
STANDARD FLASHING
(DOT HWY STD 702001)
W/ R11-4 (60" x 30")

- ② M4-8A 48" X 48" END DETOUR
- ③ W20-2 48" X 48" STANDARD FLASHING BLACK ON ORANGE (REFLECTORIZED)
- ④ M4-9 30" X 24" BLACK ON ORANGE (REFLECTORIZED)
- ⑤ M4-9(BL) 30" X 24" BLACK ON ORANGE (REFLECTORIZED)
- ⑥ M4-9(BR) 30" X 24" BLACK ON ORANGE (REFLECTORIZED)
- ⑦ M4-9R 30" X 24" BLACK ON ORANGE (REFLECTORIZED)
- ⑧ M4-9L 30" X 24" BLACK ON ORANGE (REFLECTORIZED)
- ⑨ W20-3A 48" X 48" STANDARD FLASHING
- ⑩ M4-10L 48" X 24" BLACK ON ORANGE (REFLECTORIZED)
- ⑪ R5-1 30" X 30" BLACK ON ORANGE (REFLECTORIZED)
- ⑫ W20-1 (O)-48 ROAD CONSTRUCTION AHEAD
- ⑬ W21-1a(O)-48 ROAD CONSTRUCTION AHEAD
- ⑭ M4-10R 48" X 24" BLACK ON ORANGE (REFLECTORIZED)
- ⑮ CHANGEABLE MESSAGE SIGN
- ⑯ R3-1 24" X 24" (REFLECTORIZED)
- ⑰ R3-2 24" X 24" (REFLECTORIZED)
- ⑱ W3-1 36" X 36" (REFLECTORIZED)
- ⑲ R1-1 30" X 30" (REFLECTORIZED)
- ⑳ M4-9c (L) 30" X 24" BLACK ON ORANGE (REFLECTORIZED)
- ㉑ M4-9c (R) 30" X 24" BLACK ON ORANGE (REFLECTORIZED)

- SHERIDAN RD. NORTHBOUND: a. W17-1100 (2 EACH) 24" X 12" BLACK ON ORANGE (REFLECTORIZED)
- SHERIDAN RD. SOUTHBOUND: b. W17-1100 (2 EACH) 24" X 12" BLACK ON ORANGE (REFLECTORIZED)
- ISABELLA ST. WESTBOUND: c. W17-1100 (2 EACH) 24" X 12" BLACK ON ORANGE (REFLECTORIZED)
- ISABELLA ST. EASTBOUND: d. W17-1100 (2 EACH) 24" X 12" BLACK ON ORANGE (REFLECTORIZED)
- FOURTH ST. SOUTHBOUND: e. W17-1100 (2 EACH) 24" X 12" BLACK ON ORANGE (REFLECTORIZED)

REVISIONS	
NAME	DATE

ILLINOIS DEPARTMENT OF TRANSPORTATION

**DETOUR PLAN
CONSTRUCTION STAGE 2**

DATE 7/12/2007
DRAWN BY LTD
CHECKED BY BJL

PLOT DATE = 7/12/2007
 PLOT SCALE = 3/8" = 1'-0"
 USER NAME = bjohean

1051 PERIMETER DRIVE, SUITE 1025
 SHALIMBURG, ILLINOIS 60173
 (847) 605-9800

