

F.A.U. RTE.	SECTION	COUNTY	TOTAL SHEETS	SHEET NO.
3509	00-00173-00-FF	COOK	246	44
STA.		TO STA.		
FED. ROAD DIST. NO. 7 ILLINOIS FED. AID PROJECT				

PLOT DATE = 7/12/2007
 PLOT SCALE = 1/8" = 1'-0"
 USER NAME = byholman

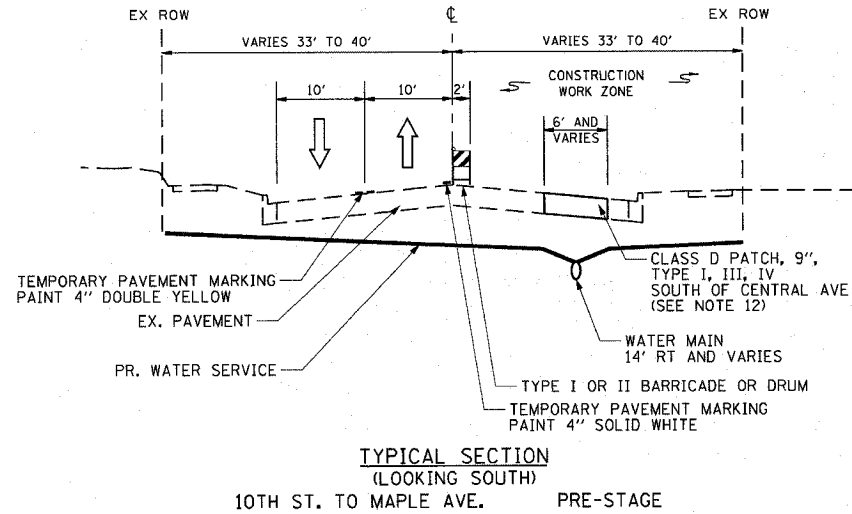

TYPICAL SECTION
(LOOKING SOUTH)
10TH ST. TO MAPLE AVE. PRE-STAGE

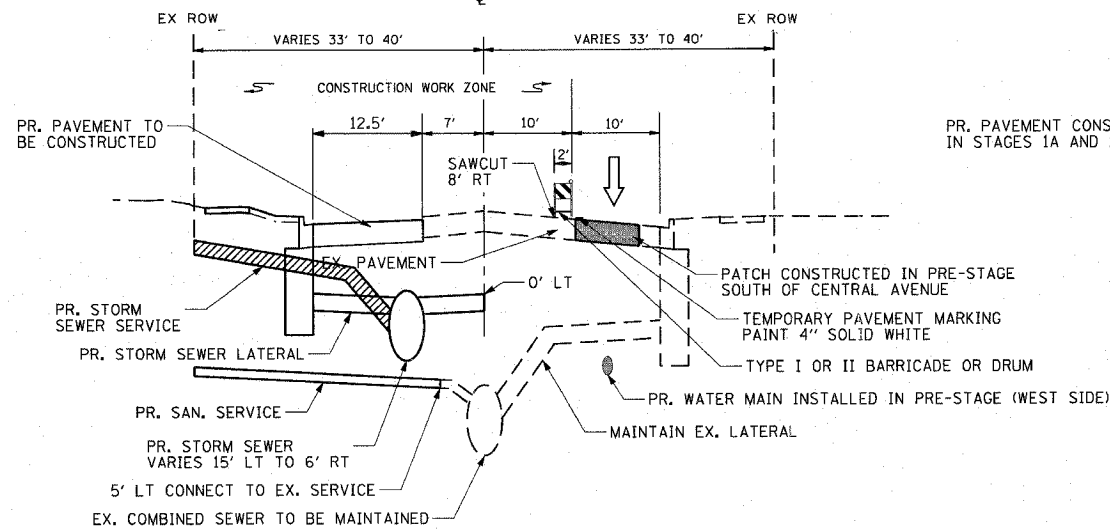

TYPICAL SECTION
(LOOKING SOUTH)
CENTRAL AVE. TO ISABELLA ST. OPPOSITE HAND
LAKE AVE. TO CENTRAL AVE. 10TH ST. TO LAKE AVE

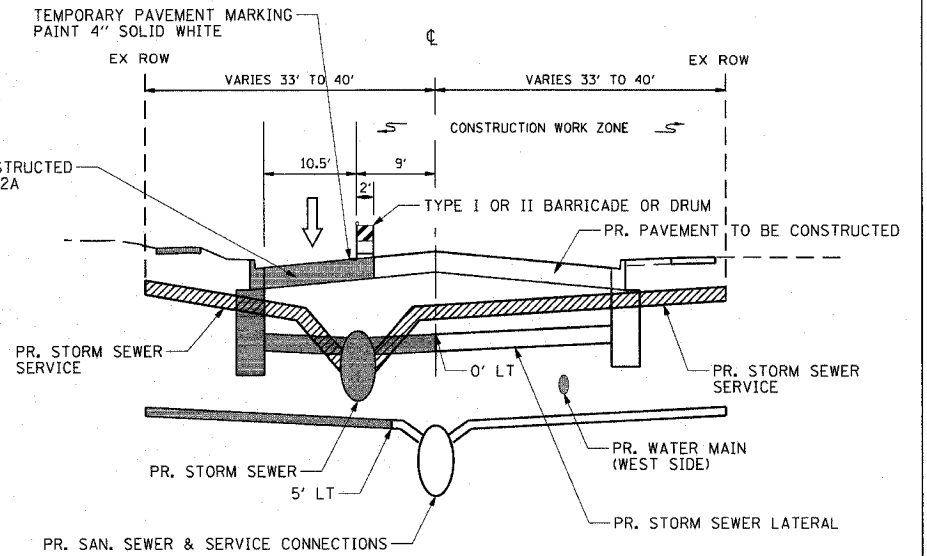

TYPICAL SECTION
(LOOKING SOUTH)
CENTRAL AVE. TO ISABELLA ST. OPPOSITE HAND
LAKE AVE. TO CENTRAL AVE. 10TH ST. TO LAKE AVE

SUGGESTED CONSTRUCTION STAGING:

PRE-STAGE: WATERMAIN, RETAINING WALL & SEWER OUTFALLS

- CONSTRUCT SEWER OUTFALLS AT NORTH SHORE CHANNEL ADJACENT TO SHERIDAN RD. MAINTAINING EXISTING TRAFFIC PATTERN.
- ESTABLISH TWO-WAY TRAFFIC ON EAST SIDE OF SHERIDAN RD. THE FOLLOWING OPERATIONS TO BE PERFORMED ALONG THE WEST HALF OF SHERIDAN RD.:
 - CONSTRUCT PROPOSED WATER MAIN AS SHOWN IN PLANS.
 - INSTALL WATER SERVICE CONNECTIONS, BOTH SIDES OF SHERIDAN RD.
 - WATER SERVICE CONNECTIONS TO BE INSTALLED BY METHOD OF BORING.
 - CONSTRUCT PAVEMENT PATCHING SOUTH OF CENTRAL AVE.
 - CONSTRUCT PROPOSED RETAINING WALL ALONG WEST SIDE OF SHERIDAN RD. AS SHOWN ON PLANS.
- DETERMINE ELEVATION OF EXISTING WEST SIDE SANITARY SERVICES BETWEEN STA. 1017+50 TO STA. 1026+50 AND EAST SIDE SANITARY SERVICES BETWEEN STA. 1084+00 TO STA. 1094+00. PAID FOR AS EXPLORATION TRENCH AT EACH SERVICE.

**STAGE 1A: ISABELLA ST. TO CENTRAL AVE., EAST SIDE
CENTRAL AVE. TO LAKE AVE., WEST SIDE**

- INSTALL DETOUR PER PLAN DETAILS AND CLOSE SHERIDAN RD. TO SOUTHBOUND TRAFFIC WITHIN LIMITS SPECIFIED. SOUTHBOUND TRAFFIC SHALL BE TRANSITIONED FROM TWO LANES TO ONE BETWEEN 5TH ST. AND LAKE AVE. INSTALL TEMPORARY TRAFFIC SIGNALS AND ESTABLISH ONE-WAY NORTHBOUND TRAFFIC ON WEST SIDE OF SHERIDAN RD. BETWEEN ISABELLA ST. AND CENTRAL AVE., AND ON THE EAST SIDE OF SHERIDAN ROAD BETWEEN CENTRAL AVE. AND LAKE AVE. FOLLOW STANDARDS 701501-03, 701502-01, AND 701701-04 FOR STAGING TRANSITIONS AND SIGN SPACING.
- INSTALL DETOUR FOR LAKE AVE. PER PLAN DETAILS AND CLOSE LAKE AVE. TO EASTBOUND TRAFFIC FROM 5TH ST. TO SHERIDAN RD. ESTABLISH ONE-WAY WESTBOUND TRAFFIC ON NORTH SIDE OF LAKE AVE.
- INSTALL TEMPORARY ALL-WAY STOP AT THE INTERSECTION OF 4TH ST. AND ISABELLA ST.
- THE FOLLOWING OPERATIONS TO BE PERFORMED ALONG SHERIDAN RD.
 - REMOVE EXISTING PAVEMENT AND CURB & GUTTER.
 - PERFORM NECESSARY UTILITY ADJUSTMENTS.
 - CONSTRUCT MAINLINE STORM SEWER AND MANHOLES.
 - CONSTRUCT LATERALS WITH DRAINAGE STRUCTURES, AND LATERALS FOR OTHER SIDE OF ROADWAY TO CENTERLINE.
 - MAINTAIN OPPOSITE SIDE DRAINAGE TO EXISTING COMBINED SEWER.
 - CONSTRUCT SANITARY SERVICE CONNECTIONS FROM R.O.W. TO 5' OF EX COMBINED SEWER BY METHOD OF BORING AT TREE LOCATIONS, CONNECT TO EXISTING.
 - INSTALL CONDUIT AND FOUNDATIONS FOR PERMANENT TRAFFIC SIGNALS.
 - CONSTRUCT AGGREGATE BASE, CONCRETE CURB & GUTTER, PCC BASE COURSE AND HMA BINDER COURSE (12.5' PAVED WIDTH).
 - CONSTRUCT SW QUADRANT OF SHERIDAN RD./LAKE AVE. INTERSECTION. (SEE SUBSTAGE 1A)
 - CONSTRUCT NW QUADRANT OF SHERIDAN RD./LAKE AVE. INTERSECTION. (SEE SUBSTAGE 1A)
 - PLACE TEMPORARY EROSION CONTROL SEEDING ON THE CONSTRUCTION SIDE OF THE ROADWAY.

SUB-STAGE 1A: LAKE AVENUE

- SHIFT NORTHBOUND TRAFFIC WEST OF THE CENTERLINE TO CONSTRUCT PAVEMENT AT SOUTHEAST AND NORTHEAST QUADRANTS OF THE LAKE AVE. INTERSECTION

**STAGE 1B: ISABELLA ST. TO CENTRAL AVE., WEST SIDE
CENTRAL AVE. TO LAKE AVE., EAST SIDE**

- ESTABLISH ONE-WAY NORTHBOUND TRAFFIC ON EAST SIDE OF SHERIDAN RD. BETWEEN ISABELLA ST. AND CENTRAL AVE., AND ON THE WEST SIDE OF SHERIDAN ROAD BETWEEN CENTRAL AVE. AND LAKE AVE. FOLLOW STANDARDS 701501-03, 701502-01, AND 701701-04 FOR STAGING TRANSITIONS AND SIGN SPACING.
- MAINTAIN DETOUR FOR LAKE AVE. ESTABLISHED IN STAGE A. MAINTAIN ONE-WAY WESTBOUND TRAFFIC ON NORTH SIDE OF LAKE AVE.
- THE FOLLOWING OPERATIONS TO BE PERFORMED ALONG SHERIDAN RD.:
 - REMOVE EXISTING PAVEMENT AND CURB & GUTTER.
 - PERFORM NECESSARY UTILITY ADJUSTMENTS.
 - REMOVE EXISTING COMBINED SEWER AND CONSTRUCT PROPOSED SANITARY MAINLINE.
 - COMPLETE SANITARY SEWER CONNECTIONS BOTH SIDES, USING METHOD OF BORING AT TREE LOCATIONS.
 - CONSTRUCT STORM SEWER LATERALS AND INSTALL DRAINAGE STRUCTURES.
 - INSTALL CONDUIT AND FOUNDATIONS FOR PERMANENT TRAFFIC SIGNALS.
 - CONSTRUCT AGGREGATE BASE, CONCRETE CURB & GUTTER, PCC BASE COURSE AND HMA BINDER COURSE.
 - OPEN LAKE AVE. TO TWO-WAY TRAFFIC.
 - INSTALL PERMANENT TRAFFIC SIGNALS
 - PLACE TEMPORARY EROSION CONTROL SEEDING ON THE CONSTRUCTION SIDE OF THE ROADWAY.
 - OPEN SHERIDAN RD. TO TWO-WAY TRAFFIC WITHIN LIMITS SPECIFIED.
 - REMOVE TEMPORARY ALL-WAY STOP AT THE INTERSECTION OF 4TH ST. AND ISABELLA ST.

STAGE 1A
STAGE 1A
STAGE 2A

GENERAL NOTES:

- STAGING PROCEDURES PRESENTED ARE THE SUGGESTED SEQUENCE OF OPERATIONS. THE CONTRACTOR MAY SUBMIT AN ALTERNATIVE STAGING PROPOSAL TO THE ENGINEER FOR HIS APPROVAL. THE CONTRACTOR SHALL NOT BE ENTITLED TO ADDITIONAL COMPENSATION FOR HIS CHANGE IN STAGING. NOTE THAT ONLY CERTAIN SECTIONS OF SHERIDAN ROAD MAY BE CLOSED AT ONE TIME AND ONE WAY TRAFFIC WILL NOT BE ALLOWED BETWEEN NOVEMBER 19, 2007 AND MARCH 14, 2008. FOR COMPLETION AND INTERIM COMPLETION DATES, SEE THE SPECIAL PROVISIONS
- INGRESS AND EGRESS TO DRIVEWAYS AND SIDE STREETS SHALL BE MAINTAINED AS SHOWN ON THE PLANS AND/OR AS DIRECTED BY THE ENGINEER. ACCESS TO ALL RESIDENTS AND BUSINESSES MUST BE MAINTAINED AT ALL TIMES. DRIVEWAY CONSTRUCTION WORK SHALL BE STAGED TO ALLOW ACCESS. ENTRANCE SIGNS SHALL BE INCLUDED IN THE COST OF TRAFFIC CONTROL AND PROTECTION.
- THE CONTRACTOR SHALL MAINTAIN TRAFFIC IN ACCORDANCE WITH THE SPECIAL PROVISIONS, STATE STANDARDS, STANDARD SPECIFICATIONS, AND AS DIRECTED BY THE ENGINEER.
- THE ENGINEER SHALL BE INFORMED 48 HOURS IN ADVANCE OF ANY CHANGE IN CONSTRUCTION STAGING.
- CITY OF EVANSTON ORDINANCES RESTRICT CONSTRUCTION TO BETWEEN 7:00 A.M. AND 7:00 P.M., MONDAY THROUGH SATURDAY. THE CLOSURE OF ONE THROUGH TRAFFIC LANE FOR ANY REASON DIFFERENT THAN WHAT IS SHOWN ON THE SUGGESTED STAGES OF CONSTRUCTION AND TRAFFIC CONTROL PLANS SHALL BE RESTRICTED TO THE WEEKDAY HOURS OF 9:00 A.M. TO 3:30 P.M. AND BE APPROVED BY THE ENGINEER. ANY VIOLATION OF THESE REQUIREMENTS SHALL BE CONSIDERED A TRAFFIC CONTROL DEFICIENCY ACCORDING TO THE SPECIAL PROVISIONS.
- THE CONTRACTOR SHALL BE REQUIRED TO REMOVE ALL EXISTING PAVEMENT MARKINGS WHICH CONFLICT WITH THE DESIGNATED TRAFFIC CONTROL PLAN. THIS WORK SHALL BE PAID FOR AS PAVEMENT MARKING REMOVAL OR WORK ZONE PAVEMENT MARKING REMOVAL.
- ALL TEMPORARY PAVEMENT MARKINGS SHOWING DETERIORATION SHALL BE REPLACED BY THE CONTRACTOR AS DIRECTED BY THE ENGINEER. THE CONTRACTOR SHALL ONLY BE PAID FOR THE FIRST TWO APPLICATIONS OF TEMPORARY PAVEMENT MARKINGS AND NOT FOR REPLACEMENT OF ANY MARKINGS REQUIRED WITHIN THE FIRST SEVEN DAYS AFTER PLACEMENT. ALL MARKINGS REQUIRING REPLACEMENT AFTER THE SECOND PLACEMENT SHALL BE REPLACED BY THE CONTRACTOR AT HIS OWN EXPENSE.
- THE FURNISHING, INSTALLING, AND RELOCATION OF ALL TRAFFIC SIGNS SHALL BE IN ACCORDANCE WITH THE MANUAL ON UNIFORM TRAFFIC CONTROL DEVICES AND THE STANDARD SPECIFICATIONS. THIS WORK SHALL BE INCLUDED IN THE COST FOR TRAFFIC CONTROL AND PROTECTION. ALL CONFLICTING TRAFFIC SIGNS SHALL BE COVERED AS DIRECTED BY THE ENGINEER. THIS WORK SHALL BE INCLUDED IN THE COST OF TRAFFIC CONTROL AND PROTECTION.
- ALL UNBALLASTED TYPE I AND II BARRICADES SHALL HAVE TWO (2) SANDBAGS ON THE BOTTOM RAIL. ALL TYPE III BARRICADES SHALL REQUIRE A MINIMUM OF FOUR (4) SANDBAGS PER BARRICADE.
- THE CONTRACTOR SHALL BE RESPONSIBLE FOR ENSURING DRAINAGE OF THE ROADWAY DURING ALL STAGES OF CONSTRUCTION. THIS INCLUDES ADJUSTING THE EXISTING DRAINAGE STRUCTURE FRAMES DURING STAGE I LOCATED ALONG THE EDGE OF PAVEMENT. A QUANTITY OF 6 INLETS, TYPE A, SPECIAL, TYPE I FRAME, OPEN LID, AND 200 FT OF 12 INCH STORM SEWER HAVE BEEN PROVIDED FOR TEMPORARY USE. EXISTING DRAINAGE STRUCTURES, AS NOTED ON THE TRAFFIC CONTROL SHEETS, WILL ALSO REQUIRE MODIFICATIONS TO BE USED FOR TEMPORARY DRAINAGE. REMOVAL OF THESE ITEMS, AS NECESSARY, WILL BE CONSIDERED INCLUDED IN THE COST OF INSTALLATION. THE CONTRACTOR MAY SALVAGE ALL OF THESE REMOVED TEMPORARY ITEMS AND, WITH APPROVAL OF THE ENGINEER, THEY MAY BE USED ELSEWHERE ON THE PROJECT.
- "WORKERS" (W21-1A) SIGNS SHALL ONLY BE ERECTED WHEN WORKERS WILL BE PRESENT.
- CLASS D PATCHES, TYPE I & III SHALL BE DETERMINED IN THE FIELD. TYPE IV PATCH SHALL BE 5' WIDE AND SHALL BE FROM STATION 1065+00 TO STATION 1098+50 WITH OMISSION AT BRIDGE.

REVISIONS	
NAME	DATE

ILLINOIS DEPARTMENT OF TRANSPORTATION
SUGGESTED CONSTRUCTION PROCEDURE AND MAINTENANCE OF TRAFFIC TYPICAL SECTIONS AND NOTES
 SHERIDAN ROAD
 DATE 7/13/07
 DRAWN BY LTD
 CHECKED BY B.JL
 NO SCALE

