

F.A.J. RTE.	SECTION	COUNTY	TOTAL SHEETS	SHEET NO.
3509	00-00173-00-FP	COOK	246	58
STA. 1071+00		TO STA. 1077+50		
FED. ROAD DIST. NO. 7 ILLINOIS FED. AID PROJECT				

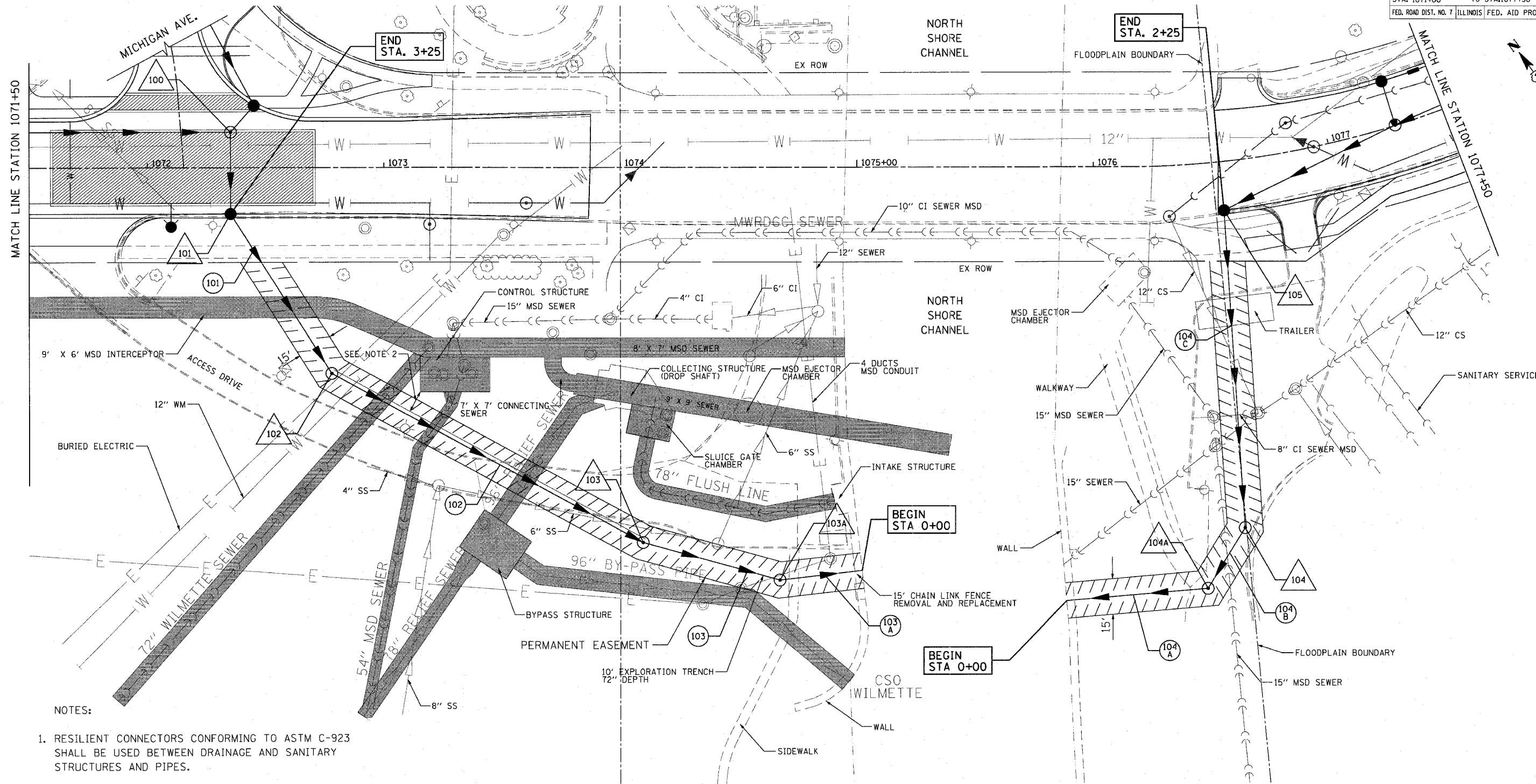

NOTES:

- RESILIENT CONNECTORS CONFORMING TO ASTM C-923 SHALL BE USED BETWEEN DRAINAGE AND SANITARY STRUCTURES AND PIPES.
- MAINTAIN MINIMUM HORIZONTAL SEPARATION OF 10 FEET BETWEEN OUTSIDE OF MWRD STRUCTURES AND OUTSIDE OF PROPOSED SEWER FACILITIES.

FOR PROFILE SEE SHEET 72

SCHEDULE OF STORM SEWER STRUCTURES

STRUCTURE NUMBER	STATION	OFFSET (FT)	TYPE	FRAME & GRATE	RIM ELEVATION	INVERT								
						NORTH	NE	EAST	SE	SOUTH	SW	WEST	NW	
102	1072+77.8	87.2'	RT	MH TA 5 DIA	T1 F. CL	598.32	577.08			577.08				
103	1074+09.5	159.1'	RT	MH TA 5 DIA	T1 F. CL	588.54			576.65				576.65	
103A	1074+67.4	174.9'	RT	MH TA 7 DIA	T1 F. CL	586.87			575.48				576.48	
104A	1076+37.4	179.8'	RT	MH TA 6 DIA, DROP	T1 F. CL	600.75		591.13					580.07	
104	1076+49.6	155.5'	RT	MH TA 5 DIA	T1 F. CL	601.45		591.35			591.25			

SCHEDULE OF STORM SEWER PIPES

PIPE NUMBER	ITEM	CLASS	TYPE	SIZE	LENGTH (FT)	SLOPE	TBF (CU YD)
101	SS - JACKED IN PLACE	A	4	42"	75.0	0.30%	129
102	SS - JACKED IN PLACE	A	3	42"	145.0	0.30%	0
103	SS	A	2	42"	55.0	0.30%	0
103A	SS	A	2	54"	32.5	0.06%	0
104A	SS	A	2	36"	57.5	0.13%	15
104B	SS	A	2	30"	25.0	0.50%	11
104C	SS - JACKED IN PLACE	A	2	30"	130.0	0.50%	23

REVISIONS	
NAME	DATE

ILLINOIS DEPARTMENT OF TRANSPORTATION
DRAINAGE & UTILITY PLAN
 SHERIDAN ROAD
 NORTH CHANNEL OUTFALL

DATE 7/13/07
 DRAWN BY LTD
 CHECKED BY BJL

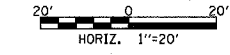

PLOT DATE = 7/12/2007
 FILE NAME = S:\projects\83964\road\sherdan.dwg
 USER NAME = EJP
 DATE = 7/13/07

1081 PERIMETER DRIVE, SUITE 1025
 SCHAMBERG, ILLINOIS 60173
 (847) 905-9800

