

F.A.U. RTE.	SECTION	COUNTY	TOTAL SHEETS	SHEET NO.
3509	00-00173-00-FF	COOK	246	59
STA. 1076+00		TO STA. 1086+00		
FED. ROAD DIST. NO. 7 ILLINOIS FED. AID PROJECT				

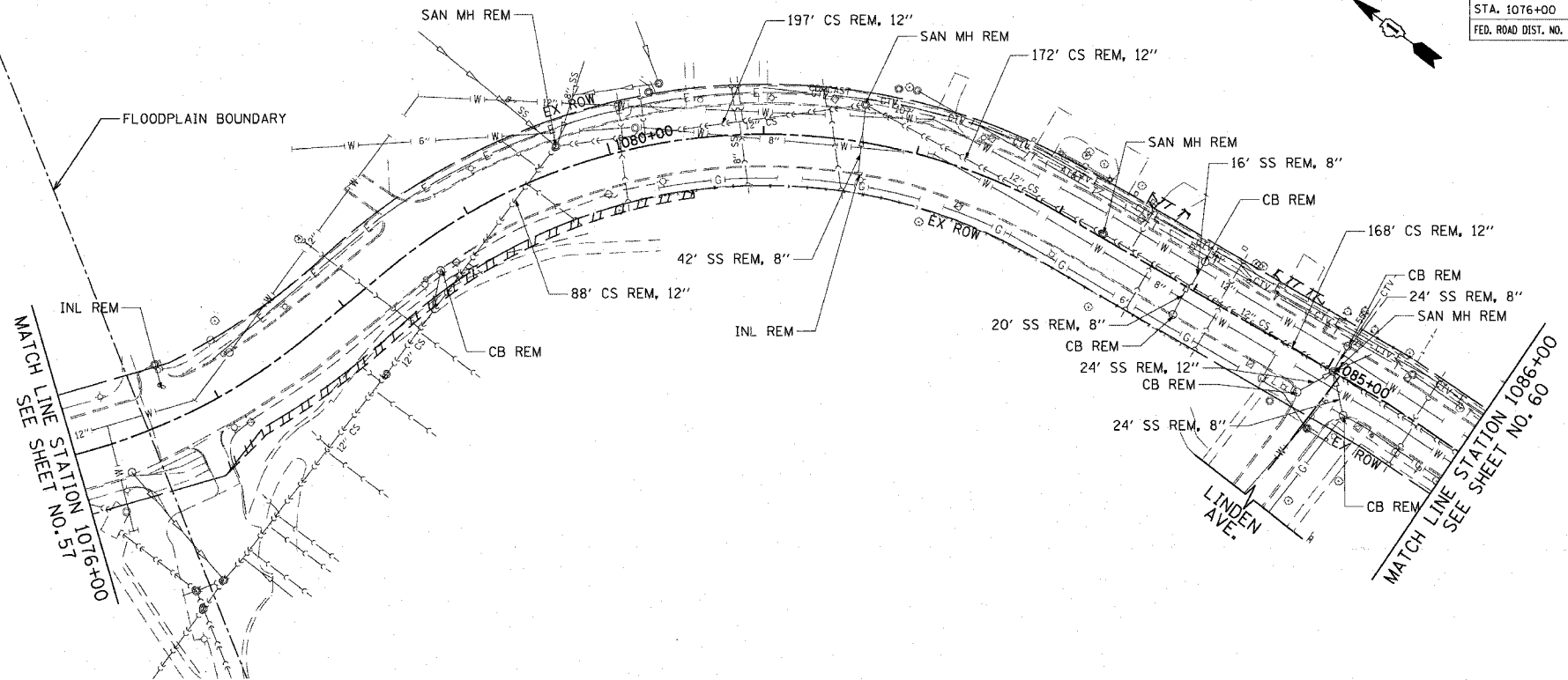

SCHEDULE OF STORM SEWER STRUCTURES

STRUCTURE NUMBER	STATION	OFFSET (FT)	TYPE	FRAME & GRATE	RIM ELEVATION	INVERT								
						NORTH	NE	EAST	SE	SOUTH	SW	WEST	NW	
105	1076+53.2	20.6'	RT	CB TA 5 DIA	T23 F & G	603.55			596.01			592.00		
106A	1077+44.4	19.5'	LT	INLET TA	T23 F & G	602.55								598.90
106	1077+29.4	19.5'	LT	CB TA 4 DIA	T23 F & G	602.54					598.79		598.79	
107	1077+29.4	0.2'	LT	MH TA 5 DIA	T1 F, CL	602.93		598.62	596.69				596.39	
108	1078+30.0	3.2'	LT	MH TA 5 DIA	T1 F, CL	602.97			597.47		598.82		597.17	
109	1078+30.0	19.5'	RT	CB TYPE C	T23 F & G	602.77	599.02						599.02	
109A	1078+15.0	19.5'	RT	INLET TA	T23 F & G	602.78			599.13					
110	1079+35.0	17.0'	LT	MH TA 5 DIA	T1 F, CL	604.57			599.00				597.99	
111	1080+44.0	2.5'	RT	MH TA 5 DIA	T1 F, CL	606.64			600.37		602.41		600.07	
112	1080+44.0	19.5'	RT	CB TYPE C	T23 F & G	606.30		602.55						
113	1081+50.0	5.5'	LT	MH TA 5 DIA	T1 F, CL	609.29			603.00				601.39	
114	1083+15.0	19.5'	LT	CB TYPE C	T23 F & G	612.77						609.02		
115	1083+15.0	12.0'	LT	MH TA 5 DIA	T1 F, CL	612.78			608.97		604.60		608.37	604.30
116	1083+15.0	19.5'	RT	CB TYPE C	T23 F & G	612.41			608.66					
117	1085+44.0	19.5'	LT	CB TYPE C	T23 F & G	614.33						610.58		
118	1085+44.0	12.1'	LT	MH TA 5 DIA	T1 F, CL	614.48	605.49		610.53		605.79		610.30	
119	1085+45.4	19.5'	RT	CB TYPE C	T23 F & G	614.34			610.59					

EXISTING

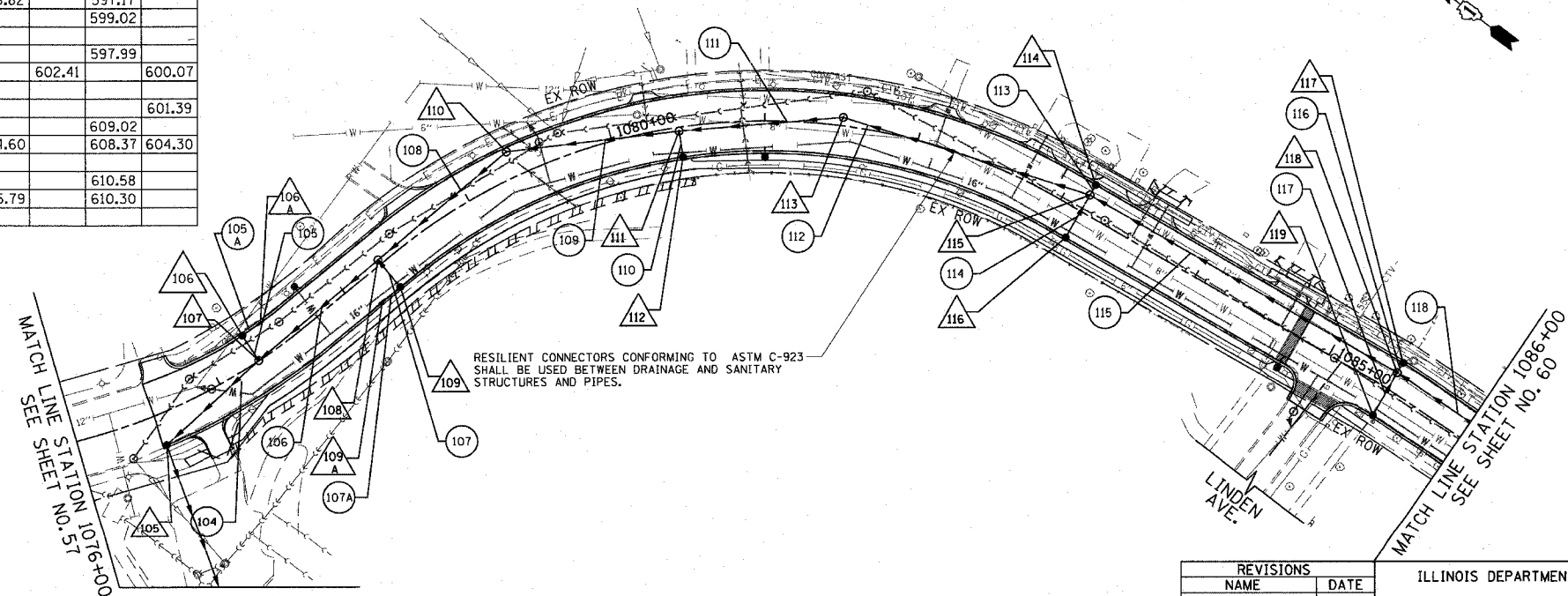

SCHEDULE OF STORM SEWER PIPES

PIPE NUMBER	ITEM	CLASS	TYPE	SIZE	LENGTH (FT)	SLOPE	TBF (CU YD)
104	SS	WM REQMTS	2	30"	76.0	0.50%	56
105	SS	A	1	12"	16.8	1.00%	3
105A	SS	A	1	12"	10.2	1.00%	2
106	SS	A	2	27"	95.5	0.50%	50
107	SS	WM REQMTS	1	12"	20.2	1.00%	4
107A	SS	WM REQMTS	1	12"	11.0	1.00%	2
108	SS	A	2	27"	103.2	0.50%	54
109	SS	WM REQMTS	2	27"	107.4	1.00%	57
110	SS	WM REQMTS	1	12"	14.5	1.00%	3
111	SS	A	2	27"	101.4	1.00%	76
112	SS	A	2	27"	162.2	0.80%	132
113	SS	WM REQMTS	1	12"	5.0	1.00%	1
114	SS	WM REQMTS	1	12"	29.0	1.00%	5
115	SS	A	2	27"	224.0	0.40%	240
116	SS	A	1	12"	5.0	1.00%	1
117	SS	WM REQMTS	1	12"	29.0	1.00%	5
118	SS	WM REQMTS	2	27"	245.8	0.40%	279

PROPOSED

REVISIONS	
NAME	DATE

ILLINOIS DEPARTMENT OF TRANSPORTATION  
**DRAINAGE & UTILITY PLAN**  
 SHERIDAN ROAD  
 STATION 1076+00 TO STATION 1086+00

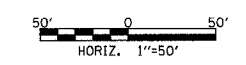

DATE 7/13/07  
 DRAWN BY LTD  
 CHECKED BY BJL

PLOT DATE = 7/12/2007  
 PLOT SCALE = 1"=50'  
 USER NAME = bholman

1051 PERIMETER DRIVE, SUITE 1025  
 SCHUMBERG, ILLINOIS 60173  
 (847) 605-8600

