

F.A.U. R/L	SECTION	COUNTY	TOTAL SHEETS	SHEET NO.
3509 00	00173-00-FP	COOK	246	166
STA. 4088+60		TO STA. 4113+13		
FED. ROAD DIST. NO. 7 ILLINOIS FED. AID PROJECT				

PLOT DATE = 8/7/2007
 FILE NAME = 9A\06\VRM\1\road\sheet1\ex_lighter
 PLOT SCALE = 50/00000 / IN.
 USER NAME = mjg@transys.com

PROJECT LIMITS
 STATION 4088+74.25

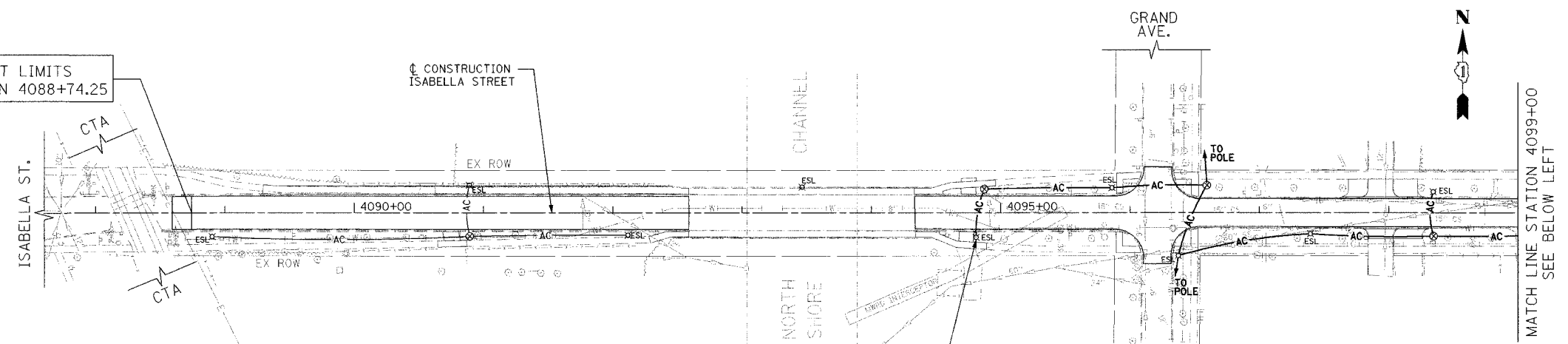

MATCH LINE STATION 1100+00
 SEE SHEET 165

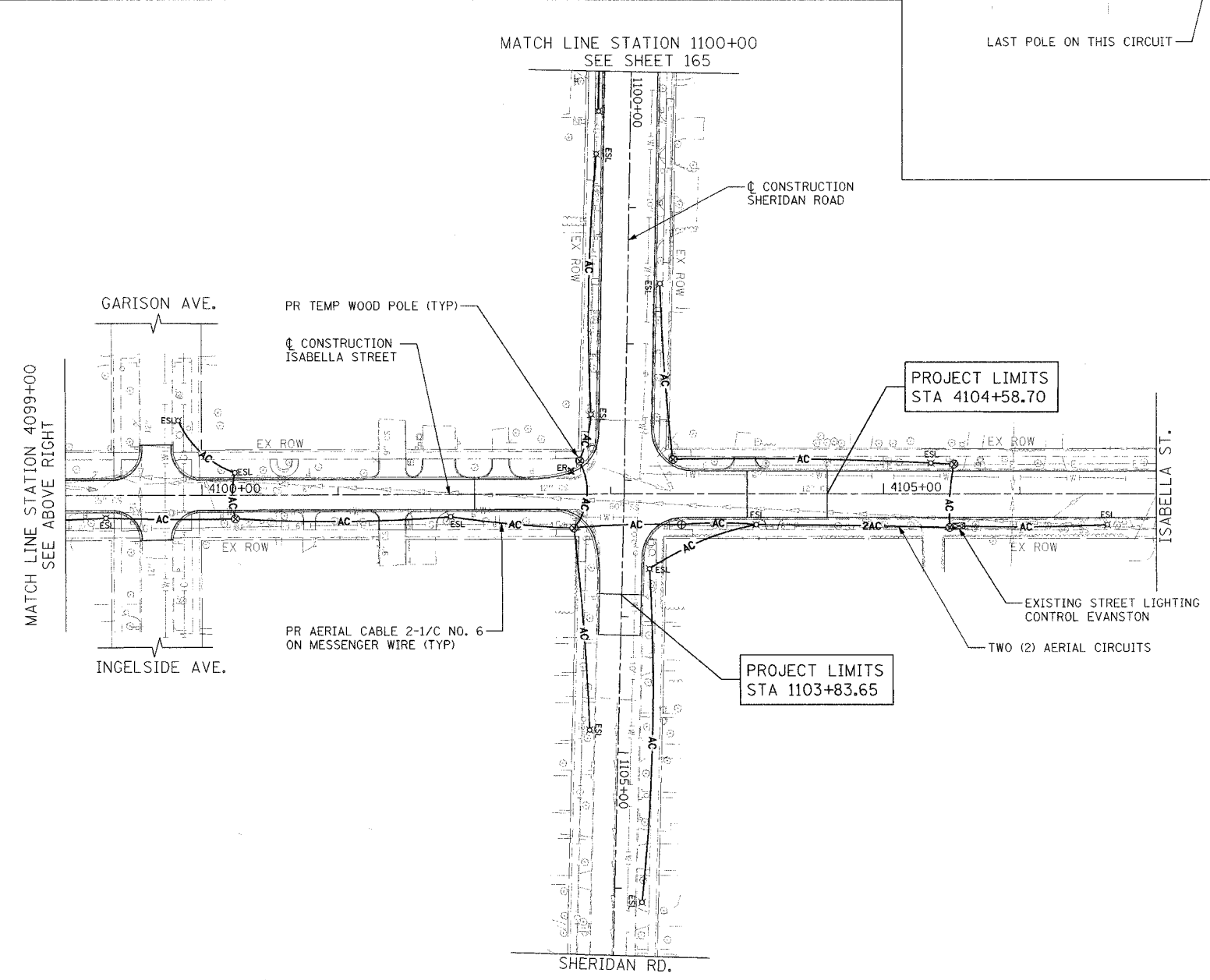

REVISIONS NAME	DATE

ILLINOIS DEPARTMENT OF TRANSPORTATION
 EXISTING & TEMPORARY LIGHTING PLAN
 ISABELLA STREET
 STATION 4088+50 TO STATION 4113+13

DATE 7/30/07
 DRAWN BY AJJ
 CHECKED BY RJG

HORIZ. 1"=50'

1087 PERIMETER DRIVE, SUITE 1025
 SCHMIDGANG, ILLINOIS 60075
 (847) 668-8600

