

F.A.U. RTE.	SECTION	COUNTY	TOTAL SHEETS	SHEET NO.
3509	00-00173-00-FP	COOK	246	206
STA. 1039+50.00 TO STA. 1041+00.00				
FED. ROAD DIST. NO. 1 ILLINOIS FED. AID PROJECT				

DATE	
BY	
FINAL SURVEY	
PLANNED	
NOTE BOOK	
AREAS CHECKED	
NO.	

DATE	
BY	
ORIGINAL SURVEY	
PLANNED	
NOTE BOOK	
AREAS CHECKED	
NO.	

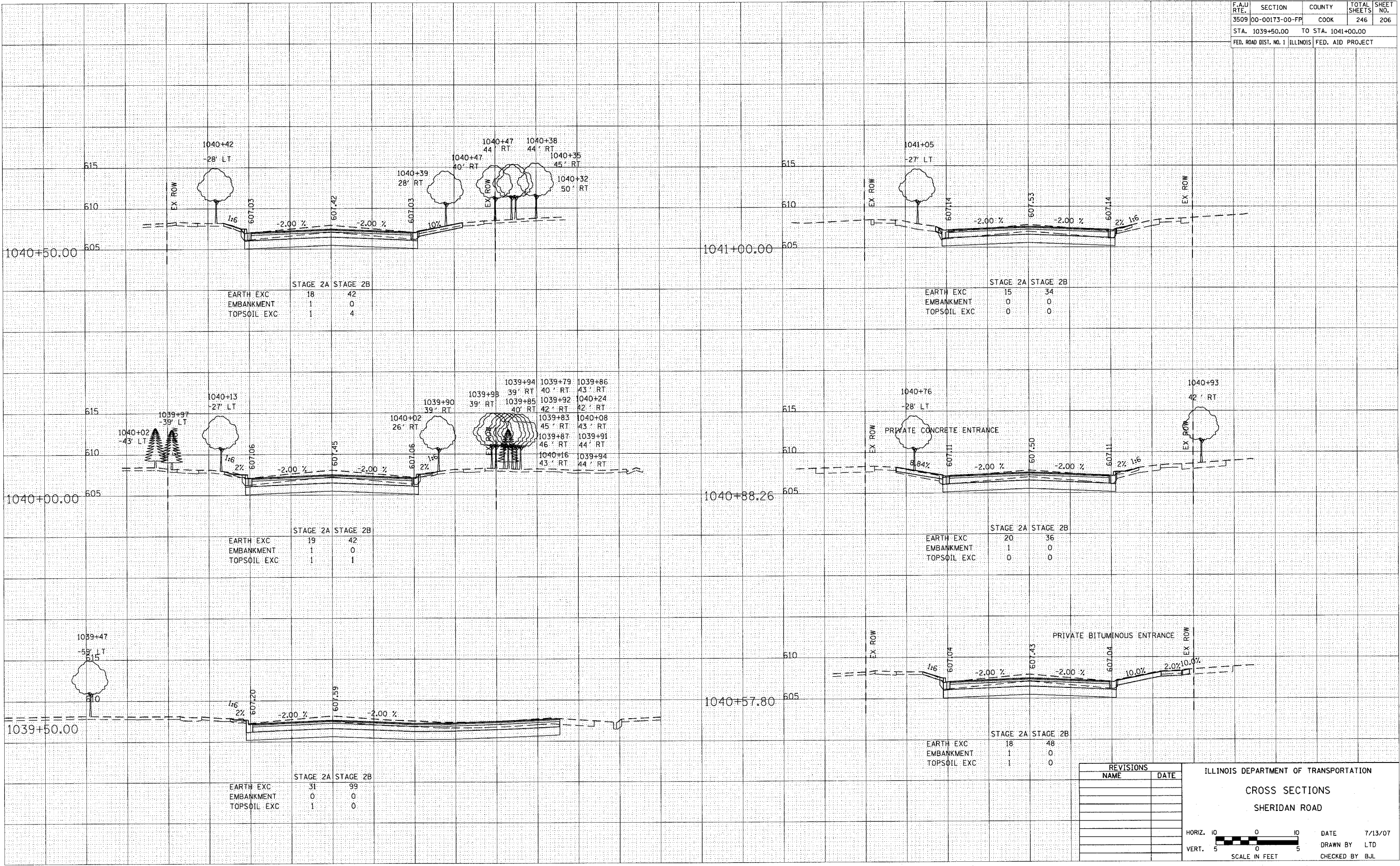

REVISIONS	
NAME	DATE

ILLINOIS DEPARTMENT OF TRANSPORTATION  
**CROSS SECTIONS**  
 SHERIDAN ROAD

HORIZ. 1" = 10'  
 VERT. 1" = 5'

SCALE IN FEET

DATE 7/13/07  
 DRAWN BY LTD  
 CHECKED BY BJL