

F.A.U. RTE.	SECTION	COUNTY	TOTAL SHEETS	SHEET NO.
3509	00-00173-00-FP	COOK	246	209
STA. 1043+91.09 TO STA. 1046+00.00				
FED. ROAD DIST. NO. 1 ILLINOIS FED. AID PROJECT				

DATE	
BY	
FINAL SURVEY	
NOTED	
NO.	

DATE	
BY	
ORIGINAL SURVEY	
NOTED	
NO.	

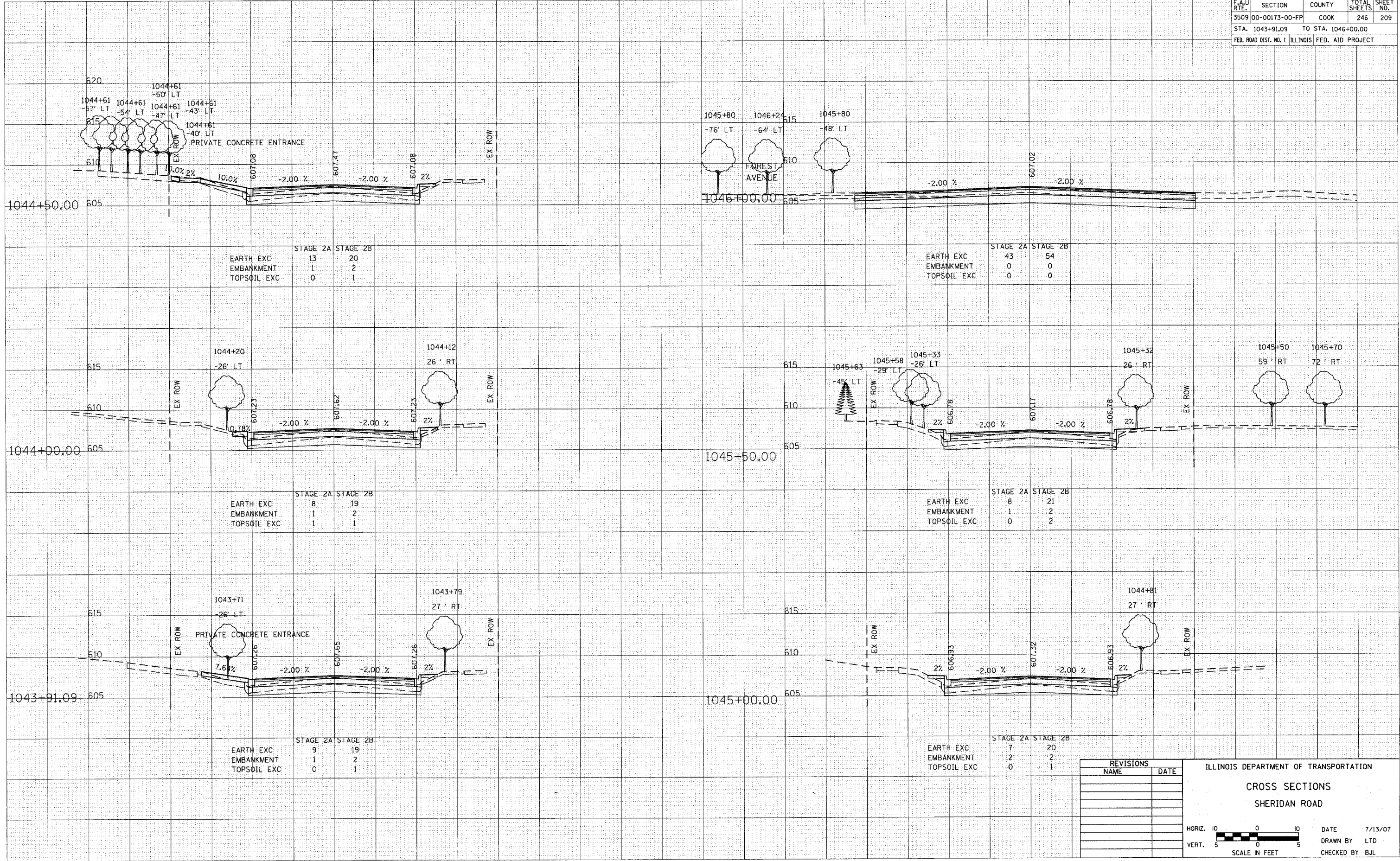

REVISIONS	
NAME	DATE

ILLINOIS DEPARTMENT OF TRANSPORTATION

CROSS SECTIONS
SHERIDAN ROAD

HORIZ. 1" = 40'
VERT. 1" = 5'

SCALE IN FEET

DATE 7/13/07
DRAWN BY LTD
CHECKED BY BJL