

F.A.U. RTE.	SECTION	COUNTY	TOTAL SHEETS	SHEET NO.
3509	00-00173-00-FP	COOK	246	213
STA. 1052+80.06		TO STA. 1054+50.00		
FED. ROAD DIST. NO. 1		ILLINOIS FED. AID PROJECT		

DATE	
BY	
SURVEYED	
PLOTTED	
NOTE BOOK	
AREAS CHECKED	

DATE	
BY	
SURVEYED	
PLOTTED	
NOTE BOOK	
AREAS CHECKED	

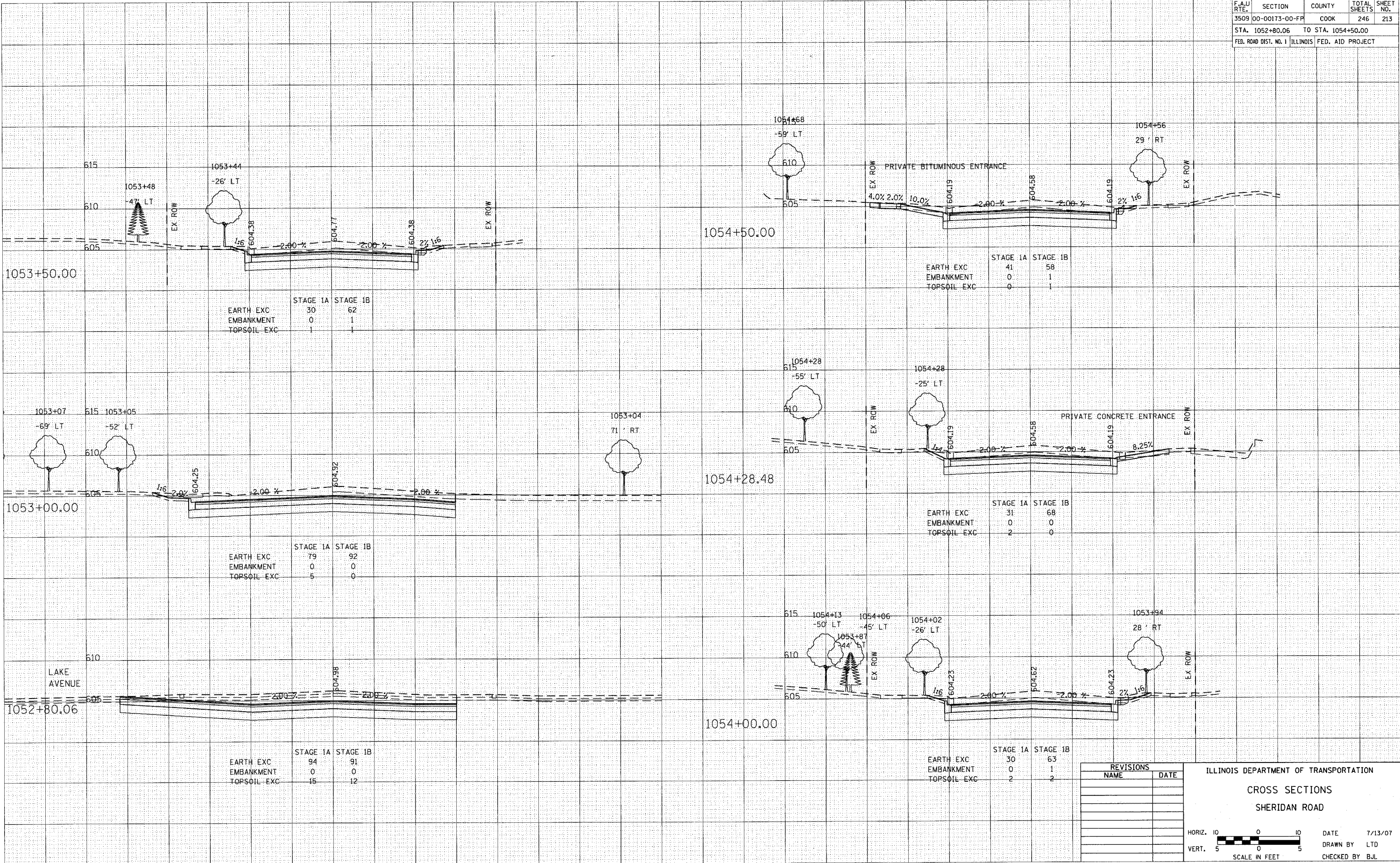

REVISIONS	
NAME	DATE

ILLINOIS DEPARTMENT OF TRANSPORTATION

CROSS SECTIONS

SHERIDAN ROAD

HORIZ. 1" = 10'

VERT. 1" = 5'

SCALE IN FEET

DATE 7/13/07

DRAWN BY LTD

CHECKED BY BJL