

NOTES:

1. REFER TO INTERSECTION DETAIL SHEETS FOR LOCATION OF PAVEMENT JOINTS FOR STAGING.
2. USE THE FOLLOWING PAY ITEMS WHERE APPLICABLE IN ORDER TO STAGE CONSTRUCT THE INTERSECTION:
HOT MIX ASPHALT SURFACE REMOVAL-BUTT JOINT
INCIDENTAL HOT-MIX ASPHALT SURFACING
HOT-MIX ASPHALT SURFACE REMOVAL, VARIABLE DEPTH

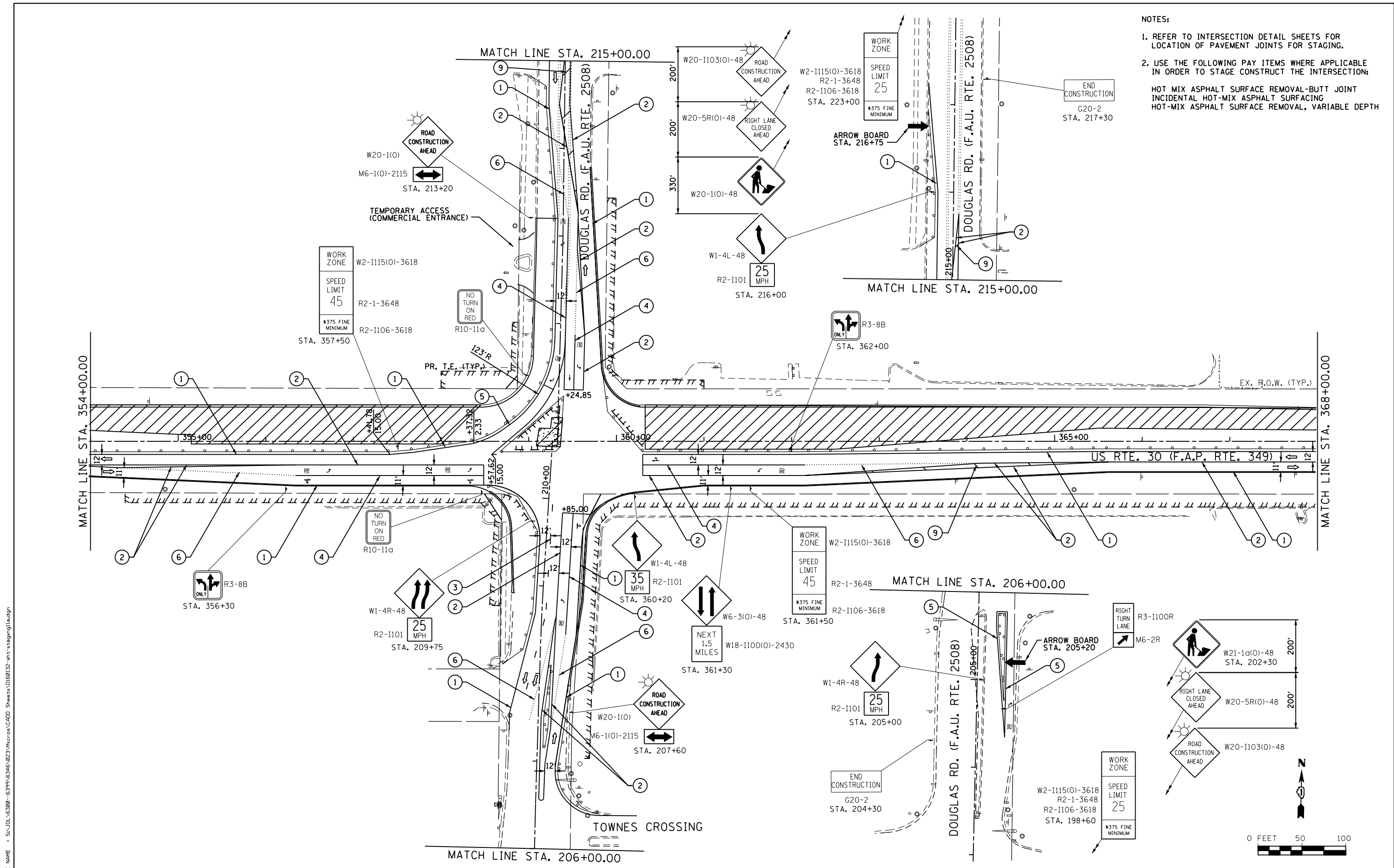

FILE NAME = S:\JOLI\63300-63999\6346\023\Micro\CAD Sheets\0160132-sht-staging1a.dgn

STRAND
ENGINEERS
1170 SOUTH HOUBOLT ROAD
JOLIET, ILLINOIS 60431
(815) 744-4200

USER NAME = amanda.j
DESIGNED -
DRAWN -
PLOT SCALE = 100.0000' / 1" =
CHECKED -
PLOT DATE = 8/1/2012
DATE -

DESIGNED -
DRAWN -
CHECKED -
DATE -
REVISED -
REVISED -
REVISED -
REVISED -

**STATE OF ILLINOIS
DEPARTMENT OF TRANSPORTATION**

**MAINTENANCE OF TRAFFIC
STAGE 1a**

SCALE: AS SHOWN SHEET NO. OF SHEETS STA. 354+00.00 TO STA. 368+00.00

F.A.P. RTE.	SECTION	COUNTY	TOTAL SHEETS	SHEET NO.
349	11 WRS-3	KENDALL	527	106
CONTRACT NO. 60132				
FED. ROAD DIST. NO. 1 ILLINOIS FED. AID PROJECT				