

PLAN	SURVEYED	DATE
	PLOTTED	BY
	CHECKED	
	AT	
	CADD FILE NAME	
NOTE BOOK NO.		

PROFILE	SURVEYED	DATE
	PLOTTED	BY
	CHECKED	
	AT	
	STRUCTURE	
NOTE BOOK NO.		

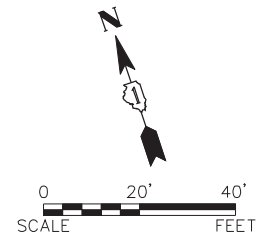
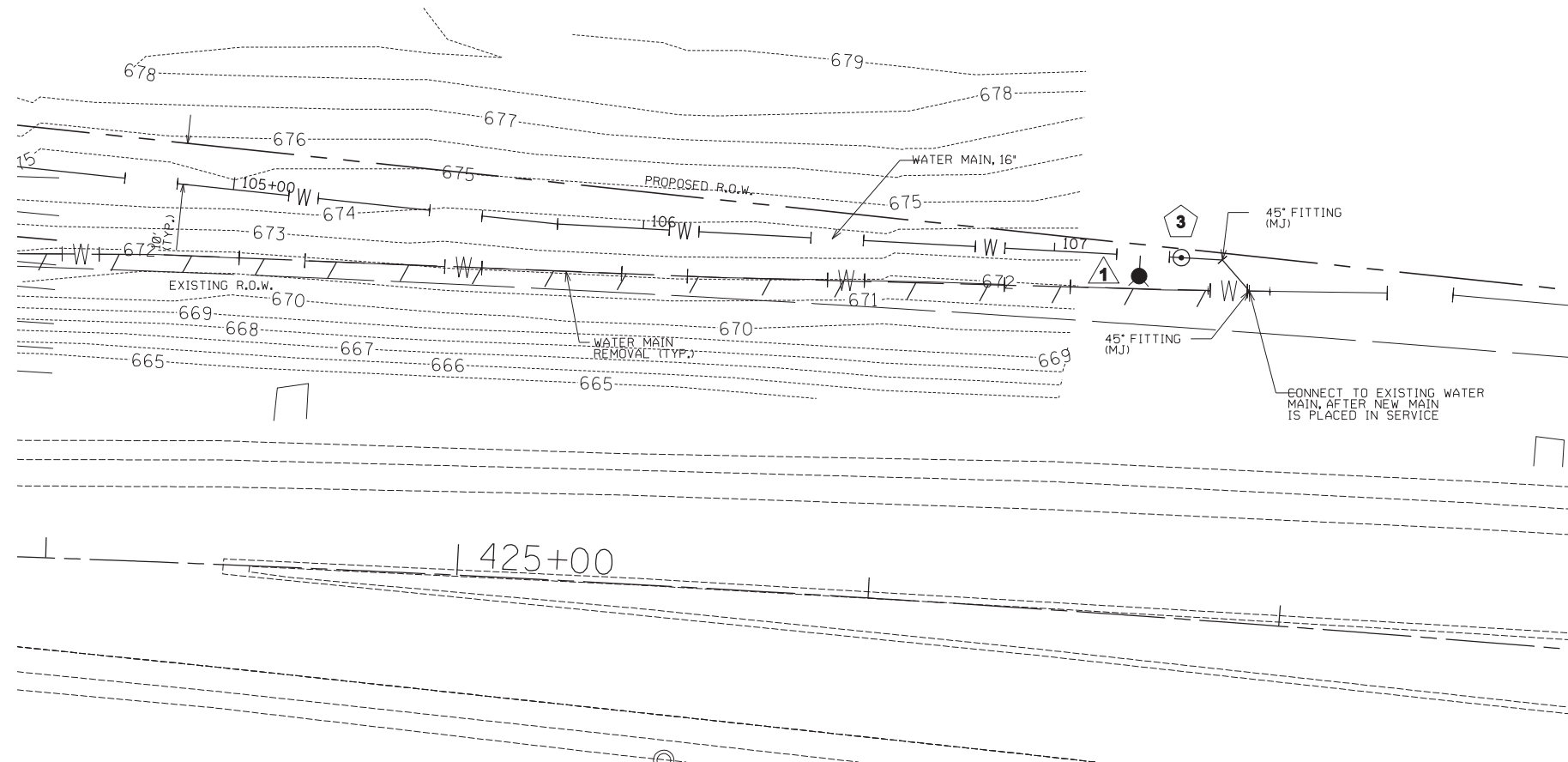

- 3** VALVE VAULT NO. 3
STA 107+30.90
(ROADWAY STA 426+70.06)
16" GATE VALVE
IN 60" VAULT
RIM = 673.75
- 1** FIRE HYDRANT NO. 1
STA 107+20.90, 5.00' RT
W/ 16"x16"x6" TEE (MJ)
AND AUXILIARY VALVE
BURY ELEV. = 673.00

- CONSTRUCTION SEQUENCE**
1. TEMPORARY SHUT DOWN OF EXISTING 16" WATER MAIN SECTION. USE EMERGENCY SHUT DOWN PROCEDURES.
 2. CUT EXISTING MAIN AND INSTALL VV #1, WATER MAIN TO 16"x16"x16" TEE, AND VV #2. RECONNECT TO EXISTING WATER MAIN.
 3. WITH VV #2 REMAINING CLOSED OPEN EXISTING WATER MAIN AT VV #1.
 4. CONSTRUCT NEW WATER MAIN, PRESSURE TEST, AND DISINFECT NEW WATER MAIN.
 5. AFTER VILLAGE OBTAINS OPERATING PERMIT, DISCONNECT FROM EXISTING WATER MAIN AT THE 16"x16"x16" TEE, CAPPING TEE WITH MJ FITTING AND THRUST BLOCKING.
 6. CONNECT TO EXISTING WATER MAIN AT VV #3 USING 45° FITTING (MJ) AND THRUST BLOCKING.
 7. REMOVE EXISTING WATER MAIN.

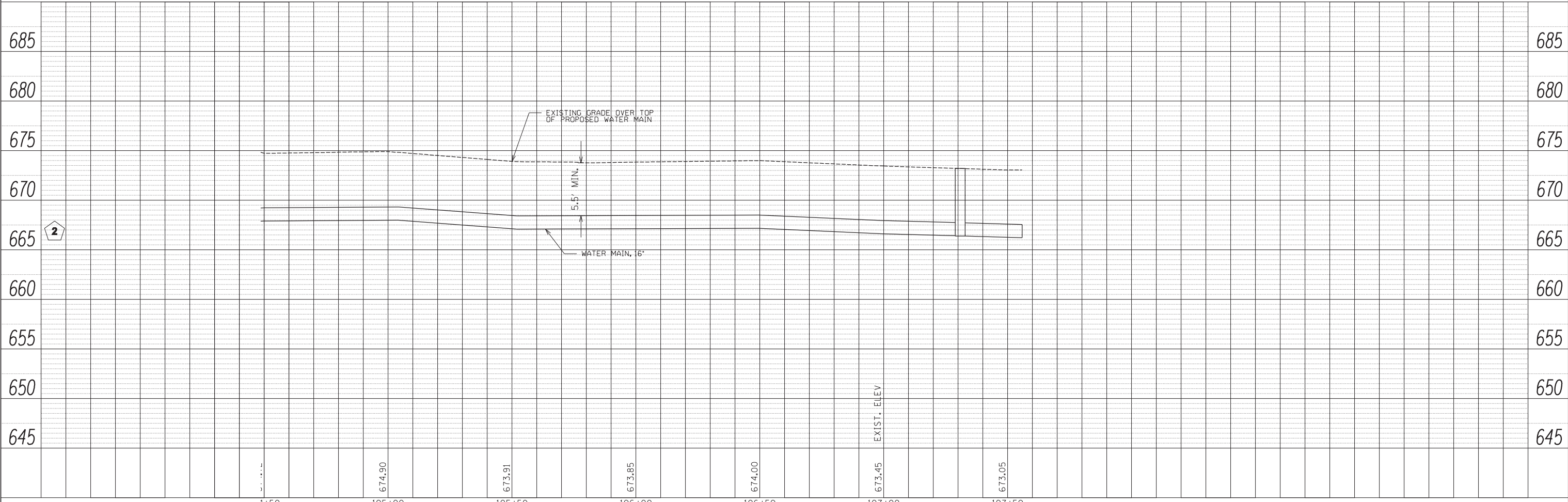

FILE NAME = H:\SDSKProj\M01120\dgn\Dgn_Final_Eng\M01120-PP.dgn	USER NAME = kpung	DESIGNED - TNP	REVISD -	STATE OF ILLINOIS DEPARTMENT OF TRANSPORTATION	PROPOSED WATER MAIN PLAN AND PROFILE	F.A.P. RTE. = 349	SECTION = 11 WRS-3	COUNTY = KENDALL	TOTAL SHEETS = 527	SHEET NO. = 181		
PLOT SCALE = 20.0000' / IN.	CHECKED - TAW	REVISD -	SCALE: 1" = 20'			SHEET NO. 2 OF 3 SHEETS	STA. 104+50 TO STA. 107+55.89	CONTRACT NO. 60132				
PLOT DATE = 4/26/2012	DATE = 4/26/12	REVISD -	FED. ROAD DIST. NO. 1 ILLINOIS FED. AID PROJECT									