

SIGN (A)
 LEFT ON GREEN
 ARROW ONLY
 SEE NOTE 1
 R-10-5
 24" x 30"
 (2 EACH)

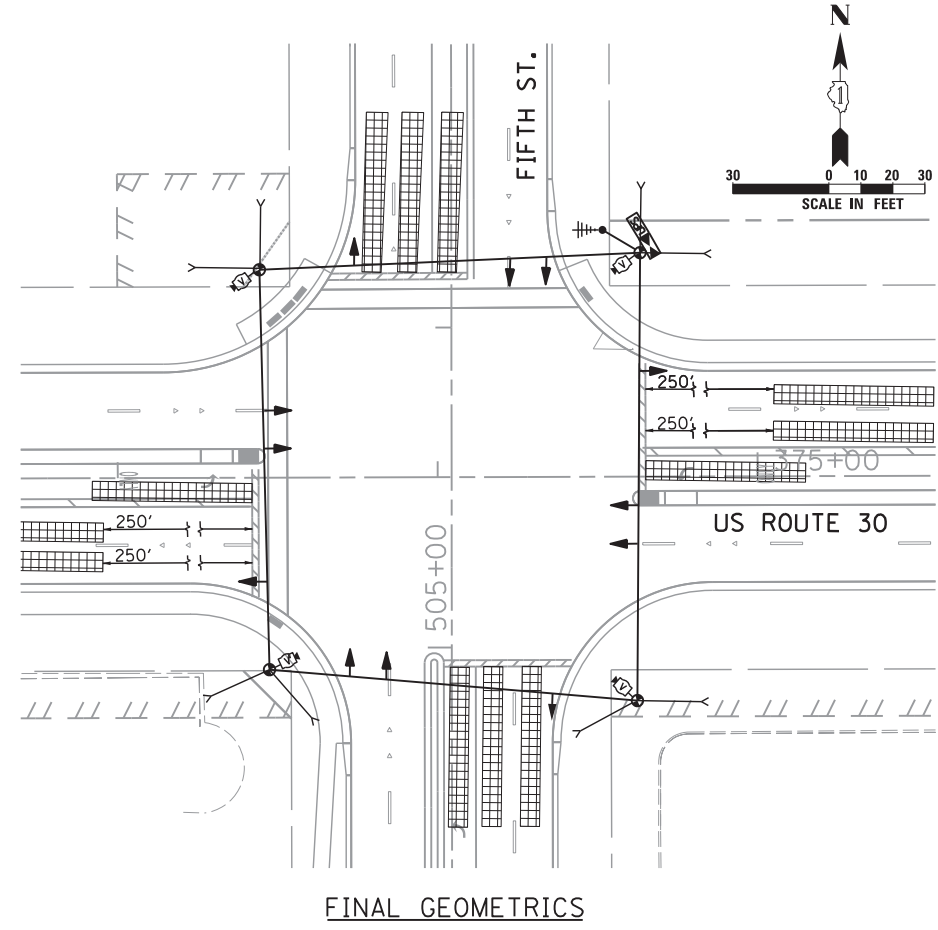

NOTES:
 1. COST OF SIGN IS INCIDENTAL TO TEMPORARY TRAFFIC SIGNAL INSTALLATION.

\\Dc01\Projects\264\Dgn\CADD_Sheets\160132-SHT-TS-20.dgn

SINGH
 CONSULTING ENGINEERS
 www.singhinc.com

USER NAME = vpelegrinos	DESIGNED - VO	REVISED -
	DRAWN - YJ	REVISED -
PLOT SCALE = 30.000' / in.	CHECKED - KGP	REVISED -
PLOT DATE = 4/25/2012	DATE -	REVISED -

**STATE OF ILLINOIS
 DEPARTMENT OF TRANSPORTATION**

**TEMPORARY TRAFFIC SIGNAL M.O.T. STAGING PLAN
 US ROUTE 30 AT FIFTH ST. STAGES 2b, 3 AND FINAL GEOMETRICS**

SCALE: 1"=30' SHEET NO. OF SHEETS STA. TO STA.

F.A.P. RTE.	SECTION	COUNTY	TOTAL SHEETS	SHEET NO.
349	11 WRS-3	KENDALL	527	264
CONTRACT NO. 60132				
FED. ROAD DIST. NO. 1 ILLINOIS FED. AID PROJECT				