

STATE OF ILLINOIS
DEPARTMENT OF TRANSPORTATION
DIVISION OF HIGHWAYS

**JOLIET VARIOUS MOVABLE BRIDGES
AUTOMATION**

**BRIDGE OFFICE BUILDING
SECTION NO. 2012-045I**

**CONSTRUCTION PROJECT NO. C-91-546-12
IMPROVEMENTS TO BUILDING EXTERIOR
WILL COUNTY**

D-91-301-09

F.A. RTE.	SECTION	COUNTY	TOTAL SHEETS	SHEET NO.
N.A.	BRIDGE OFFICE BUILDING	WILL	11	1
	JOLIET	ILLINOIS	CONTRACT NO. 60V37	

INDEX OF SHEETS

- COVER SHEET
- SUMMARY OF QUANTITIES
- ABBREVIATIONS, SYMBOLS LEGEND AND TOTAL BILL OF MATERIALS
- ROOF PLAN - DEMOLITION
- ROOF PLAN - NEW WORK - MECHANICAL OPTION 1
- ROOF PLAN - NEW WORK - MECHANICAL OPTION 2
- EXTERIOR ELEVATIONS
- EXTERIOR ELEVATIONS
- EXISTING CONDITION DETAILS
- NEW WORK DETAILS
- NEW WORK DETAILS

PROJECT DESCRIPTION:

ROOF REPLACEMENT, EXTERIOR MASONRY TUCKPOINTING AND SEALING AND MODIFICATION AND PAINTING OF FIRE ESCAPE AT BRIDGE OFFICE BUILDING. MECHANICAL EQUIPMENT CURBS/PLATFORMS WILL BE FURNISHED AND INSTALLED UNDER A SEPARATE CONTRACT TO BE COMPLETED CONCURRENTLY WITH THIS PROJECT. STRUCTURAL IN-FILL OF EXISTING OPENINGS AND CONSTRUCTION OF NEW OPENINGS FOR MECHANICAL EQUIPMENT WILL ALSO BE INCLUDED WITH THE SEPARATE PROJECT. NOTE THAT TWO ROOF PLANS ARE SHOWN TO DEPICT TWO OPTIONS FOR MECHANICAL SYSTEMS. ONE OPTION WILL BE SELECTED.

FULL SIZE PLANS HAVE BEEN PREPARED USING STANDARD ARCHITECTURAL SCALES. APPLICABLE BAR SCALES ARE SHOWN ON EACH SHEET.

J.U.L.I.E.
JOINT UTILITY LOCATION INFORMATION FOR EXCAVATION
1-800-892-0123 OR 811

CONTRACT NO. 60V37

PRINTED BY THE AUTHORITY
OF THE STATE OF ILLINOIS

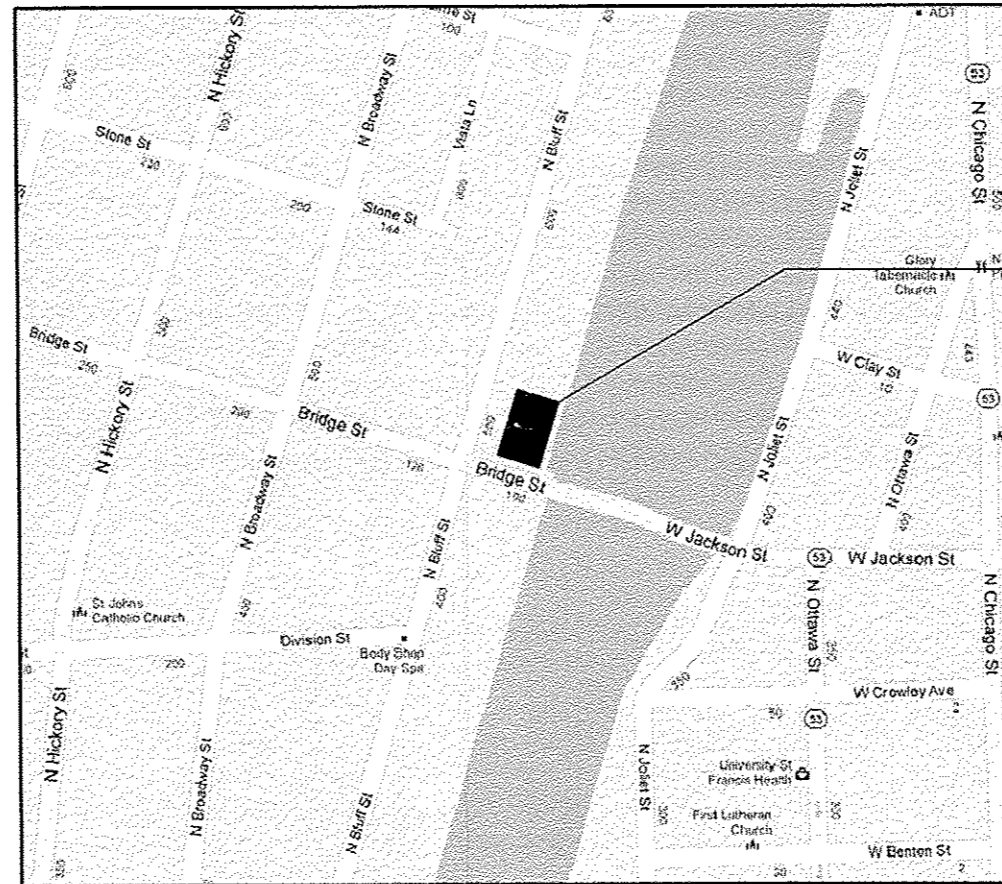

LOCATION PLAN
NO SCALE

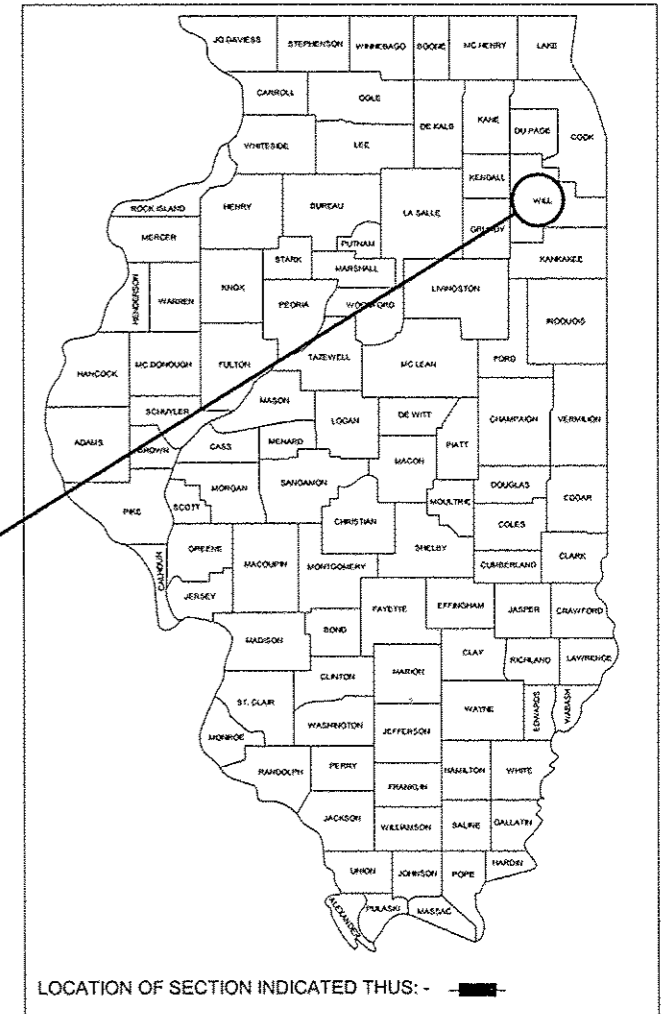

LOCATION OF SECTION INDICATED THIS: - [thick black line]

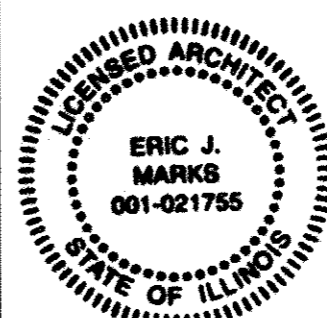

EXPIRES: 11/30/12
Eric J. Marks
6/28/2012

STATE OF ILLINOIS
DEPARTMENT OF TRANSPORTATION
DIVISION OF HIGHWAYS

SUBMITTED July 5, 2012
John P. [Signature]
DEPUTY DIRECTOR OF HIGHWAYS, REGION ENGINEER

August 17, 2012
John J. Baranzelli, P.E. /a
acting ENGINEER OF DESIGN AND ENVIRONMENT

August 17, 2012
William R. Frey /a
acting DIRECTOR OF HIGHWAYS, CHIEF ENGINEER

PROJECT MANAGER - SERIN KELLER (847) 705-4556
PROJECT ENGINEER - JOE SACCOMANNO (847) 705-4594

