

GENERAL NOTES

1. CONTRACTOR TO FIELD VERIFY ALL DIMENSIONS.
2. MINIMUM ROOF INSULATION THICKNESS = 2"
3. MINIMUM ROOF SLOPE = 1/4" PER 1'-0"

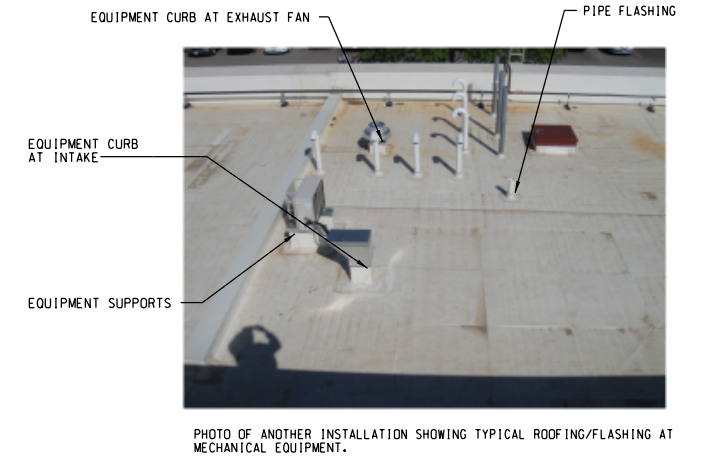

1 ROOF PLAN - NEW WORK - OPTION 2
1/4" = 1'-0"

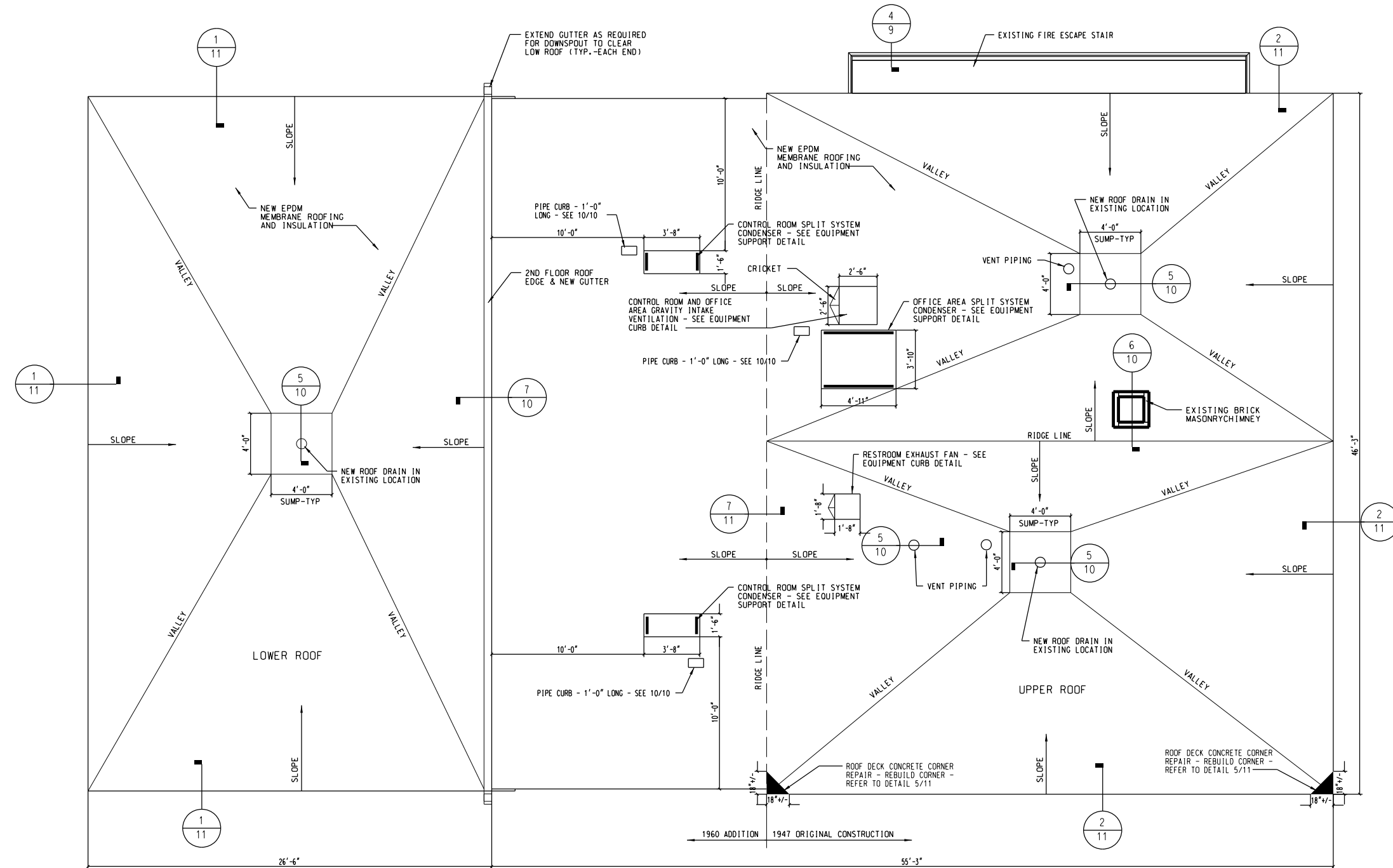
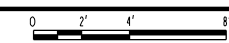

BILL OF MATERIALS		
ITEMS	UNIT	TOTAL
ROOF REPLACEMENT, LOCATION 1	LS	1



USER NAME =	DESIGNED - LOF	REVISED
	DRAWN - BRK	REVISED
PLOT SCALE =	CHECKED - EJM	REVISED
PLOT DATE = 06-28-2012	APPROVED - GLC	REVISED

STATE OF ILLINOIS
DEPARTMENT OF
TRANSPORTATION

ROOF PLAN - NEW WORK - MECHANICAL OPTION 2

Scale SHEET NO. 6 OF 11 SHEETS Station From Station To

F.A.P. RTE.	SECTION	COUNTY	TOTAL SHEETS	SHEET NO.
	2012-0451	WILL	11	6
CONTRACT NO. 60V37			ILLINOIS FED. AID PROJECT	