

F.A.U. RTE.	SECTION	COUNTY	TOTAL SHEETS	SHEET NO.
3002	00-00083-00-PV	DUPAGE	73	1
ILLINOIS			CONTRACT NO. 63579	

INDEX OF SHEETS

- 1 COVER SHEET AND INDEX OF DRAWINGS
- 2 GENERAL NOTES AND STATE STANDARDS
- 3 - 8 SUMMARY OF QUANTITIES
- 9 - 10 TYPICAL SECTIONS
- 11 SCHEDULE OF QUANTITIES
- 12 ALIGNMENT, TIES AND BENCHMARKS
- 13 REMOVAL PLAN
- 14 - 15 PROPOSED PLAN AND PROFILE
- 16 - 19 SUGGESTED STAGES OF CONSTRUCTION & TRAFFIC CONTROL
- 20 EROSION CONTROL AND LANDSCAPING PLANS
- 21 DRAINAGE AND UTILITY GENERAL NOTES AND DETAILS
- 22 - 23 DRAINAGE & UTILITY PLAN AND PROFILE
- 24 - 25 PLATS OF HIGHWAYS
- 26 - 28 INTERSECTION & ROADWAY DETAILS
- 29 PAVEMENT MARKING AND SIGNING PLAN
- 30 - 35 TRAFFIC SIGNAL PLANS
- 36 - 37 LIGHTING PLANS AND DETAILS
- 40 SOIL BORINGS
- 41 - 68 IDOT DISTRICT ONE DETAILS
- 69 - 73 CROSS SECTIONS

STATE OF ILLINOIS
 DEPARTMENT OF TRANSPORTATION
 DIVISION OF HIGHWAYS

PLANS FOR PROPOSED
 FEDERAL AID PROJECT

FAU 3002 (PASQUINELLI DRIVE)
 AT FAP 311 (OGDEN AVENUE /U.S. ROUTE 34)
 ROADWAY RECONSTRUCTION AND WIDENING

SECTION NO.: 00-00083-00-PV
 PROJECT NO.: CMM-M-8003 (748)
 JOB NO.: C-91-128-07

VILLAGE OF WESTMONT
 DUPAGE COUNTY

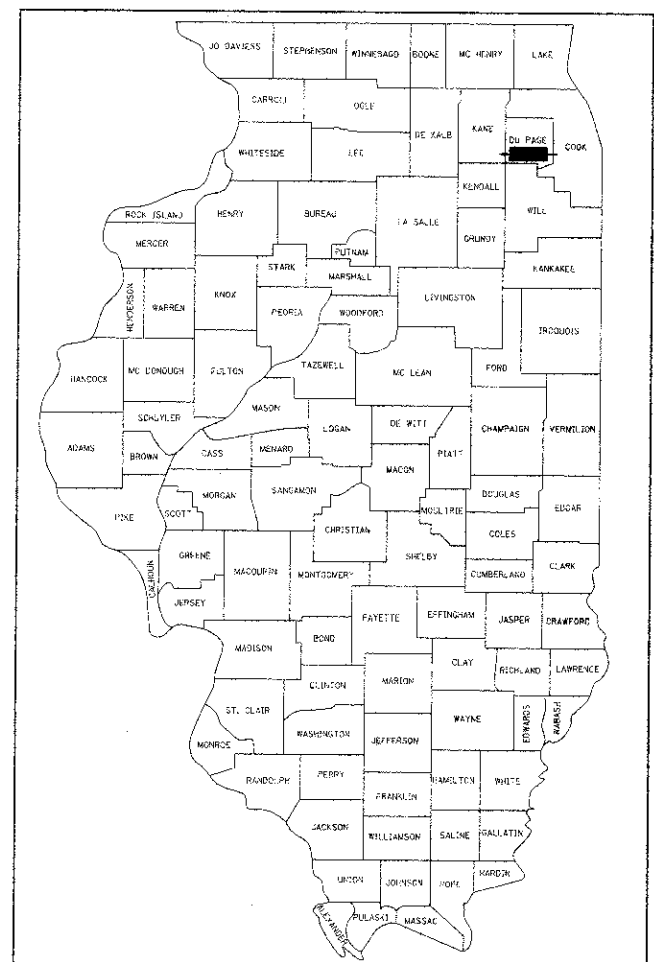

LOCATION OF SECTION INDICATED THIS: [Black Rectangle]

AGENCY RESPONSIBLE FOR LETTING

APPROVED MARCH 28 2011

WESTMONT DIRECTOR OF PUBLIC WORKS

PASSED APRIL 13 2011

DISTRICT 1 ENGINEER OF LOCAL ROADS & STREETS

RELEASED FOR BID BASED ON LIMITED REVIEW

APRIL 13, 2011

DEPUTY DIRECTOR OF HIGHWAYS, REGION 1 ENGINEER

Matthew A. Papirnik, P.E. ENGINEER

ILLINOIS REGISTRATION No. 062-052094
 EXPIRATION DATE: 11/30/2011
 APPLIES TO ALL SHEETS EXCEPT FOR THOSE LISTED BELOW

DAVID E. MERTZ, P.E. ENGINEER

ILLINOIS REGISTRATION No. 062-052068
 EXPIRATION DATE: 11/30/2011
 APPLIES TO SHEETS 30-37

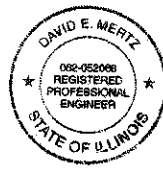

PRINTED BY THE AUTHORITY OF THE STATE OF ILLINOIS

FOR LIST OF STATE AND LOCAL STANDARDS, SEE SHEET NO. 2

PROJECT LOCATED WITHIN THE VILLAGE OF WESTMONT

TRAFFIC DATA - PASQUINELLI DRIVE

POSTED SPEED: 30MPH
 DESIGN SPEED: 35MPH
 CURRENT ADT (2007): 11,000 VPD
 DESIGN ADT (2030): 12,000 VPD

TRAFFIC DATA - OGDEN AVENUE

POSTED SPEED: 35MPH
 DESIGN SPEED: 40MPH
 CURRENT ADT (2007): 37,400 VPD
 DESIGN ADT (2030): 41,000 VPD

DESIGN DESIGNATION

COLLECTOR STREET (PASQUINELLI DRIVE)
 OTHER PRINCIPAL ARTERIAL (OGDEN AVENUE)

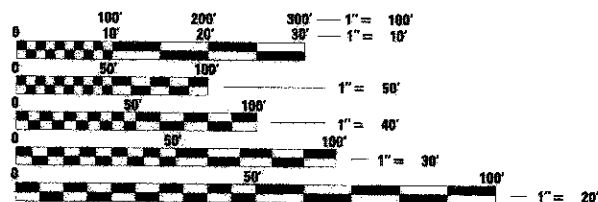

FULL SIZE PLANS HAVE BEEN PREPARED USING STANDARD ENGINEERING SCALES. REDUCED SIZED PLANS WILL NOT CONFORM TO STANDARD SCALES. IN MAKING MEASUREMENTS ON REDUCED PLANS, THE ABOVE SCALES MAY BE USED.

J.U.L.I.E.
 JOINT UTILITY LOCATION INFORMATION FOR EXCAVATION
 1-800-892-0123
 OR 811

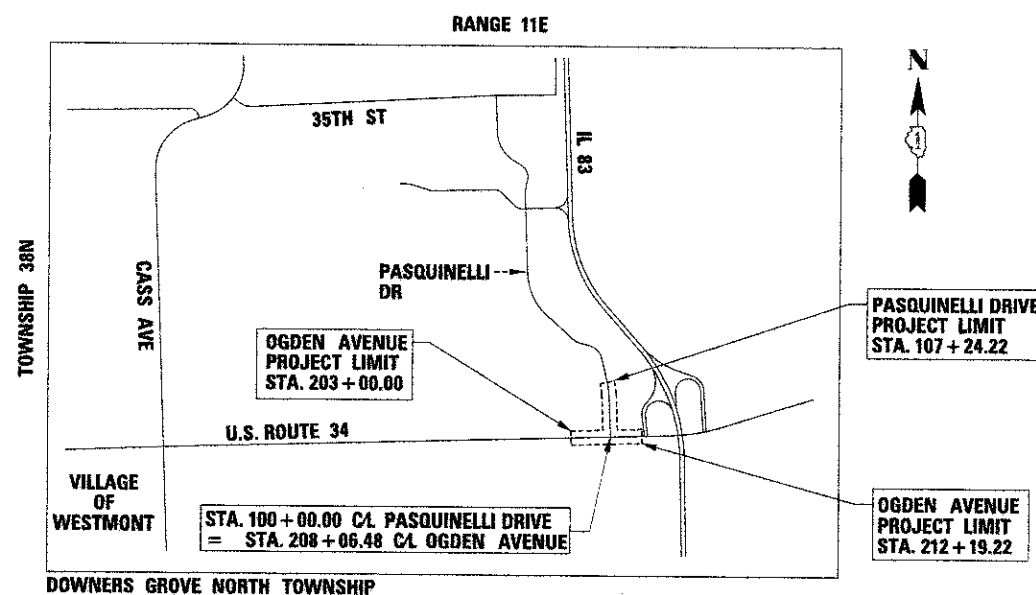

LOCATION MAP

N.T.S.

GROSS LENGTH OF PROJECT = 1,645 LINEAL FEET (0.31 MILES)
 NET LENGTH OF PROJECT = 1,645 LINEAL FEET (0.31 MILES)

IL DESIGN FIRM NO. 184-001310



EXP. 04/30/2013

PROGRAM AND OFFICE ENGINEER: CHARLES F. RIDDLE, P.E. 847-705-4406 /SCHAUMBURG, IL

CONTRACT NO. 63579