

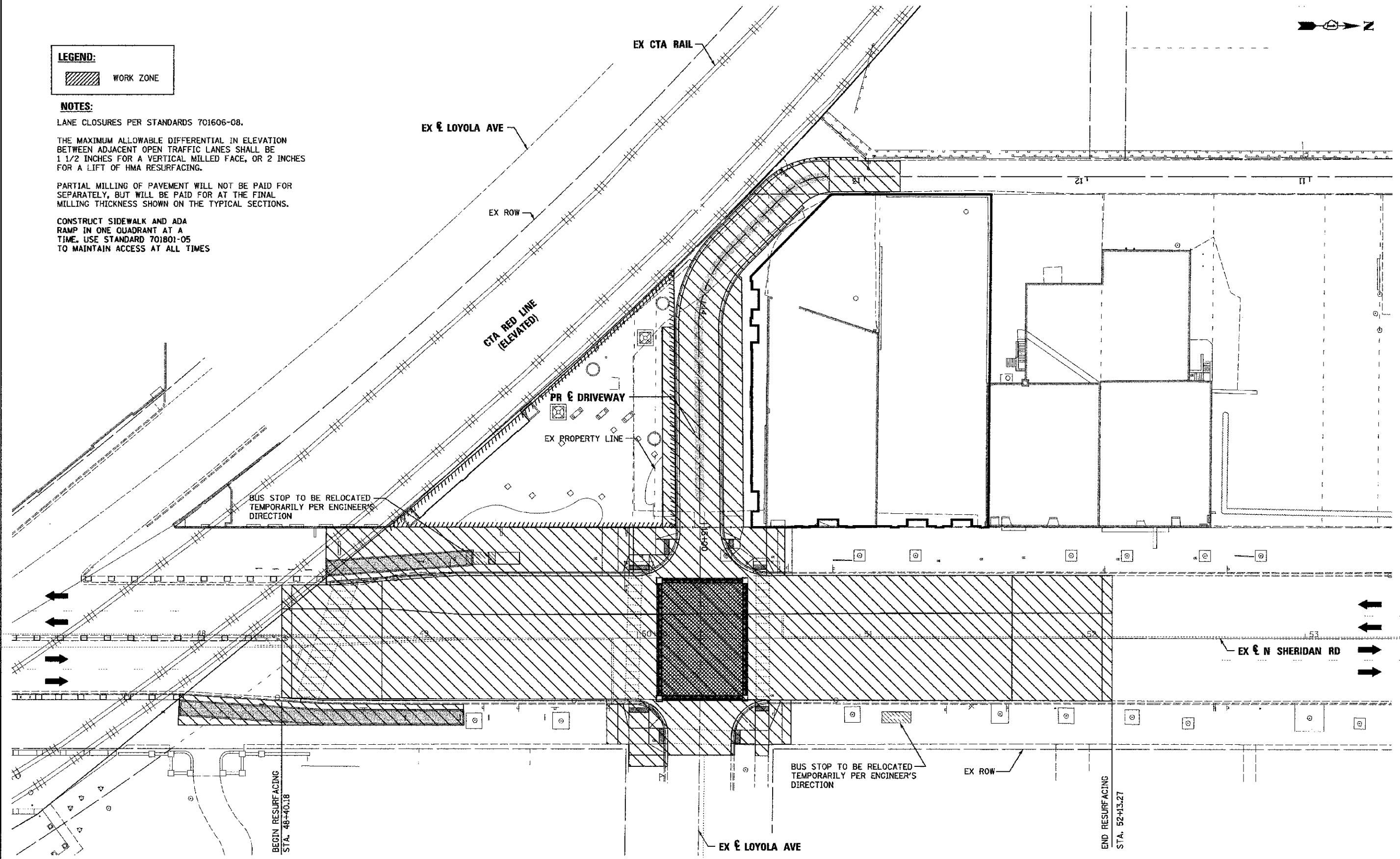

**LEGEND:**  
 WORK ZONE

**NOTES:**  
 LANE CLOSURES PER STANDARDS 701606-08.  
 THE MAXIMUM ALLOWABLE DIFFERENTIAL IN ELEVATION BETWEEN ADJACENT OPEN TRAFFIC LANES SHALL BE 1 1/2 INCHES FOR A VERTICAL MILLED FACE, OR 2 INCHES FOR A LIFT OF HMA RESURFACING.  
 PARTIAL MILLING OF PAVEMENT WILL NOT BE PAID FOR SEPARATELY, BUT WILL BE PAID FOR AT THE FINAL MILLING THICKNESS SHOWN ON THE TYPICAL SECTIONS.  
 CONSTRUCT SIDEWALK AND ADA RAMP IN ONE QUADRANT AT A TIME. USE STANDARD 701801-05 TO MAINTAIN ACCESS AT ALL TIMES



FILE NAME =	DESIGNED - AAA	REVISED -
USER NAME = tblank	DRAWN - TMB	REVISED -
PLOT DATE = 7/2/2012	CHECKED - JMM	REVISED -
	DATE - 7/2/2012	REVISED -



STATE OF ILLINOIS  
 DEPARTMENT OF TRANSPORTATION

MAINTENANCE OF TRAFFIC

SCALE: 1"=20' SHEET NO. 1 OF 1 SHEETS STA. TO STA.

F.A.U. RTE. 2865	SECTION 10-B5159-00-TL	COUNTY COOK	TOTAL SHEETS 62	SHEET NO. 16
CONTRACT NO. 63715				ILLINOIS FED. AID PROJECT