

PROJECT ENDS  
STA 8+70

PROJECT BEGINS  
STA 8+42

LIMITS OF 10YR  
FLOOD = 626.0

LIMITS OF 10YR FLOOD = 626.0

BFE = 627.0

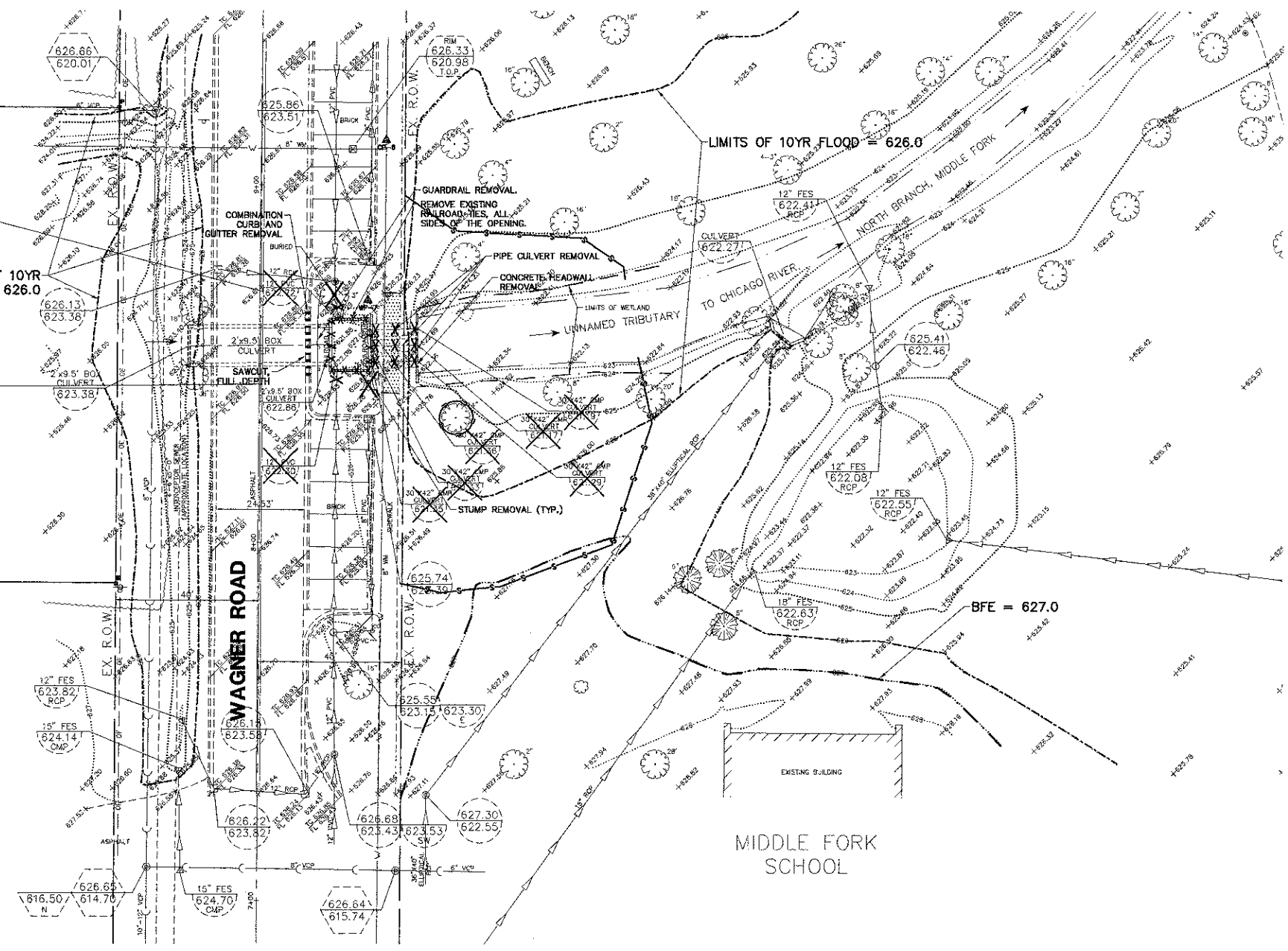

**LEGEND**

STORM SEWER REMOVAL	---x---x---x---
COMBINATION CURB & GUTTER REMOVAL	■■■■■■■■■■
PCC SIDEWALK REMOVAL	▨▨▨▨▨▨▨▨
PERIMETER EROSION BARRIER	—S—S—S—S—
TEMPORARY FENCING	—X—X—X—X—
TREE REMOVAL	⊗
WATERS OF THE US	— · — · — · —
10 YEAR FLOOD LIMITS	— · — · — · —
100 YEAR FLOOR LIMITS	— · — · — · —

**NOTES:**

1. REMOVAL OF EXISTING TREE STUMP SHALL NOT BE PAID FOR SEPARATELY BUT SHALL BE CONSIDERED INCLUDED IN THE CONTRACT UNIT PRICE FOR EARTH EXCAVATION.
2. REMOVAL OF EXISTING RAILROAD TIES SHALL NOT BE PAID FOR SEPARATELY BUT SHALL BE CONSIDERED INCLUDED IN THE CONTRACT UNIT PRICE FOR EARTH EXCAVATION.

FILE NAME = 3509.213--Wagner--PR1.cwg	USER NAME = BRIAN WESOLOWSKI	DESIGNED - BVS	REVISED - 6/29/12	<b>SUNSET RIDGE ROAD &amp; WAGNER ROAD SECTION 10-0050-00-SW VILLAGE OF NORTHFIELD, ILLINOIS</b>	<b>EXISTING CONDITIONS/DEMOLITION PLAN</b>			FAU RTE	SECTION	COUNTY	TOTAL SHEETS	SHEET NO.	
	PLOT SCALE = 1" = .0833'	DRAWN - BVS	REVISED -		SCALE 1"=20'	SHEET NO.	OF SHEETS	STA.	TO STA.	2777	10-0050-00-SW	COOK	15 3
	PLOT DATE = 4/30/2012	CHECKED - LJD	REVISED -									CONTRACT #	63729
		DATE - 4/30/12	REVISED -								ILLINOIS FED. AID PROJECT		