

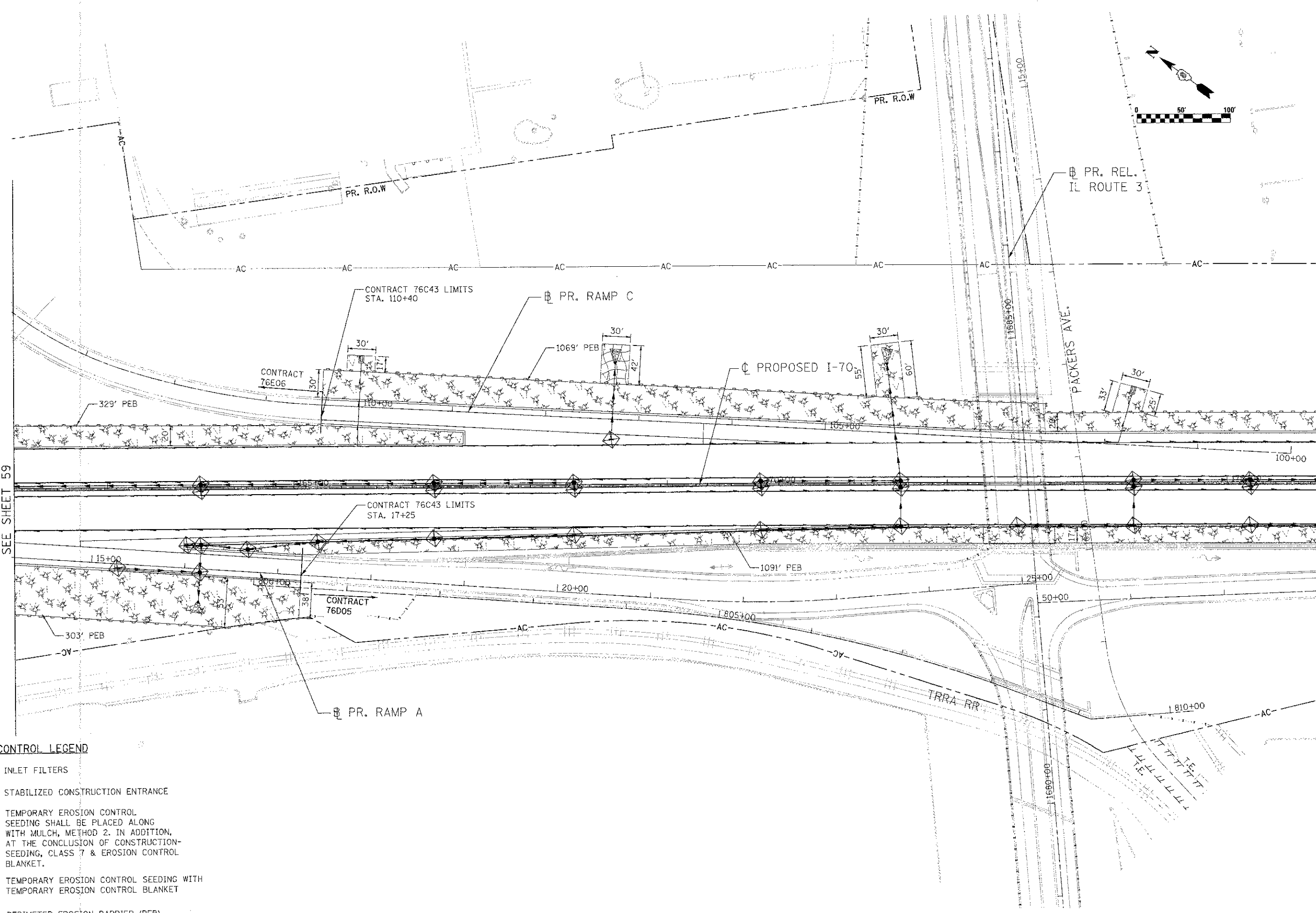



MATCH LINE STA. 162+00
SEE SHEET 59

MATCH LINE STA. 176+00
SEE SHEET 61

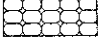
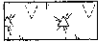

- EROSION CONTROL LEGEND**
-  INLET FILTERS
 -  STABILIZED CONSTRUCTION ENTRANCE
 -  TEMPORARY EROSION CONTROL SEEDING SHALL BE PLACED ALONG WITH MULCH, METHOD 2. IN ADDITION, AT THE CONCLUSION OF CONSTRUCTION SEEDING, CLASS 7 & EROSION CONTROL BLANKET.
 -  TEMPORARY EROSION CONTROL SEEDING WITH TEMPORARY EROSION CONTROL BLANKET
 -  PERIMETER EROSION BARRIER (PEB)



USER NAME = \$USER\$	DESIGNED - AS	REVISED -
PLOT SCALE = \$SCALE\$	DRAWN - AS	REVISED -
PLOT DATE = \$DATE\$	CHECKED - ST	REVISED -
	DATE - 06/29/2012	REVISED -

**STATE OF ILLINOIS
DEPARTMENT OF TRANSPORTATION**
I-70 CONNECTION

PROPOSED I-70 EROSION CONTROL STA. 162+00 TO STA. 176+00	
SCALE: 1"=50'	SHEET NO. 3 OF 5 SHEETS STA. TO STA.

F.A.P. R.T.E. 998	SECTION 82-1R	COUNTY ST. CLAIR	TOTAL SHEETS 294	SHEET NO. 60
FED. ROAD DIST. NO.		ILLINOIS FED. AID PROJECT		

\$\$\$\$\$PLT\$\$\$\$\$ 06/29/2012 10:00 AM C:\Users\lin\Documents\Lin\Projects\I70\I70_162_176.dwg \$\$\$\$\$\$