

\ORCD\99-MOTIFL.DGN, \ORCD\98-MOTIFL.DGN, \ORCD\97-MOTIFL.DGN, \ORCD\96-MOTIFL.DGN, \ORCD\95-MOTIFL.DGN, \ORCD\94-MOTIFL.DGN, \ORCD\93-MOTIFL.DGN, \ORCD\92-MOTIFL.DGN, \ORCD\91-MOTIFL.DGN, \ORCD\90-MOTIFL.DGN, \ORCD\89-MOTIFL.DGN, \ORCD\88-MOTIFL.DGN, \ORCD\87-MOTIFL.DGN, \ORCD\86-MOTIFL.DGN, \ORCD\85-MOTIFL.DGN, \ORCD\84-MOTIFL.DGN, \ORCD\83-MOTIFL.DGN, \ORCD\82-MOTIFL.DGN, \ORCD\81-MOTIFL.DGN, \ORCD\80-MOTIFL.DGN, \ORCD\79-MOTIFL.DGN, \ORCD\78-MOTIFL.DGN, \ORCD\77-MOTIFL.DGN, \ORCD\76-MOTIFL.DGN, \ORCD\75-MOTIFL.DGN, \ORCD\74-MOTIFL.DGN, \ORCD\73-MOTIFL.DGN, \ORCD\72-MOTIFL.DGN, \ORCD\71-MOTIFL.DGN, \ORCD\70-MOTIFL.DGN, \ORCD\69-MOTIFL.DGN, \ORCD\68-MOTIFL.DGN, \ORCD\67-MOTIFL.DGN, \ORCD\66-MOTIFL.DGN, \ORCD\65-MOTIFL.DGN, \ORCD\64-MOTIFL.DGN, \ORCD\63-MOTIFL.DGN, \ORCD\62-MOTIFL.DGN, \ORCD\61-MOTIFL.DGN, \ORCD\60-MOTIFL.DGN, \ORCD\59-MOTIFL.DGN, \ORCD\58-MOTIFL.DGN, \ORCD\57-MOTIFL.DGN, \ORCD\56-MOTIFL.DGN, \ORCD\55-MOTIFL.DGN, \ORCD\54-MOTIFL.DGN, \ORCD\53-MOTIFL.DGN, \ORCD\52-MOTIFL.DGN, \ORCD\51-MOTIFL.DGN, \ORCD\50-MOTIFL.DGN, \ORCD\49-MOTIFL.DGN, \ORCD\48-MOTIFL.DGN, \ORCD\47-MOTIFL.DGN, \ORCD\46-MOTIFL.DGN, \ORCD\45-MOTIFL.DGN, \ORCD\44-MOTIFL.DGN, \ORCD\43-MOTIFL.DGN, \ORCD\42-MOTIFL.DGN, \ORCD\41-MOTIFL.DGN, \ORCD\40-MOTIFL.DGN, \ORCD\39-MOTIFL.DGN, \ORCD\38-MOTIFL.DGN, \ORCD\37-MOTIFL.DGN, \ORCD\36-MOTIFL.DGN, \ORCD\35-MOTIFL.DGN, \ORCD\34-MOTIFL.DGN, \ORCD\33-MOTIFL.DGN, \ORCD\32-MOTIFL.DGN, \ORCD\31-MOTIFL.DGN, \ORCD\30-MOTIFL.DGN, \ORCD\29-MOTIFL.DGN, \ORCD\28-MOTIFL.DGN, \ORCD\27-MOTIFL.DGN, \ORCD\26-MOTIFL.DGN, \ORCD\25-MOTIFL.DGN, \ORCD\24-MOTIFL.DGN, \ORCD\23-MOTIFL.DGN, \ORCD\22-MOTIFL.DGN, \ORCD\21-MOTIFL.DGN, \ORCD\20-MOTIFL.DGN, \ORCD\19-MOTIFL.DGN, \ORCD\18-MOTIFL.DGN, \ORCD\17-MOTIFL.DGN, \ORCD\16-MOTIFL.DGN, \ORCD\15-MOTIFL.DGN, \ORCD\14-MOTIFL.DGN, \ORCD\13-MOTIFL.DGN, \ORCD\12-MOTIFL.DGN, \ORCD\11-MOTIFL.DGN, \ORCD\10-MOTIFL.DGN, \ORCD\9-MOTIFL.DGN, \ORCD\8-MOTIFL.DGN, \ORCD\7-MOTIFL.DGN, \ORCD\6-MOTIFL.DGN, \ORCD\5-MOTIFL.DGN, \ORCD\4-MOTIFL.DGN, \ORCD\3-MOTIFL.DGN, \ORCD\2-MOTIFL.DGN, \ORCD\1-MOTIFL.DGN, \ORCD\0-MOTIFL.DGN

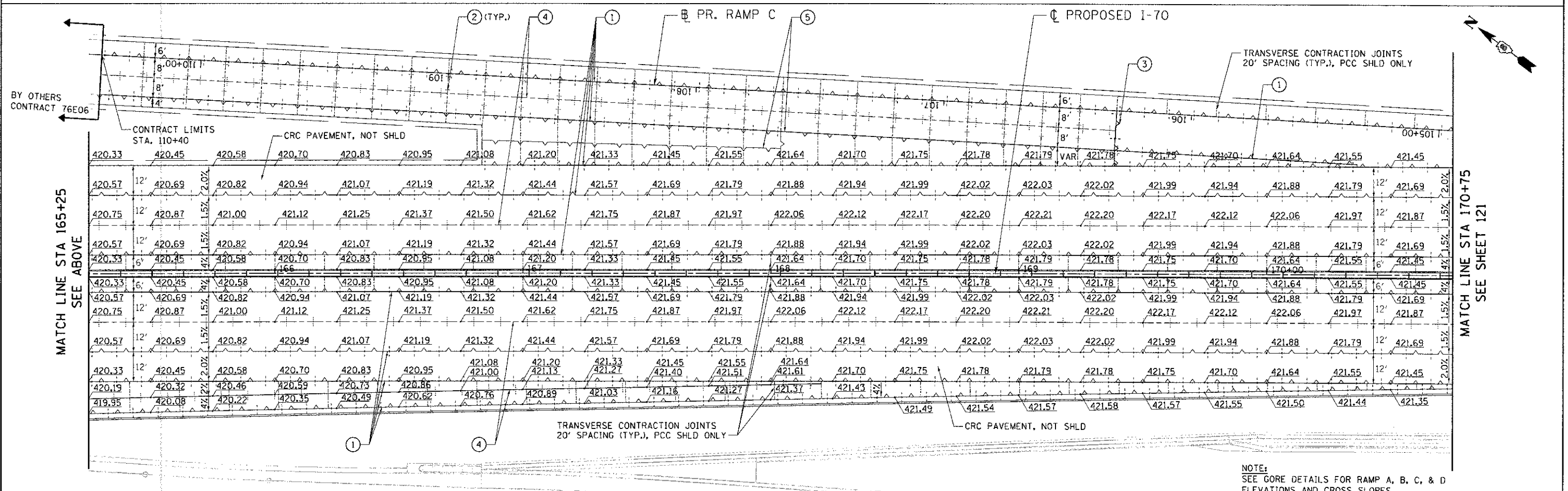
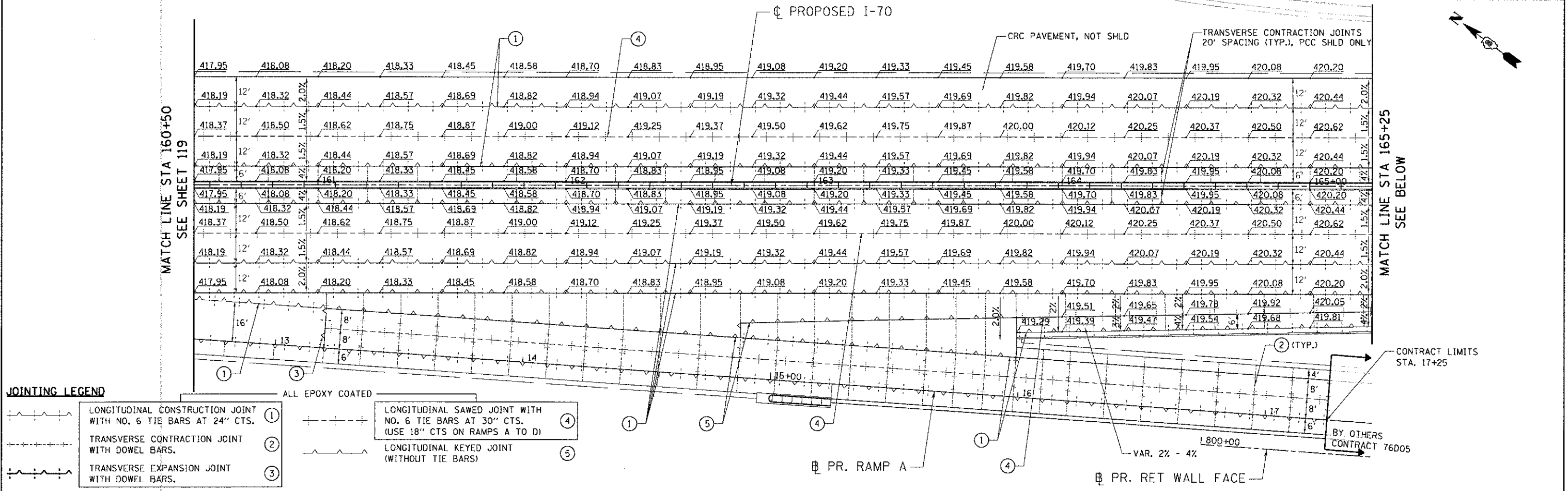

FILE NAME =	USER NAME = #USER#	DESIGNED - JB	REVISED -	<b>STATE OF ILLINOIS</b> <b>DEPARTMENT OF TRANSPORTATION</b> I-70 CONNECTION	<b>I-70 PAVEMENT ELEVATION PLANS</b> <b>STA. 160+50 TO STA. 170+75</b>		F.A.P. RTE. 998	SECTION 82-1R	COUNTY ST. CLAIR	TOTAL SHEETS 294	SHEET NO. 120	
#FILEL#	PLOT SCALE = #SCALE#	DRAWN - MDN	REVISED -		SCALE: 1"=20'	SHEET NO. 3 OF 5 SHEETS	STA.	TO STA.	FED. ROAD DIST. NO.	ILLINOIS FED. AID PROJECT	CONTRACT NO. 76C43	
	PLOT DATE = #DATE#	CHECKED - ACL	REVISED -									
		DATE - 06/29/12	REVISED -									