

KEY MAP

GORE DETAILS

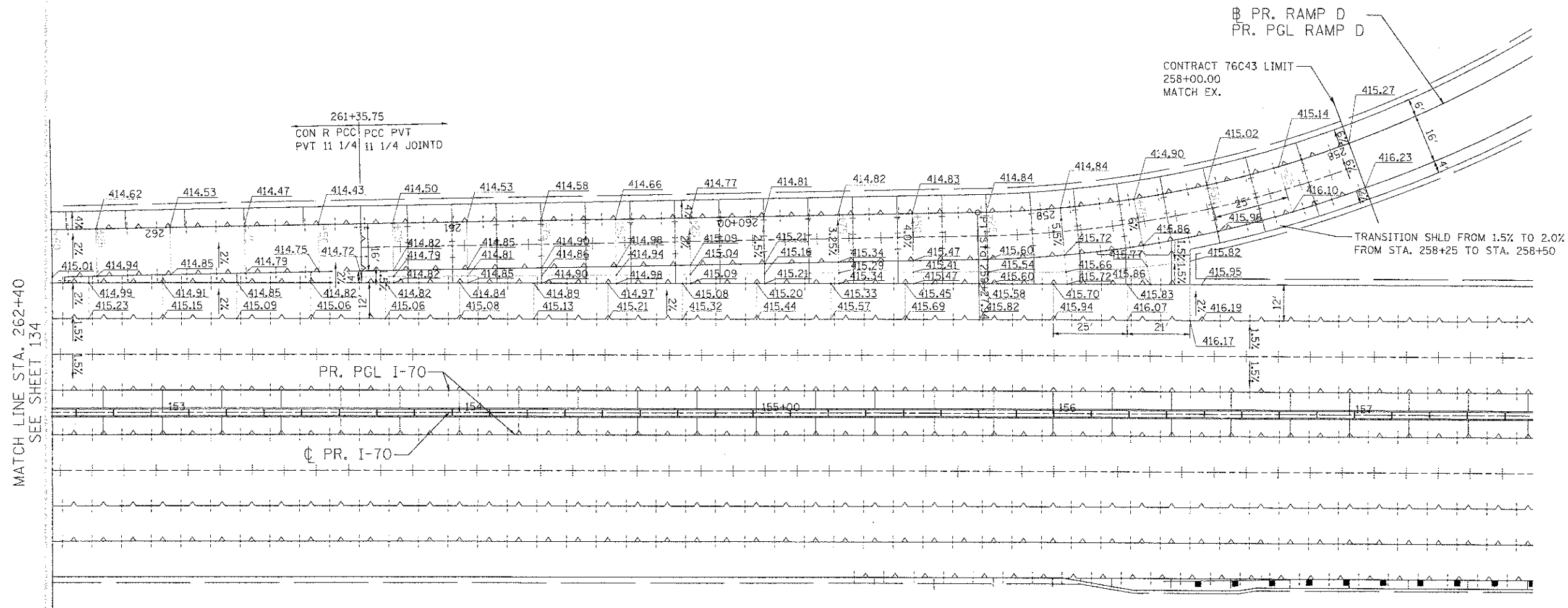
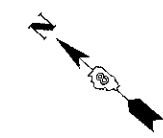
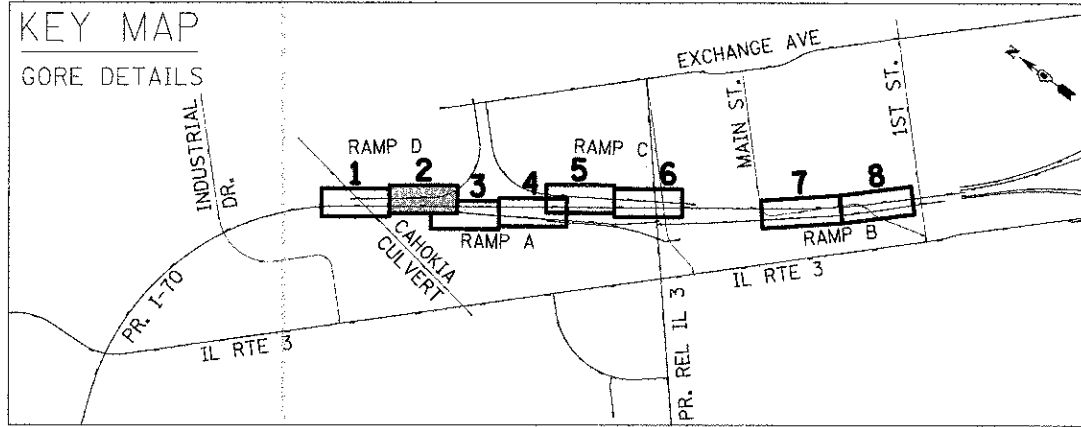

JOINTING LEGEND

	LONGITUDINAL CONSTRUCTION JOINT WITH NO. 6 TIE BARS AT 24" CTS. (1)		LONGITUDINAL SAWED JOINT WITH NO. 6 TIE BARS AT 30" CTS. (USE 18" CTS ON RAMPS A TO D) (4)
	TRANSVERSE CONTRACTION JOINT WITH DOWEL BARS. (2)		LONGITUDINAL KEYED JOINT (WITHOUT TIE BARS) (5)
	TRANSVERSE EXPANSION JOINT WITH DOWEL BARS. (3)		



USER NAME = #USER#	DESIGNED - SEW	REVISED -
PLOT SCALE = #SCALE#	DRAWN - SEW	REVISED -
PLOT DATE = #DATE#	CHECKED - ST	REVISED -
	DATE - 06/29/2012	REVISED -

STATE OF ILLINOIS
DEPARTMENT OF TRANSPORTATION
I-70 CONNECTION

PROPOSED I-70 AND RAMP D
GORE DETAILS
SCALE: 1"=20'
SHEET NO. 2 OF 8 SHEETS
STA. 262+40 TO STA. 258+00

F.A.P. RTE. 998	SECTION 82-1R	COUNTY ST. CLAIR	TOTAL SHEETS 294	SHEET NO. 135
CONTRACT NO. 76C43				
FED. ROAD DIST. NO. [ILLINOIS] FED. AID PROJECT				