

MATCH LINE STA 98+50
 NB I-55 SEE BELOW

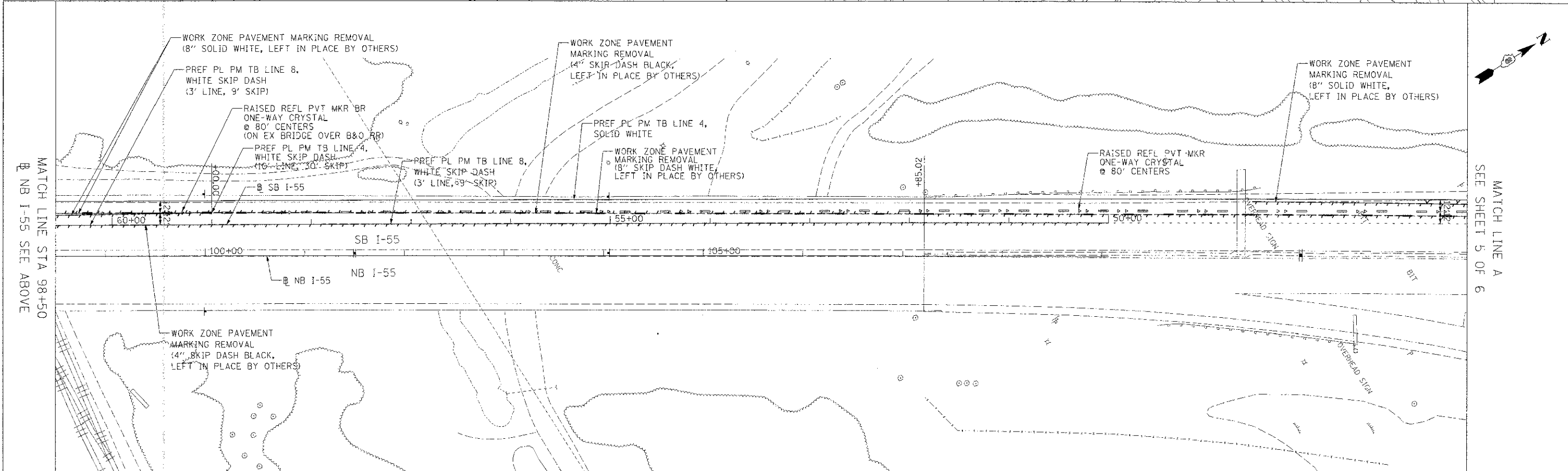

MATCH LINE STA 98+50
 NB I-55 SEE ABOVE

MATCH LINE A
 SEE SHEET 5 OF 6

FILE NAME DBTAI-76C43-SHT-1PK-04.dgn	USER NAME PLS	DESIGNED OP	REVISIONS -	STATE OF ILLINOIS DEPARTMENT OF TRANSPORTATION	PROPOSED PAVEMENT MARKING PLANS		F.A.P. 1 RTE. 998	SECTION 82-1R	COUNTY ST. CLAIR	TOTAL SHEETS 294	SHEET NO. 152
SCALE: 1"=50'	SHEET NO. 4 OF 6 SHEETS	STA.	TO STA.		FED. ROAD DIST. NO.	ILLINOIS FED. AID PROJECT	CONTRACT NO. 76C43				
PLT SCALE = 1/8" = 1'-0"	CHECKED DDM	DATE 06/29/12	REVISIONS -								
PLT DATE = 6/27/2012											