

09-21-2012 LETTING ITEM 031

STATE OF ILLINOIS  
DEPARTMENT OF TRANSPORTATION  
DIVISION OF HIGHWAYS

**PROPOSED  
HIGHWAY PLANS**

FAS ROUTE 733 (US 67)  
SECTION (62,48)RS-3,50RS-2  
PROJECT ACNHR5-0733(112)  
3P - RESURFACING  
GREENE COUNTY

FOR INDEX OF SHEETS, SEE SHEET NO. 2

F.A.S. RTE.	SECTION	COUNTY	TOTAL SHEETS	SHEET NO.
733	62,48RS-3,50RS-2	GREENE	16	1
		ILLINOIS	CONTRACT NO. 76F25	

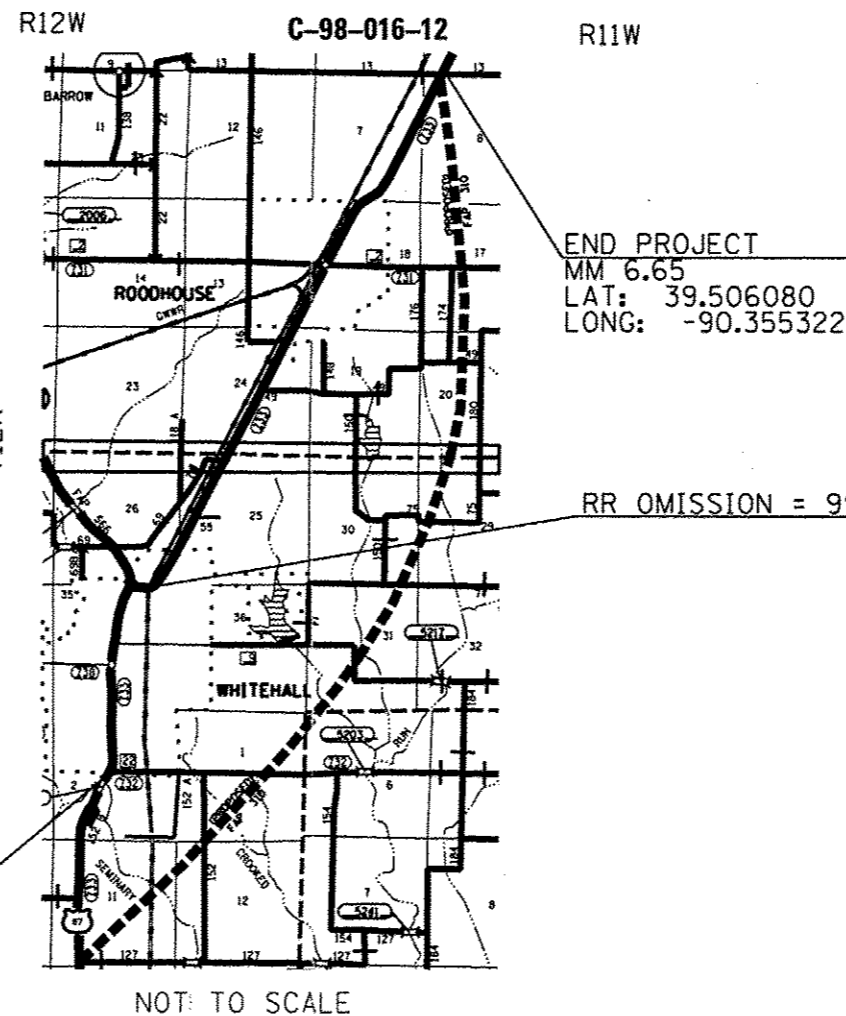

INDEX OF SHEETS

- 1 COVER SHEET
- 2 INDEX OF SHEETS, HIGHWAY STANDARDS, ADT, GENERAL NOTES, COMMITMENTS
- 3-4 SUMMARY OF QUANTITIES
- 5-8 TYPICAL SECTIONS
- 9 SCHEDULES OF QUANTITIES
- 10-11 LINE DIAGRAM
- 12 MILLING & PAVING DETAILS
- 13-15 STRIPING DETAILS
- 16 CULVERT REPLACEMENT DETAIL

HIGHWAY STANDARDS

- 000001-06
- 280001-06
- 442201-03
- 542406-01
- 701011-02
- 701201-04
- 701301-04
- 701306-03
- 701311-03
- 701336-06
- 701501-06
- 701901-02
- 780001-03
- 781001-03

ADT

McCarthy Ave. to Carlinville St.  
 2011 ADT = 4350 (Actual)  
 2013 ADT = 4400 (Estimated)  
 2033 ADT = 5400 (Estimated)  
 SU = 4.1% MU = 4.4%

Carlinville St. to Lincoln St.  
 2011 ADT = 8500 (Actual)  
 2013 ADT = 8700 (Estimated)  
 2011 ADT = 10600 (Estimated)  
 SU = 3.5% MU = 1.8%

Lincoln St. to IL 106/N. Main St.  
 2011 ADT = 7750 (Actual)  
 2013 ADT = 7900 (Estimated)  
 2033 ADT = 9600 (Estimated)  
 SU = 3.7% MU = 1.3%

IL 106/N. Main St. to CH 2/Palm St.  
 2011 ADT = 6200 (Actual)  
 2013 ADT = 6300 (Estimated)  
 2033 ADT = 7700 (Estimated)  
 SU = 2.6% MU = 2.6%

CH 2/Palm St. to TR 13  
 2011 ADT = 4100 (Actual)  
 2013 ADT = 4200 (Estimated)  
 2033 ADT = 5100 (Estimated)  
 SU = 2.4% MU = 3.9%

IL 106  
 2009 ADT = 1000 (Actual)  
 SU = 3% MU = 8%

GENERAL NOTES

1. ILLINOIS STATE LAW REQUIRES A 48-HOUR NOTICE TO BE GIVEN TO ALL UTILITIES BEFORE DIGGING. FIELD MARKING OF FACILITIES MAY BE OBTAINED BY CONTACTING J.U.L.I.E. OR FOR NON-MEMBERS, THE UTILITY COMPANY DIRECTLY. AGENCIES KNOWN TO HAVE FACILITIES WITHIN THE PROJECT AREA ARE AS FOLLOWS:
  - AMEREN ILLINOIS (GAS & ELECTRIC)
  - FRONTIER NORTH, INC. (COMMUNICATIONS)
  - GREENE COUNTY PARTNERS, INC. (CABLE TV)
  - ILLINOIS RURAL ELECTRIC COOPERATIVE (ELECTRIC)
  - VILLAGE OF MANCHESTER (WATER)
  - CITY OF ROODHOUSE (WATER & SANITARY SEWER)
  - CITY OF ROODHOUSE (GAS & ELECTRIC)
  - CITY OF WHITE HALL (GAS)
  - CITY OF WHITE HALL (WATER & SANITARY SEWER)

MEMBERS OF J.U.L.I.E. (800)892-0123 ARE INDICATED BY \*.  
 NON-J.U.L.I.E. MEMBERS MUST BE NOTIFIED INDIVIDUALLY.
2. THE STANDARDS AND REVISION NUMBERS LISTED SHALL APPLY TO THIS PROJECT.
3. THE THICKNESS OF THE BITUMINOUS MIXTURE SHOWN ON THE PLANS IS THE NOMINAL THICKNESS. DEVIATIONS FROM THE NOMINAL THICKNESS WILL BE PERMITTED WHEN SUCH DEVIATIONS OCCUR DUE TO IRREGULARITIES IN THE EXISTING SURFACE OR BASE ON WHICH THE BITUMINOUS MIXTURE IS PLACED.
4. NO OVERNIGHT LANE CLOSURES SHALL BE ALLOWED ON THE PROJECT.
5. CARE SHALL BE TAKEN AT ALL SIDE STREETS AND ENTRANCES DURING MILLING OPERATIONS TO ENSURE THAT THE PROPOSED RESURFACING WILL MEET THE EXISTING SIDE STREETS AND ENTRANCES.
6. THE RESIDENT ENGINEER SHALL VERIFY THE EXISTENCE OF HIGHWAY LIGHTING AND/OR ITS UTILITIES WITHIN THE PROJECT LIMITS. IF HIGHWAY LIGHTING AND/OR ITS EXISTS WITHIN THE PROJECT LIMITS, AND IF THESE ITEMS REQUIRE LOCATING, THE CONTRACTOR SHALL BE DIRECTED TO DO SO ACCORDING TO SECTION 803 OF THE STANDARD SPECIFICATIONS. IF LOCATING UNDERGROUND CABLE IS NOT INCLUDED AS PART OF THE PLANS, THIS WORK SHALL BE PAID FOR ACCORDING TO ARTICLE 109.04 OF THE STANDARD SPECIFICATIONS.
7. EXCESS BITUMEN REMOVAL SHALL BE PAID FOR ACCORDING TO ARTICLE 109.04 OF THE STANDARD SPECIFICATIONS.
8. THE CONTRACTOR AND THE ENGINEER SHALL BE AWARE THAT NO SURVEY WAS PERFORMED FOR THIS PROJECT. THE STATIONING AND TOPO SHOWN IN THE PLANS WAS CREATED USING MICROFILM AND FIELD MEASUREMENTS MADE BY DESIGN PERSONNEL. BOTH SHALL BE ASSUMED TO BE APPROXIMATE.
9. THE CONTRACTOR SHALL BE AWARE THAT THERE ARE MANHOLES AND VALVES LOCATED WITHIN THE RESURFACING LIMITS. CARE SHALL BE TAKEN IN THESE LOCATIONS DURING MILLING OPERATIONS.
10. THE CONTRACTOR SHALL VERIFY ALL DIMENSIONS AND CONDITIONS IN THE FIELD PRIOR TO CONSTRUCTION AND ORDERING OF MATERIALS.
11. "ROAD CONSTRUCTION AHEAD" SIGNS SHALL BE PLACED AT EACH END OF THE PROJECT PLUS THE INTERSECTING SIDE ROADS, AND WILL BE INCLUDED IN THE TRAFFIC CONTROL PAY ITEMS. ALL CONSTRUCTION SIGNS SHALL BE FLUORESCENT ORANGE, 48 X 48.

12. THE PAVEMENT MARKINGS SHOWN IN THE PLANS ARE APPROXIMATE. THE LOCATION OF THE PROPOSED CROSSWALKS AND STOP BARS SHALL MATCH EXISTING FIELD CONDITIONS. RAILROAD CROSSING STRIPING SHOULD BE AS SHOWN IN THE PLAN DETAIL.
13. SHORT-TERM PAVEMENT MARKING SHALL BE APPLIED TO THE MILLED, PRIMED, AND FINAL HMA SURFACE. ONLY THE REMOVAL OF THE FINAL SURFACE APPLICATION SHALL BE PAID FOR AS WORK ZONE PAVEMENT MARKING REMOVAL - SQ FT. A QUANTITY FOR TEMPORARY PAVEMENT MARKING EQUAL TO THE AMOUNT OF PERMANENT PAVEMENT MARKING HAS BEEN ADDED TO THE PLANS.
14. ALL TEMPORARY PAVEMENT MARKINGS WILL BE PLACED IN SUCH A MANNER SO AS NOT TO INTERFERE WITH THE PLACEMENT OF PERMANENT PAVEMENT MARKINGS.
15. THE FOLLOWING MIXTURE REQUIREMENTS ARE APPLICABLE FOR THIS PROJECT:

MIXTURE USE	SURFACE	LEVEL BINDER	PATCHING
AC/PG	PG 64-22	PG 64-22	PG 64-22
RAP % (MAX)	SEE SPEC.	SEE SPEC.	SEE SPEC.
DESIGN AIR VOIDS	4.0% @ Ndes=70	4.0% @ Ndes=70	4.0% @ Ndes=70
MIX COMPOSITION			
(GRADATION MIXTURE)	IL 12.5/9.5	IL 9.5	IL 19.0
FRICITION AGG	MIXTURE "D"	MIXTURE "C"	MIXTURE "B"

SHOULDERS ≥ 2.25'	SHOULDERS < 2.25'	INCIDENTAL SURF
PG 64-22	PG 64-22	PG 64-22
See Contract RAP Special Provision	See Contract RAP Special Provision	SEE SPEC.
**2.0% @ Ndes=30	**2.0% @ Ndes=30	4.0% @ Ndes=70
NMAS 3/4"	NMAS 1/2"	
		MIXTURE "D"

\*\*TOP LIFT SHOULDERS - DESIGN THIS MIX AT 2.0% VOIDS AND ADD ASPHALT TO REDUCE VOIDS TO 1.5%.

PLAN QUANTITIES FOR HMA SURFACE COURSE ITEMS ARE CALCULATED USING A UNIT WEIGHT OF 112 LB/SQ YD/IN (59.8 KG/SQ M/25 MM THICKNESS).

COMMITMENTS

NONE

# SUMMARY OF QUANTITIES

SUMMARY OF QUANTITIES			TOTAL QUANTITIES	CONSTRUCTION TYPE CODE		
CODE NO	ITEM	UNIT		0005 80% FED 20% STATE	0005 50% CITY WHITE HALL 50% STATE	0005 50% CITY ROODHOUSE 50% STATE
20200600	EXCAVATING AND GRADING EXISTING SHOULDER	UNIT	429	429		
20800150	TRENCH BACKFILL	CU YD	6	6		
28000400	PERIMETER EROSION BARRIER	FOOT	25	25		
28000500	INLET AND PIPE PROTECTION	EACH	1	1		
40600200	BITUMINOUS MATERIALS (PRIME COAT)	TON	70	60	5.3	4.7
40600300	AGGREGATE (PRIME COAT)	TON	338	291	25	22
40600635	LEVELING BINDER (MACHINE METHOD), N70	TON	4668	4024	330	314
40600990	TEMPORARY RAMP	SQ YD	1637	1637		
40603340	HOT-MIX ASPHALT SURFACE COURSE, MIX "D", N70	TON	9865	8531	706	628
44000158	HOT-MIX ASPHALT SURFACE REMOVAL, 2 1/4"	SQ YD	112684	96815	8395	7474
44200156	PAVEMENT PATCHING, TYPE II, 13"	SQ YD	60	60		
44200162	PAVEMENT PATCHING, TYPE IV, 13"	SQ YD	32	32		
48102100	AGGREGATE WEDGE SHOULDER, TYPE B	TON	586	586		

SUMMARY OF QUANTITIES			TOTAL QUANTITIES	CONSTRUCTION TYPE CODE		
CODE NO	ITEM	UNIT		0005 80% FED 20% STATE	0005 50% CITY WHITE HALL 50% STATE	0005 50% CITY ROODHOUSE 50% STATE
48203100	HOT-MIX ASPHALT SHOULDERS	TON	89	89		
50105220	PIPE CULVERT REMOVAL	FOOT	56	56		
54215763	METAL END SECTIONS, EQUIVALENT ROUND-SIZE 18"	EACH	2	2		
542D5473	PIPE CULVERTS, CLASS D, TYPE 1 EQUIVALENT ROUND-SIZE 18"	FOOT	66	66		
67000400	ENGINEER'S FIELD OFFICE, TYPE A	CAL MO	9	9		
67100100	MOBILIZATION	L SUM	1	1		
70100450	TRAFFIC CONTROL AND PROTECTION, STANDARD 701201	L SUM	1	1		
70100460	TRAFFIC CONTROL AND PROTECTION, STANDARD 701306	L SUM	1	1		
70100600	TRAFFIC CONTROL AND PROTECTION, STANDARD 701336	L SUM	1	1		
70102620	TRAFFIC CONTROL AND PROTECTION, STANDARD 701501	L SUM	1	1		
70300100	SHORT TERM PAVEMENT MARKING	FOOT	9684	9684		

FILE NAME :	USER NAME : conoverpj	DESIGNED -	REVISED -	<b>STATE OF ILLINOIS DEPARTMENT OF TRANSPORTATION</b>	<b>SUMMARY OF QUANTITIES</b>			F.A.S. RTE.	SECTION	COUNTY	TOTAL SHEETS	SHEET NO.
		DRAWN -	REVISED -					733	62,48RS-3,50RS-2	GREENE	16	3
		CHECKED -	REVISED -									
		DATE -	REVISED -									
	PLOT SCALE : 100.0000' / 1"											
	PLOT DATE : 6/29/2012											
							SCALE:	SHEET NO. 1 OF 2 SHEETS	STA.	TO STA.	FED. ROAD DIST. NO. ILLINOIS FED. AID PROJECT	
											CONTRACT NO. 76F25	

# SUMMARY OF QUANTITIES

SUMMARY OF QUANTITIES			TOTAL QUANTITIES	CONSTRUCTION TYPE CODE			SUMMARY OF QUANTITIES			TOTAL QUANTITIES	CONSTRUCTION TYPE CODE		
CODE NO	ITEM	UNIT		0005 80% FED 20% STATE	0005 50% CITY WHITE HALL 50% STATE	0005 50% CITY ROODHOUSE 50% STATE	CODE NO	ITEM	UNIT				
70300210	TEMPORARY PAVEMENT MARKING LETTERS AND SYMBOLS	SQ FT	123	123		Z0048665	RAILROAD PROTECTIVE LIABILITY INSURANCE	L SUM	1	1			
70300220	TEMPORARY PAVEMENT MARKING - LINE 4"	FOOT	93232	93232		+Z0076600	TRAINEES	HOUR	1,000	1,000			
70300260	TEMPORARY PAVEMENT MARKING - LINE 12"	FOOT	982	982		+Z0076604	TRAINEES TRAINING PROGRAM GRADUATE	HOUR	1,000	1,000			
70300280	TEMPORARY PAVEMENT MARKING - LINE 24"	FOOT	224	224									
70301000	WORK ZONE PAVEMENT MARKING REMOVAL	SQ FT	1076	1076									
*78000100	THERMOPLASTIC PAVEMENT MARKING - LETTERS AND SYMBOLS	SQ FT	123	123									
*78000200	THERMOPLASTIC PAVEMENT MARKING - LINE 4"	FOOT	93232	93232									
*78000600	THERMOPLASTIC PAVEMENT MARKING - LINE 12"	FOOT	982	982									
*78000650	THERMOPLASTIC PAVEMENT MARKING - LINE 24"	FOOT	224	224									
*78100100	RAISED REFLECTIVE PAVEMENT MARKER	EACH	444	444									
78300200	RAISED REFLECTIVE PAVEMENT MARKER REMOVAL	EACH	444	444									

\*SPECIALTY ITEM

+0042

FILE NAME :	USER NAME : c:\pwwork\pwwork\conoverpj\d8288278\d8288278.dgn	DESIGNED -	REVISED -	<b>STATE OF ILLINOIS DEPARTMENT OF TRANSPORTATION</b>	<b>SUMMARY OF QUANTITIES</b>	F.A.S. RTE.	SECTION	COUNTY	TOTAL SHEETS	SHEET NO.
		DRAWN -	REVISED -			733	(62,40RS-3,50RS-2	GREENE	16	4
	PLOT SCALE : 1/8"=1'-0"	CHECKED -	REVISED -							
	PLOT DATE : 6/29/2012	DATE -	REVISED -							
						SCALE:	SHEET NO. 2 OF 2 SHEETS	STA.	TO STA.	FED. ROAD DIST. NO. [ILLINOIS] FED. AID PROJECT
										CONTRACT NO. 76F25

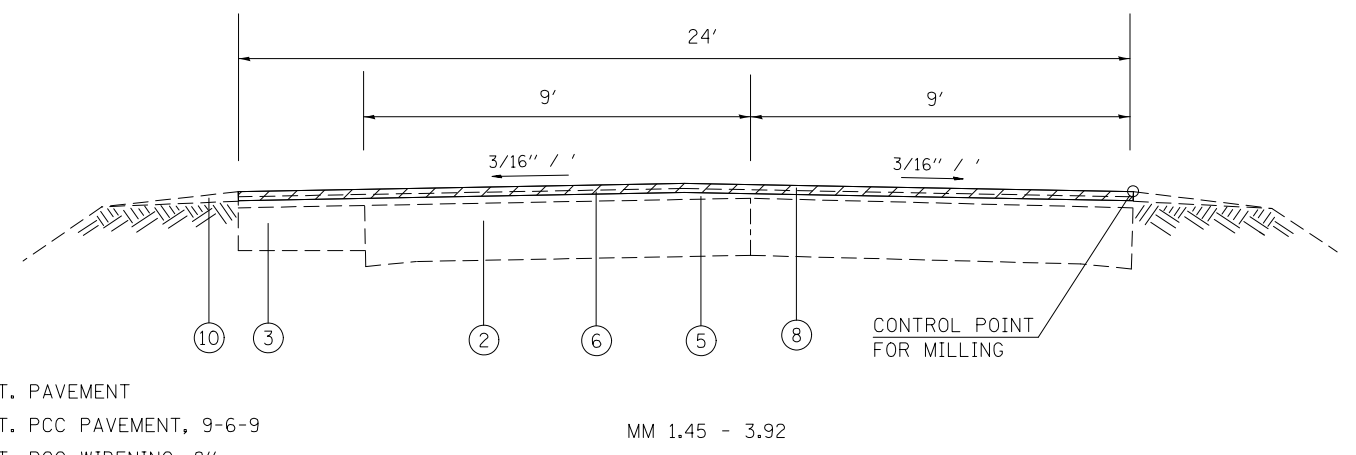
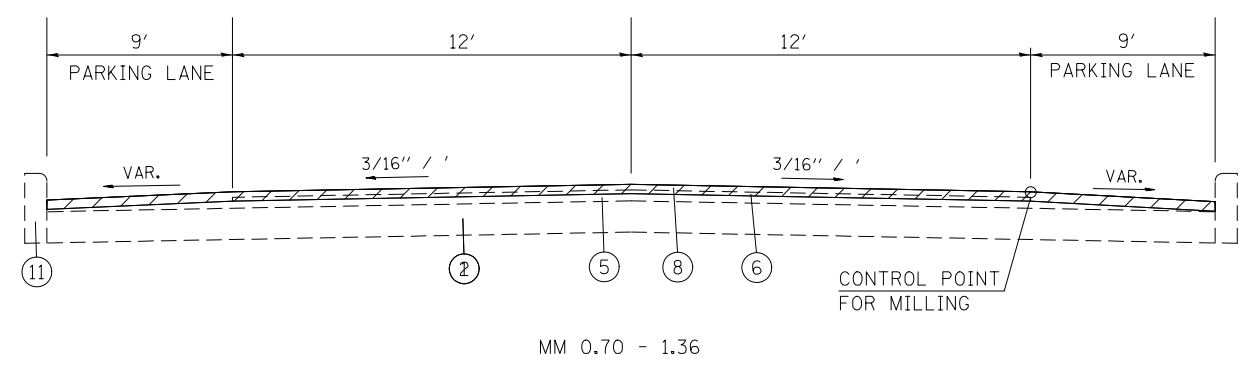
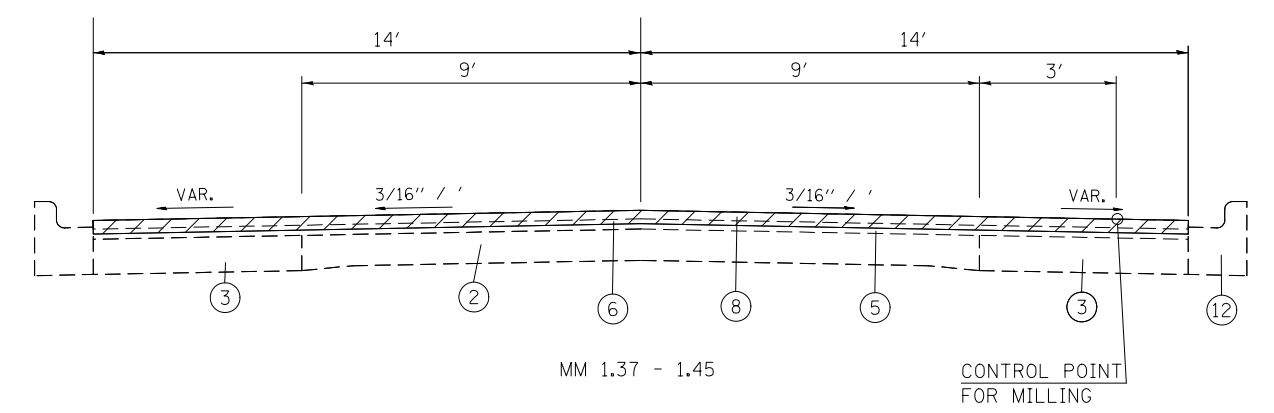
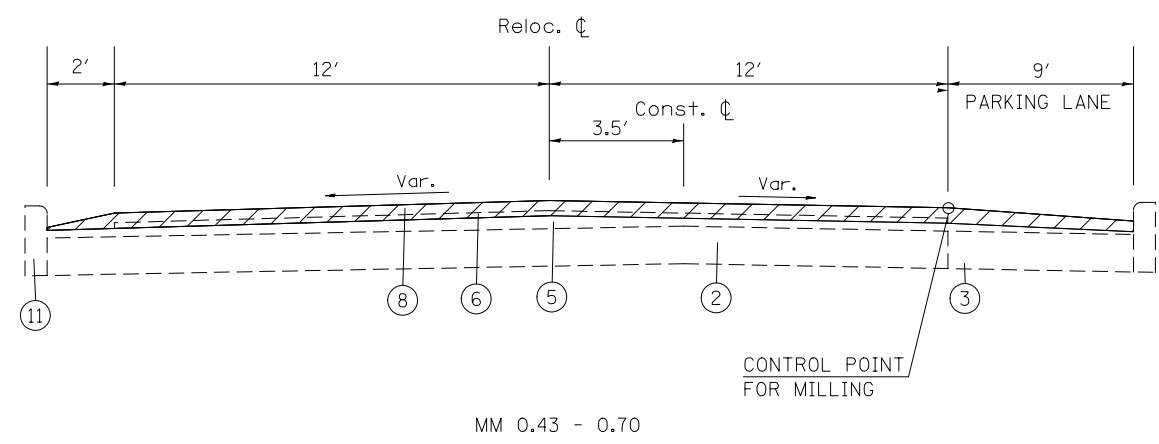
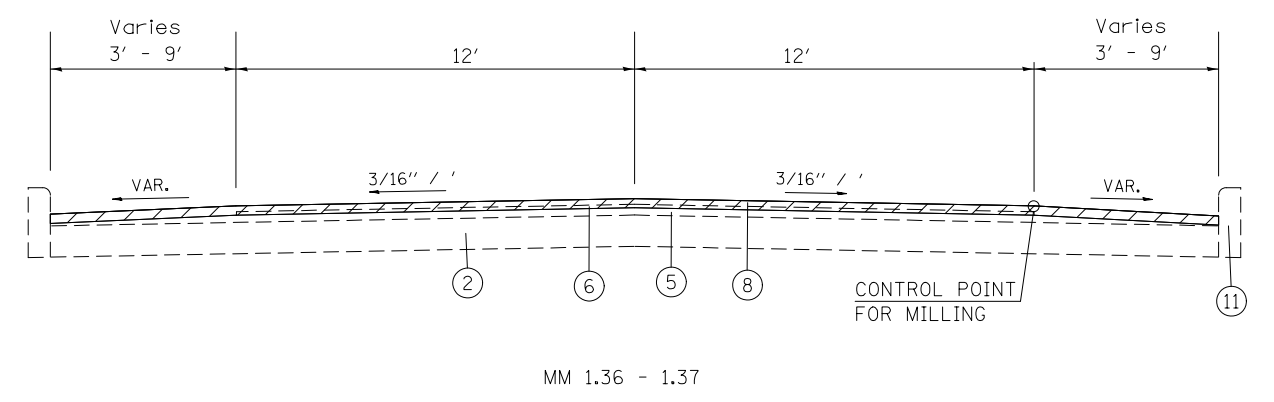
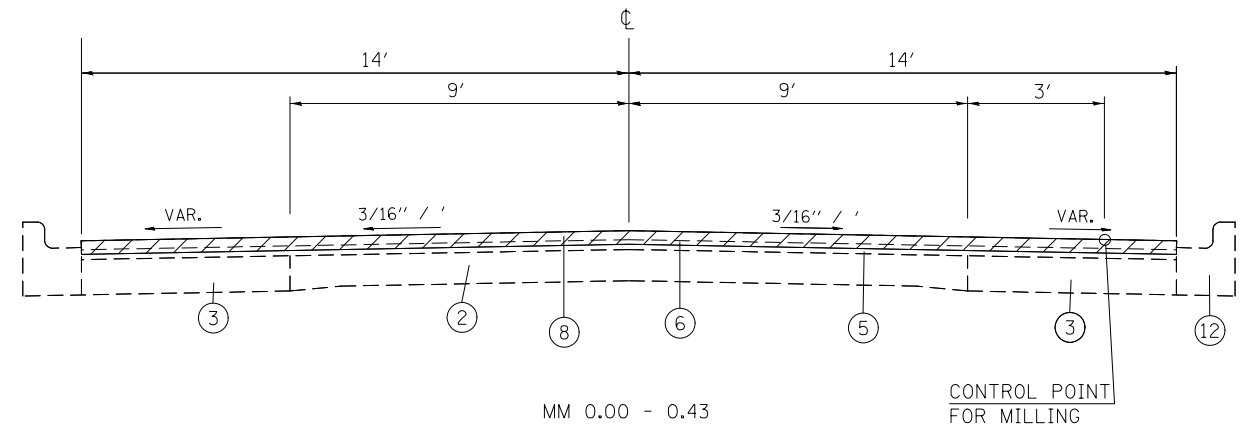

HMA SURFACE REMOVAL 2 1/4"

- ① EXIST. PAVEMENT
- ② EXIST. PCC PAVEMENT, 9-6-9
- ③ EXIST. PCC WIDENING, 8"
- ④ EXIST. BASE COURSE WIDENING, 9"
- ⑤ EXIST. HMA SURFACE - VAR. DEPTH
- ⑥ EXIST. LEVELING BINDER (MM), MIX C, TY 2 - 0.75"
- ⑦ EXIST. STRIP REFLECTIVE CRACK CONTROL TREATMENT
- ⑧ EXIST. HMA SURFACE COURSE, MIX D, CL I, TY 2 - 1.5"
- ⑨ EXIST. HMA SHOULDER
- ⑩ EXIST. AGG SHOULDER
- ⑪ EXIST. CONCRETE CURB
- ⑫ EXIST. CCC&G, TYPE B-6.12

FILE NAME =	USER NAME = conoverpj	DESIGNED -	REVISED -
et:\pwork\pwork\conoverpj\d0280278\d076f25-sht-plan2.dgn		DRAWN -	REVISED -
	PLOT SCALE = 100.0000' / in.	CHECKED -	REVISED -
	PLOT DATE = 6/29/2012	DATE -	REVISED -

**STATE OF ILLINOIS  
DEPARTMENT OF TRANSPORTATION**

**EXISTING TYPICAL SECTIONS**

SCALE: SHEET NO. 1 OF 2 SHEETS STA. TO STA.

F.A.S. RTE.	SECTION	COUNTY	TOTAL SHEETS	SHEET NO.
733	(62,48)RS-3,5ORS-2	GREENE	16	5
CONTRACT NO. 76F25				
FED. ROAD DIST. NO.	ILLINOIS	FED. AID PROJECT		

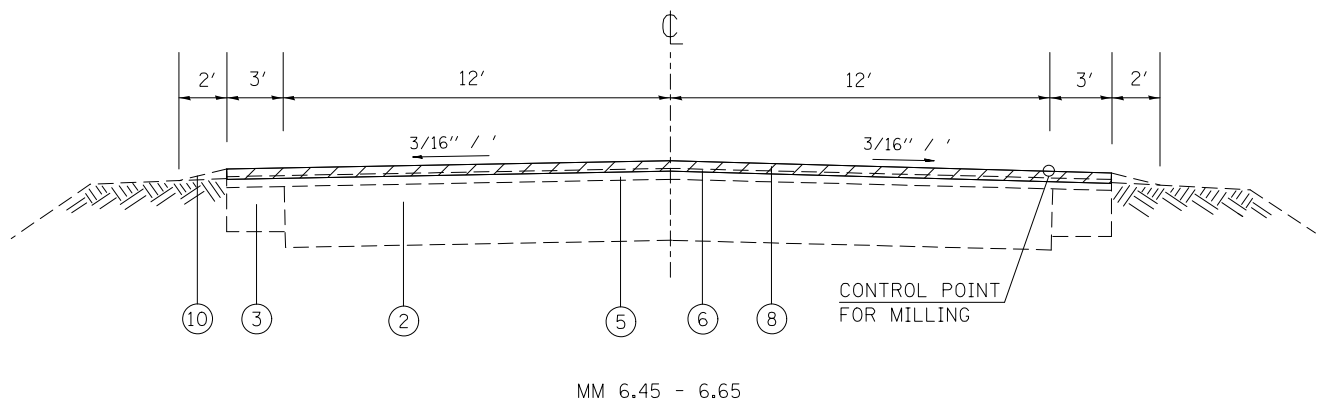
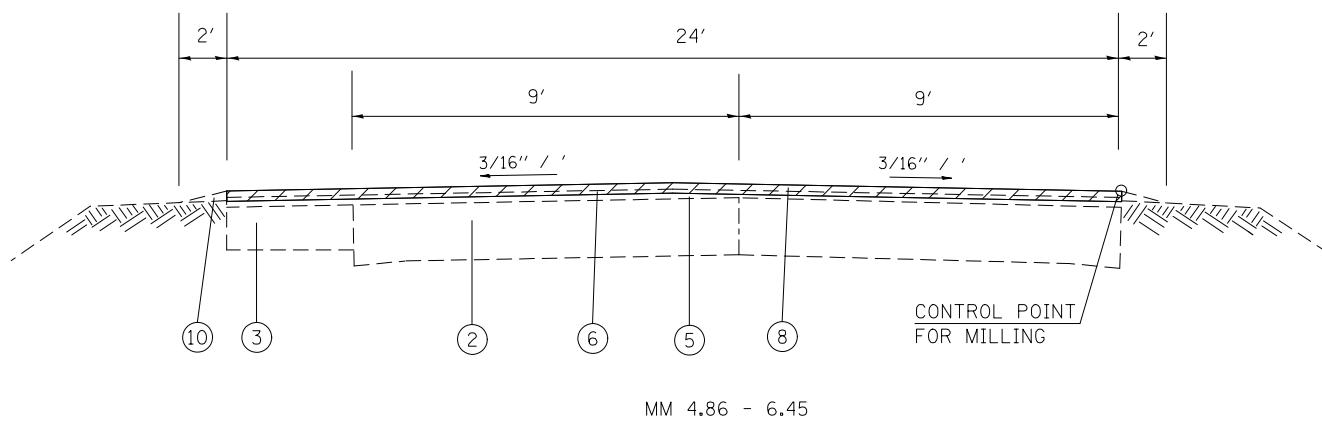
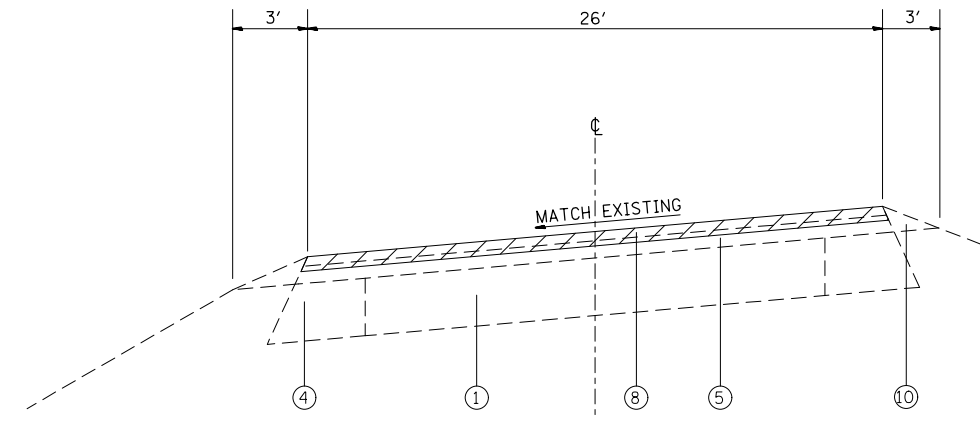
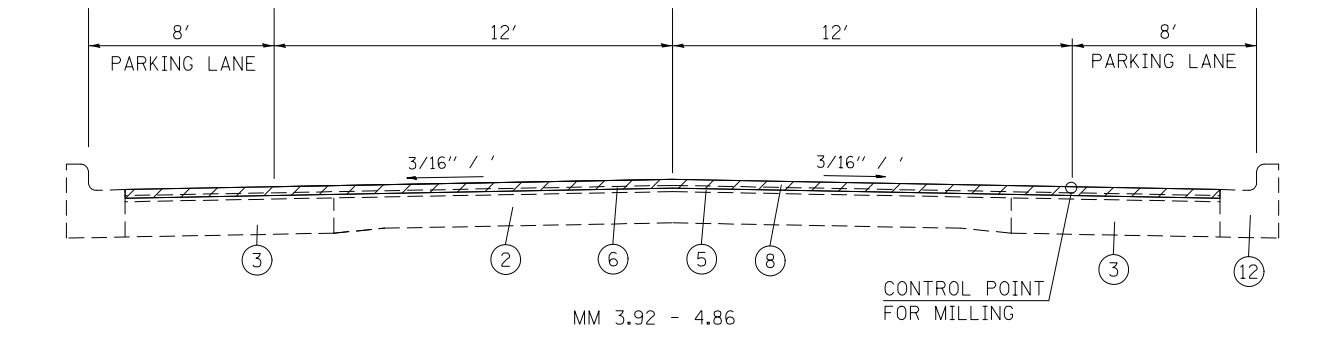

- ① EXIST. PAVEMENT
- ② EXIST. PCC PAVEMENT, 9-6-9
- ③ EXIST. PCC WIDENING, 8"
- ④ EXIST. BASE COURSE WIDENING, 9"
- ⑤ EXIST. HMA SURFACE - VAR. DEPTH
- ⑥ EXIST. LEVELING BINDER (MM), MIX C, TY 2 - 0.75"
- ⑦ EXIST. STRIP REFLECTIVE CRACK CONTROL TREATMENT
- ⑧ EXIST. HMA SURFACE COURSE, MIX D, CL I, TY 2 - 1.5"
- ⑨ EXIST. HMA SHOULDER
- ⑩ EXIST. AGG SHOULDER
- ⑪ EXIST. CONCRETE CURB
- ⑫ EXIST. CCC&G, TYPE B-6.12

HMA SURFACE REMOVAL 2 1/4"

FILE NAME =	USER NAME = conoverpj	DESIGNED -	REVISED -	<b>STATE OF ILLINOIS DEPARTMENT OF TRANSPORTATION</b>	<b>EXISTING TYPICAL SECTIONS</b>			F.A.S. RTE.	SECTION	COUNTY	TOTAL SHEETS	SHEET NO.	
	et:\pwork\pwork\conoverpj\d0280278\d076f25-sht-plan2.dgn	DRAWN -	REVISED -		SCALE:	SHEET NO. 2 OF 2 SHEETS	STA.	TO STA.	733	(62,48)RS-3,5ORS-2	GREENE	16	6
	PLOT SCALE = 100.0000' / 1in.	CHECKED -	REVISED -					CONTRACT NO. 76F25					
	PLOT DATE = 6/29/2012	DATE -	REVISED -					FED. ROAD DIST. NO. ILLINOIS FED. AID PROJECT					

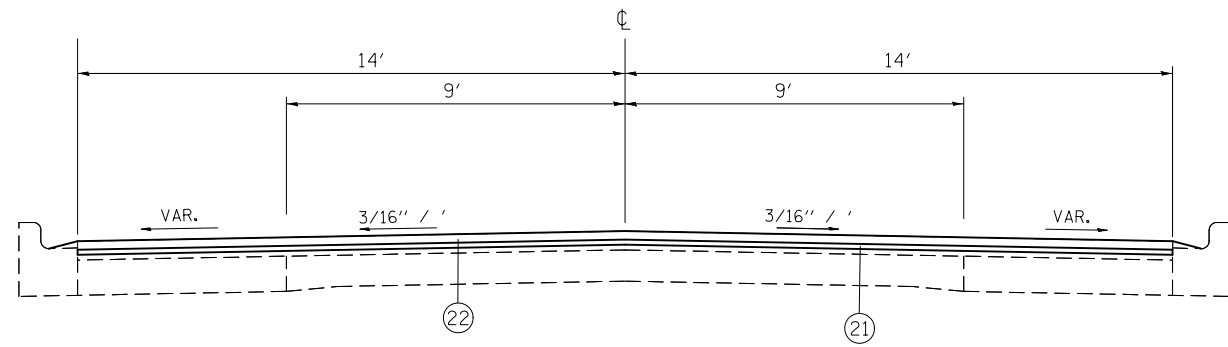

MM 0.00 - 0.43

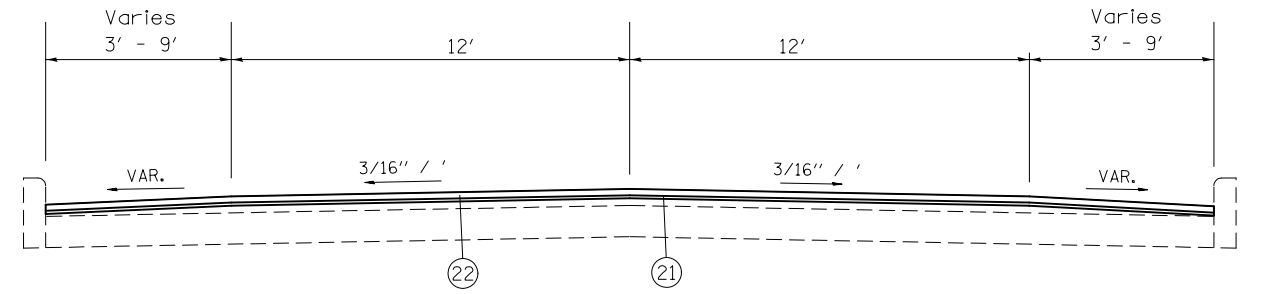

MM 1.36 - 1.37

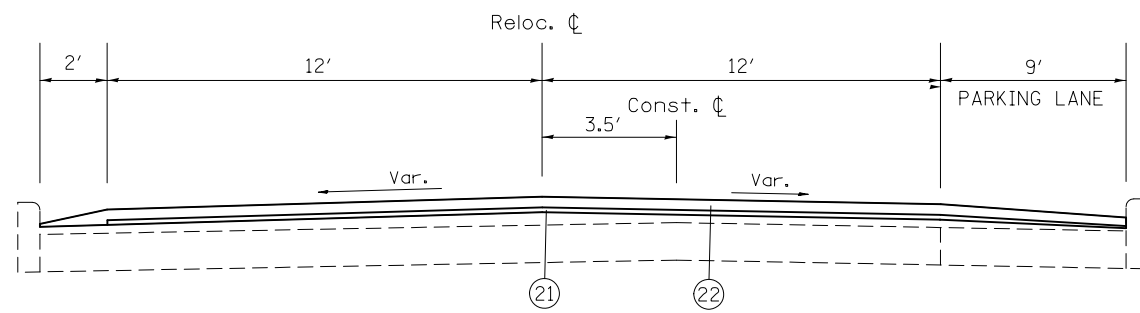

MM 0.43 - 0.70

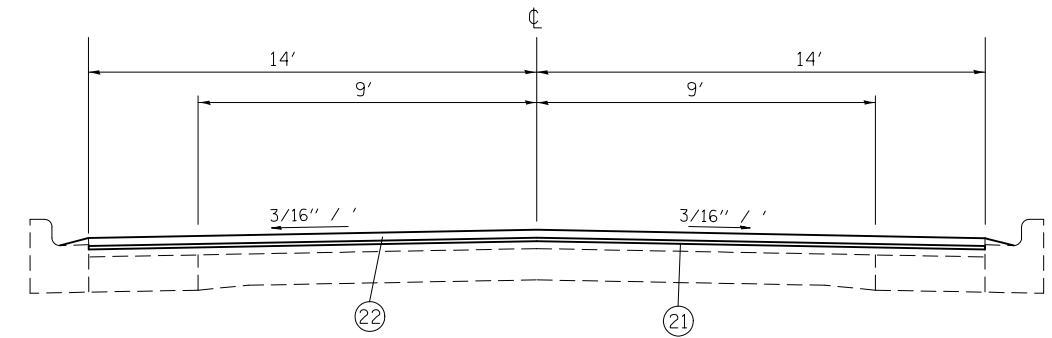

MM 1.37 - 1.45

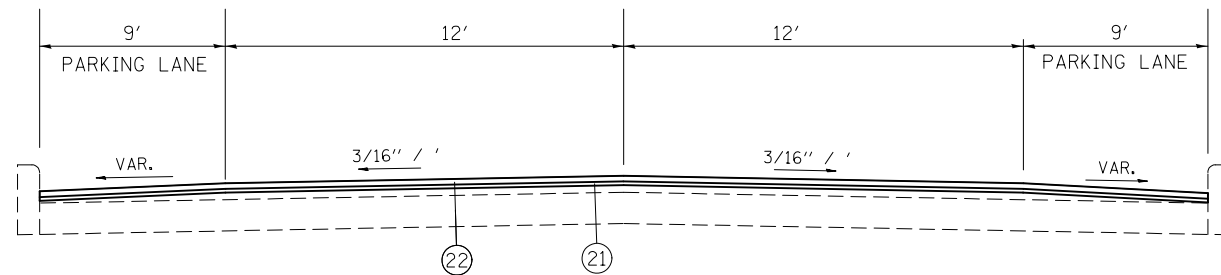

MM 0.70 - 1.36

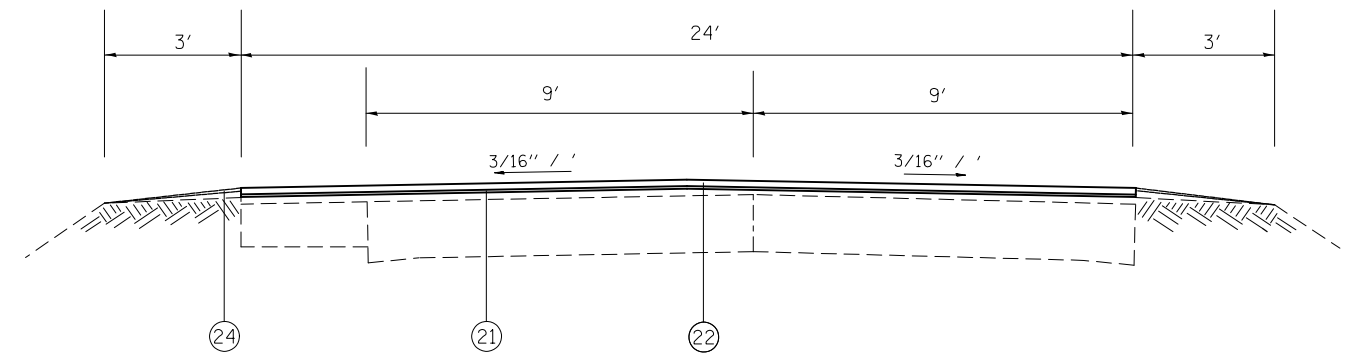

MM 1.45 - 3.92

- ① PROP. LEVELING BINDER (MM), N70, 3/4"
- ② PROP. HMA SURFACE COURSE, MIX D, N70, 1 1/2"
- ③ PROP. HMA SHOULDERS, 2 1/4"
- ④ PROP. AGGREGATE SHOULDER WEDGE, TYPE B

FILE NAME =	USER NAME = conoverpj	DESIGNED -	REVISED -
et:\pwork\pwork\conoverpj\d0280278\d076f25-sht-plan2.dgn		DRAWN -	REVISED -
	PLOT SCALE = 100.0000' / 1"	CHECKED -	REVISED -
	PLOT DATE = 6/29/2012	DATE -	REVISED -

**STATE OF ILLINOIS  
DEPARTMENT OF TRANSPORTATION**

**PROPOSED TYPICAL SECTIONS**

SCALE: SHEET NO. 1 OF 2 SHEETS STA. TO STA.

F.A.S. RTE.	SECTION	COUNTY	TOTAL SHEETS	SHEET NO.
733	(62,48)RS-3,5ORS-2	GREENE	16	7
CONTRACT NO. 76F25				
FED. ROAD DIST. NO. ILLINOIS FED. AID PROJECT				

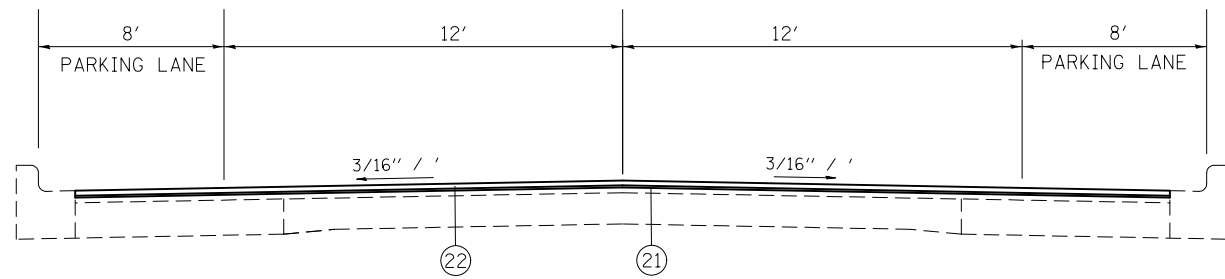

MM 3.92 - 4.86

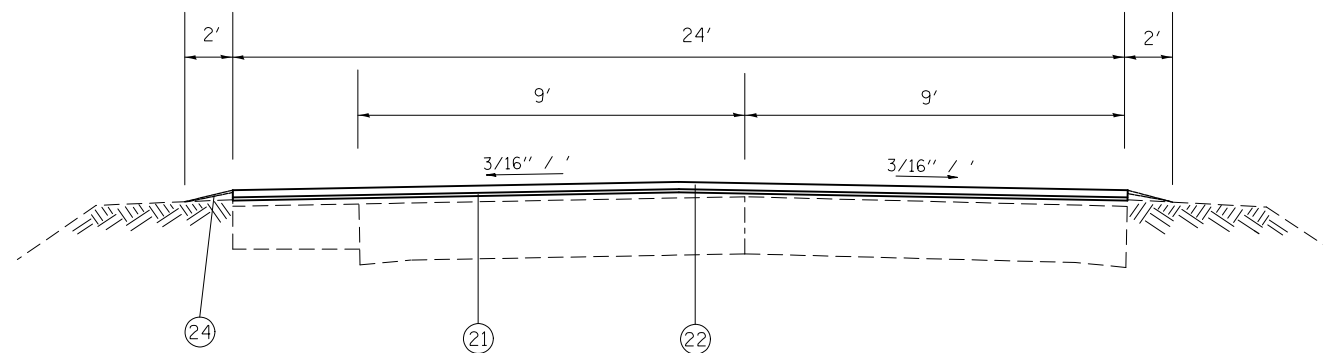

MM 4.86 - 6.45

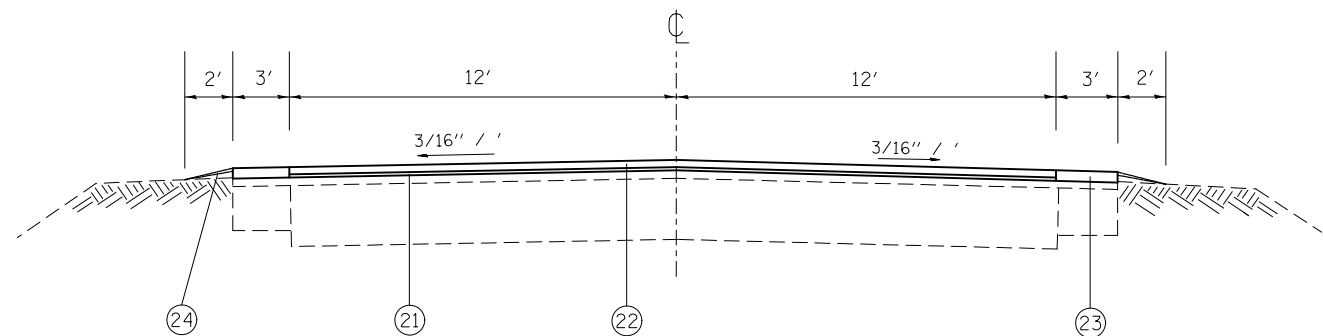

MM 6.45 - 6.65

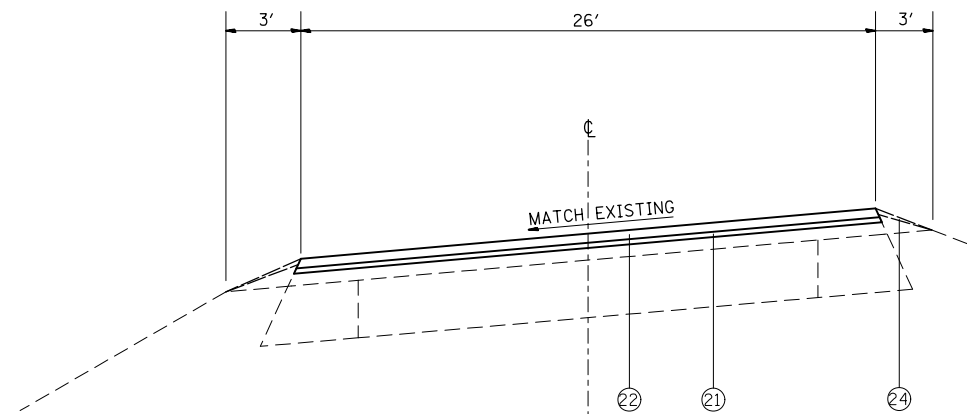

IL 106

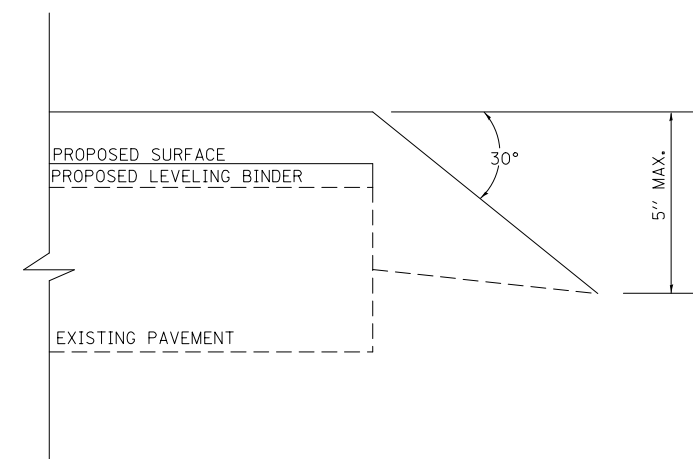

**SAFETY EDGE DETAIL**

MM 1.45 - 3.92  
MM 4.86 - 6.45

- ① PROP. LEVELING BINDER (MM), N70, 3/4"
- ② PROP. HMA SURFACE COURSE, MIX D, N70, 1 1/2"
- ③ PROP. HMA SHOULDERS, 2 1/4"
- ④ PROP. AGGREGATE SHOULDER WEDGE, TYPE B

FILE NAME =	USER NAME = conoverpj	DESIGNED -	REVISED -
et:\pwork\pwork\conoverpj\d0280278\d076f25-sht-plan2.dgn		DRAWN -	REVISED -
	PLOT SCALE = 100.0000' / 1in.	CHECKED -	REVISED -
	PLOT DATE = 6/29/2012	DATE -	REVISED -

**STATE OF ILLINOIS  
DEPARTMENT OF TRANSPORTATION**

**PROPOSED TYPICAL SECTIONS**

SCALE: SHEET NO. 2 OF 2 SHEETS STA. TO STA.

F.A.S. RTE.	SECTION	COUNTY	TOTAL SHEETS	SHEET NO.
733	(62,48)RS-3,5ORS-2	GREENE	16	8
CONTRACT NO. 76F25				
FED. ROAD DIST. NO. ILLINOIS FED. AID PROJECT				



MAINLINE RESURFACING								
LOCATION	HMA SURFACE REMOVAL, 2 1/4"	TEMPORARY RAMP	BITUMINOUS MATERIALS (PRIME COAT)	AGGREGATE (PRIME COAT)	LEVELING BINDER (MM)	HMA SURFACE COURSE	HMA SHOULDERS	AGGREGATE WEDGE SHOULDER, TYPE B
	SQ YD	SQ YD	TON	TON	TON	TON	TON	TON
MM 0.00 - 0.43	7063.5	23.3	4.42	21.2	296.7	579.5		
MM 0.43 - 0.70	4118.4		2.58	13.8	159.7	319.3		
MM 0.70 - 1.36	9292.8		5.82	27.8	390.3	780.6		
MM 1.36 - 1.37	211.2		0.14	0.6	8.9	17.7		
MM 1.37 - 1.45	1314.1		0.82	4.0	55.2	110.4		
MM 1.45 - 3.92	34777.6		21.76	104.4	1460.7	2921.3		380.4
MM 3.92 - 4.86	13235.2		8.28	40.0	555.9	1111.8		
MM 4.86 - 6.45	22387.2		14.00	67.2	940.3	1880.5		163.2
MM 6.45 - 6.65	3520	25.0	2.20	10.6	118.3	236.5	88.7	20.5
SIDEROADS		1566.7				33.3		
WHITE HALL PARKING LANES	8395.2		5.26	24.2	330.5	705.2		
ROODHOUSE PARKING LANES	7474.2		4.68	22.4	314.0	627.8		
IL 106	632.1	21.7	0.20	0.9	26.5	53.1		14.1
Cut-Thru	262.6		0.08	0.4	11.0	14.7		7.7
SAFETY EDGE						472.4		
TOTALS	112684.1	1636.7	70.24	337.5	4668.0	9864.1	88.7	585.9

PAVEMENT PATCHING			
LOCATION	SIZE	TYPE II 13"	TYPE IV 13"
		SQ YD	SQ YD
MM 3.13	6' X 48'		32.0
MM 3.14	6' X 21'	14.0	
MM 4.74	12' X 10'	13.3	
MM 4.74	12' X 10'	13.3	
IL 106 (CULVERT)	26' X 4'	11.6	
EXTRA QUANTITY		7.8	
TOTALS		60.0	32.0

PAVEMENT MARKING SCHEDULE									
LOCATION	THERMOPLASTIC PAVEMENT MARKING							RAISED REFLECTIVE PAVEMENT MARKERS	RAISED REFLECTIVE PAVEMENT MARKERS REMOVAL
	SOLID WHITE 4"	SOLID YELLOW 4"		SKIP-DASH YELLOW 4"	SOLID WHITE CROSS WALKS 12"	SOLID WHITE STOP BARS 24"	LETTERS & SYMBOLS WHITE RR CROSSING	EACH	EACH
		NO-PASS NB	NO-PASS SB						
	FOOT	FOOT	FOOT	FOOT	FOOT	FOOT	SQ FT		
MM 0.00 - 0.05	528.0	264.0		70				3	3
MM 0.05 - 0.12	739.2	369.6	369.6					5	5
MM 0.12 - 0.17	528.0		264.0	70				3	3
MM 0.17 - 0.40	2428.8			300				15	15
MM 0.40 - 0.53	1372.8	686.4		170				9	9
MM 0.53 - 0.55	211.2			30				1	1
MM 0.55 - 0.68	1372.8		686.4	170				9	9
MM 0.68 - 1.43	7920.0			990	742	84		50	50
MM 1.43 - 1.45	211.2	105.6		30				1	1
MM 1.45 - 1.73	2956.8	1478.4	1478.4			48	61.2	19	19
MM 1.73 - 1.78	528.0		264.0	70		24	61.2	3	3
MM 1.78 - 4.75	31363.2			3920	160	40		196	196
MM 4.75 - 4.85	1056.0	528.0		130	80			7	7
MM 4.85 - 5.41	5913.6	2956.8	2956.8					37	37
MM 5.41 - 5.62	2217.6		1108.8	280				14	14
MM 5.62 - 6.65	10876.8			1360				68	68
IL 106	485	570.0				16		4	4
Cut-Thru	265	148.0				12			
SUB-TOTALS	70974.0	7106.8	7128.0	7590					
TOTALS		92798.8			982	224	122.4	444	444

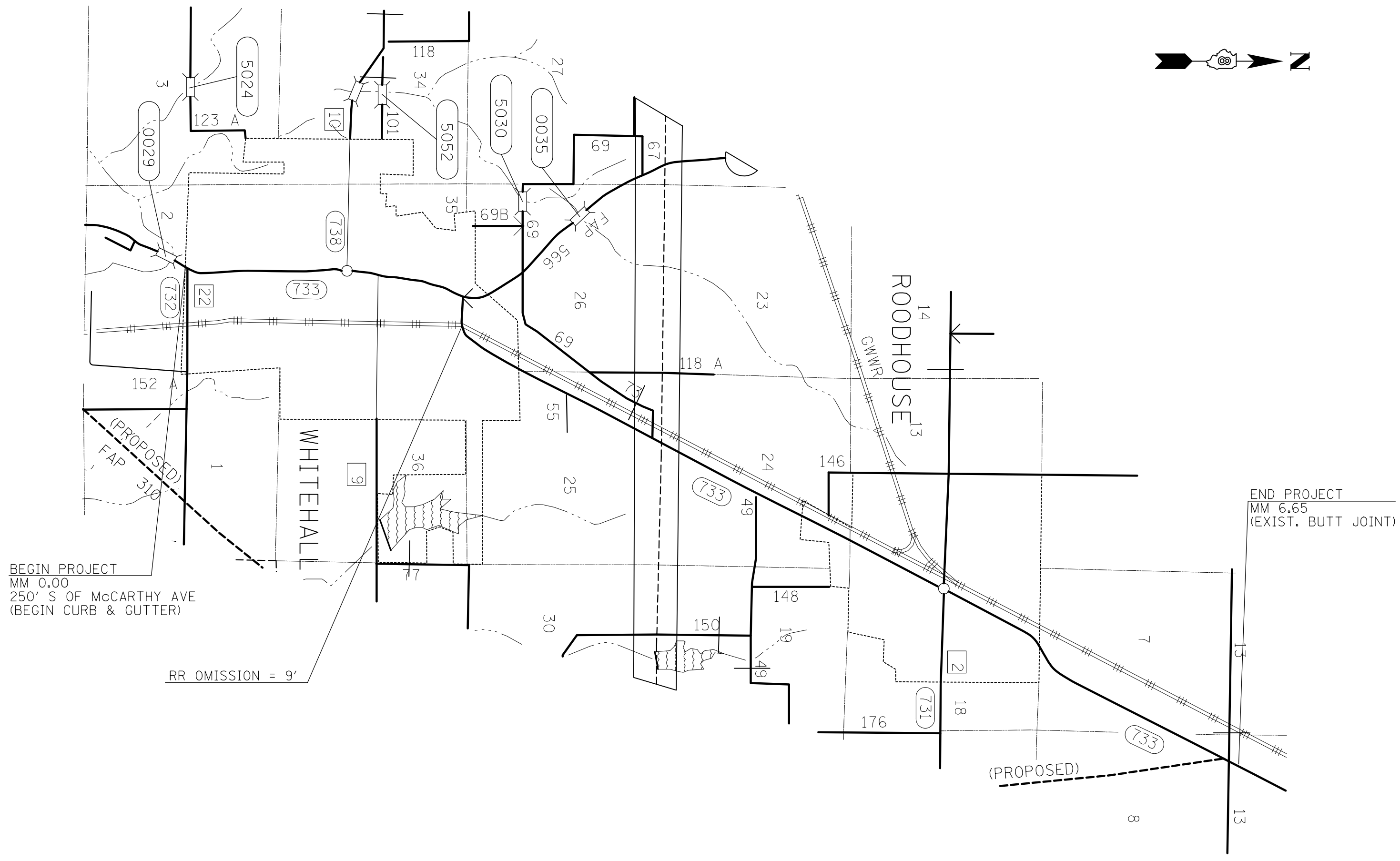

BEGIN PROJECT  
MM 0.00  
250' S OF MCCARTHY AVE  
(BEGIN CURB & GUTTER)

RR OMISSION = 9'

END PROJECT  
MM 6.65  
(EXIST. BUTT JOINT)

FILE NAME =	USER NAME = conoverpj	DESIGNED -	REVISED -
et:\pwork\pwork\conoverpj\d0280278\d076f25-sht-plan2.dgn		DRAWN -	REVISED -
	PLOT SCALE = 100.0000' / 1" =	CHECKED -	REVISED -
	PLOT DATE = 6/29/2012	DATE -	REVISED -

**STATE OF ILLINOIS  
DEPARTMENT OF TRANSPORTATION**

**LINE DIAGRAMS**

SCALE: SHEET NO. 1 OF 2 SHEETS STA. TO STA.

F.A.S. RTE.	SECTION	COUNTY	TOTAL SHEETS	SHEET NO.
733	(62,48)RS-3,5ORS-2	GREENE	16	10
CONTRACT NO. 76F25				
FED. ROAD DIST. NO.		ILLINOIS FED. AID PROJECT		



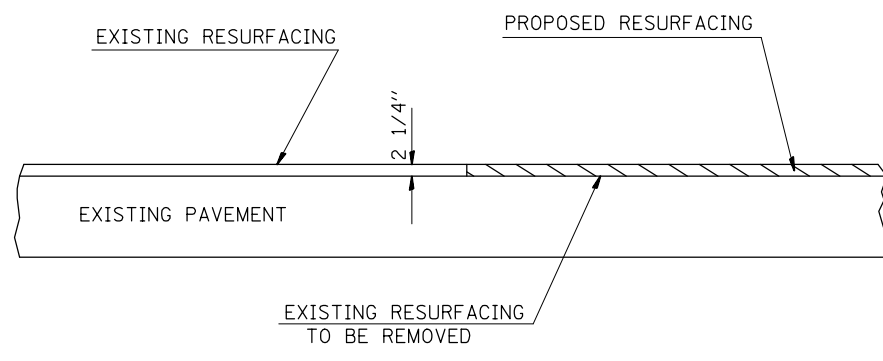
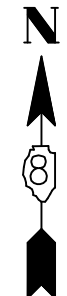

JOINT @ BEGINNING & END OF PROJECT

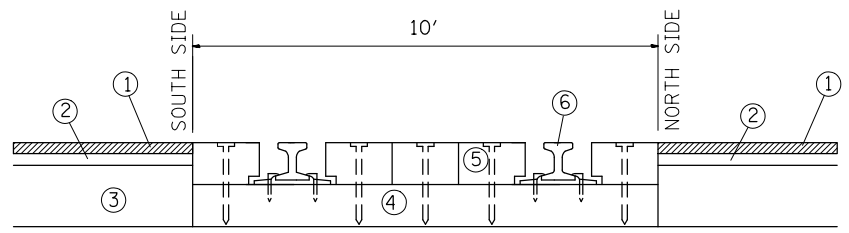

JOINTS @ RAILROAD

- ① PROPOSED 2 1/4 " MILLING AND BITUMINOUS RESURFACING
- ② EXISTING BITUMINOUS SURFACE
- ③ EXISTING PAVEMENT
- ④ EXISTING RR TIES
- ⑤ EXISTING RR PLANKS
- ⑥ EXISTING RAIL

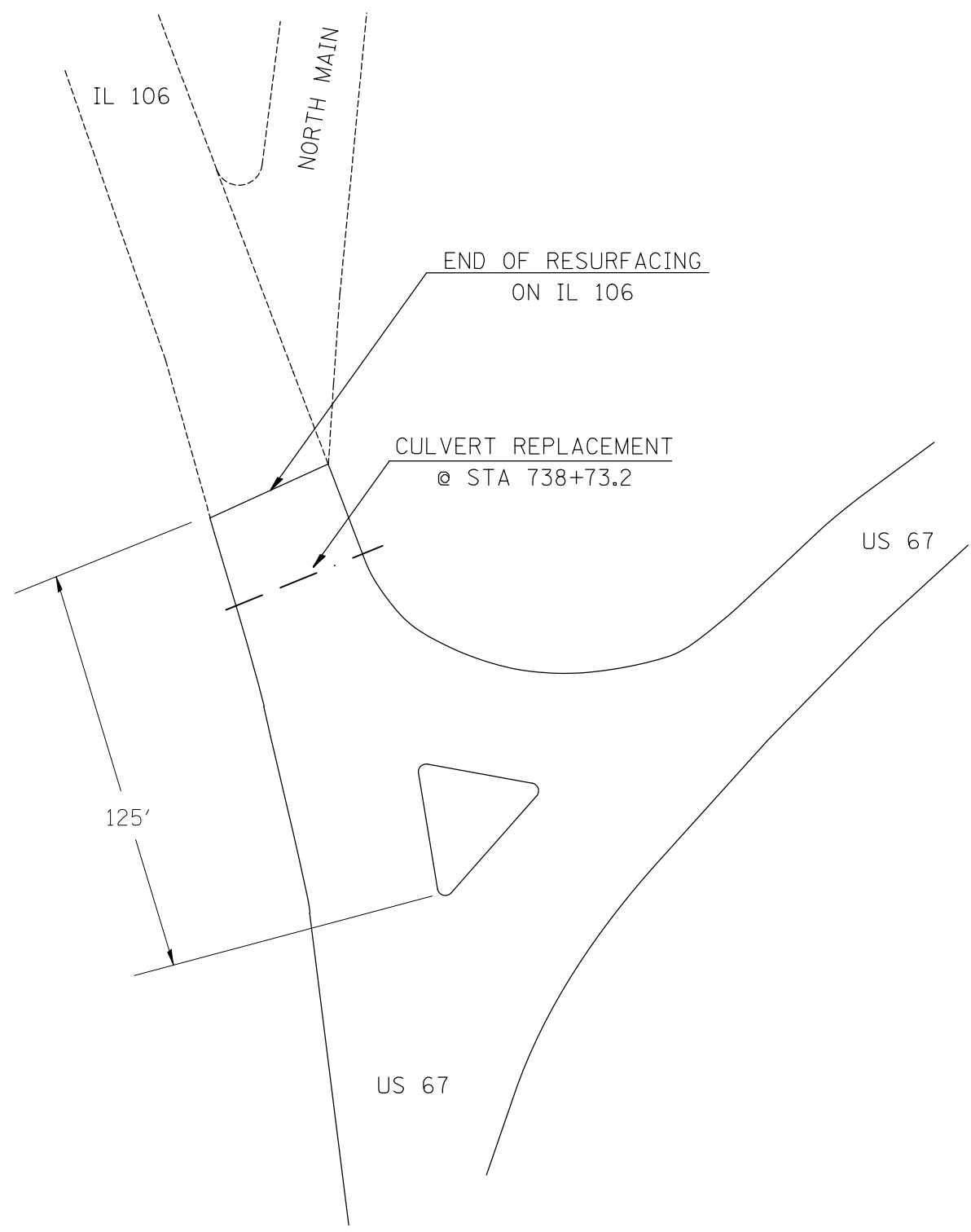

NOT TO SCALE

FILE NAME =	USER NAME = conoverpj	DESIGNED -	REVISED -	<b>STATE OF ILLINOIS DEPARTMENT OF TRANSPORTATION</b>	<b>MILLING &amp; PAVING DETAILS</b>			F.A.S. RTE.	SECTION	COUNTY	TOTAL SHEETS	SHEET NO.	
et:\pw\work\p\dot\conoverpj\d0280278\d076f25-sht-plan2.dgn		DRAWN -	REVISED -		SCALE:	SHEET NO. 1 OF 2 SHEETS	STA.	TO STA.	733	(62,48)RS-3,5ORS-2	GREENE	16	12
		CHECKED -	REVISED -					CONTRACT NO. 76F25					
		DATE -	REVISED -										
	PLOT SCALE = 100.0000' / 1in.												
	PLOT DATE = 7/2/2012												
								FED. ROAD DIST. NO. ILLINOIS FED. AID PROJECT					

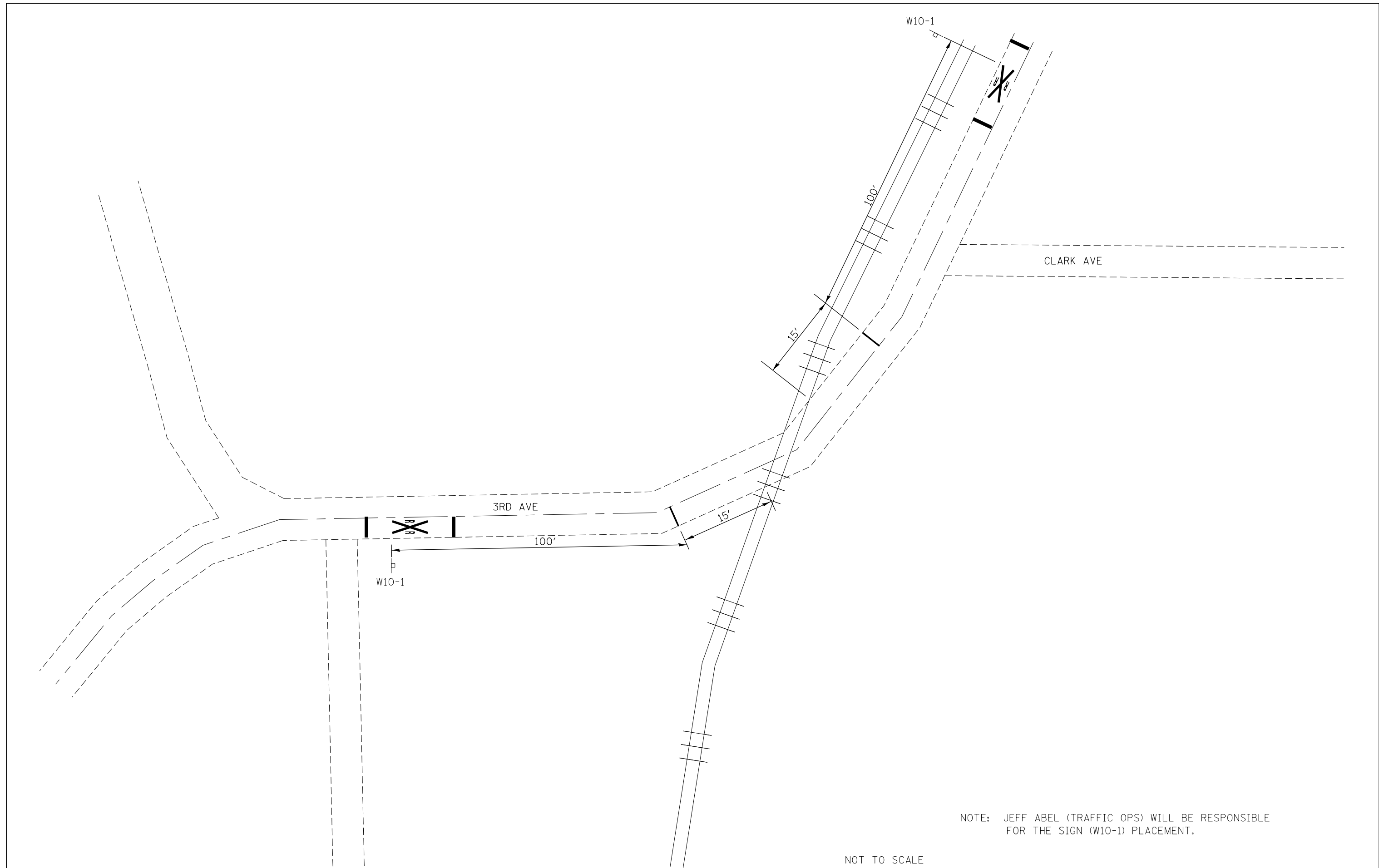

NOTE: JEFF ABEL (TRAFFIC OPS) WILL BE RESPONSIBLE FOR THE SIGN (W10-1) PLACEMENT.

NOT TO SCALE

FILE NAME =	USER NAME = conoverpj	DESIGNED -	REVISED -
e:\pwork\pwork\conoverpj\d0280278\d076f25-sht-plan2.dgn		DRAWN -	REVISED -
	PLOT SCALE = 100.0000' / in.	CHECKED -	REVISED -
	PLOT DATE = 6/29/2012	DATE -	REVISED -

**STATE OF ILLINOIS  
DEPARTMENT OF TRANSPORTATION**

**STRIPING DETAIL**

SCALE: SHEET NO. 1 OF 3 SHEETS STA. TO STA.

F.A.S. RTE.	SECTION	COUNTY	TOTAL SHEETS	SHEET NO.
733	(62,48)RS-3,5ORS-2	GREENE	16	13
FED. ROAD DIST. NO. ILLINOIS FED. AID PROJECT			CONTRACT NO. 76F25	

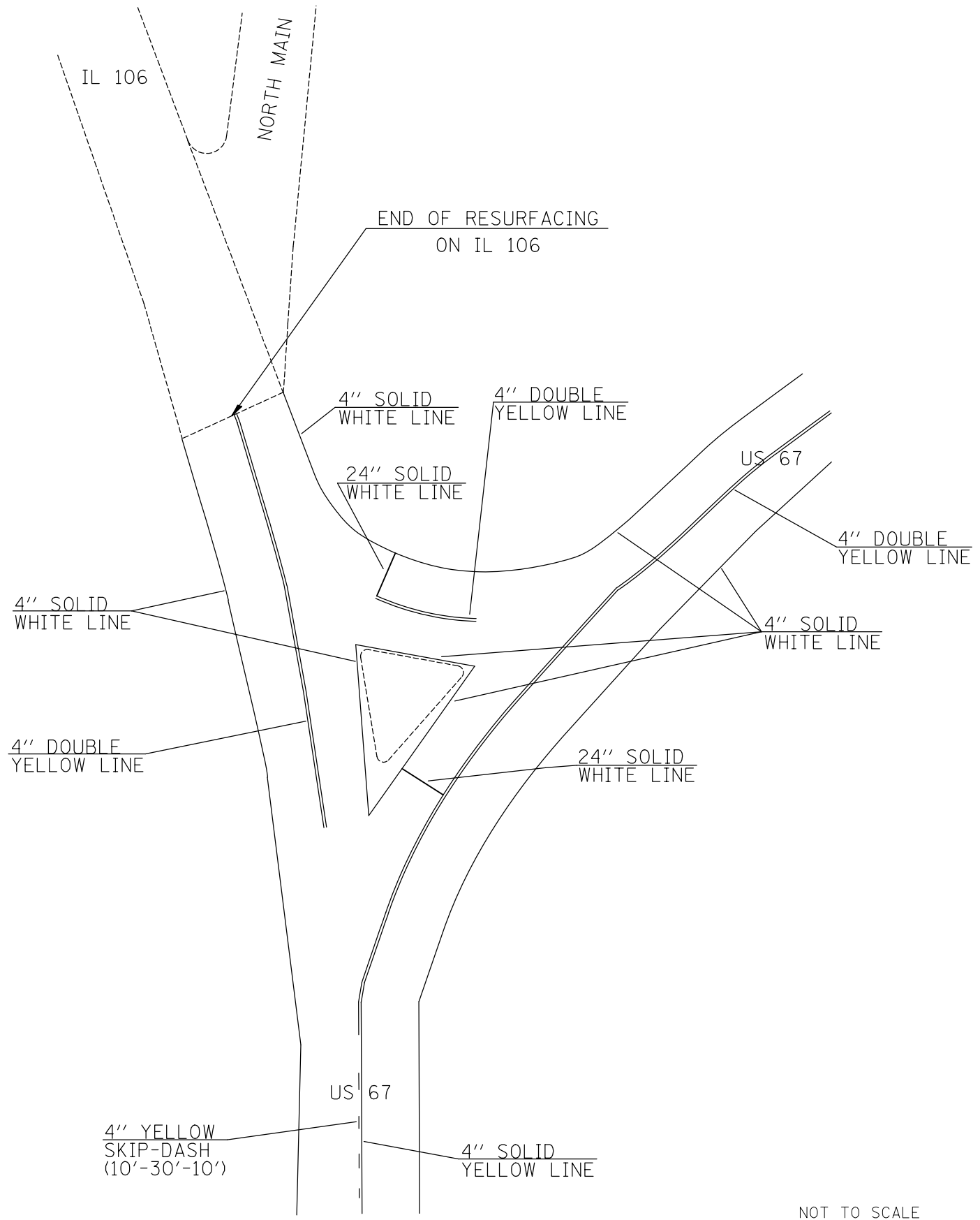
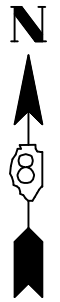

NOT TO SCALE

FILE NAME =	USER NAME = conoverpj	DESIGNED -	REVISED -
et:\pwork\pwork\conoverpj\d0280278\d076f25-sht-plan2.dgn		DRAWN -	REVISED -
	PLOT SCALE = 100.0000' / 1in.	CHECKED -	REVISED -
	PLOT DATE = 6/29/2012	DATE -	REVISED -

**STATE OF ILLINOIS  
DEPARTMENT OF TRANSPORTATION**

<b>STRIPING DETAIL</b>			
SCALE:	SHEET NO. 2 OF 3 SHEETS	STA.	TO STA.

F.A.S. RTE.	SECTION	COUNTY	TOTAL SHEETS	SHEET NO.
733	(62,48)RS-3,5ORS-2	GREENE	16	14
FED. ROAD DIST. NO.			ILLINOIS FED. AID PROJECT	
			CONTRACT NO. 76F25	

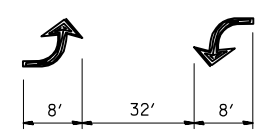
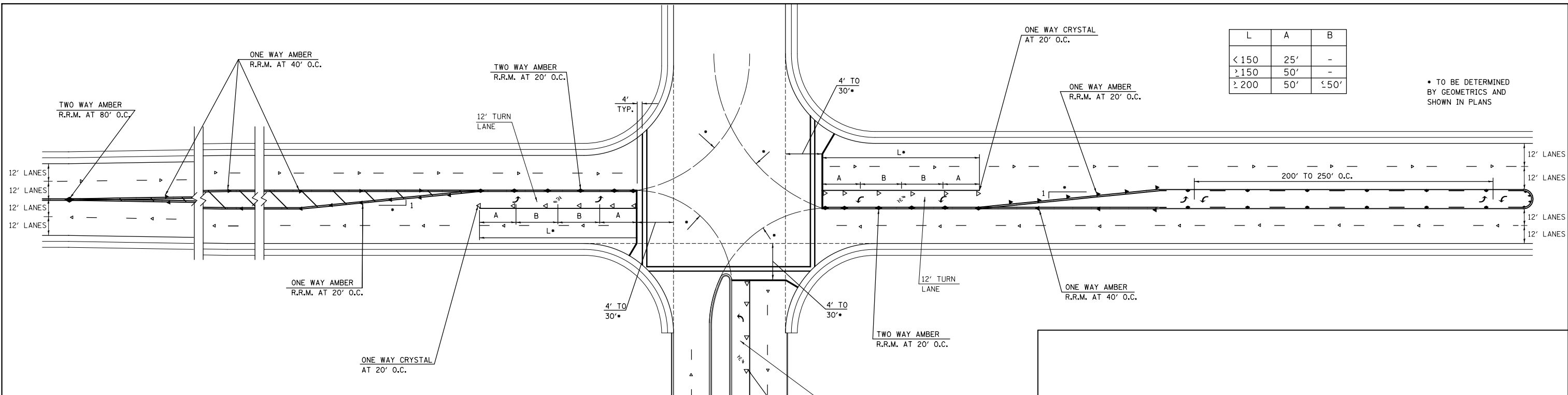

BI-DIRECTIONAL TURN ARROW @ 200' O. C.

SPEED	CHANNELIZATION & GORES	OBJECTS	CONTINUOUS
< 30 MPH	15'	10'	50'
30-45 MPH	20'	15'	75'
> 45 MPH	30'	20'	150'

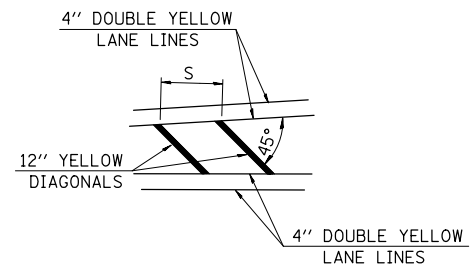

TYPICAL APPLICATION FOR MEDIAN STRIPING

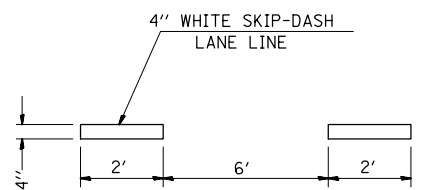

TYPICAL APPLICATION FOR WHITE SKIP-DASH LANE LINES

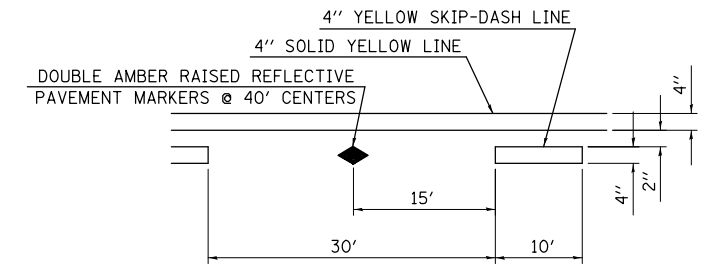

TYPICAL APPLICATION FOR BI-DIRECTIONAL TURN LANE WITH RAISED REFLECTIVE PAVEMENT MARKERS

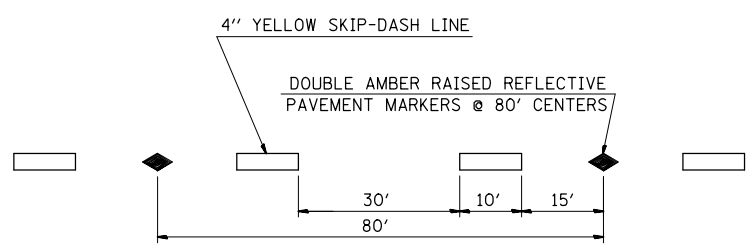

TYPICAL APPLICATION FOR YELLOW SKIP-DASH LINES WITH RAISED REFLECTIVE PAVEMENT MARKERS

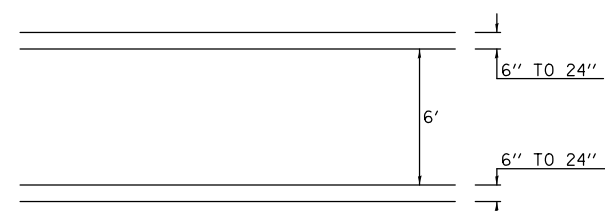

TYPICAL APPLICATION FOR PEDESTRIAN CROSSWALK

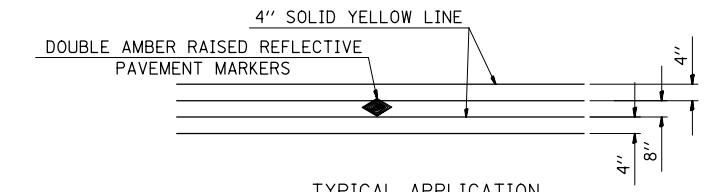

TYPICAL APPLICATION FOR DOUBLE YELLOW LANE LINES WITH RAISED REFLECTIVE PAVEMENT MARKERS

FILE NAME =	USER NAME = conoverpj	DESIGNED -	REVISED -
et:\pwork\pwork\conoverpj\d0280278\076f25-sht-plan2.dgn		DRAWN -	REVISED -
	PLOT SCALE = 100.0000' / in.	CHECKED -	REVISED -
	PLOT DATE = 6/29/2012	DATE -	REVISED -

**STATE OF ILLINOIS  
DEPARTMENT OF TRANSPORTATION**

**STRIPING DETAIL**

SCALE: SHEET NO. 3 OF 3 SHEETS STA. TO STA.

F.A.S. RTE.	SECTION	COUNTY	TOTAL SHEETS	SHEET NO.
733	(62,48)RS-3,5ORS-2	GREENE	16	15
CONTRACT NO. 76F25				
FED. ROAD DIST. NO. ILLINOIS FED. AID PROJECT				

NOTES:

A STANDARD BAND ANGLE CONNECTOR SHALL BE USED PER MANUFACTURER'S REQUIREMENTS TO CONNECT THE PIPE CULVERT. COST TO BE INCLUDED IN THE CULVERT PAY ITEMS.

THE COST OF SEEDING, MULCH, FERTILIZER AND EARTHWORK REQUIRED TO COMPLETE THE CULVERT REPLACEMENT IS TO BE INCLUDED IN THE CULVERT PAY ITEMS.

ADDITIONAL QUANTITIES FOR CULVERT REPLACEMENT:

TRENCH BACKFILL - 6 CU YD  
 PERIMETER EROSION CONTROL - 25 FT  
 INLET AND PIPE PROTECTION - 1 EACH

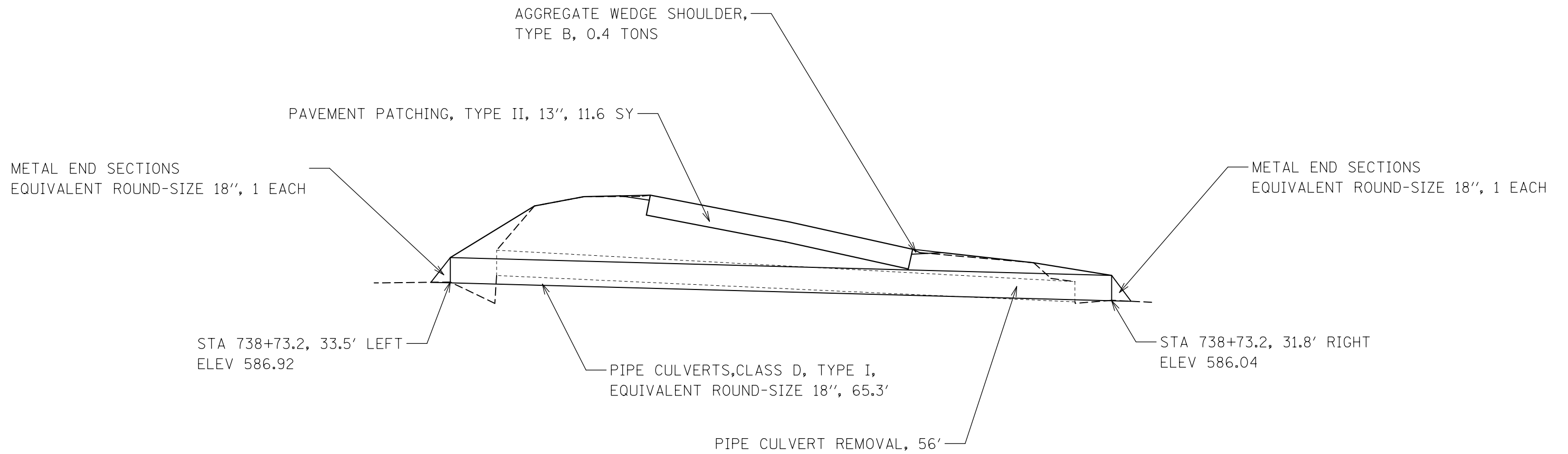

NOT TO SCALE

FILE NAME =	USER NAME = conoverpj	DESIGNED -	REVISED -	<b>STATE OF ILLINOIS DEPARTMENT OF TRANSPORTATION</b>	<b>IL 106 CULVERT REPLACEMENT DETAIL</b>	F.A.S. RTE.	SECTION	COUNTY	TOTAL SHEETS	SHEET NO.	
et:\pwork\pwork\conoverpj\d0280278\d076f25-sht-plan2.dgn		DRAWN -	REVISED -			733	(62,48)RS-3,5ORS-2	GREENE	16	16	
PLOT SCALE = 100.0000' / 1in.		CHECKED -	REVISED -			CONTRACT NO. 76F25					
PLOT DATE = 6/29/2012		DATE -	REVISED -			FED. ROAD DIST. NO.	ILLINOIS	FED. AID PROJECT			
SCALE:						SHEET NO. 1 OF 1 SHEETS	STA.	TO STA.			