

GENERAL NOTES

Reinforcement bars designated (E) shall be epoxy coated.

Plan dimensions and details relative to existing plans are subject to nominal construction variations. The Contractor shall field verify existing dimensions and details affecting new construction and make necessary approved adjustments prior to construction or ordering of materials. Such variations shall not be cause for additional compensation for a change in scope of the work, however, the Contractor will be paid for the quantity actually furnished at the unit price bid for the work.

Existing reinforcement bars extending into removal area shall be cleaned, straightened and incorporated into the new construction. Any reinforcement bars that are damaged during concrete removal shall be replaced with an approved bar splicer or anchorage system. Cost included with Concrete Removal.

The deck surface shall have its final finish surface tined according to Article 420.09(e)1 of the Standard Specifications. Cost included with "Concrete Superstructure".

Cleaning and Painting of the existing structural steel and bearings shall be as specified in the Special Provision for "Cleaning and Painting Existing Steel Surfaces". All beams, bearings, deck drains and other structural steel within 5 feet (measured along the beam) of either side of the deck joints shall be cleaned per Near White Blast Cleaning-SSPC-SP10.

The designated areas cleaned per near white blast cleaning SSPC-SP10 shall be painted according to the requirements of paint system 1- OZ/E/U. The color of the final finish coat for all cleaned surfaces shall match the existing steel.

Containment of cleaning residue is required to control nuisance dust. See special provisions.

The existing coating does not contain lead. By specification, a Class 2A containment is required to contain nuisance dust from escaping into the environment.

Joint openings shall be adjusted according to Article 520.04 of the Std. Specs. when the deck is poured at an ambient temperature other than 50° F.

Protective coat shall be placed on top/inside faces of parapets/wingwalls and on top of new concrete at joints.

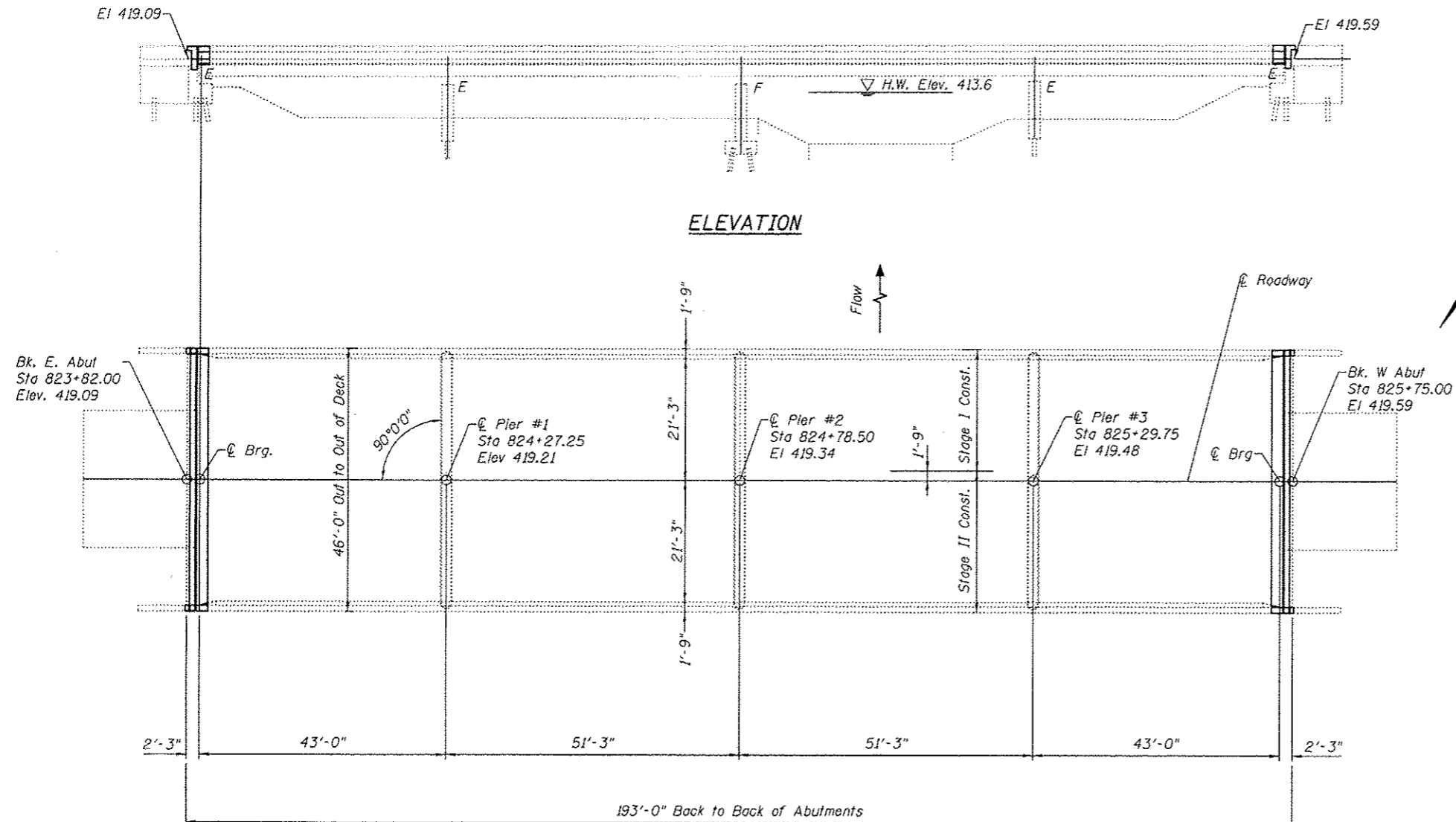

ELEVATION

PLAN

Remove Preformed Joint Sealer and Install Preformed Joint Strip Seal

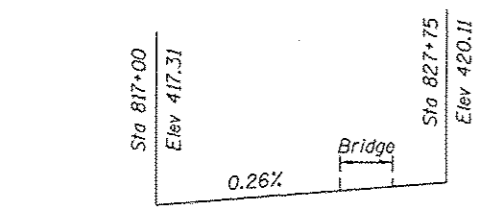

PROFILE GRADE
(Along ϕ Roadway)



Expires 11/30/12

INDEX OF SHEETS

1. General Plan & Elevation
2. Deck Cross Section
3. Joint Details
4. Wingwall & Railpost Details
5. Strip Seal Details
6. Bar Splicer Base Sheet
7. For Information Only (F.I.O.) - Existing Steel Details
8. F.I.O. - Existing Framing Plans

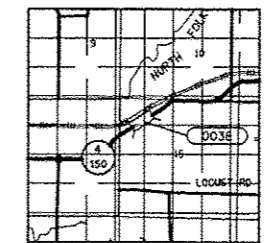

LOCATION SKETCH

TOTAL BILL OF MATERIAL

ITEM	UNIT	TOTAL
Concrete Removal	Cu. Yd.	13.6
Concrete Superstructure	Cu. Yd.	13.2
Hot-Mix Asphalt Surface Removal (Deck)	Sq. Yd.	877
Reinforcement Bars, Epoxy Coated	Pound	1760
Bar Splicers	Each	24
Preformed Joint Strip Seal	Foot	92
Waterproofing Membrane System	Sq. Yd.	892
HMA Surface Course, Mix "D" N90	Ton	74.4
Protective Coat	Sq. Yd.	32
Containment and Disposal of Non-Lead Paint Cleaning Residues No. 1	L. Sum	1
Cleaning and Painting Steel Bridge No. 1	L. Sum	1

DESIGNED - AYY	EXAMINED - <i>Timothy A. D... [Signature]</i>	DATE - 7/31/12
CHECKED - PSK	PASSED - <i>[Signature]</i>	
DRAWN - AYY		
CHECKED - PSK		

ENGINEER OF STRUCTURAL SERVICES
ENGINEER OF BRIDGES AND STRUCTURES

STATE OF ILLINOIS
DEPARTMENT OF TRANSPORTATION

GENERAL PLAN & ELEVATION
079-0038
SHEET NO. 1 OF 9 SHEETS

IL RTE. 4/150	SECTION 110-BR	COUNTY Randolph	TOTAL SHEETS 20	SHEET NO. 12
CONTRACT NO. 76F53			ILLINOIS FED. AID PROJECT	