

GENERAL NOTES

1. ALL CONSTRUCTION SHALL BE DONE IN ACCORDANCE WITH THE STATE OF ILLINOIS "STANDARD SPECIFICATIONS FOR ROAD AND BRIDGE CONSTRUCTION, ADOPTED JANUARY 1, 2012," THESE PLANS AND THE SPECIAL PROVISIONS INCLUDED IN THE CONTRACT DOCUMENTS.
2. THE CONTRACTOR SHALL COORDINATE ACTIVITIES WITH ALL UTILITIES WITHIN THE PROJECT LIMITS. THE LOCATIONS OF EXISTING UTILITIES AS SHOWN ON THE PLANS ARE BASED ON CAREFUL FIELD INVESTIGATION AND THE BEST INFORMATION AVAILABLE, BUT ARE NOT GUARANTEED. IT SHALL BE THE RESPONSIBILITY OF THE CONTRACTOR TO DETERMINE THEIR EXACT LOCATIONS FROM THE UTILITY COMPANIES AND BY FIELD INSPECTION. THE CONTRACTOR IS REQUIRED TO CONTACT J.U.L.I.E. AT, 1-800-892-0123, PRIOR TO PROCEEDING WITH ANY EXCAVATION AND WORK ON THE PROJECT.
3. THE FOLLOWING RATES OF APPLICATION HAVE BEEN USED IN CALCULATING PLAN QUANTITIES...
 AGGREGATE SURFACE COURSE, TYPE B - 1.8 TON/CU YD
 MULCH METHOD - 2.0 TON/ACRE
 TEMPORARY SEEDING - 100LB/ACRE

LIST OF ILLINOIS DOT HIGHWAY STANDARDS

STANDARD NO. DESCRIPTION

000001-06	STANDARD SYMBOLS, ABBREVIATIONS & PATTERNS
280001-06	TEMPORARY EROSION CONTROL SYSTEMS
515001-03	NAME PLATE FOR BRIDGES
601101-01	CONCRETE HEADWALL FOR PIPE DRAIN
635006-03	REFLECTOR AND TERMINAL MARKER PLACEMENT
701901-02	TRAFFIC CONTROL DEVICES
BLR-21-9	TYP APP OF TRAFFIC CONTROL DEVICES, CONSTRUCTION ON RURAL LOCAL HIGHWAYS
BLR-22-7	TYP APP OF TRAFFIC CONTROL DEVICES, CONSTRUCTION ON RURAL LOCAL HIGHWAYS, RURAL TRAFFIC, 2L, 2W, ROAD CLOSED TO THRU TRAFFIC

TYPICALS

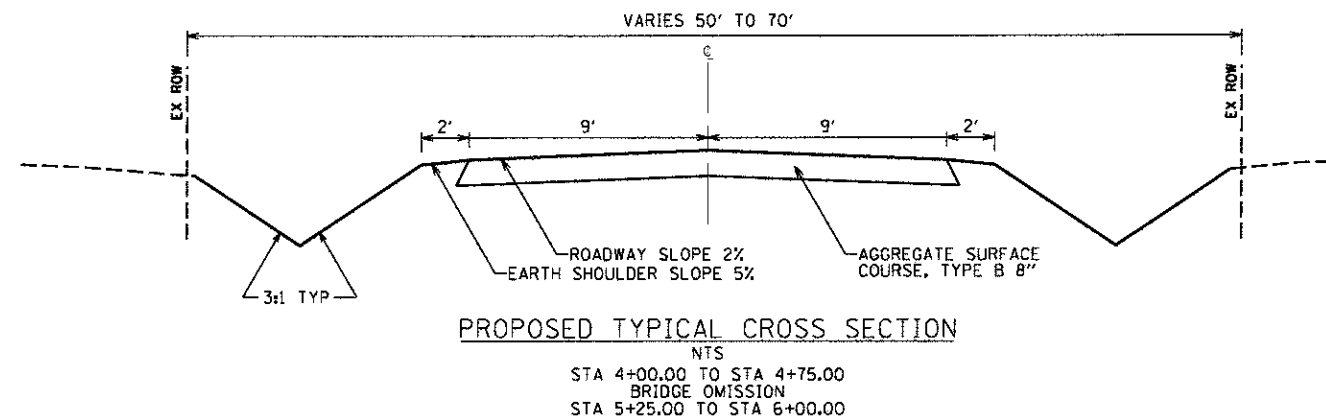
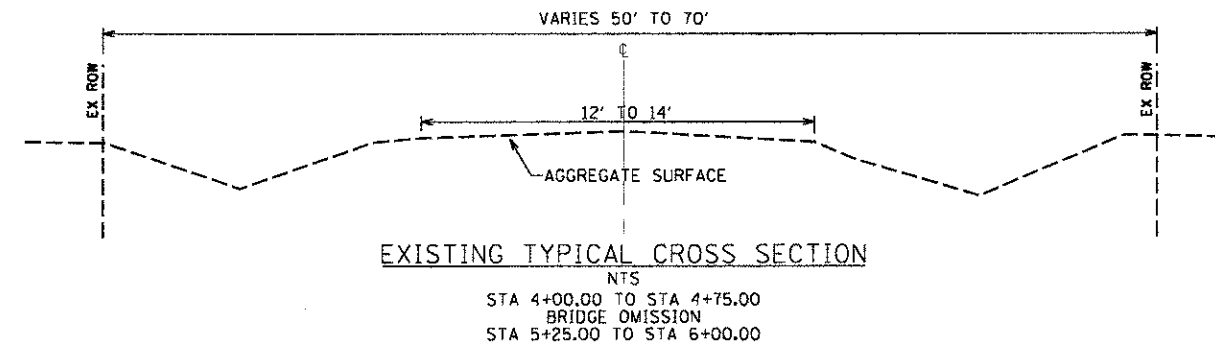

ALIGNMENT AND TIES

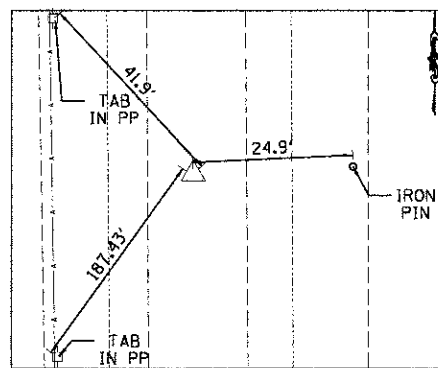
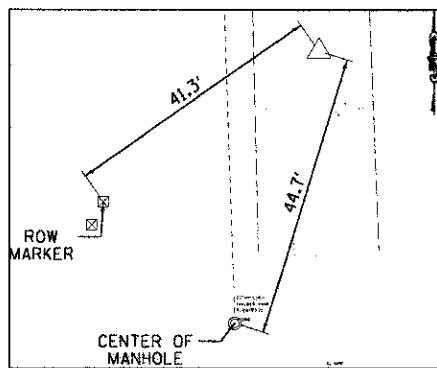

POT STA 0+00.00
 N: 1210988.0976
 E: 1130939.4503

POT STA 11+00.00
 E: 1212087.9866
 N: 1130923.8262

SET 5/8" IRON PIN & CAP
 N: 1210937.9697
 E: 1130941.1625
 STA 97+49.85
 1.0' RT

SET 5/8" IRON PIN & CAP
 N: 1212487.8133
 E: 1130919.1467
 STA 14+99.85
 1.0' RT

NOTE:
 STATION EQUATION
 2+00.00 = 100+00.00

TYP ENTRANCE DETAIL

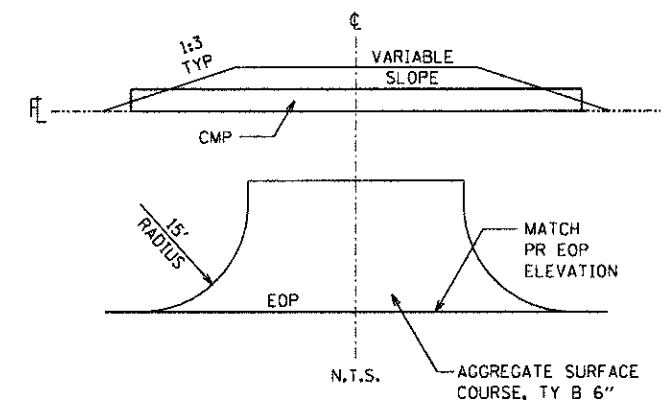

NO.	DATE	DESCRIPTION OF REVISIONS	NO.	DATE	DESCRIPTION OF REVISIONS