

F.A.I. RTE.	SECTION	COUNTY	TOTAL SHEETS	SHEET NO.
90/94	*	COOK	312	60
STA. 4434+00		TO STA. 4458+00		
FED. ROAD DIST. NO. 1 ILLINOIS FED. AID PROJECT				
60A62 • (1919.15, 2021-922 PT1 & PT2) R-1				

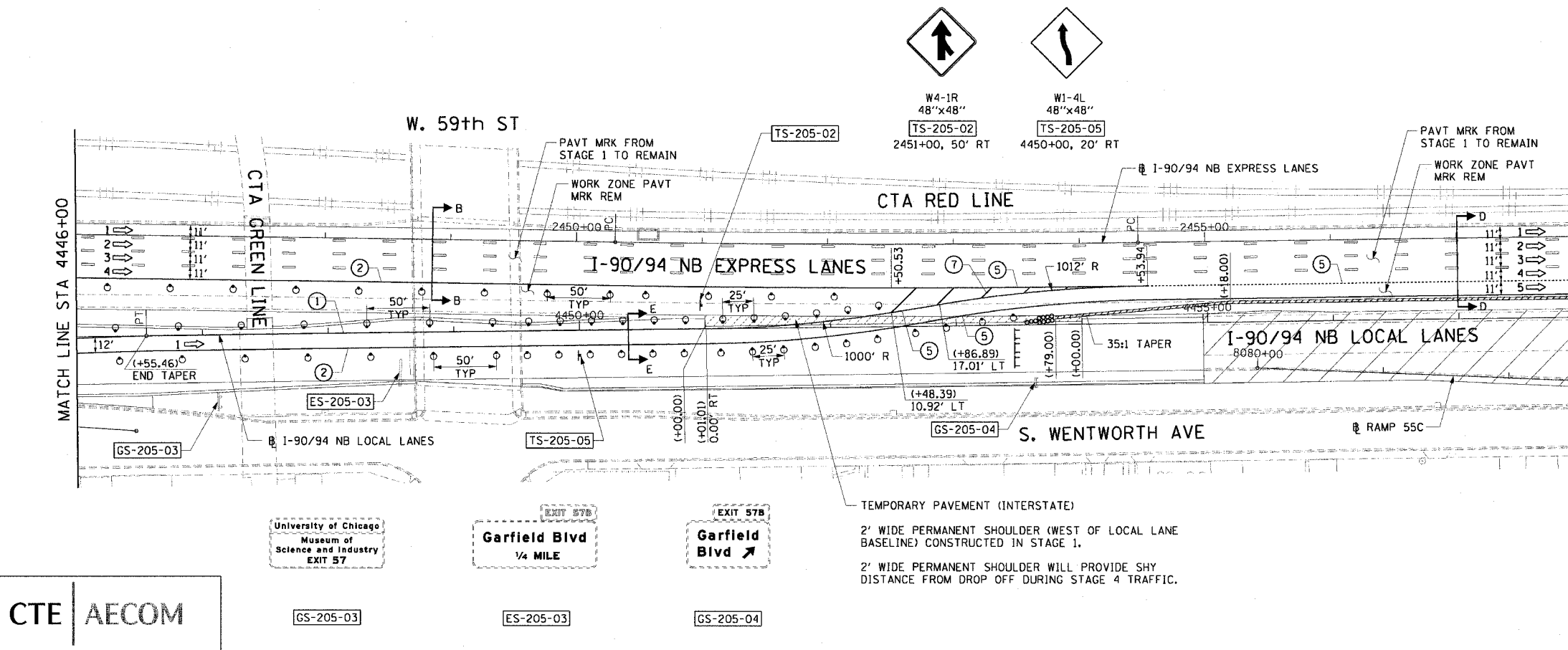

LEGEND:

- 1 → LANE NUMBER AND DIRECTION OF TRAFFIC
- ▨ WORK AREA
- ▨ TEMPORARY PAVEMENT
- ∞ IMPACT ATTENUATORS, TEMPORARY (NON-REDIRECTIVE), TEST LEVEL 3
- DRUM OR BARRICADE TYPE II WITH STEADY BURNING LIGHT
- ▬ BARRICADE TYPE III
- ▬ TEMPORARY CONCRETE BARRIER
- ① LINE 4" (YELLOW EDGE)
- ② LINE 4" (WHITE EDGE)
- ③ LINE 4" (SKIP DASH, 6' SKIP - 2' DASH, WHITE)
- ④ LINE 5" (SKIP DASH, 30' SKIP - 10' DASH, WHITE)
- ⑤ LINE 8" (WHITE GORE LINE)
- ⑥ LINE 8" (SKIP DASH, 12' SKIP - 3' DASH, WHITE)
- ⑦ LINE 12" (DIAGONAL, 30' C-C, WHITE)
- ⑧ LETTERS AND SYMBOLS
- ES-XXX-XX EXISTING OVERHEAD OR CANTILEVER SIGNS
- GS-XXX-XX EXISTING POST MOUNTED SIGNS
- TS-XXX-XX TEMPORARY SIGNS
- +XX.XX STATION PROVIDED FROM THE ± SB I-90/94 EXPRESS LANES
- (+XX.XX) STATION PROVIDED FROM THE ± SB I-90/94 LOCAL LANES

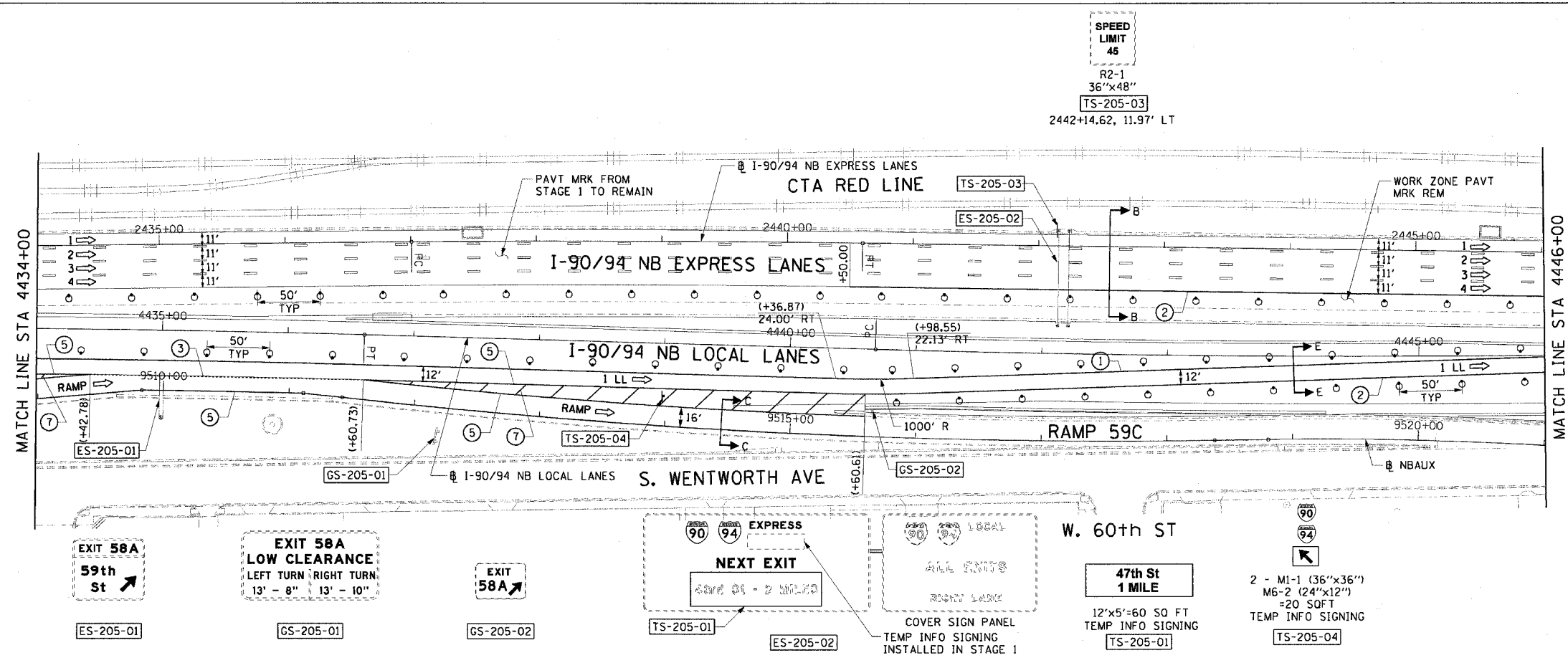

- NOTES:**
- SEE SHEET MOTTS-1 FOR TYPICAL SECTIONS.
 - SEE TEMPORARY SIGN PANEL SHEETS FOR DETAILS.

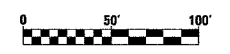

REVISIONS	
NAME	DATE

MOT-205

ILLINOIS DEPARTMENT OF TRANSPORTATION
F.A.I. 90/94 (DAN RYAN EXPRESSWAY)
63RD STREET TO GARFIELD BLVD (NB LOCAL LANES)

**SUGGESTED STAGES OF CONSTRUCTION AND TRAFFIC CONTROL
STAGE 2**

SCALE: 1"=50'
DATE: June 9, 2006

DRAWN BY: PHP
CHECKED BY: RMC

CTE | AECOM

6/2/2006 3:34:32 PM