

| F.A.I. RTE.                                     | SECTION | COUNTY | TOTAL SHEETS | SHEET NO. |
|---|---------|--------|--------------|-----------|
| 90/94   |         | COOK   | 247          | 19        |
| FED. ROAD DIST. NO. 1 ILLINOIS FED. AID PROJECT |         |        |              |           |
| 60A63 (1919.15, 2021-922 PT1 & PT2) R-2         |         |        |              |           |

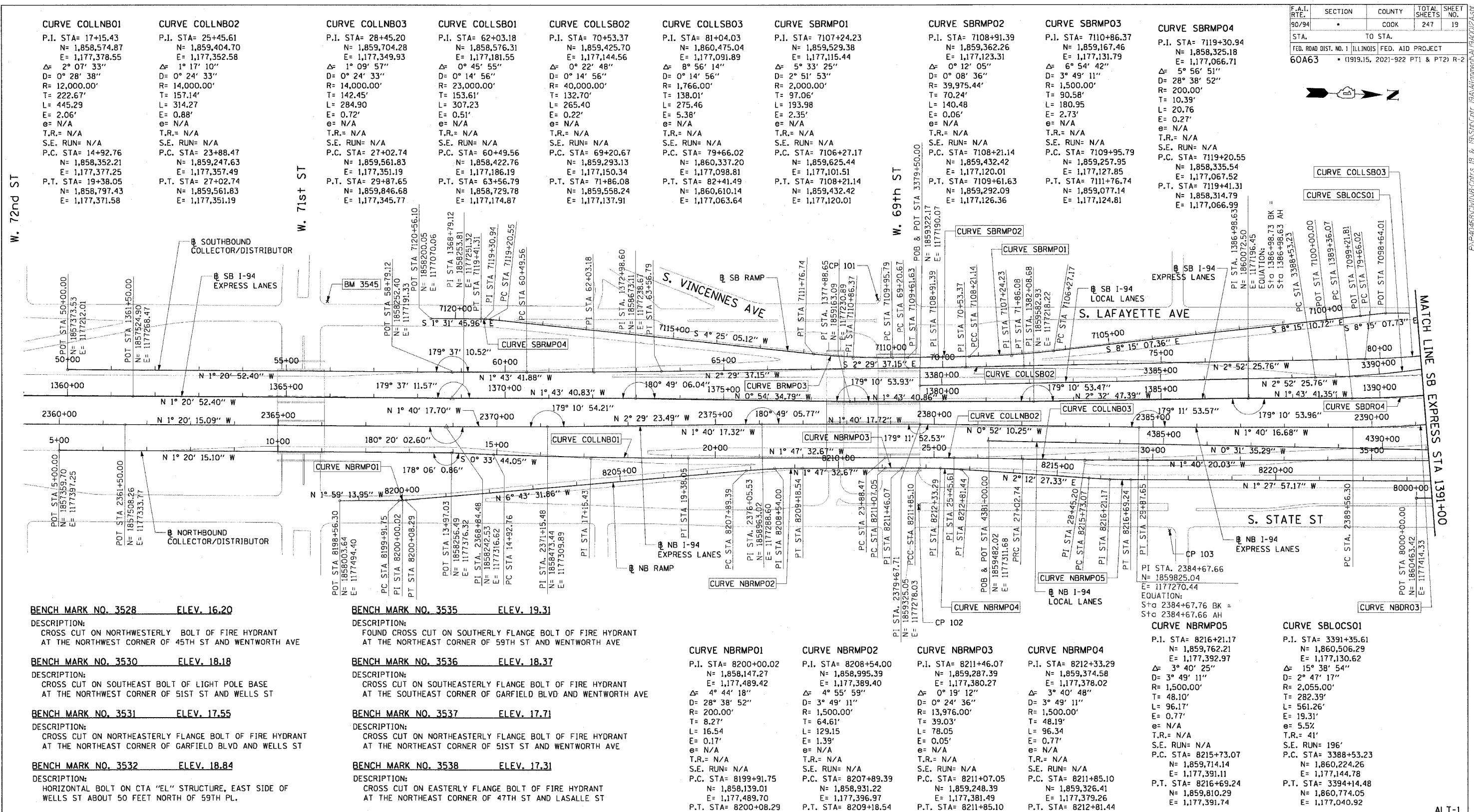
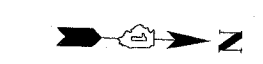

| CURVE COLLNO1  | CURVE COLLNO2  |
|--|--|
| P.I. STA= 17+15.43<br>N= 1,858,574.87<br>E= 1,177,378.55<br>Δ= 2° 07' 33"<br>D= 0° 28' 38"<br>R= 12,000.00'<br>T= 222.67'<br>L= 445.29<br>E= 2.06'<br>e= N/A<br>T.R.= N/A<br>S.E. RUN= N/A<br>P.C. STA= 14+92.76<br>N= 1,858,352.21<br>E= 1,177,377.25<br>P.T. STA= 19+38.05<br>N= 1,858,797.43<br>E= 1,177,371.58 | P.I. STA= 25+45.61<br>N= 1,859,404.70<br>E= 1,177,352.58<br>Δ= 1° 17' 10"<br>D= 0° 24' 33"<br>R= 14,000.00'<br>T= 157.14'<br>L= 314.27<br>E= 0.88'<br>e= N/A<br>T.R.= N/A<br>S.E. RUN= N/A<br>P.C. STA= 23+88.47<br>N= 1,859,247.63<br>E= 1,177,357.49<br>P.T. STA= 27+02.74<br>N= 1,859,561.83<br>E= 1,177,351.19 |

| CURVE COLLNO3  | CURVE COLLNO4  |
|--|--|
| P.I. STA= 28+45.20<br>N= 1,859,704.28<br>E= 1,177,349.93<br>Δ= 1° 09' 57"<br>D= 0° 24' 33"<br>R= 14,000.00'<br>T= 142.45'<br>L= 284.90<br>E= 0.72'<br>e= N/A<br>T.R.= N/A<br>S.E. RUN= N/A<br>P.C. STA= 27+02.74<br>N= 1,859,561.83<br>E= 1,177,351.19<br>P.T. STA= 29+87.65<br>N= 1,859,846.68<br>E= 1,177,345.77 | P.I. STA= 62+03.18<br>N= 1,858,576.31<br>E= 1,177,181.55<br>Δ= 0° 45' 57"<br>D= 0° 14' 56"<br>R= 23,000.00'<br>T= 153.61'<br>L= 307.23<br>E= 0.51'<br>e= N/A<br>T.R.= N/A<br>S.E. RUN= N/A<br>P.C. STA= 60+49.56<br>N= 1,858,422.76<br>E= 1,177,186.19<br>P.T. STA= 63+56.79<br>N= 1,858,729.78<br>E= 1,177,174.87 |

| CURVE COLLNO5  | CURVE COLLNO6   |
|--|---|
| P.I. STA= 70+53.37<br>N= 1,859,425.70<br>E= 1,177,144.56<br>Δ= 0° 22' 48"<br>D= 0° 14' 56"<br>R= 40,000.00'<br>T= 132.70'<br>L= 265.40<br>E= 0.22'<br>e= N/A<br>T.R.= N/A<br>S.E. RUN= N/A<br>P.C. STA= 69+20.67<br>N= 1,859,293.13<br>E= 1,177,150.34<br>P.T. STA= 71+86.08<br>N= 1,859,558.24<br>E= 1,177,137.91 | P.I. STA= 81+04.03<br>N= 1,860,475.04<br>E= 1,177,091.89<br>Δ= 0° 56' 14"<br>D= 0° 14' 56"<br>R= 1,766.00'<br>T= 138.01'<br>L= 275.46<br>E= 5.38'<br>e= N/A<br>T.R.= N/A<br>S.E. RUN= N/A<br>P.C. STA= 79+66.02<br>N= 1,860,337.20<br>E= 1,177,098.81<br>P.T. STA= 82+41.49<br>N= 1,860,610.14<br>E= 1,177,063.64 |

| CURVE SBRMPO1  | CURVE SBRMPO2   |
|--|---|
| P.I. STA= 7107+24.23<br>N= 1,859,529.38<br>E= 1,177,115.44<br>Δ= 5° 33' 25"<br>D= 2° 51' 53"<br>R= 2,000.00'<br>T= 97.06'<br>L= 193.98<br>E= 0.22'<br>e= N/A<br>T.R.= N/A<br>S.E. RUN= N/A<br>P.C. STA= 7108+21.14<br>N= 1,859,625.44<br>E= 1,177,120.01<br>P.T. STA= 7108+21.14<br>N= 1,859,432.42<br>E= 1,177,120.01 | P.I. STA= 7108+91.39<br>N= 1,859,362.26<br>E= 1,177,123.31<br>Δ= 0° 12' 05"<br>D= 0° 08' 36"<br>R= 39,975.44'<br>T= 70.24'<br>L= 140.48<br>E= 0.06'<br>e= N/A<br>T.R.= N/A<br>S.E. RUN= N/A<br>P.C. STA= 7108+21.14<br>N= 1,859,432.42<br>E= 1,177,120.01<br>P.T. STA= 7109+61.63<br>N= 1,859,292.09<br>E= 1,177,126.36 |

| CURVE SBRMPO3  | CURVE SBRMPO4  |
|--|--|
| P.I. STA= 7110+86.37<br>N= 1,859,167.46<br>E= 1,177,131.79<br>Δ= 6° 54' 42"<br>D= 3° 49' 11"<br>R= 1,500.00'<br>T= 90.58'<br>L= 180.95<br>E= 2.73'<br>e= N/A<br>T.R.= N/A<br>S.E. RUN= N/A<br>P.C. STA= 7109+95.79<br>N= 1,859,257.95<br>E= 1,177,127.85<br>P.T. STA= 7111+76.74<br>N= 1,859,077.14<br>E= 1,177,124.81 | P.I. STA= 7119+30.94<br>N= 1,858,325.18<br>E= 1,177,066.71<br>Δ= 5° 56' 51"<br>D= 28° 38' 52"<br>R= 200.00'<br>T= 10.39'<br>L= 20.76<br>E= 0.27'<br>e= N/A<br>T.R.= N/A<br>S.E. RUN= N/A<br>P.C. STA= 7119+20.55<br>N= 1,858,335.54<br>E= 1,177,067.52<br>P.T. STA= 7119+41.31<br>N= 1,858,314.79<br>E= 1,177,066.99 |

|  |  |  |  |   |
|--|--|--|--|---|
| <b>BENCH MARK NO. 3528</b> ELEV. 16.20<br>DESCRIPTION:<br>CROSS CUT ON NORTHWESTERLY BOLT OF FIRE HYDRANT AT THE NORTHWEST CORNER OF 45TH ST AND WENTWORTH AVE | <b>BENCH MARK NO. 3530</b> ELEV. 18.18<br>DESCRIPTION:<br>CROSS CUT ON SOUTHEAST BOLT OF LIGHT POLE BASE AT THE NORTHWEST CORNER OF 51ST ST AND WELLS ST | <b>BENCH MARK NO. 3531</b> ELEV. 17.55<br>DESCRIPTION:<br>CROSS CUT ON NORTHEASTERLY FLANGE BOLT OF FIRE HYDRANT AT THE NORTHEAST CORNER OF GARFIELD BLVD AND WELLS ST | <b>BENCH MARK NO. 3532</b> ELEV. 18.84<br>DESCRIPTION:<br>HORIZONTAL BOLT ON CTA "EL" STRUCTURE, EAST SIDE OF WELLS ST ABOUT 50 FEET NORTH OF 59TH PL. | <b>BENCH MARK NO. 3533</b> ELEV. 19.71<br>DESCRIPTION:<br>BRASS DISK (CTA MONUMENT) AT THE SOUTHWEST CORNER OF 63RD ST AND HARVARD ST |
|--|--|--|--|---|

|   |   |   |   |  |
|---|---|---|---|--|
| <b>BENCH MARK NO. 3535</b> ELEV. 19.31<br>DESCRIPTION:<br>FOUND CROSS CUT ON SOUTHERLY FLANGE BOLT OF FIRE HYDRANT AT THE NORTHEAST CORNER OF 59TH ST AND WENTWORTH AVE | <b>BENCH MARK NO. 3536</b> ELEV. 18.37<br>DESCRIPTION:<br>CROSS CUT ON SOUTHEASTERLY FLANGE BOLT OF FIRE HYDRANT AT THE SOUTHEAST CORNER OF GARFIELD BLVD AND WENTWORTH AVE | <b>BENCH MARK NO. 3537</b> ELEV. 17.71<br>DESCRIPTION:<br>CROSS CUT ON NORTHEASTERLY FLANGE BOLT OF FIRE HYDRANT AT THE NORTHEAST CORNER OF 51ST ST AND WENTWORTH AVE | <b>BENCH MARK NO. 3538</b> ELEV. 17.31<br>DESCRIPTION:<br>CROSS CUT ON EASTERLY FLANGE BOLT OF FIRE HYDRANT AT THE NORTHEAST CORNER OF 47TH ST AND LASALLE ST | <b>BENCH MARK NO. 3544</b> ELEV. 19.38<br>DESCRIPTION:<br>CROSS CUT ON WESTERLY FLANGE BOLT OF FIRE HYDRANT AT THE NORTHWEST CORNER OF 67TH ST AND LAFAYETTE AVE |
|---|---|---|---|--|

|   |  |  |  |
|---|--|--|--|
| <b>CURVE NBRMPO1</b><br>P.I. STA= 8200+00.02<br>N= 1,858,147.27<br>E= 1,177,489.42<br>Δ= 4° 44' 18"<br>D= 28° 38' 52"<br>R= 200.00'<br>T= 8.27'<br>L= 16.54<br>E= 0.17'<br>e= N/A<br>T.R.= N/A<br>S.E. RUN= N/A<br>P.C. STA= 8199+91.75<br>N= 1,858,139.01<br>E= 1,177,489.70<br>P.T. STA= 8200+08.29<br>N= 1,858,155.49<br>E= 1,177,488.45 | <b>CURVE NBRMPO2</b><br>P.I. STA= 8208+54.00<br>N= 1,858,995.39<br>E= 1,177,389.40<br>Δ= 4° 55' 59"<br>D= 3° 49' 11"<br>R= 1,500.00'<br>T= 64.61'<br>L= 129.15<br>E= 1.39'<br>e= N/A<br>T.R.= N/A<br>S.E. RUN= N/A<br>P.C. STA= 8207+89.39<br>N= 1,858,931.22<br>E= 1,177,396.97<br>P.T. STA= 8209+18.54<br>N= 1,859,059.97<br>E= 1,177,387.38 | <b>CURVE NBRMPO3</b><br>P.I. STA= 8211+46.07<br>N= 1,859,287.39<br>E= 1,177,380.27<br>Δ= 0° 19' 12"<br>D= 0° 24' 36"<br>R= 13,976.00'<br>T= 39.03'<br>L= 78.05<br>E= 0.05'<br>e= N/A<br>T.R.= N/A<br>S.E. RUN= N/A<br>P.C. STA= 8211+07.05<br>N= 1,859,248.39<br>E= 1,177,381.49<br>P.T. STA= 8211+85.10<br>N= 1,859,326.41<br>E= 1,177,379.26 | <b>CURVE NBRMPO4</b><br>P.I. STA= 8212+33.29<br>N= 1,859,374.58<br>E= 1,177,378.02<br>Δ= 3° 40' 48"<br>D= 3° 49' 11"<br>R= 1,500.00'<br>T= 48.10'<br>L= 96.17'<br>E= 0.77'<br>e= N/A<br>T.R.= N/A<br>S.E. RUN= N/A<br>P.C. STA= 8211+85.10<br>N= 1,859,326.41<br>E= 1,177,379.26<br>P.T. STA= 8212+81.44<br>N= 1,859,422.73<br>E= 1,177,379.88 |
|---|--|--|--|

|  |  |
|--|--|
| <b>CURVE NBRMPO5</b><br>P.I. STA= 8216+21.17<br>N= 1,859,762.21<br>E= 1,177,392.97<br>Δ= 3° 40' 25"<br>D= 3° 49' 11"<br>R= 1,500.00'<br>T= 48.10'<br>L= 96.17'<br>E= 0.77'<br>e= N/A<br>T.R.= N/A<br>S.E. RUN= N/A<br>P.C. STA= 8215+73.07<br>N= 1,859,714.14<br>E= 1,177,391.11<br>P.T. STA= 8216+69.24<br>N= 1,859,810.29<br>E= 1,177,391.74 | <b>CURVE SBLOCSO1</b><br>P.I. STA= 3391+35.61<br>N= 1,860,506.29<br>E= 1,177,130.62<br>Δ= 15° 38' 54"<br>D= 2° 47' 17"<br>R= 2,055.00'<br>T= 282.39'<br>L= 561.26'<br>E= 19.31'<br>e= 5.52'<br>T.R.= 41'<br>S.E. RUN= 196'<br>P.C. STA= 3388+53.23<br>N= 1,860,224.26<br>E= 1,177,144.78<br>P.T. STA= 3394+14.48<br>N= 1,860,774.05<br>E= 1,177,040.92 |
|--|--|

|   |   |
|---|---|
| <b>CURVE SBLOCSO2</b><br>P.I. STA= 7099+21.81<br>N= 1,859,562.93<br>E= 1,177,218.22<br>Δ= 11° 17' 19.45"<br>D= 1386+98.73 BK =<br>Sto 1386+98.63 AH<br>Sto 1388+53.23 | <b>CURVE SBLOCSO3</b><br>P.I. STA= 7099+21.81<br>N= 1,859,562.93<br>E= 1,177,218.22<br>Δ= 11° 17' 19.45"<br>D= 1386+98.73 BK =<br>Sto 1386+98.63 AH<br>Sto 1388+53.23 |
|---|---|

**CTE | AECOM**

**BENCH MARK NO. 3545** ELEV. 10.53  
DESCRIPTION:  
CROSS CUT ON NORTHWEST BOLT OF LIGHT POLE BASE AT THE NORTHWEST CORNER OF 71ST ST AND LAFAYETTE AVE

**NOTES:**  
1. AVERAGE GRID TO GROUND CONVERSION FACTOR = 1.000010988654360

| REVISIONS |      |
|-----------|------|
| NAME      | DATE |
|           |      |
|           |      |
|           |      |
|           |      |
|           |      |

ILLINOIS DEPARTMENT OF TRANSPORTATION  
F.A.I. 90/94 (DAN RYAN EXPRESSWAY)  
63RD STREET TO GARFIELD BLVD (SB LOCAL LANES)  
**ALIGNMENT PLAN**  
SCALE: 1"=100'  
DATE: June 9, 2006  
DRAWN BY: NJH/AMM  
CHECKED BY: JAL/MS

12/26/06 12:56:32 PM