

F.A.I. RTE.	SECTION	COUNTY	TOTAL SHEETS	SHEET NO.
90/94	*	COOK	247	82
STA. 3441+00	TO STA. 3449+00			
FED. ROAD DIST. NO. 1 ILLINOIS FED. AID PROJECT				
60A63 * (1919.15, 2021-922 PT1 & PT2) R-2				

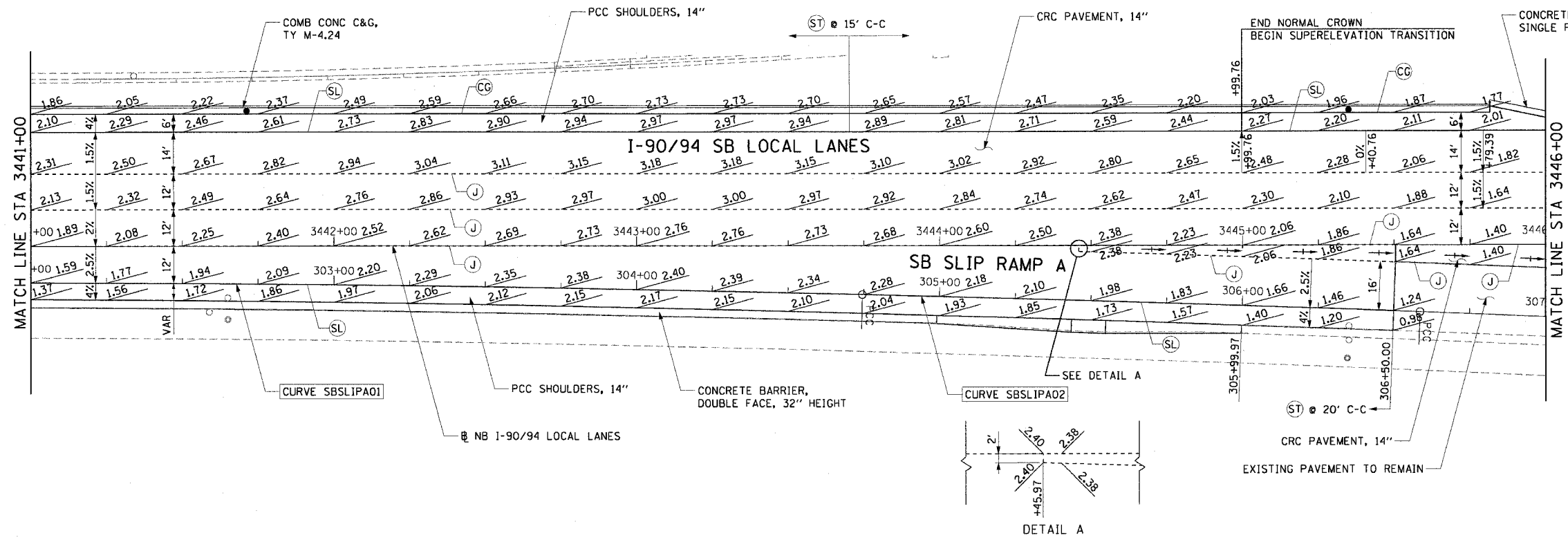

- NOTES:
- SEE ALIGNMENT AND TIES SHEETS FOR CURVE INFORMATION.
  - SEE ROADWAY PLAN SHEETS FOR BEGINNING AND END TAPER STATIONS AND TAPER RATES.
  - PAVEMENT ELEVATIONS ARE SHOWN AT 25' INTERVALS.
  - SEE ROADWAY DETAILS FOR THE TYING OF THE BARRIER BASE TO THE PCC SHOULDER.
  - TRANSITION FROM 4% SHOULDER SLOPE TO 1.5% GORE SLOPE AT A DISTANCE OF 25' FROM THE START OF THE GORE.

- LEGEND:
- Ⓞ LONGITUDINAL CURB AND GUTTER JOINT - NO. 6 EPOXY COATED TIE BARS, 24" LONG AT 24" C-C
  - Ⓝ LONGITUDINAL SAWED JOINT - NO. 6 EPOXY COATED TIE BARS, 30" LONG AT 30" C-C  
LONGITUDINAL CONSTRUCTION JOINT - NO. 8 EPOXY COATED TIE BARS, 24" LONG AT 24" C-C
  - Ⓛ LONGITUDINAL SHOULDER CONSTRUCTION JOINT - NO. 8 EPOXY COATED TIE BARS, 30" LONG AT 24" C-C
  - Ⓢ TRANSVERSE SHOULDER CONTRACTION JOINT  
- SPACED 15' C-C ALONG OUTSIDE SHOULDER  
- SPACED 20' C-C AT ALL OTHER LOCATIONS
  - ↔ SWALE

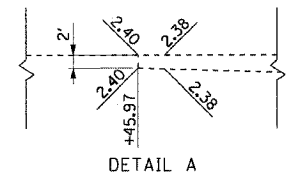

W. 59th ST

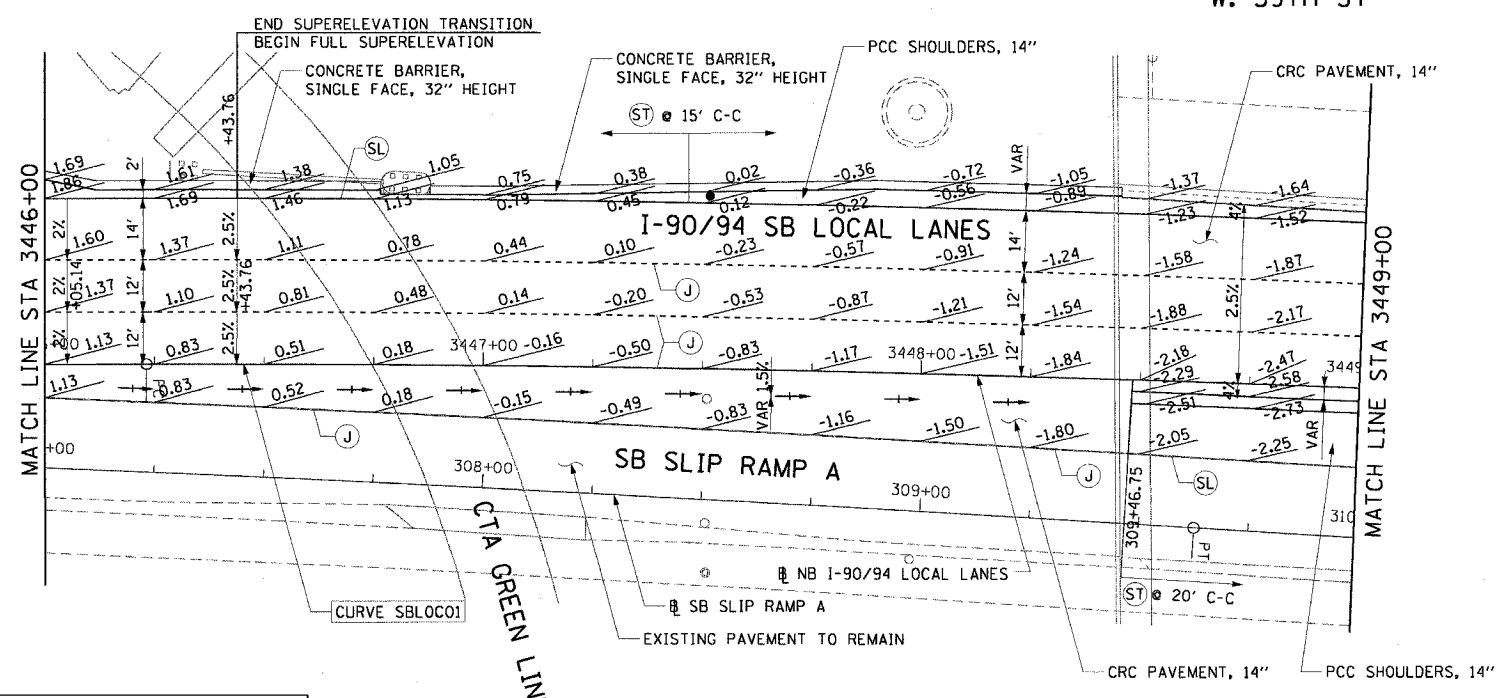

SWALE ELEVATIONS		
STATION	OFFSET	ELEVATION
3444+50.00	1.06' RT	2.36
	+75.00	1.46' RT 2.21
3445+00.00	1.88' RT	2.03
	+25.00	2.32' RT 1.83
	+50.00	2.79' RT 1.60
	+75.00	3.81' RT 1.34
3446+00.00	4.84' RT	1.05
	+25.00	5.75' RT 0.74
	+50.00	5.75' RT 0.43
	+75.00	5.75' RT 0.09
3447+00.00	5.75' RT	-0.25
	+25.00	5.75' RT -0.58
	+50.00	5.75' RT -0.92
	+75.00	5.75' RT -1.26
3448+00.00	5.75' RT	-1.61
	+25.00	5.75' RT -1.93

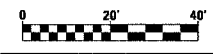

REVISIONS	
NAME	DATE

PJE-3

ILLINOIS DEPARTMENT OF TRANSPORTATION  
F.A.I. 90/94 (DAN RYAN EXPRESSWAY)  
63RD STREET TO GARFIELD BLVD (SB LOCAL LANES)

PAVEMENT JOINT AND ELEVATION PLANS

SCALE: 1"=20'  
DATE: June 9, 2006

DRAWN BY: PHP  
CHECKED BY: NJH



10/5/2006 10:53:38 PM