

F.A.I. RTE.	SECTION	COUNTY	TOTAL SHEETS	SHEET NO.
90/94		COOK	247	93
STA. 3386+00		TO STA. 3410+00		
FED. ROAD DIST. NO. 1		ILLINOIS		FED. AID PROJECT
60A63		(1919.15, 2021-922 PT1 & PT2)		R-2

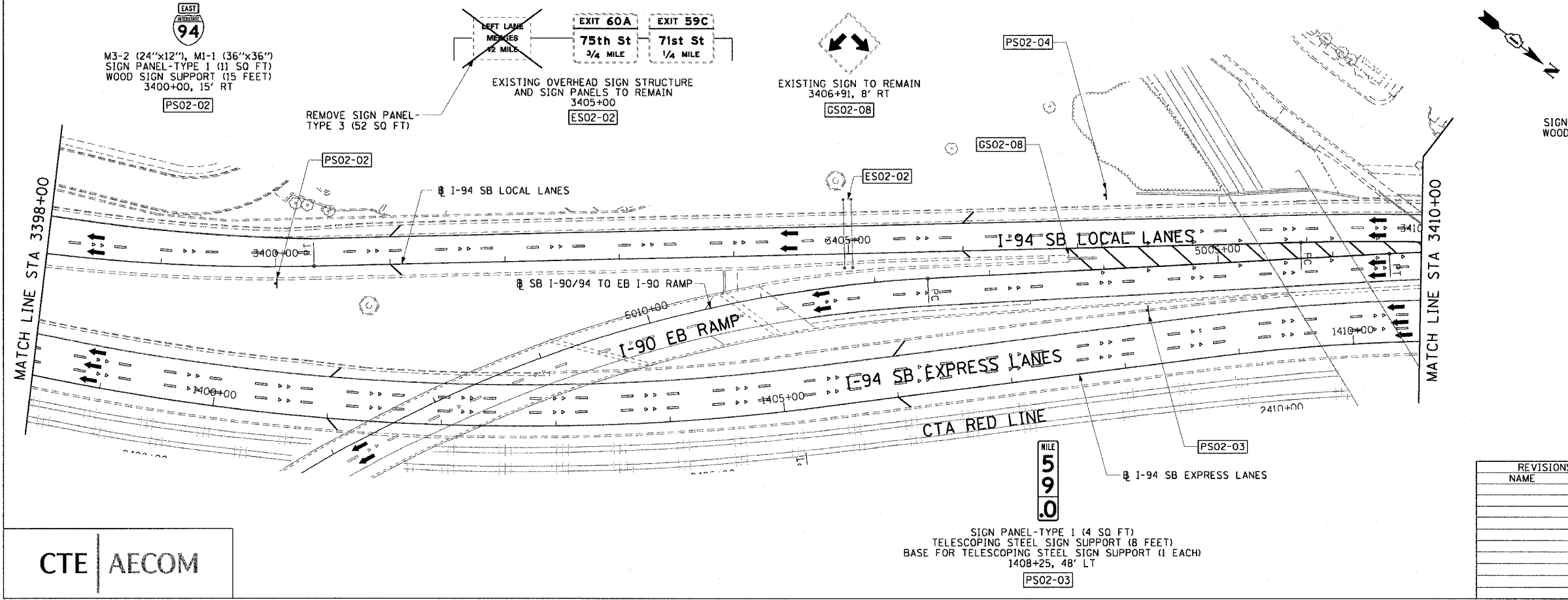
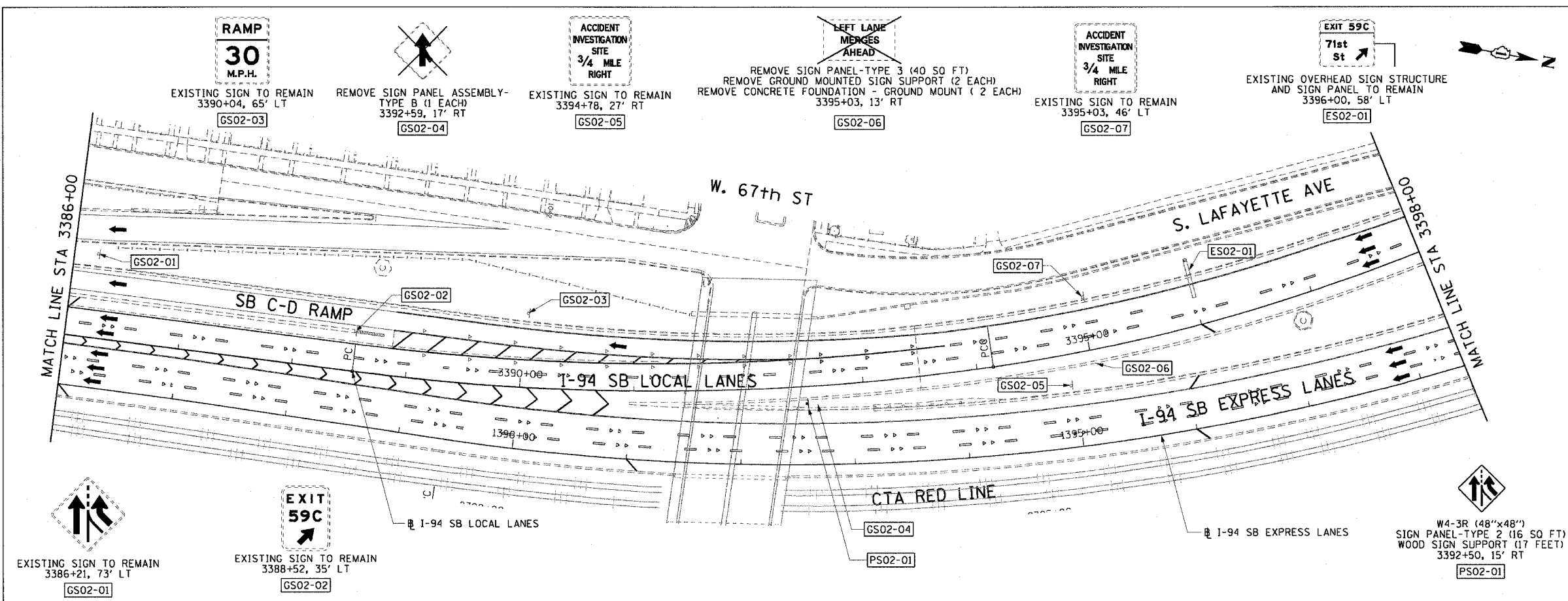

LEGEND:

- ESXX-XX EXISTING OVERHEAD OR CANTILEVER SIGNS
- GSXX-XX EXISTING POST MOUNTED SIGNS
- PSXX-XX PROPOSED SIGNS

NOTES:

- FOR MILE MARKER PANELS SEE PROPOSED SIGN PANEL DETAIL SHEETS.

REVISIONS

NAME	DATE

ILLINOIS DEPARTMENT OF TRANSPORTATION
F.A.I. 90/94 (DAN RYAN EXPRESSWAY)
63RD STREET TO GARFIELD BLVD (SB LOCAL LANES)

PROPOSED SIGNING PLANS

SCALE: 1"=50'
DATE: June 9, 2006

DRAWN BY: PHP
CHECKED BY: RMG

SG-02

CTE | AECOM

SIGN PANEL-TYPE 1 (4 SQ FT)
TELESCOPING STEEL SIGN SUPPORT (8 FEET)
BASE FOR TELESCOPING STEEL SIGN SUPPORT (1 EACH)
1408+25, 48' LT
PS02-03

PLAN 3-40-053.PLT
 6/5/2006