

F.A.I. RT.:	SECTION	COUNTY	TOTAL SHEETS	SHEET NO.
90/94		COOK	247	131
STA. 3418+76.35 TO STA. 3421+83.51				
FED. ROAD DIST. NO. 1 ILLINOIS FED. AID PROJECT				
60A63 • (1919.15, 2021-922 PT1 & PT2) R-2				

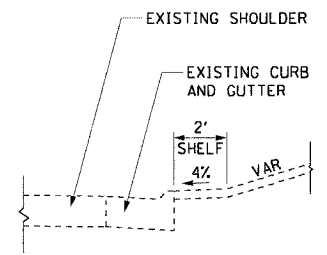

SECTION A-A

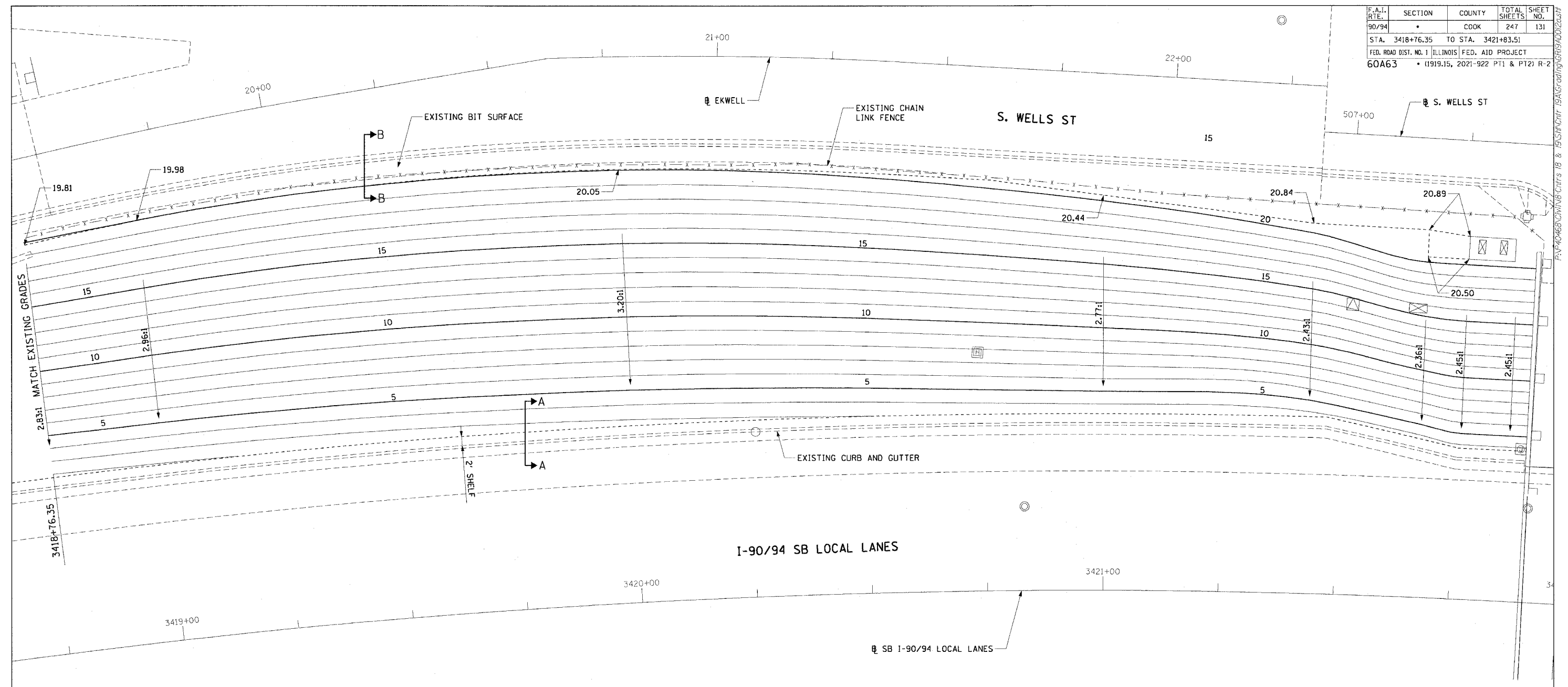
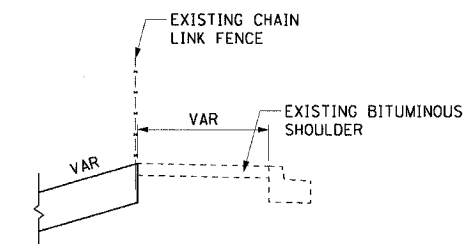

SECTION B-B

GRADING ELEVATIONS		
STATION	OFFSET	ELEV
3418+76.35	89.69' LT	19.81
3419+00.00	92.08' LT	19.98
3420+00.00	94.50' LT	20.05
3421+00.00	86.13' LT	20.44
3421+43.71	80.70' LT	20.84
3421+67.64	74.21' LT	20.50
3421+67.64	80.11' LT	20.89

NOTES:  
 1. ELEVATIONS ARE FOR FUTURE LOCATION OF FLUTED KNEE WALL CONSTRUCTED IN CONTRACT 62985.

REVISIONS	
NAME	DATE

ILLINOIS DEPARTMENT OF TRANSPORTATION  
 F.A.I. 90/94 (DAN RYAN EXPRESSWAY)  
 63RD STREET TO GARFIELD BLVD (SB LOCAL LANES)

**GRADING PLANS**

SCALE: 1"=10'  
 DATE: June 9, 2006

DRAWN BY: NJH  
 CHECKED BY: RMG



6/5/2006 10:34:22 PM  
 P:\P\0463\CHW\08\Chrs 18 & 19\SH\Chw 19\ANG\ad\ng\091002\02.gif