

STATE OF ILLINOIS
DEPARTMENT OF TRANSPORTATION

F.A.I. RTE.	SECTION	COUNTY	TOTAL SHEETS	SHEET NO.
90/94		COOK	247	175
STA.	TO STA.			
FED. ROAD DIST. NO. 1	ILLINOIS FED. AID PROJECT			
60A63	1919.15, 2021-922 PT1 & PT2 R-2			

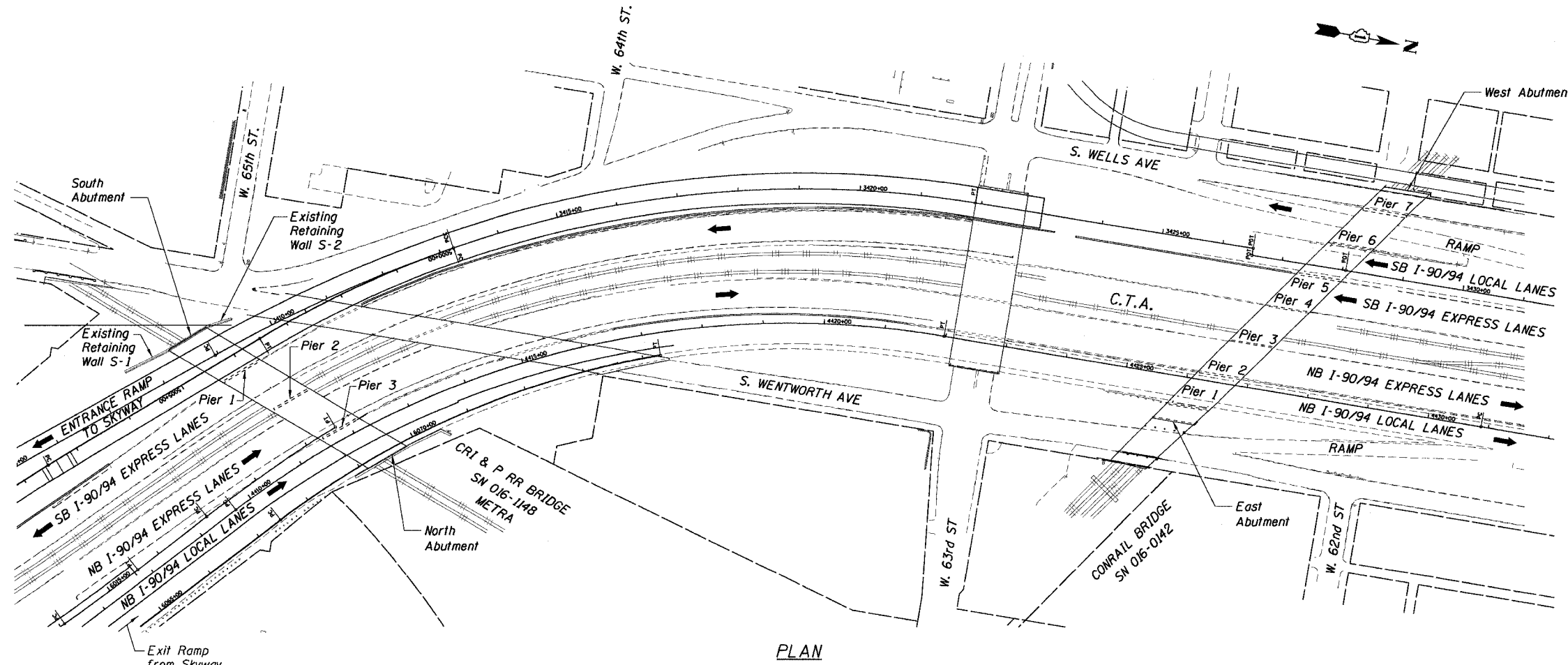

TOTAL BILL OF MATERIAL
Structure No. 016-1148

Item	Unit	Quantity
Structural Repair of Concrete (Depth Equal to or Less Than 5")	Sq Ft	903
Epoxy Crack Sealing	LF	140
Protective Coat	Sq Yd	101

TOTAL BILL OF MATERIAL
Structure No. 016-0142

Item	Unit	Quantity
Structural Repair of Concrete (Depth Equal to or Less Than 5")	Sq Ft	715
Structural Repair of Concrete (Special)	Sq Ft	1,196
Epoxy Crack Sealing	LF	213
Protective Coat	Sq Yd	213



GENERAL NOTES:

- Pier Repair Locations and Quantities are estimated. The necessary adjustments based on current field conditions will be made at time of construction. However, such variations shall not be cause for additional compensation for a change in the Scope of Work; however, the Contractor will be paid for the quantity actually furnished at the Unit Price bid for the Work.
- The Contractor shall expose the top of footing at all pier and abutment repair locations. The cost shall be included in the cost of Structural Repair of Concrete.
- Delaminated and spalled areas of concrete shall be repaired by utilizing Structural Repair of Concrete and described in the Specifications as Structural Repair of Concrete.
- Cracks shall be repaired by utilizing the Epoxy Crack Sealing and described in Section 590 of the Standard Specifications as Epoxy Crack Sealing.
- The approximate location of the downspout is shown in the Elevation. If repairs are to be made near the attachments of the downspout, the downspout shall be detached before making the repairs. The Contractor shall reattach the downspout. The cost of the detachment and reattachment of the downspouts to the Piers shall be included in the cost of Structural Repair of Concrete and Structural Repair of Concrete (Special).
- Existing rustication shall be maintained and re-established in new repair areas and shall be included in the cost of Structural Repair of Concrete and Structural Repair of Concrete (Special).
- The Contractor shall provide Railroad Protective Liability Insurance in accordance with Articles 107.11 and 107.12 of the Standard Specifications for all Railroad Highway Crossings and the Chicago Transit Authority (CTA). The CTA has additional requirements as shown in the "CTA Coordination" provision as shown in the Contract Special Provisions.

INDEX OF SHEETS

- BR1 General Plan
- BR2 Pier 1 - Plan and Elevation (SN 016-1148)
- BR3 South Abutment - Plan and Elevation (SN 016-1148)
- BR4 Pier 5 (West Face) - Plan and Elevation (SN 016-0142)
- BR5 Pier 6 - Plan and Elevation (SN 016-0142)
- BR6 Pier 7 and West Abutment - Plan and Elevation (SN 016-0142)

DESIGN SPECIFICATIONS

2002 AASHTO, Standard Specifications for Highway Bridges

DESIGN STRESSES

$f'_c = 3,500$ psi
 $f_y = 60,000$ psi (Reinf.)

SUBSTRUCTURE REPAIR WORK ITEMS

- Metra Railroad Bridge (SN 016-1148)
 - Pier 1 Repairs (South Face)
 - South Abutment Repairs (North Face)
- Conrail Railroad Bridge (SN 016-0142)
 - Pier 5 Repairs (West Face)
 - Pier 6 Repairs (East and West Face)
 - Pier 7 Repairs (East and West Face)

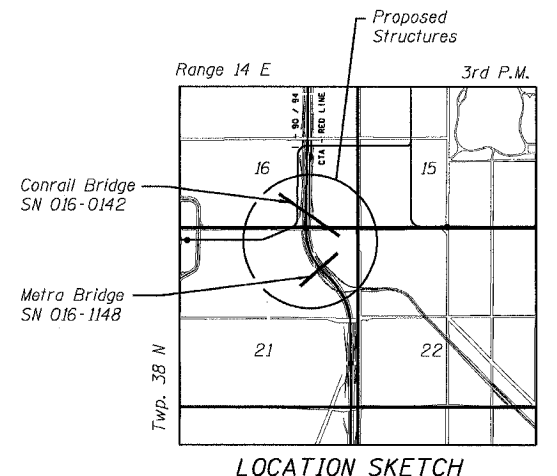

LOCATION SKETCH

Sheet BR1 of 6

REVISIONS		ILLINOIS DEPARTMENT OF TRANSPORTATION F.A.I. 90/94 (DAN RYAN EXPRESSWAY) 63RD STREET TO GARFIELD BLVD (SB LOCAL LANES) GENERAL PLAN SUBSTRUCTURE AND ABUTMENT REPAIRS METRA BRIDGE (SN 016-1148) AND CONRAIL BRIDGE (SN 016-0142) COOK COUNTY
NAME	DATE	
		SCALE: None DATE: June 9, 2006 DRAWN BY: CHD CHECKED BY: MJP

F:\P\04663\Drawings\016-1148\016-0142\016-0142-0006-3.dwg 10:52:15 AM 6/27/2006