

F.A.S. RTE.	SECTION	COUNTY	TOTAL SHEETS	SHEET NO.
516	241BR & 56BR	CHAMPAIGN	82	20
STA. 0+00.00		TO STA. 7+00.00		
FED. ROAD DIST. NO.	ILLINOIS	FED. AID PROJECT		

EROSION CONTROL PLAN

PROPOSED S.N. 010-0221

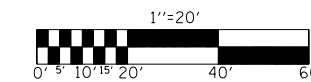

Gene & Maryellen Irick

Ella L. Flessner

SEC. 22, T. 20 N., R. 10 E., 3RD P.M.

Ella L. Flessner

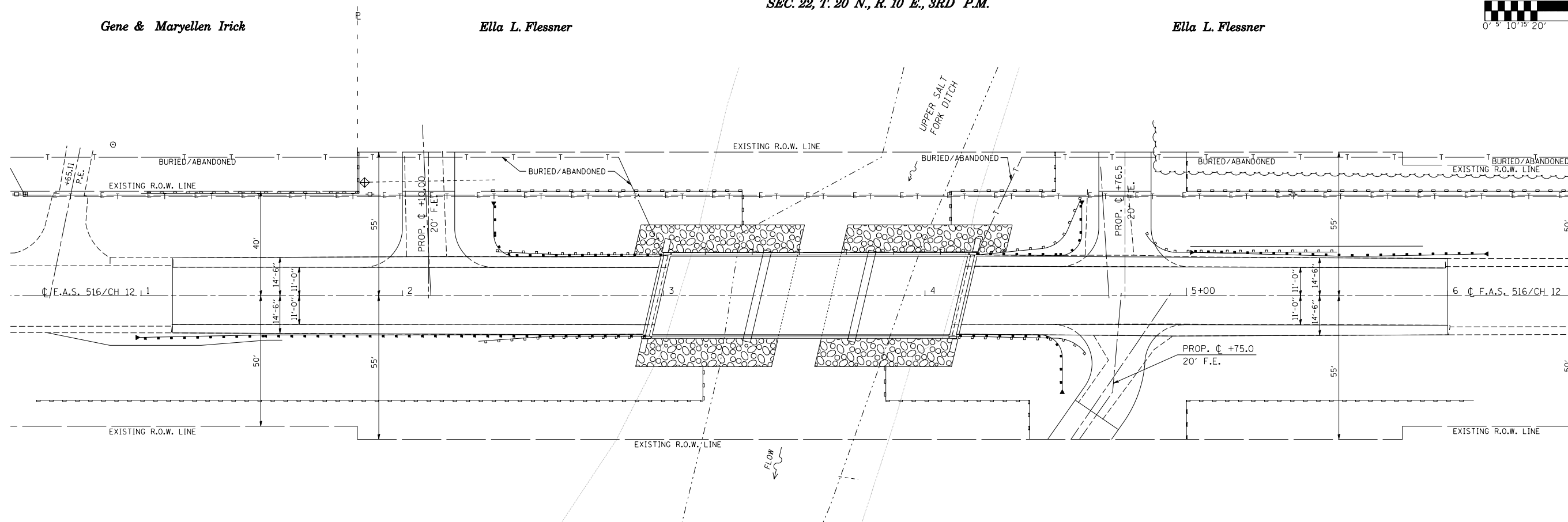

Gary & Nancy Olson

Gary & Nancy Olson

SEC. 23, T. 20 N., R. 10 E., 3RD P.M.

28000500 INLET AND PIPE PROTECTION

STATION	QUANTITY (EACH)
LT. 1+88.00	1.0
TOTAL	= 1.0 EACH

28000400 PERIMETER EROSION BARRIER

LOCATION (QUADRANT)	QUANTITY (FOOT)
SOUTHWEST	213.0
SOUTHEAST	270.0
NORTHWEST	235.0
NORTHEAST	210.0
TOTAL	= 928.0 FOOT

SEEDING, CLASS 2

STATION	TO	STATION	25000200 SEEDING (SQ FT)	25000400 NITROGEN (90.0 LB/ACRE)	25000500 PHOSPHORUS (90.0 LB/ACRE)	25000600 POTASSIUM (90.0 LB/ACRE)	25100115 MULCH (SQ FT)
RT. 0+63.87	TO	2+90.10	2,972.4	6.1	6.1	6.1	2,972.4
RT. 4+12.50	TO	6+10.00	4,389.1	9.1	9.1	9.1	4,389.1
LT. 1+12.00	TO	3+00.00	2,883.6	6.0	6.0	6.0	2,883.6
LT. 4+22.30	TO	6+46.73	4,609.4	9.5	9.5	9.5	4,609.4
TOTAL			= 14,854.5 SQ FT	30.7 LB	30.7 LB	30.7 LB	14,854.5 SQ FT
USE			= 0.4 ACRE	31.0 LB	31.0 LB	31.0 LB	0.4 ACRE

25000350 SEEDING, CLASS 7

(USE THE SAME AREA AS SEEDING, CLASS 2)

TOTAL = 14,854.5 SQ FT
USE = 0.4 ACRE

28000250 TEMPORARY EROSION CONTROL SEEDING

APPLICATION RATE = 100 LB/ACRE
(USE THE SAME AREA AS SEEDING, CLASS 2)

TOTAL = 34.0 LB

LEGEND

- PERIMETER EROSION BARRIER
- STONE RIPRAP, CLASS A-4
- INLET AND PIPE PROTECTION

SEEDING PAY LIMITS:

SEEDING LIMITS SHALL BE DEFINED AS AREAS OF EARTH SLOPES WHICH ARE DISTURBED AS SHOWN ON THE STATION CROSS SECTIONS.

ILLINOIS DEPARTMENT OF TRANSPORTATION
EROSION CONTROL PLAN
PROPOSED S.N. 010-0221
F.A.P. 516/(C.H. 12)
SECTION 241BR & 56BR
CHAMPAIGN COUNTY

SCALE: 1" = 20' DRAWN BY: B.B.P.
DATE: 05/15/06 CHECKED BY: G.A.E.