

F.A.S. RTE.	SECTION	COUNTY	TOTAL SHEETS	SHEET NO.
516	241BR & 56BR	CHAMPAIGN	82	46
STA. 135+00.00		TO STA. 141+00.00		
FED. ROAD DIST. NO.		ILLINOIS	FED. AID PROJECT	

EROSION CONTROL PLAN

PROPOSED S.N. 010-2028

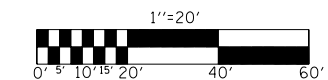

SEC. 34, T20N, R10E, 3rd. P.M.

Charles W. Plotner
5425001

Dean Crider, as Trustee (1/2 Int.)
&
Lois A Crider, as Trustee (1/2 Int.)
5425002

Clifford E. And Shirley J. McDuffie
as Tenants by the Entirety
5425003

PROPOSED STRUCTURE NO. 010-2028
DOUBLE BARREL 12' x 12' x 32'
PRECAST CONCRETE BOX CULVERT (M273)
STATION 137+67, 0° SKEW
DESIGN FILL HEIGHT < 2'
EXISTING STRUCTURE NO. 010-0087
SINGLE SPAN REINFORCED CONCRETE SLAB
STATION 137+67, 0° SKEW
26' BACK TO BACK ABUTMENT

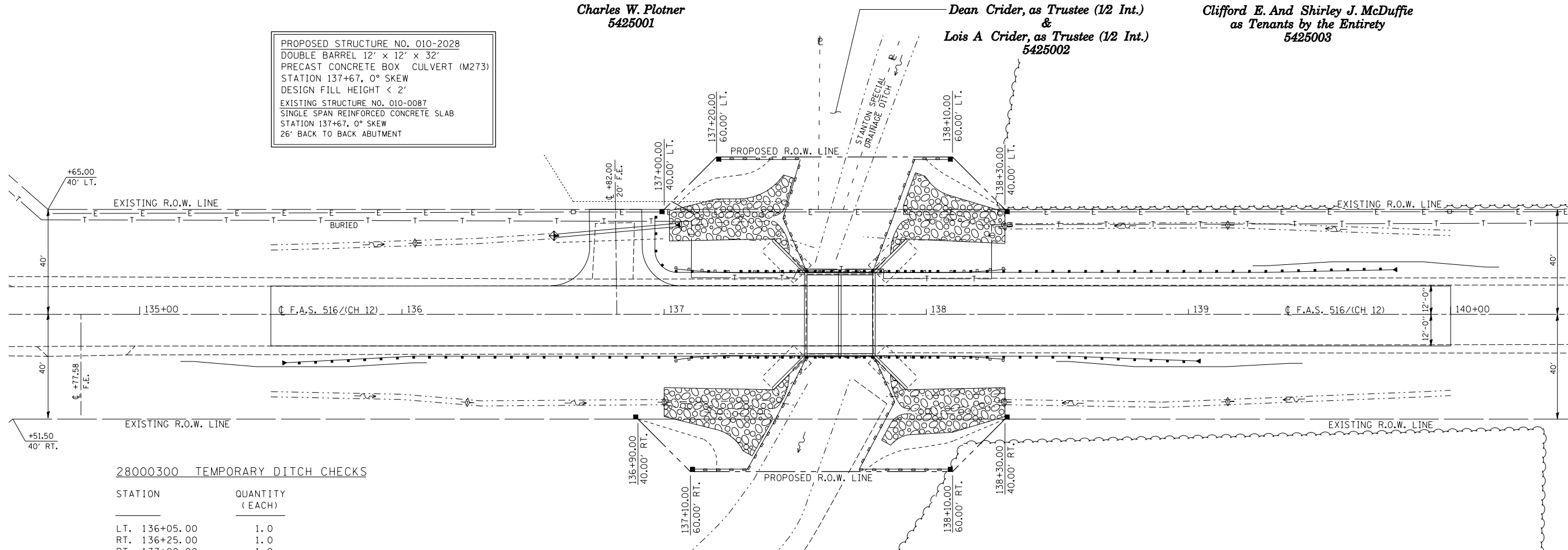

28000300 TEMPORARY DITCH CHECKS

STATION	QUANTITY (EACH)
LT. 136+05.00	1.0
RT. 136+25.00	1.0
RT. 137+00.00	1.0
RT. 138+30.00	1.0
LT. 138+30.00	1.0
RT. 139+15.00	1.0
LT. 139+15.00	1.0
TOTAL	= 7.0 EACH

28000500 INLET AND PIPE PROTECTION

STATION	QUANTITY (EACH)
LT. 136+60.00	1.0
TOTAL	= 1.0 EACH

28000400 PERIMETER EROSION BARRIER

LOCATION (QUADRANT)	QUANTITY (FOOT)
SOUTHWEST	84.0
SOUTHEAST	76.0
NORTHWEST	70.0
NORTHEAST	84.0
TOTAL	= 314.0 FOOT

SEEDING, CLASS 2

STATION	TO	STATION	25000200 SEEDING (SQ FT)	25000400 NITROGEN (90.0 LB/ACRE)	25000500 PHOSPHORUS (90.0 LB/ACRE)	25000600 POTASSIUM (90.0 LB/ACRE)	25100115 MULCH (SQ FT)
RT. 135+20.00	TO	137+54.20	5,527.4	11.4	11.4	11.4	5,527.4
RT. 137+79.60	TO	140+15.00	5,557.6	11.5	11.5	11.5	5,557.6
LT. 135+40.00	TO	137+54.20	5,436.1	11.2	11.2	11.2	5,436.1
LT. 137+79.60	TO	140+15.00	5,583.8	11.5	11.5	11.5	5,583.8
TOTAL			= 22,104.9 SQ FT	45.6 LB	45.6 LB	45.6 LB	22,104.9 SQ FT
USE			= 0.5 ACRE	46.0 LB	46.0 LB	46.0 LB	0.5 ACRE

25000350 SEEDING, CLASS 7

(USE THE SAME AREA AS SEEDING, CLASS 2)
TOTAL = 22,104.9 SQ FT
USE = 0.5 ACRE

28000250 TEMPORARY EROSION CONTROL SEEDING

APPLICATION RATE = 100 LB/ACRE
(USE THE SAME AREA AS SEEDING, CLASS 2)
TOTAL = 51.0 LB

LEGEND

- TEMPORARY DITCH CHECK
- INLET & PIPE PROTECTION
- PERIMETER EROSION BARRIER
- STONE RIPRAP, CLASS A-4

SEEDING PAY LIMITS:

SEEDING LIMITS SHALL BE DEFINED AS AREAS OF EARTH SLOPES WHICH ARE DISTURBED AS SHOWN ON THE STATION CROSS SECTIONS.

ILLINOIS DEPARTMENT OF TRANSPORTATION
EROSION CONTROL PLAN
PROPOSED S.N. 010-2028
F.A.S. 516/(C.H. 12)
SECTION 241BR & 56BR
CHAMPAIGN COUNTY

SCALE: 1" = 20'
DATE: 05/15/06
DRAWN BY: B.B.P.
CHECKED BY: G.A.E.