

70 60 50 40 30 20 10 0 10 20 30 40 50 60 70

CONTRACT NO. 70359

F.A.S. 516/C.H. 12  
 PROPOSED S.N. 010-2028

SECTION	COUNTY	TOTAL SHEETS	SHEET NO.
516 241BR & 56BR	CHAMPAIGN	82	61
STA. 137+79.60 TO STA.			
FED. ROAD DIST. NO.		ILLINOIS FED. AID PROJECT	

FINAL SURVEY	DATE
BY	
NOTE BOOK	
AREAS CHECKED	

ORIGINAL SURVEY	DATE
BY	
AREAS CHECKED	

PLOT DATE = 7/6/2006  
 FILE NAME = G:\projects\0501304 (v8)\2028\010-2028.dwg  
 PLOT SCALE = 10.56882 / IN.  
 USER NAME = pfer-sondr

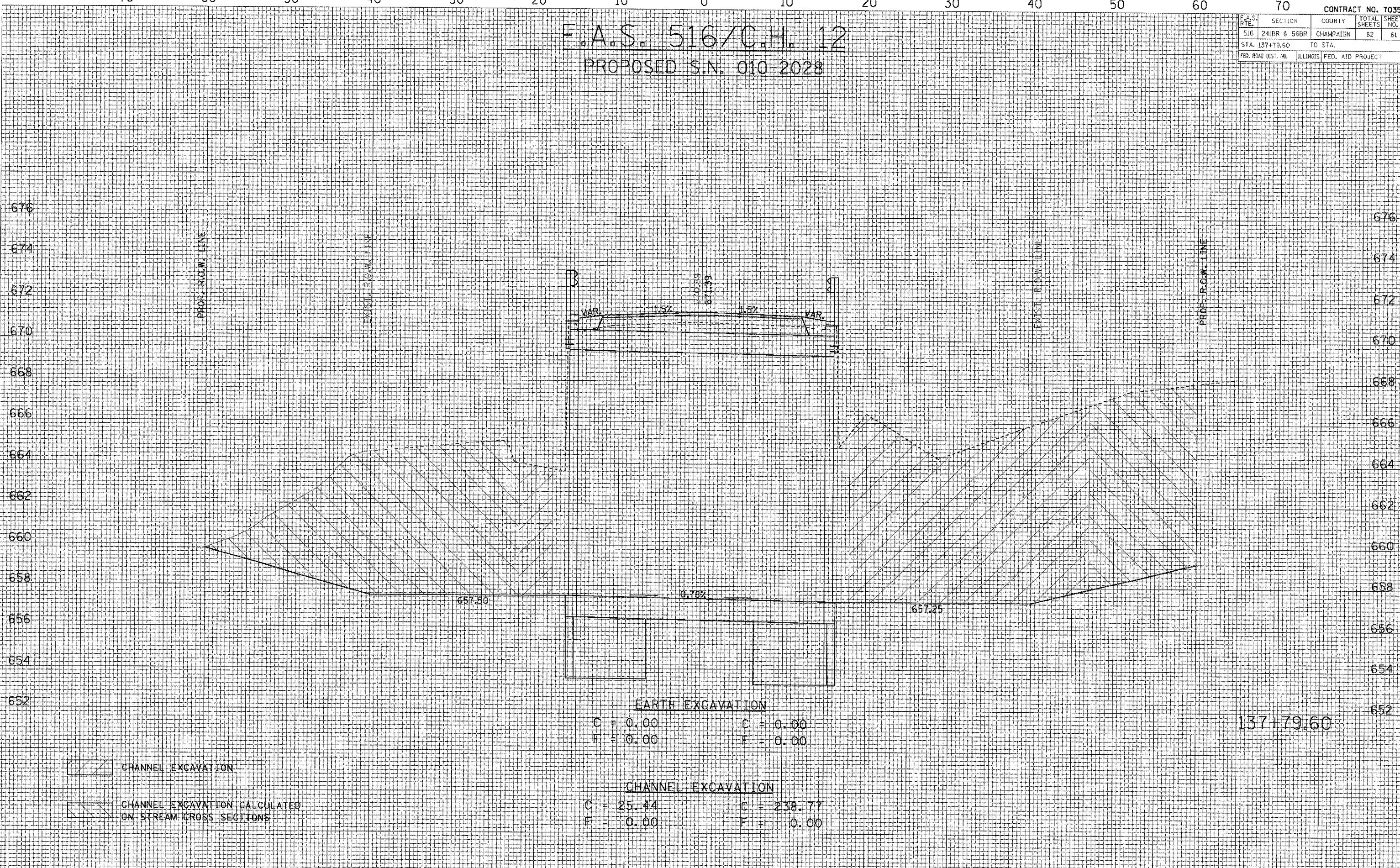

<b>EARTH EXCAVATION</b>	
C = 0.00	C = 0.00
F = 0.00	F = 0.00
<b>CHANNEL EXCAVATION</b>	
C = 25.44	C = 238.77
F = 0.00	F = 0.00

- CHANNEL EXCAVATION
- CHANNEL EXCAVATION CALCULATED ON STREAM CROSS SECTIONS

70 60 50 40 30 20 10 0 10 20 30 40 50 60 70