

F.A.S. RTE.	SECTION	COUNTY	TOTAL SHEETS	SHEET NO.
516	241BR & 56BR	CHAMPAIGN	82	76
STA.		TO STA.		
FED. ROAD DIST. NO.	ILLINOIS	FED. AID PROJECT		

DETAIL FOR DETOUR SIGNING

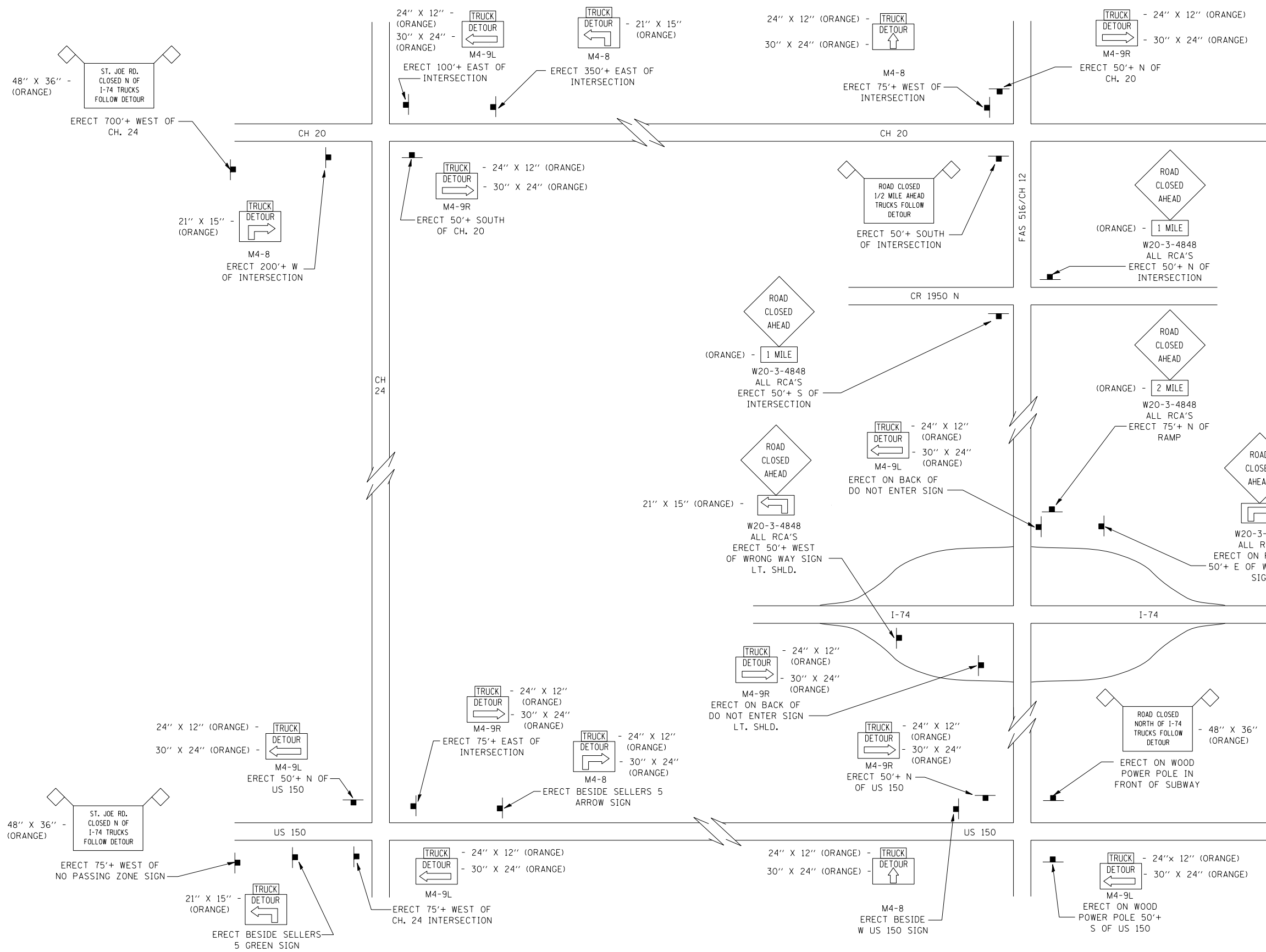

NOTE:
DETOUR SIGNING SHALL BE PAID FOR AS TRAFFIC CONTROL AND PROTECTION (SPECIAL)

ILLINOIS DEPARTMENT OF TRANSPORTATION
DETOUR SIGNING DETAIL
 F.A.S. 516/(C.H. 12)
 SECTION 241BR & 56BR
 CHAMPAIGN COUNTY

SCALE: NOT TO SCALE
 DATE: 05/16/06
 DRAWN BY: B.B.P.
 CHECKED BY: G.A.E.

PLOT DATE = 7/6/2006
 FILE NAME = c:\p\proj\516\5160304 (v8)\command\detalis.dgn
 FILE SIZE = 42,3523 / IN.
 USER NAME = pierasonbr