

FAU RTE	SECTION	COUNTY	TOTAL SHEETS	SHEET NO.
(75TH ST)1691	05-00014-00-RS	COOK	18	4
(RIVER RD)1692				
F.H.W.A. REG.	ILLINOIS	PROJECT M-8003(570)		

CONTRACT NO. 83868

WILLOW SPRINGS ROAD

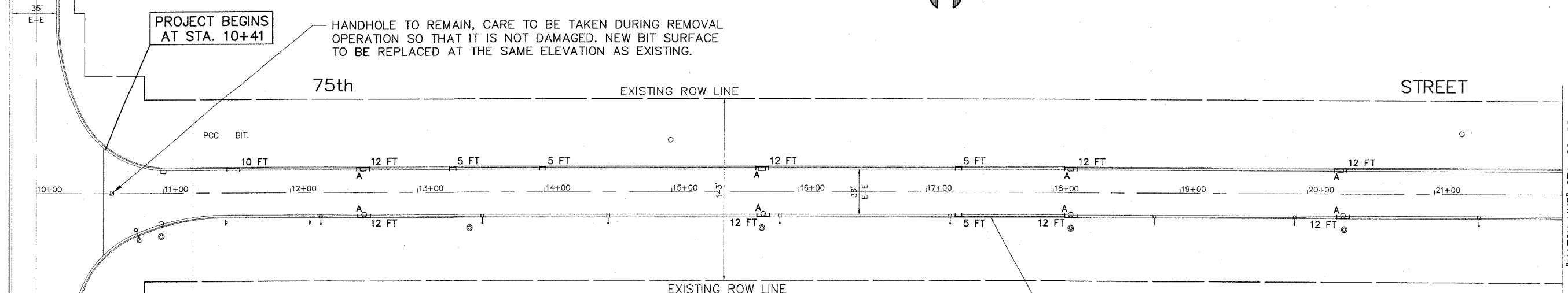

IMPORTANT!
 FULL SIZE PLANS HAVE BEEN PREPARED USING STANDARD ENGINEERING SCALES. REDUCED SIZED PLANS WILL NOT CONFORM TO STANDARD SCALES INDICATED IN TITLE BLOCK.

- LEGEND**
- DENOTES CLASS D PAVEMENT PATCHING, 9"
 - DENOTES DRIVEWAY PAVEMENT REMOVAL AND BITUMINOUS BASE COURSE, SUPERPAVE, 4" THICKNESS AND BITUMINOUS CONCRETE SURFACE COURSE, SUPERPAVE, MIXTURE C, N50, 2" THICKNESS REPLACEMENT
 - DENOTES DRIVEWAY PAVEMENT REMOVAL AND PCC REPLACEMENT (AS NOTED)

FOR CONTINUATION SEE ABOVE RIGHT

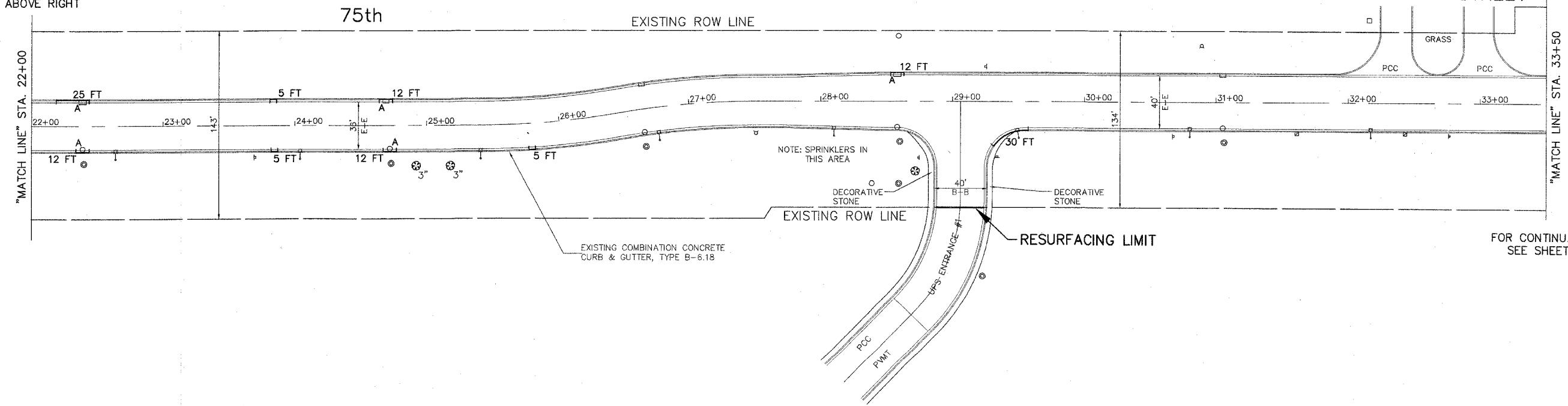

FOR CONTINUATION SEE SHEET 5

REVISIONS			
NO.	BY	DATE	DESCRIPTION
1	THK	3-29-06	IDOT - DISTRICT 1
2	THK	4-13-06	IDOT - DISTRICT 1
3	JLC	6-27-06	IDOT - DISTRICT 1