

FAU RTE	SECTION	COUNTY	TOTAL SHEETS	SHEET NO.
(75TH ST)1691	05-00014-00-RS	COOK	18	9
(RIVER RD)1692				
F.H.W.A. REG.	ILLINOIS	PROJECT M-8003(570)		

CONTRACT NO. 83868

WILLOW SPRINGS ROAD

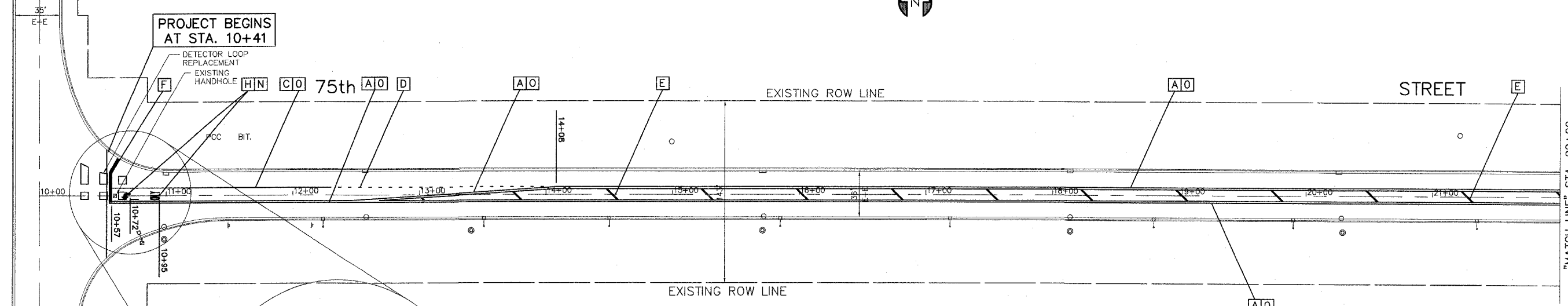

PROJECT BEGINS AT STA. 10+41

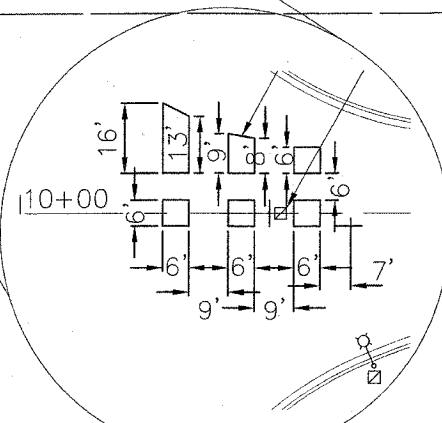

THERMOPLASTIC STRIPING CODE

- A DOUBLE SOLID YELLOW THERMOPLASTIC PAVEMENT MARKING - CENTERLINE 4" .11"O/C
- B SOLID WHITE THERMOPLASTIC PAVEMENT MARKING - LINE 6" (EDGE LINE)
- C SOLID WHITE THERMOPLASTIC PAVEMENT MARKING - LINE 6" (LANE LINE)
- D SOLID WHITE THERMOPLASTIC PAVEMENT MARKING - LINE 6", 2' DASH 6' SKIP (LANE LINE)
- E SOLID YELLOW THERMOPLASTIC PAVEMENT MARKING - LINE 12" (DIAGONALS)
- F SOLID WHITE THERMOPLASTIC PAVEMENT MARKING - LINE 24" (STOP BAR)
- G SOLID WHITE THERMOPLASTIC PAVEMENT MARKING - LINE 24" (RAILROAD WARNING & TRANSVERSE LINE)
- H SOLID WHITE THERMOPLASTIC PAVEMENT MARKING - LETTERS & SYMBOLS

PAINT STRIPING CODE

- I PAINT PAVEMENT MARKING - LETTERS & SYMBOLS
- J SOLID WHITE PAINT PAVEMENT MARKING - LINE 4"
- K SOLID WHITE PAINT PAVEMENT MARKING - LINE 6"
- L SOLID WHITE PAINT PAVEMENT MARKING - LINE 12"
- M SOLID WHITE PAINT PAVEMENT MARKING - LINE 24"

SHORT TERM STRIPING CODE

- N SHORT TERM PAVEMENT MARKING - LETTERS & SYMBOLS
- O SHORT TERM PAVEMENT MARKING - LINE 4", 2' DASH 40' SKIP

FOR CONTINUATION SEE BELOW LEFT

FOR CONTINUATION SEE ABOVE RIGHT

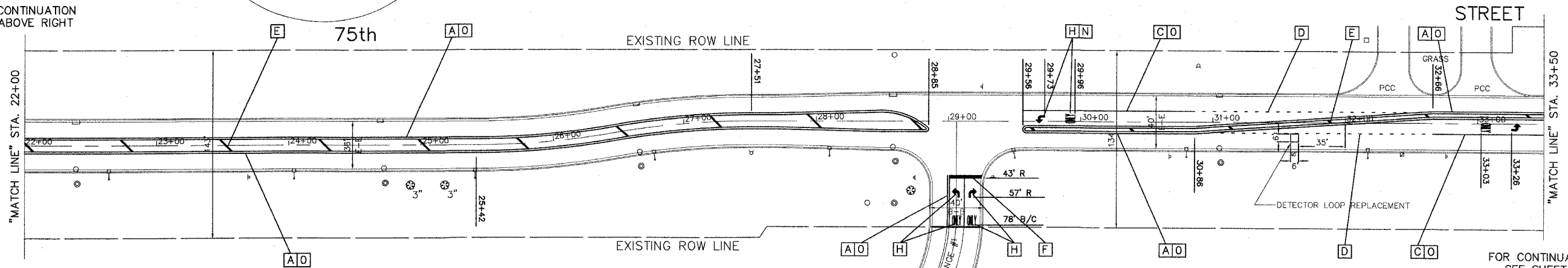

IMPORTANT!
FULL SIZE PLANS HAVE BEEN PREPARED USING STANDARD ENGINEERING SCALES. REDUCED SIZED PLANS WILL NOT CONFORM TO STANDARD SCALES INDICATED IN TITLE BLOCK.

FOR CONTINUATION SEE SHEET 5

Frank Novotny & Associates, Inc.
Civil Engineers/Municipal Consultants
825 Midway Drive • Willowbrook, IL • 60527 • Telephone: (630) 887-8640 • Fax: (630) 887-0132
Illinois Professional Design Firm No. 184-000928

PROJECT VILLAGE OF HODGKINS, ILLINOIS
75th STREET & RIVER ROAD RESURFACING
M.F.T. SECTION NO. 05-00014-00-RS

REVISIONS			
NO.	BY	DATE	DESCRIPTION
1	THK	3-29-06	IDOT - DISTRICT 1
2	THK	4-13-06	IDOT - DISTRICT 1

PAVEMENT MARKING AND DETECTOR LOOP REPLACEMENT
75TH STREET - WILLOW SPRINGS ROAD to STA. 33+50

PROJECT NO. 05084	SCALE 1"=40'
DRAWN/DESIGNED JEP/THK	DATE NOV., 2005
CHECKED/APPROVED CJA/JLC	FIELD BOOK NO. FILE

SHEET 9 OF 18 SHEETS