

1 PLAN - KNOX COUNTY HWY. 32  
 SCALE: 1" = 20'

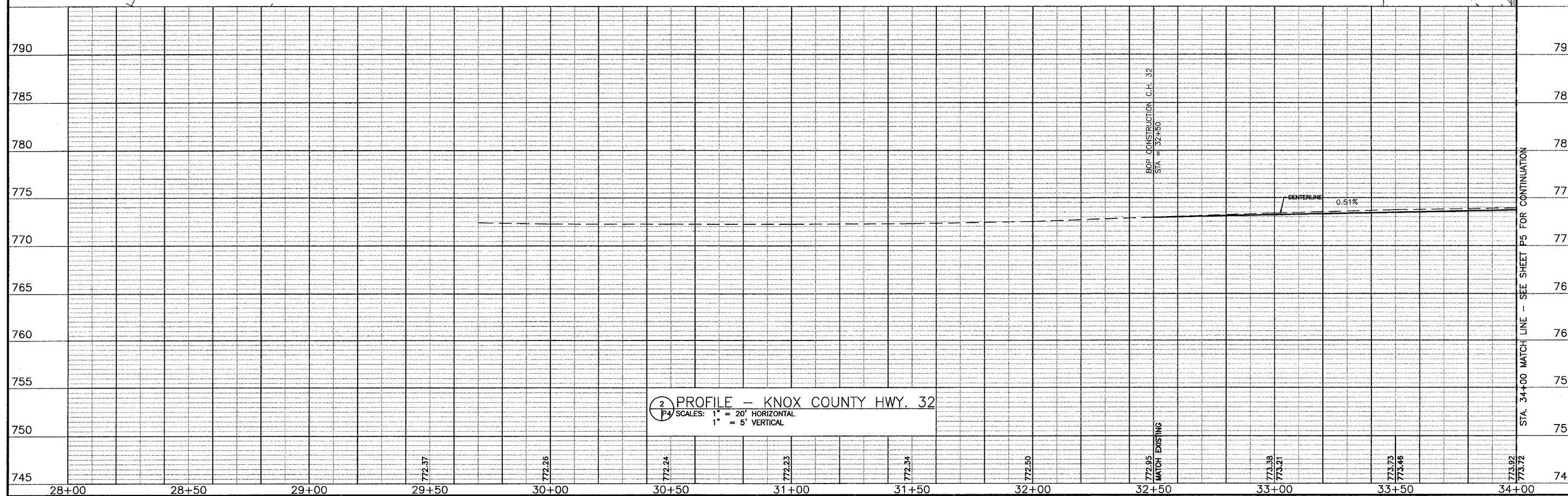

2 PROFILE - KNOX COUNTY HWY. 32  
 SCALE: 1" = 20' HORIZONTAL  
 1" = 5' VERTICAL

REVISIONS	03/06/2006 JWH
DRAWN: JWH	CHECKED: KJC
APPROVED: KJC	APPROVED: KJC
FILE NAME: 240215/P4	

**Brunet, Cooper & Zuck, Inc.**  
 Consulting Engineers  
 Structural Engineers  
 Land Surveyors  
 188 East Simmons Street  
 P.O. Box 1519  
 Celebration, Illinois 61402-1519  
 Phone: (309) 343-9282  
 Fax: (309) 343-9232  
 E-Mail: brcozengr@brcozengr.com

**PLAN & PROFILE - KNOX COUNTY HWY. 32**  
 PLANS FOR PROPOSED  
 INTERSECTION CONSTRUCTION  
 US ROUTE 150, LOGISTICS PARKWAY & KNOX COUNTY HWY. 32  
 GALESBURG, ILLINOIS

JOB NO. 240215  
 SHEET NO. 10  
**P4**  
 02/22/2005