

STATE OF ILLINOIS
DEPARTMENT OF TRANSPORTATION
DIVISION OF HIGHWAYS

PROPOSED HIGHWAY PLANS

FAU ROUTE 8075 (CARDINAL HILL ROAD-C.H.37)

SEE SHEET 2 FOR INDEX OF SHEETS,
IDOT HIGHWAY STANDARDS AND GENERAL NOTES

SURFACE TRANSPORTATION/RURAL PROGRAM
W/ HRRRP FUNDING
SECTION 03-00167-04-FP
PROJECT NO. HS-RS-167(46)
SANGAMON COUNTY
CARDINAL HILL ROAD (C.H. 37)
C-96-244-06

FAU RTE	SECTION	COUNTY	TOTAL SHEETS	SHEET NO
8075	03-00167-04-FP	SANGAMON	109	1
STA.		TO STA.		
FED. ROAD DIST. NO.	ILLINOIS	FED. AID PROJECT		

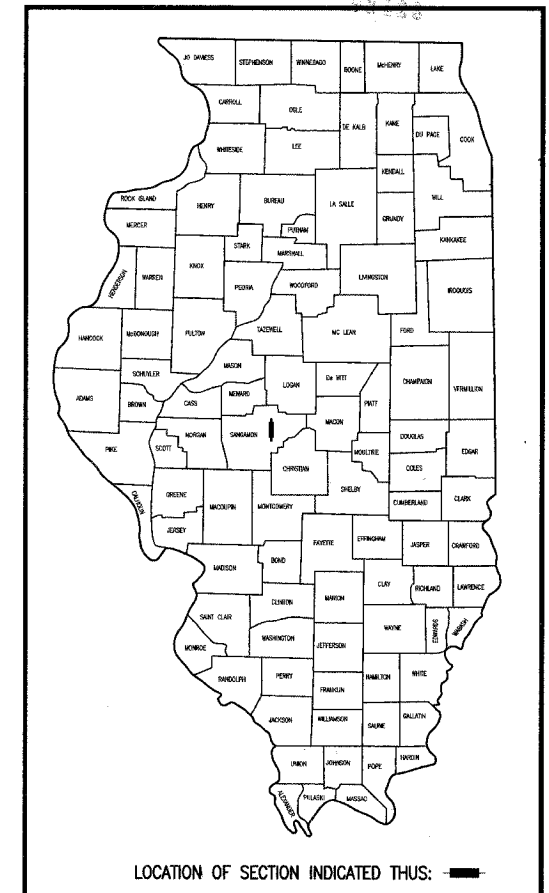

TOLL FREE

JOINT UTILITY LOCATING INFORMATION FOR EXCAVATORS
(J.U.L.I.E.) TELEPHONE NUMBER
1-800-892-0123

SBC 529 SOUTH SEVENTH ST., FLOOR 3B SPRINGFIELD, IL 62703 TERESA MAYER 217-789-8686	INSIGHT COMMUNICATIONS 711 SOUTH DIRKSEN PARKWAY SPRINGFIELD, IL 62703 DON BRITTON 217-788-5898 x671
AMEREN/CILCO 322 EAST CAPITAL AVENUE SPRINGFIELD, IL 62701 KENT KOWALSKI 309-677-5371	VILLAGE OF ROCHESTER 1 COMMUNITY DRIVE ROCHESTER, IL 62563 WAYNE BECK 217-498-7062
McLEOD USA 102 EAST SHAFER STREET FORSYTH, IL 62535 MARK MILLS 217-876-7194 x240	

UTILITY NOTE

THE LOCATIONS OF THOSE BURIED AND ABOVEGROUND UTILITIES SHOWN ARE APPROXIMATE, ARE SHOWN FOR CONTRACTOR INFORMATIONAL USE ONLY, AND ARE NOT TO BE REFERENCED FOR CONSTRUCTION PURPOSES. THE IMPLIED PRESENCE OR ABSENCE OF UTILITIES IS NOT TO BE CONSTRUED BY THE OWNER, ENGINEER, CONTRACTOR, OR SUBCONTRACTORS TO BE AN ACCURATE AND COMPLETE REPRESENTATION OF UTILITIES THAT MAY OR MAY NOT EXIST ON THE CONSTRUCTION SITE. BURIED AND ABOVEGROUND UTILITY LOCATION, IDENTIFICATION, AND MARKING ARE THE SOLE RESPONSIBILITY OF THE CONTRACTOR. REROUTING, DISCONNECTION, PROTECTION, ETC. OF ANY UTILITIES MUST BE COORDINATED BETWEEN THE CONTRACTOR, UTILITY COMPANY, AND OWNER. SITE SAFETY, INCLUDING THE AVOIDANCE OF HAZARDS ASSOCIATED WITH BURIED AND ABOVEGROUND UTILITIES, REMAIN THE SOLE RESPONSIBILITY OF THE CONTRACTOR.

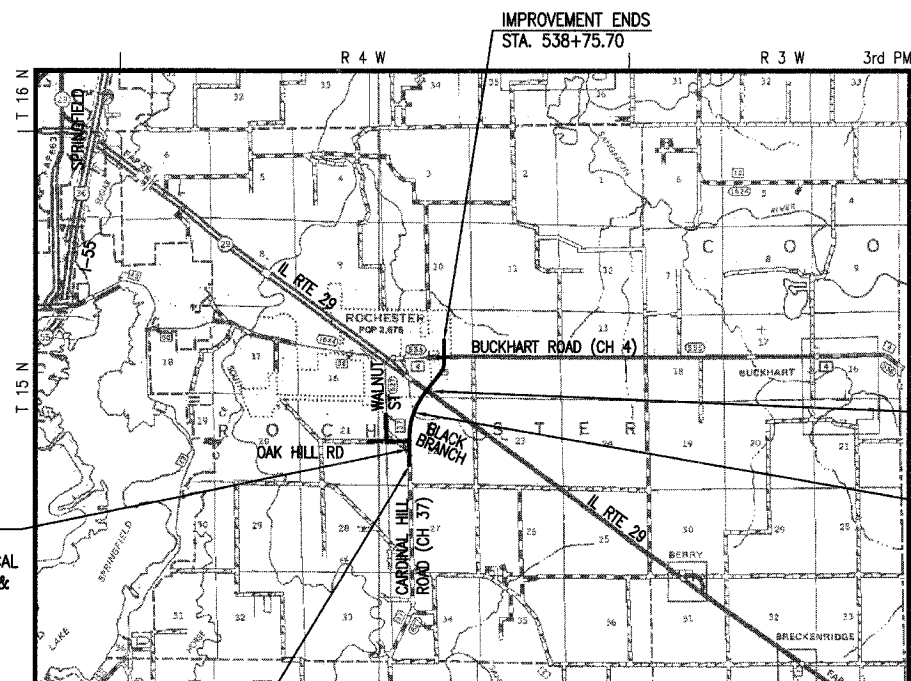

PAVING OMISSION
STA 499+67.05 TO
STA 504+68.00

STA 484+47 SINGLE SPAN
STEEL I-BEAM BRIDGE
PROP. S.N. 084-3640

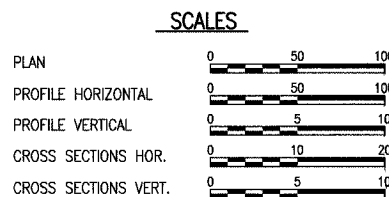

LENGTH OF PROJECT:

CARDINAL HILL ROAD	=	8325.70 ft = 1.577 mi
OAK HILL ROAD	=	1800.00 ft = 0.341 mi
WALNUT STREET	=	1100.00 ft = 0.208 mi
CARDINAL HILL ROAD DEGRADING	=	1925.00 ft = 0.365 mi
BUCKHART ROAD	=	1455.00 ft = 0.276 mi
TOTAL LENGTH OF PROJECT	=	14605.70 ft = 2.766 mi

DESIGN DESIGNATION: ADT = 4110 (26) DHV = 411 MINOR ARTERIAL 0.52(FD-20)
DESIGN SPEED = 60 MPH (STA 455+50 TO STA 494+00 & STA 528+49.64 TO 538+75.70)
= 45 MPH (STA 494+00 TO STA 528+49.64)

CONTRACT NO. 93423



Hanson Professional Services Inc.
1525 South Sixth Street, Springfield, IL 62703
Registration No. 18-001084
Phone: 217-788-2450 Fax: 217-788-2503
© Copyright Hanson Professional Services Inc. 2006

Professional Engineer Seal for Lisa D. Kramer, License No. 002-06160, State of Illinois. Includes signature and date: 11/30/2007.

AGENCY RESPONSIBLE FOR LETTING	
APPROVED	<i>July 31, 2006</i> COUNTY ENGINEER
PASSED	<i>7-27, 2006</i> DISTRICT 6 ENGINEER LOCAL ROADS & STREETS
PASSED	<i>July 27th, 2006</i> DISTRICT 6 ENGINEER OF CONSTRUCTION
RELEASING FOR BID BASED ON LIMITED REVIEW	<i>7-27, 2006</i> <i>Christine M. Reed</i> DEPUTY DIRECTOR OF HIGHWAYS, REGION 4 ENGINEER

STATE OF ILLINOIS
DEPARTMENT OF TRANSPORTATION

LAYOUT: BLR 3/15/04, DESIGNED: BLR 7/22/04, CHECKED: LUK 7/21/04, PLOTTED: VAS/085/0325038R/04W/SHEET/C-001.DWG, JUL 21, 2006 9:31AM, BLR