

F.A.U. RTE.	SECTION	COUNTY	TOTAL SHEETS	SHEET NO.
8075	03-00167-04-FP	SANGAMON	109	18
STA.		TO STA.		
FED. ROAD DIST. NO.	ILLINOIS	FED. AID PROJECT		

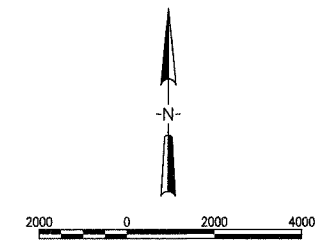
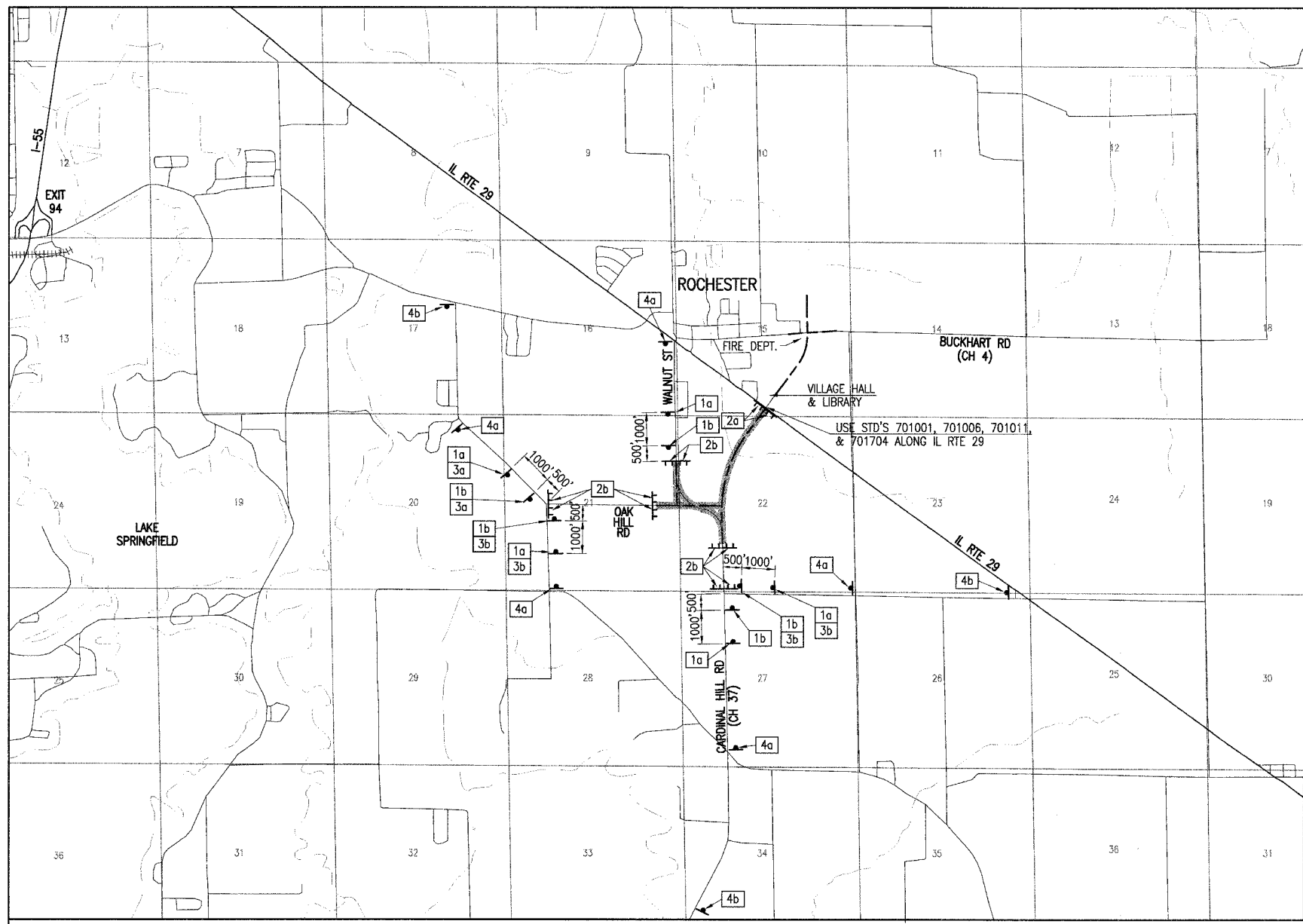

LEGEND

- 1a ROAD CLOSED AHEAD
W20-3 (O) 48x48
- 1b ROAD CLOSED 500 FT
W20-3 (O) 48x48
- 2a ROAD CLOSED
R11-2 48x30
- 2b ROAD CLOSED TO THRU TRAFFIC
R11-4 60x30
- 3a MS-1(L) (O)
21x15
- 3b MS-1(R) (O)
21x15
- 4a ROAD CLOSED 1 MILE AHEAD
LOCAL TRAFFIC ONLY
R11-3 60x30
- 4b ROAD CLOSED 2 MILES AHEAD
LOCAL TRAFFIC ONLY
R11-3 60x30
- SIGN
- TYPE III BARRICADE WITH
2 TYPE A AMBER FLASHING LIGHTS

TRAFFIC CONTROL PLAN SOUTH OF RTE 29

- NOTES:**
- CONTRACTOR SHALL PROVIDE NECESSARY TRAFFIC CONTROL DEVICES AND PRACTICES REQUIRED TO MAINTAIN THE SAFE AND EFFICIENT OPERATION OF TRAFFIC IN AND AROUND THE CONSTRUCTION SITE. FIELD MODIFICATION OF THE TRAFFIC CONTROL SCHEME DEPICTED ON THIS SHEET MAY BE REQUIRED TO FIT ACTUAL CONDITIONS. MODIFICATIONS SHALL ONLY BE MADE IF APPROVED IN WRITING BY THE RESIDENT ENGINEER.
 - ACCESS TO THE ROCHESTER VILLAGE HALL, LIBRARY AND THE FIRE DEPARTMENT SHALL BE MAINTAINED AT ALL TIMES.

LAYOUT B.B. 3/15/04
 DRAWN B.B. 7/22/04
 REVIEWED LDK 7/27/04
 I:\03\0085\03S2035B\CIVIL\SHEET\C-101TRF.DWG JUL 21, 2006 9:42AM B.B.

TRAFFIC CONTROL PLAN
 SEC. 03-00167-04-FP
 CARDINAL HILL ROAD (C.H. 37)
 SANGAMON COUNTY

SHEET 2 OF 2

HANSON
 Hanson Professional Services Inc.
 1525 South Sixth Street, Springfield, IL 62703
 Registration No. 164-001064
 © Copyright Hanson Professional Services Inc. 2006

JOB NO. 03S2035B
 DATE 6/21/06