

Xrefs:
C-RP
C-TP
PLAN-C
TITLE-E
C-ROW

F&M R/C	SECTION	COUNTY	TOTAL SHEETS	SHEET NO
8075	03-00167-04-FP	SANGAMON	109	34
STA. _____ TO STA. _____				
FED. ROAD DIST. NO.	ILLINOIS	FED. AID PROJECT		

ISLAND RADIUS POINTS

LOCATION	STATION	OFFSET	CURB FACE RADIUS
A	499+62.99	46.47' LT	2'
B	499+61.74	29.00' LT	3'
C	499+37.60	28.00' LT	2'
D	499+61.99	29.23' RT	3'
E	499+62.93	52.18' RT	2'
F	499+40.29	28.00' RT	2'
G	499+55.10	41.84' LT	2'
H	499+59.05	29.84' LT	2'
I	499+45.05	31.85' LT	2'
J	499+57.05	43.66' RT	-

DETECTABLE WARNING

NOTE:
ALL DIMENSIONS GIVEN TO EDGE OF PAVEMENT UNLESS OTHERWISE NOTED.
SEE SHEET 21 FOR TREE REMOVAL LOCATIONS.

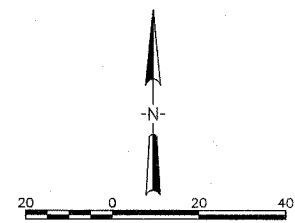

INTERSECTION DETAILS
CARDINAL HILL ROAD & IL RTE 29
SEC. 03-00167-04-FP
CARDINAL HILL ROAD (C.H. 37)
SANGAMON COUNTY

① 6-1/2" LOWER BINDER - 2 LIFTS
2-1/4" TOP LIFT BINDER (POLYMERIZED)
1-1/2" SURFACE LIFT (POLYMERIZED)
[BITUMINOUS PRIME/RC 70 (FOG COAT) REQUIRED BETWEEN SUCCESSIVE LIFTS]
SEE TABLE ON SHEET 5 FOR FULL DEPTH PAVEMENT CONSTRUCTION TABLE



Hanson Professional Services Inc.
1626 South Sixth Street, Springfield, IL 62703
Registration No. 154-00154
© Copyright Hanson Professional Services Inc. 2006

JOB NO.
03S20358
DATE
6/21/06

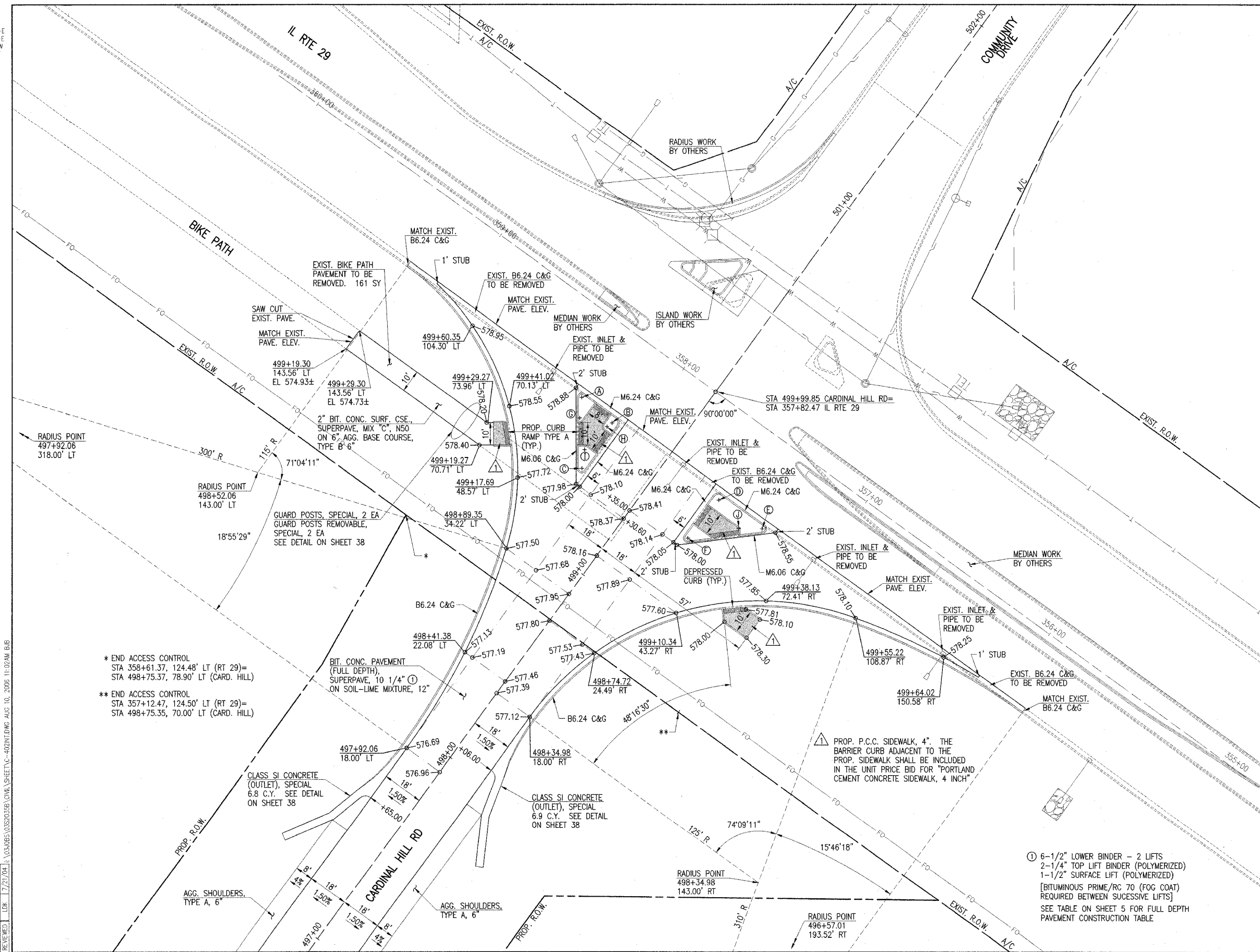

LAYOUT: B.S. 3/15/04
 DRAWN: B.S. 7/22/04
 REVIEWED: L.R. 7/21/04
 L:\ASPH\03S20358\CONV\SHEET\C-402.DWG AUG. 10, 2006 11:02AM B.S.

* END ACCESS CONTROL
STA 358+61.37, 124.48' LT (RT 29)=
STA 498+75.37, 78.90' LT (CARD. HILL)

** END ACCESS CONTROL
STA 357+12.47, 124.50' LT (RT 29)=
STA 498+75.35, 70.00' LT (CARD. HILL)

CLASS SI CONCRETE (OUTLET), SPECIAL 6.8 C.Y. SEE DETAIL ON SHEET 38

CLASS SI CONCRETE (OUTLET), SPECIAL 6.9 C.Y. SEE DETAIL ON SHEET 38

① PROP. P.C.C. SIDEWALK, 4". THE BARRIER CURB ADJACENT TO THE PROP. SIDEWALK SHALL BE INCLUDED IN THE UNIT PRICE BID FOR "PORTLAND CEMENT CONCRETE SIDEWALK, 4 INCH"