

Krefs:
C-TP
PLAN-
TITLE-
C-ROW

FAA R/F	SECTION	COUNTY	TOTAL SHEETS	SHEET NO
8075	03-00167-04-FP	SANGAMON	109	36
STA.		TO STA.		
FED. ROAD DIST. NO.	ILLINOIS	FED. AID PROJECT		

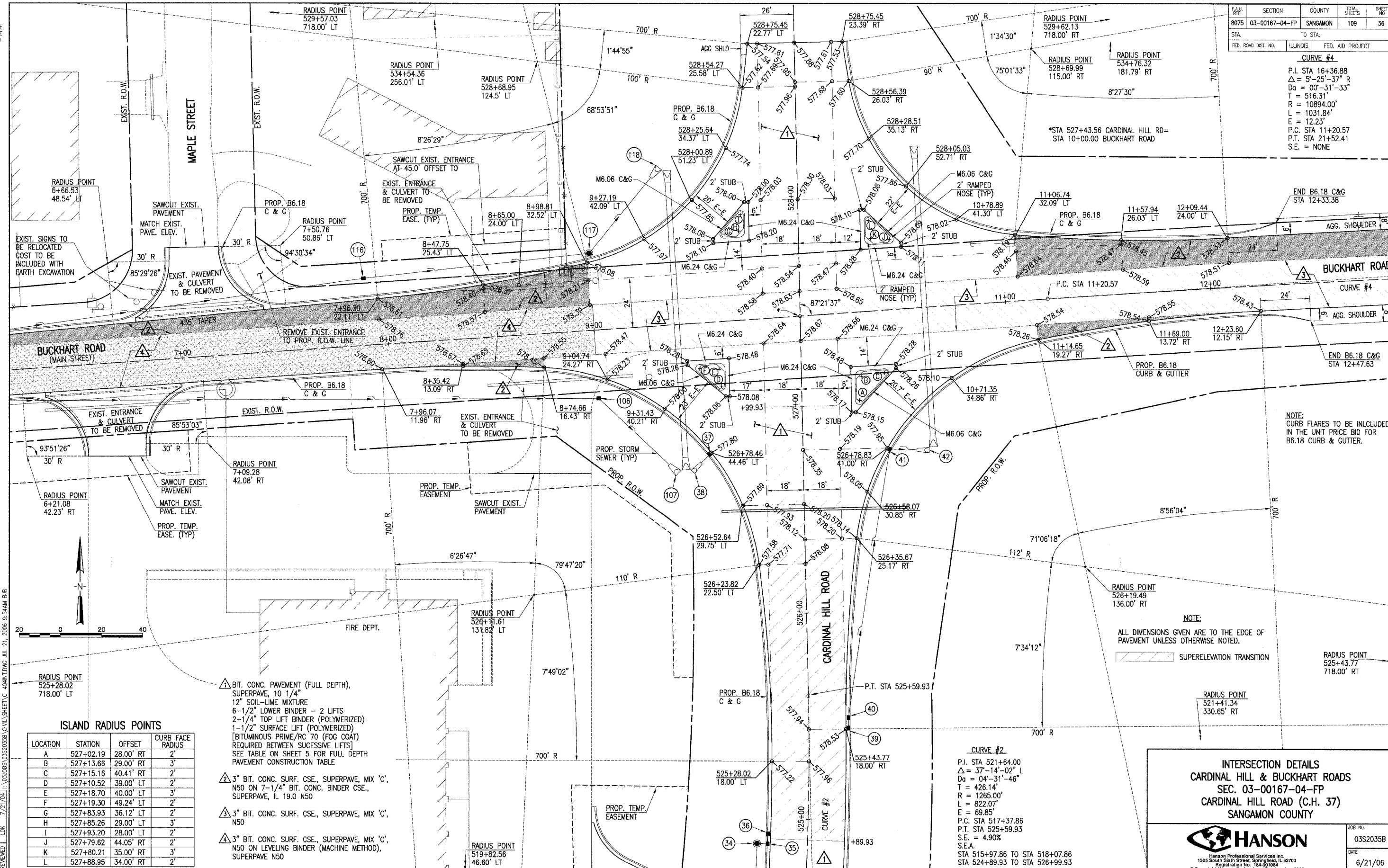

CURVE #4
 P.I. STA 16+36.88
 $\Delta = 5^{\circ}-25'-37''$ R
 $D_a = 0^{\circ}-31'-33''$
 $T = 516.31'$
 $R = 10894.00'$
 $L = 1031.84'$
 $E = 12.23'$
 P.C. STA 11+20.57
 P.T. STA 21+52.41
 S.E. = NONE

NOTE:
CURB FLARES TO BE INCLUDED IN THE UNIT PRICE BID FOR B6.18 CURB & GUTTER.

NOTE:
ALL DIMENSIONS GIVEN ARE TO THE EDGE OF PAVEMENT UNLESS OTHERWISE NOTED.



ISLAND RADIUS POINTS

LOCATION	STATION	OFFSET	CURB FACE RADIUS
A	527+02.19	28.00' RT	2'
B	527+13.66	29.00' RT	3'
C	527+15.16	40.41' RT	2'
D	527+10.52	39.00' LT	2'
E	527+18.70	40.00' LT	3'
F	527+19.30	49.24' LT	2'
G	527+83.93	36.12' LT	2'
H	527+85.26	29.00' LT	3'
I	527+93.20	28.00' LT	2'
J	527+79.62	44.05' RT	2'
K	527+80.21	35.00' RT	3'
L	527+88.95	34.00' RT	2'

- ▲ BIT. CONC. PAVEMENT (FULL DEPTH), SUPERPAVE, 10 1/4" 12" SOIL-LIME MIXTURE 6-1/2" LOWER BINDER - 2 LIFTS 2-1/4" TOP LIFT BINDER (POLYMERIZED) 1-1/2" SURFACE LIFT (POLYMERIZED) [BITUMINOUS PRIME/RC 70 (FOG COAT) REQUIRED BETWEEN SUCCESSIVE LIFTS] SEE TABLE ON SHEET 5 FOR FULL DEPTH PAVEMENT CONSTRUCTION TABLE
- ▲ 3" BIT. CONC. SURF. CSE., SUPERPAVE, MIX 'C', N50 ON 7-1/4" BIT. CONC. BINDER CSE., SUPERPAVE, IL 19.0 N50
- ▲ 3" BIT. CONC. SURF. CSE., SUPERPAVE, MIX 'C', N50
- ▲ 3" BIT. CONC. SURF. CSE., SUPERPAVE, MIX 'C', N50 ON LEVELING BINDER (MACHINE METHOD), SUPERPAVE N50

CURVE #2
 P.I. STA 521+64.00
 $\Delta = 37^{\circ}-14'-02''$ L
 $D_a = 04^{\circ}-31'-46''$
 $T = 426.14'$
 $R = 1265.00'$
 $L = 822.07'$
 $E = 69.85'$
 P.C. STA 517+37.86
 P.T. STA 525+59.93
 S.E. = 4.90%
 S.E.A.
 STA 515+97.86 TO STA 518+07.86
 STA 524+89.93 TO STA 526+99.93

INTERSECTION DETAILS
 CARDINAL HILL & BUCKHART ROADS
 SEC. 03-00167-04-FP
 CARDINAL HILL ROAD (C.H. 37)
 SANGAMON COUNTY



Hanson Professional Services Inc.
 1525 South Sixth Street, Springfield, IL 62703
 Registration No. 184-016084
 © Copyright Hanson Professional Services Inc. 2006

JOB NO.
03S20358
DATE
6/21/06

LAYOUT
DRAWN
REVIEWED
DATE
3/15/04
5/8
7/22/04
7/27/04