

Xrefs:  
 C-RP  
 C-TP  
 PLAN-E  
 TITLE-E  
 C-ROW

FAU. R/E.	SECTION	COUNTY	TOTAL SHEETS	SHEET NO.
B075	03-00167-04-FP	SANGAMON	109	37
STA.		TO STA.		
FED. ROAD DIST. NO.	ILLINOIS	FED. AID PROJECT		

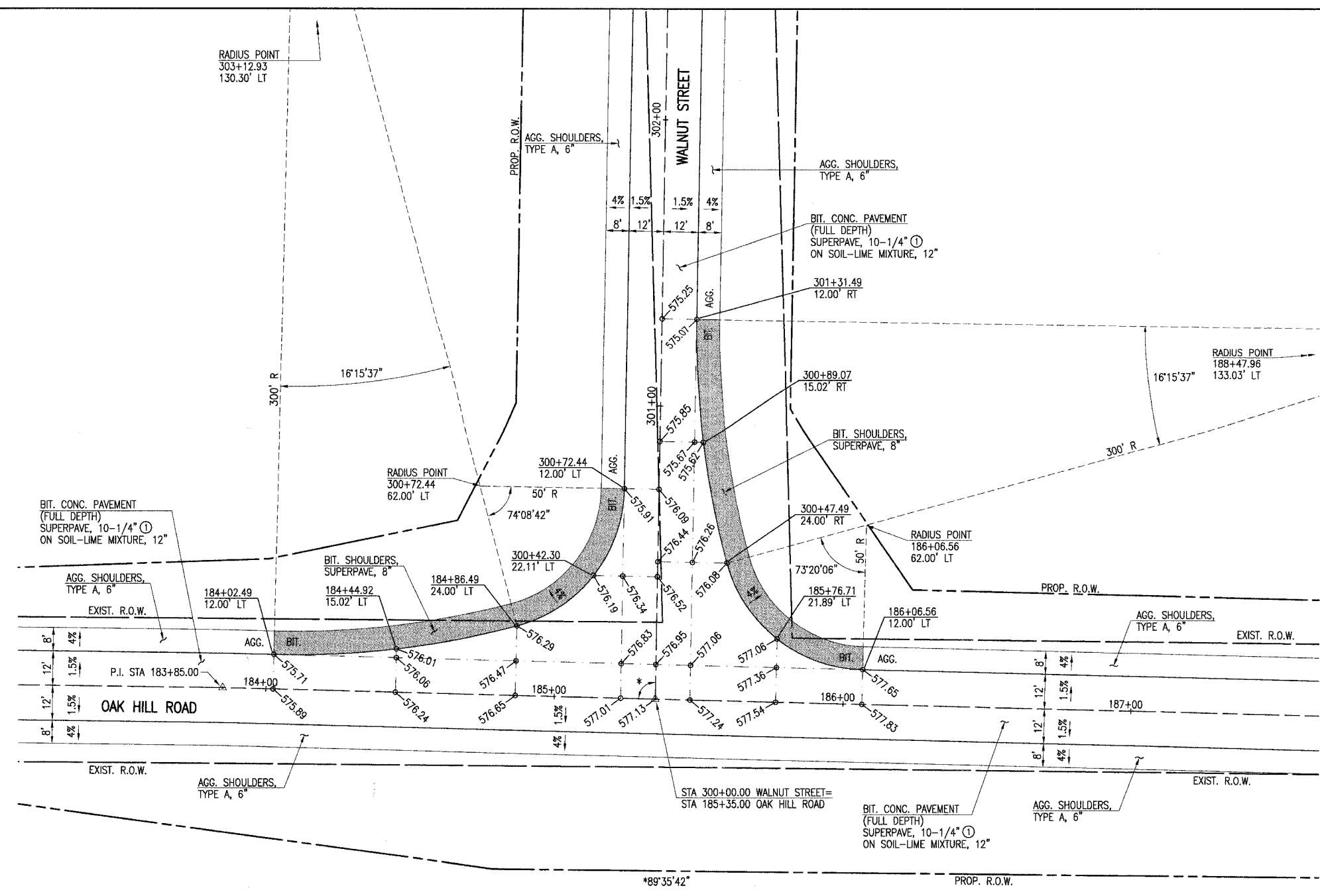

LAYOUT: BJB 3/15/04  
 DRAWN: BJB 7/22/04  
 REVIEWED: LDK 7/27/04  
 03S2035B CIVIL SHEET C-409INT.DWG JUL 21, 2006 9:54AM BJB

NOTE:  
 ALL DIMENSIONS GIVEN TO EDGE OF PAVEMENT UNLESS OTHERWISE NOTED.

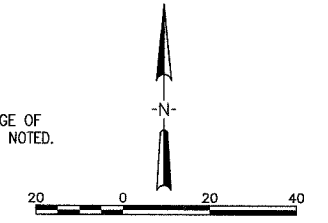

① 6-1/2" LOWER BINDER - 2 LIFTS  
 2-1/4" TOP LIFT BINDER (POLYMERIZED)  
 1-1/2" SURFACE LIFT (POLYMERIZED)  
 [BITUMINOUS PRIME/RC 70 (FOG COAT) REQUIRED BETWEEN SUCCESSIVE LIFTS]  
 SEE TABLE ON SHEET 5 FOR FULL DEPTH PAVEMENT CONSTRUCTION TABLE

INTERSECTION DETAILS  
 OAK HILL ROAD & WALNUT STREET  
 SEC. 03-00167-04-FP  
 CARDINAL HILL ROAD (C.H. 37)  
 SANGAMON COUNTY

Hanson Professional Services Inc.  
 1525 South Sixth Street, Springfield, IL 62703  
 Registration No. 154-001004  
 © Copyright Hanson Professional Services Inc. 2006

JOB NO.  
03S2035B

DATE  
6/21/06