

Xrefs:  
PLAN-E  
TITLE-E  
C-RP

F.A.U. RITE	SECTION	COUNTY	TOTAL SHEETS	SHEET NO
8075	03-00167-04-FP	SANGAMON	109	47
STA.		TO STA.		
FED. ROAD DIST. NO.	ILLINOIS	FED. AID PROJECT		

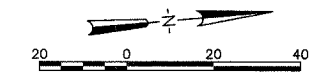
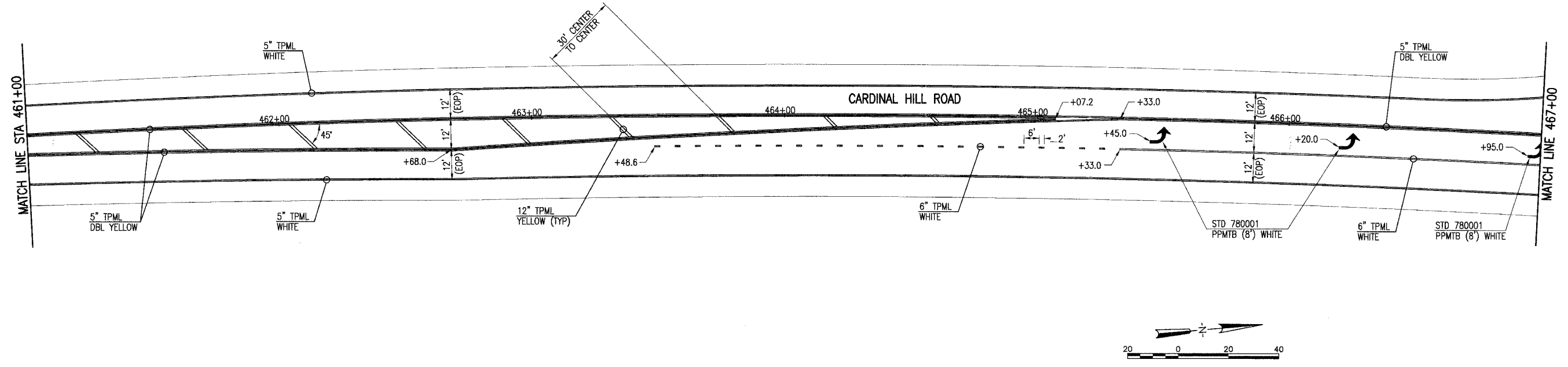
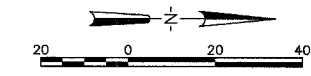
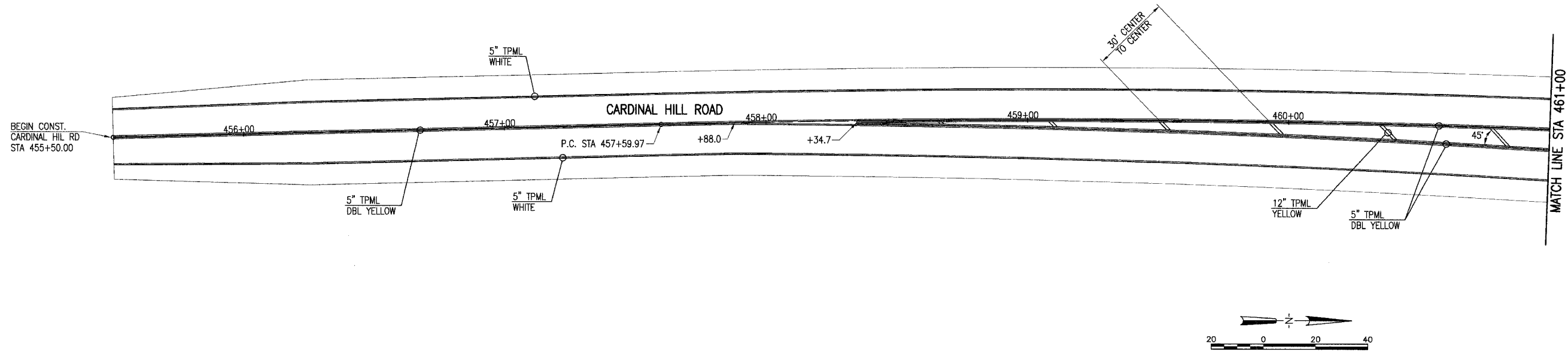

TPML = THERMOPLASTIC PAVEMENT MARKING LINE  
PPMTB = PREFORMED PLASTIC PAVEMENT MARKING, TYPE B

NOTES  
1. DIMENSIONS ARE TO CENTER OF STRIPE(S) UNLESS OTHERWISE NOTED.

**PAVEMENT MARKING**  
SEC. 03-00167-04-FP  
CARDINAL HILL ROAD (C.H. 37)  
SANGAMON COUNTY

JOB NO.  
03S2035B

DATE  
6/21/06

Hanson Professional Services Inc.  
1525 South Sixth Street, Springfield, IL 62703  
Registration No. 154-061064  
© Copyright Hanson Professional Services Inc. 2006

LAYOUT: BUB 3/15/04  
 DRAWN: BUB 7/22/04  
 CHECKED: LUK 7/21/04  
 J:\03\085\03S2035B\Civil\Sheet\03S2035B-102MKT.DWG JUL 21, 2006 10:03AM BUB