

Xrefs:
PLAN-E
TITLE-E
C-RP
C-TP

FAA/RFC	SECTION	COUNTY	TOTAL SHEETS	SHEET NO
8075	03-00167-04-FP	SANGAMON	109	55
STA.		TO STA.		
FED. ROAD DIST. NO.	ILLINOIS	FED. AID PROJECT		

STA 300+00.00 WALNUT STREET=
STA 185+35.00 OAK HILL ROAD

NOTE: SEE "NO-PASSING ZONE STRIPING" DETAIL ON SHEET 46 FOR STRIPING ALONG OAK HILL ROAD & WALNUT STREET.

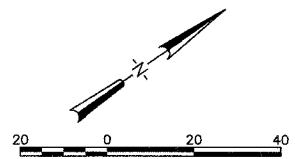
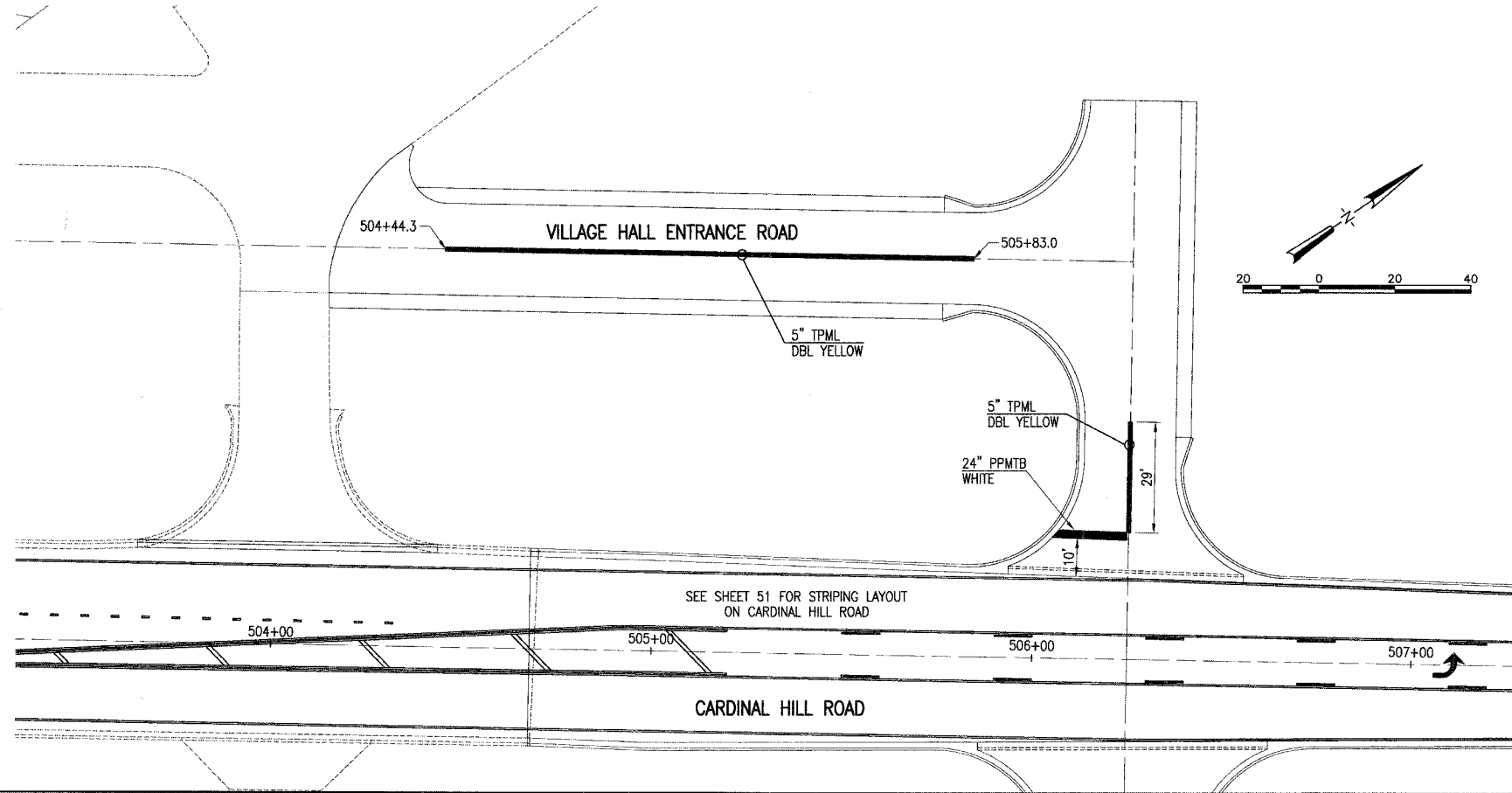
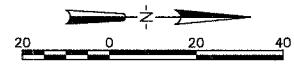
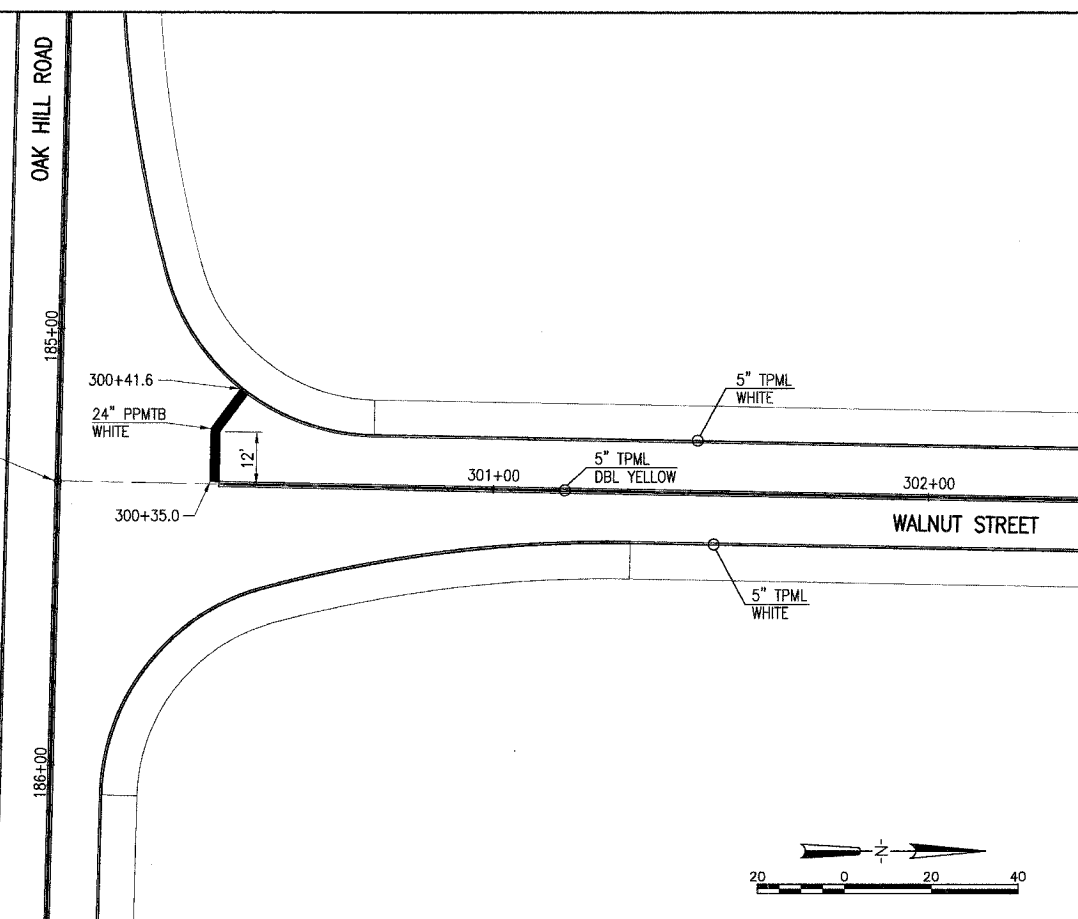

- NOTES**
- DIMENSIONS ARE TO CENTER OF STRIPE(S) UNLESS OTHERWISE NOTED.
- TPML = THERMOPLASTIC PAVEMENT MARKING LINE
PPMTB = PREFORMED PLASTIC PAVEMENT MARKING, TYPE B

SEE SHEET 51 FOR STRIPING LAYOUT ON CARDINAL HILL ROAD

LAYOUT BJB 3/15/04
 DRAWN BJB 7/22/04
 REVIEWED LDK 7/21/04
 I:\034095\03S2035B\CIVIL\SHET\C-110MARK.DWG, JUL 21, 2006 10:08AM BJB

PAVEMENT MARKING
SEC. 03-00167-04-FP
CARDINAL HILL ROAD (C.H. 37)
SANGAMON COUNTY



JOB NO.
03S2035B
DATE
6/21/06