

F.A.I. RTE.	SECTION	COUNTY	TOTAL SHEETS	SHEET NO.
57	*	WILLIAMSON	55	1

\* [X1-(4,4-1,5,6,6-2)] R-1

STATE OF ILLINOIS  
DEPARTMENT OF TRANSPORTATION  
DIVISION OF HIGHWAYS

**PROPOSED  
INTERSTATE HIGHWAY PLANS**

F.A.I. ROUTE 57 (I-57)  
SECTION [X1-(4,4-1,5,6,6-2)] R-1  
PROJECT NO. IM-057-2(145)062  
WILLIAMSON COUNTY  
C-99-040-06

FOR INDEX OF SHEETS, SEE SHEET NO. 2  
FOR SUMMARY OF QUANTITIES, SEE SHEET NO. 4 - 5

STATION EQUATIONS

STA EQ 289+26.45 @ BK = STA 0+00.00 @ AH  
STA EQ 57+43.55 @ BK = STA 57+46.55 @ AH  
STA EQ 157+95.58 @ BK = STA 157+96.05 @ AH  
STA EQ 347+00.75 @ BK = STA 348+43.15 @ AH  
STA EQ 419+74.18 @ BK = STA 1461+00 @ AH

TRAFFIC DATA

I-57 TRAFFIC DATA  
(NORTHBOUND LANES ONLY)  
2004 ADT = 16,850 WITH 33% TRUCKS  
2007 ADT = 17,880 WITH 33% TRUCKS  
2017 ADT = 21,800 WITH 33% TRUCKS

TOWNSHIPS

HERRIN  
WEST MARION

STATION	MILE POST
0+00	62
JOHNSTON CITY INTERCHANGE	59
1461+00	54
1465+00	54
MARION INTERCHANGE	54 A&B

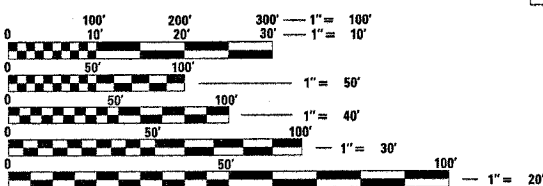
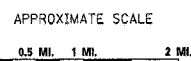

FULL SIZE PLANS HAVE BEEN PREPARED USING STANDARD ENGINEERING SCALES. REDUCED SIZED PLANS WILL NOT CONFORM TO STANDARD SCALES. IN MAKING MEASUREMENTS ON REDUCED PLANS, THE ABOVE SCALES MAY BE USED.

J.U.L.I.E.  
JOINT UTILITY LOCATION INFORMATION FOR EXCAVATION  
1-800-892-0123 or www.julietcall.com

CONTRACT NO. 98948

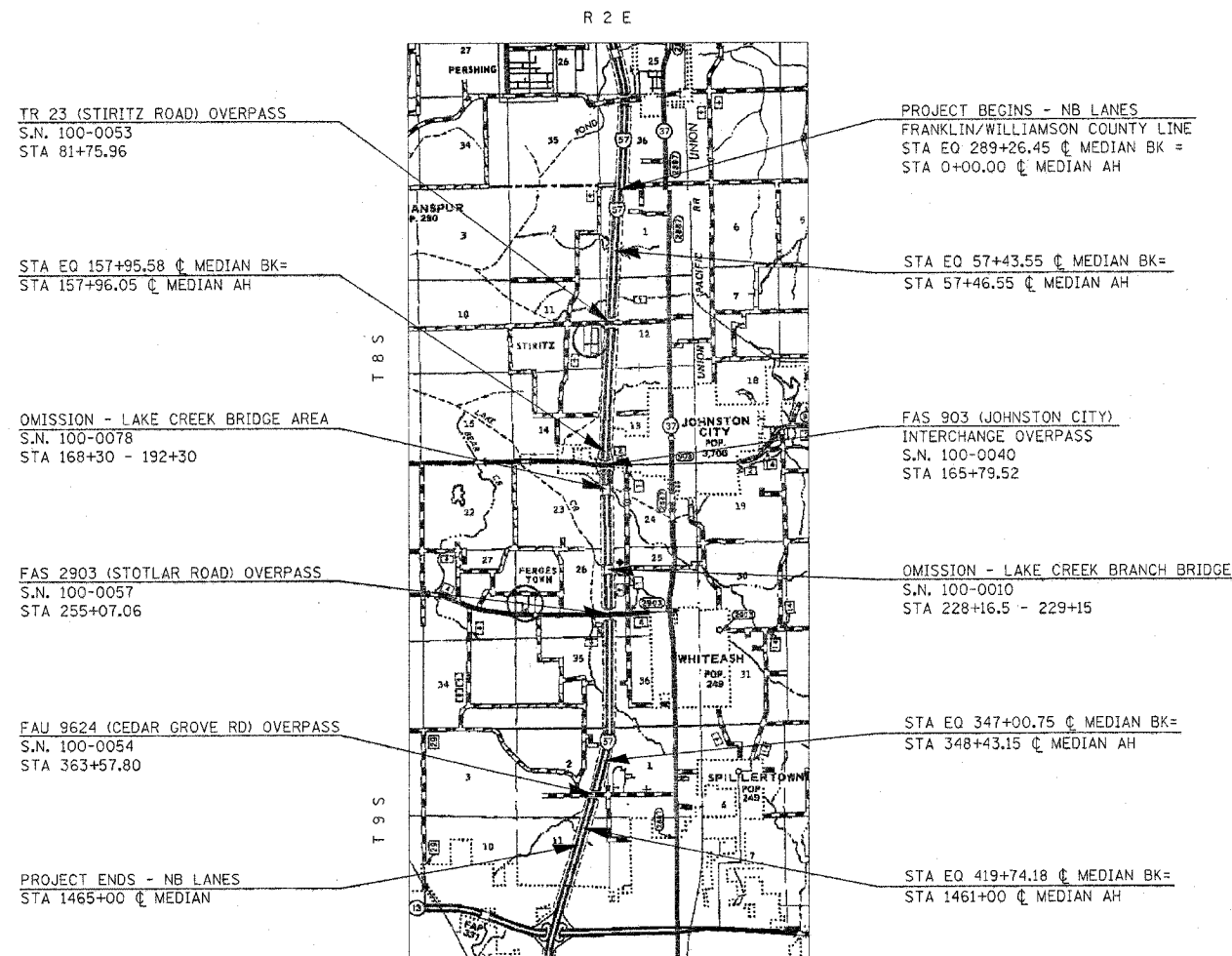
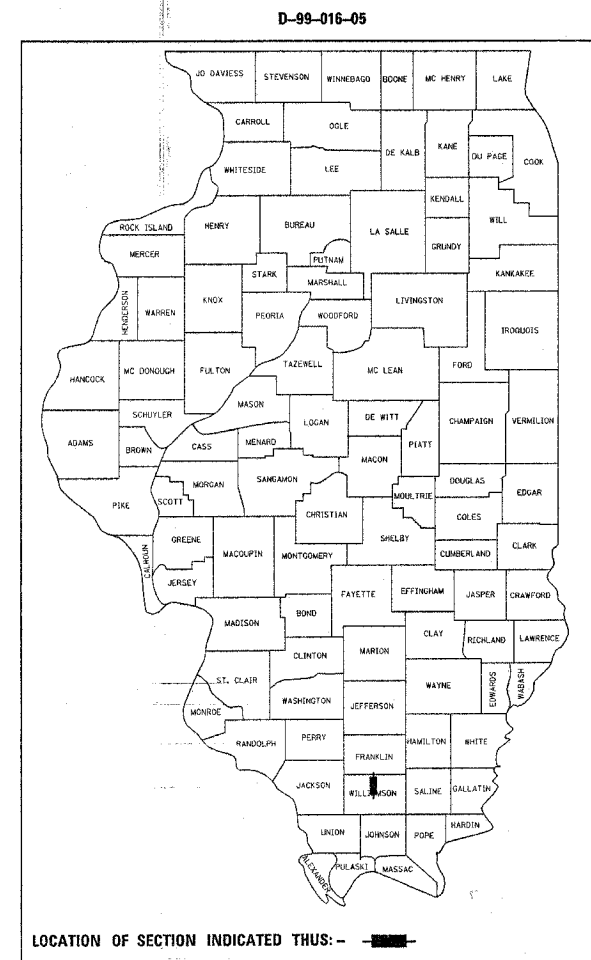

GROSS LENGTH OF PROJECT = 42,588.31 FT = 8.066 MILES (NB)  
NET LENGTH OF PROJECT = 39,619.81 FT = 7.504 MILES (NB)

STATE OF ILLINOIS  
DEPARTMENT OF TRANSPORTATION  
DIVISION OF HIGHWAYS

SUBMITTED Aug 21 2006  
Mar C. Harris  
DEPUTY DIRECTOR OF HIGHWAYS, REGION ENGINEER

20 \_\_\_\_\_  
ENGINEER OF DESIGN AND ENVIRONMENT

20 \_\_\_\_\_  
DIRECTOR OF HIGHWAYS, CHIEF ENGINEER

PRINTED BY THE AUTHORITY  
OF THE STATE OF ILLINOIS

PROJECT ENGINEER: CHARLES STEIN  
SQUAD LEADER: CYNTHIA DETERING