

F.A.I. RTE.	SECTION	COUNTY	TOTAL SHEETS	SHEET NO.
57	*	WILLIAMSON	55	40
STA. _____ TO STA. _____		FED. ROAD DIST. NO. - ILLINOIS FED. AID PROJECT		

* EX1-(4,4-1,5,6,6-2) R-1

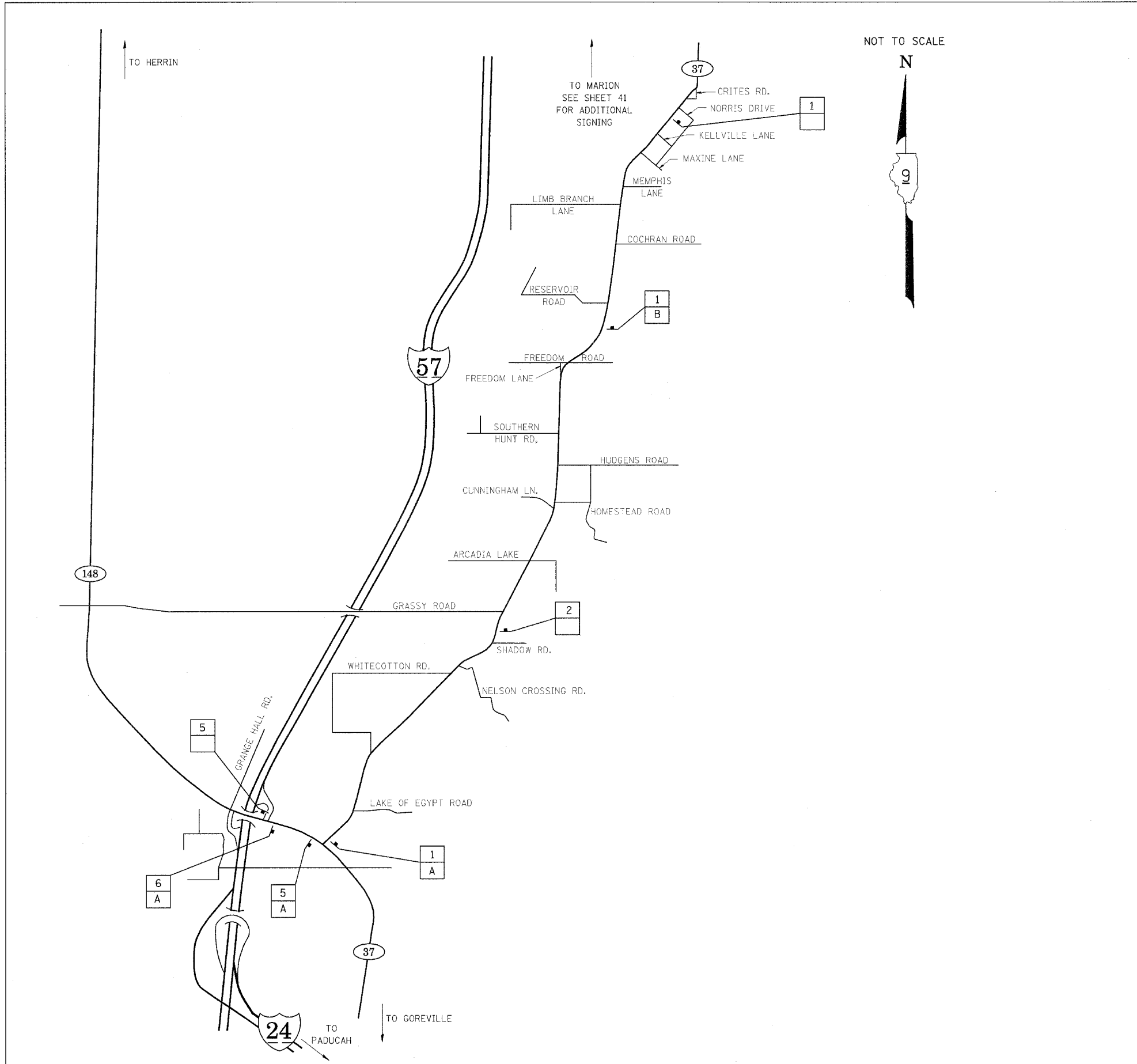

PROPOSED SIGN KEY

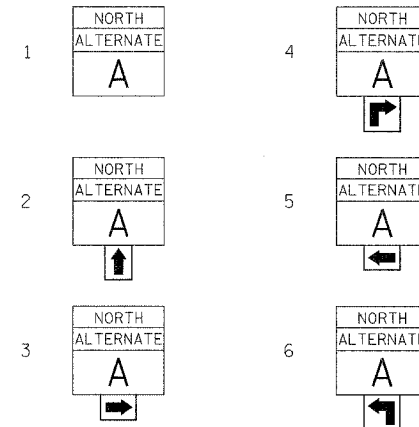

3 — PROPOSED SIGN
A — EXISTING SIGN

PLACE PROPOSED SIGN WITHIN 200' OF THE EXISTING SIGN IN RURAL AREAS. FOR PROPOSED SIGNS IN CITY LIMITS, THE SIGNS SHALL BE PLACED SO THEY DO NOT INTERFERE WITH EXISTING SIGNS AND AS DIRECTED BY THE ENGINEER. SIGNS SHALL NOT BE PLACED ON EXISTING POSTS WITH EXISTING SIGNS.

EXISTING SIGN KEY

- A STATE ROUTE SIGN
- B MILEAGE SIGN
- C SPEED LIMIT SIGN
- D DIRECTIONAL STATE ROUTE SIGN
- E CROSS ROAD SIGN
- F I-57 DIRECTIONAL SIGN
- G NO PARKING SIGN
- H SOUTHERN BRANCH - LINCOLN HERITAGE TRAIL SIGN

NOTES:

1. THE CONTRACTOR HAS THE OPTION OF USING METAL POSTS INSTEAD OF WOOD.
2. ALL SIGNS SHALL BE BLACK ON ORANGE. THE POSTS SHALL BE PLACED 12 FEET FROM THE EDGE OF PAVEMENT AS DIRECTED BY THE ENGINEER.
3. ALL SIGN HARDWARE REQUIRED TO INSTALL THE ALTERNATE ROUTE SIGNING SHALL BE INCLUDED IN COST OF SIGN PANEL TYPE 1.
4. SIGNS SHALL BE REMOVED ON COMPLETION OF THE CONTRACT AT THE DIRECTION OF THE ENGINEER. THIS WORK SHALL BE COMPLETED ACCORDING TO SECTION 724 OF THE STANDARD SPECIFICATIONS. THIS WORK WILL NOT BE PAID FOR. THE SIGNS AND POSTS SHALL BECOME THE PROPERTY OF THE CONTRACTOR.
5. ALTERNATE A = ILL. RTE. 37
6. THE RELOCATING, MAINTENANCE OR REPLACEMENT OF SIGNS SHALL BE PAID FOR IN ACCORDANCE WITH ARTICLE 109.04.
7. EXACT SIGN PLACEMENT WILL BE DETERMINED BY THE ENGINEER.
8. THE DISTRICT 9 OPERATIONS ENGINEER SHALL BE CONTACTED 10 DAYS PRIOR TO THE ERECTION OF SIGNS.

PLOT DATE = 8/22/2006
 FILE NAME = c:\pwork\98948\98948.dwg
 PLOT SCALE = 1" = 100'
 USER NAME = thomasbf