

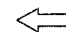

F.A.I. RTE.	SECTION	COUNTY	TOTAL SHEETS	SHEET NO.
57	*	WILLIAMSON	55	48
STA. _____		TO STA. _____		
FED. ROAD DIST. NO. _____		ILLINOIS FED. AID PROJECT		

* [X1-(4,4-1,5,6,6-2)] R-1

DRIVING LANE CONSTRUCTION

LEGEND

-  DRUM WITH STEADY BURN MONODIRECTIONAL LIGHT
-  MAINLINE TRAFFIC FLOW
-  DIRECTION INDICATOR BARRICADE WITH STEADY BURN MONODIRECTIONAL LIGHT
-  TYPE II BARRICADE, DRUM OR VERTICAL BARRICADE WITH STEADY BURNING MONODIRECTIONAL LIGHT

NOTES: THIS LAYOUT SHALL BE USED DURING DRIVING LANE CONSTRUCTION AT THE JOHNSTON CITY OVERPASS.
 TRAFFIC CONTROL STANDARDS 701401 AND 701411 SHALL BE USED DURING THIS STAGE OF CONSTRUCTION
 THE TANGENT SECTION REQUIRED FOR TC STANDARD 701401 SHALL BE EXTENDED THROUGH THE RAMP AREA TO APPROXIMATELY STATION 185+00

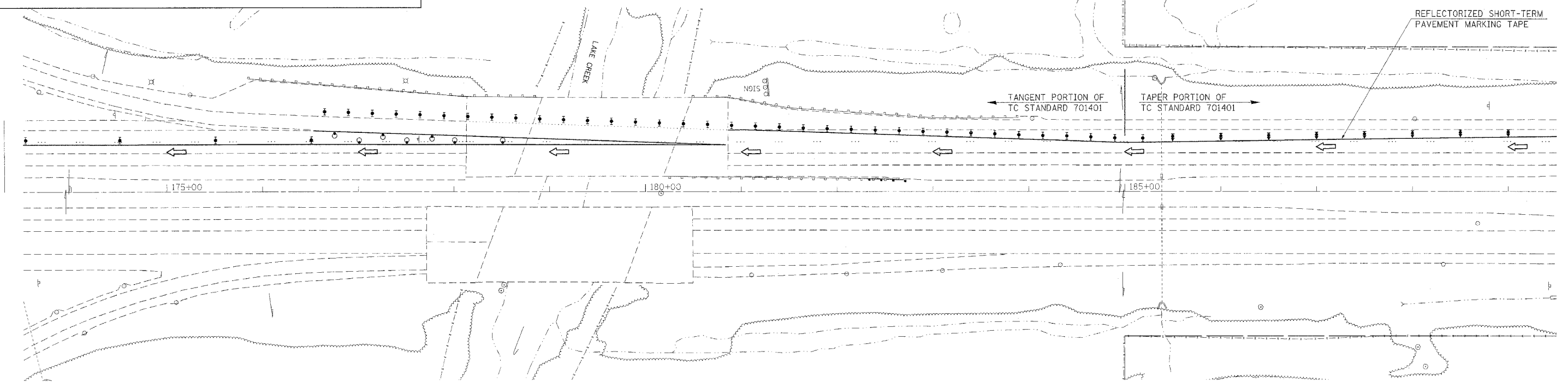
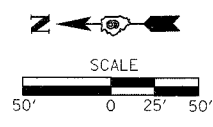

PLOT DATE = 8/18/2006
 FILE NAME = c:\pvc\proj\98948\98948.dwg
 USER NAME = shparrs