

F. A. DIST.	SECTION	COUNTY	TOTAL SHEETS	SHEET NO.
885	*	POPE	16	4
STA. 709+74.60		TO STA. 714+62.27		
FED. ROAD DIST. NO.	ILLINOIS	FED. AID PROJECT		

* - D-9 BSMART FY 07-1

STATE OF ILLINOIS
DEPARTMENT OF TRANSPORTATION

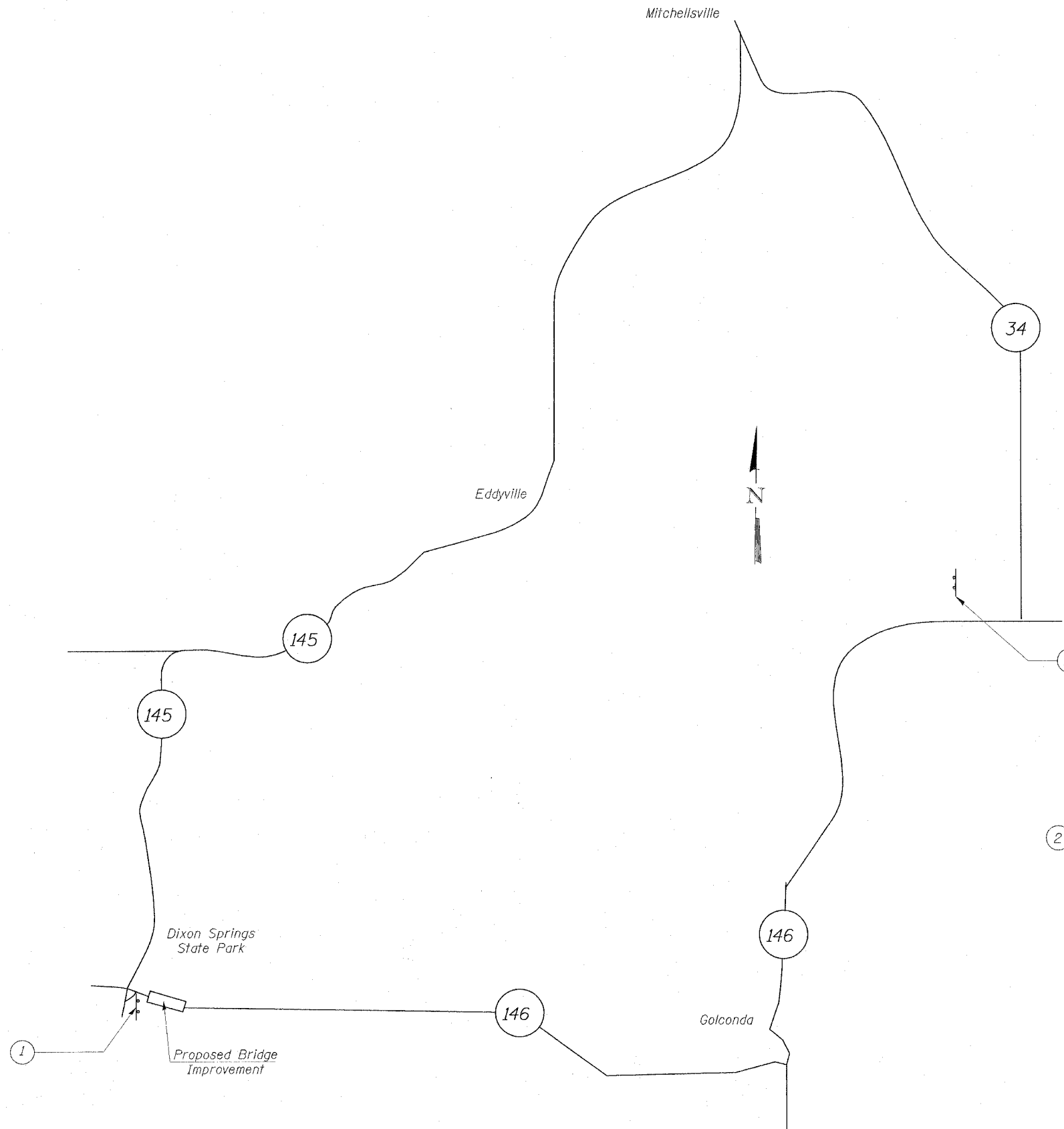

SIGN LEGEND
STAGE I

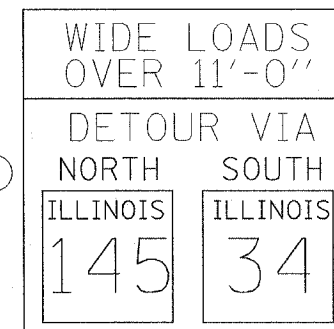

60" x 60"

SIGN LEGEND
STAGE II

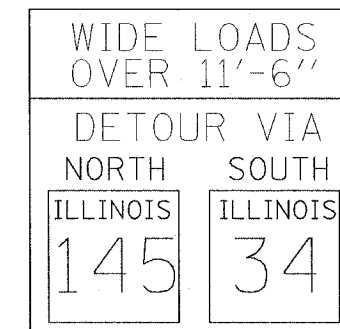

60" x 60"

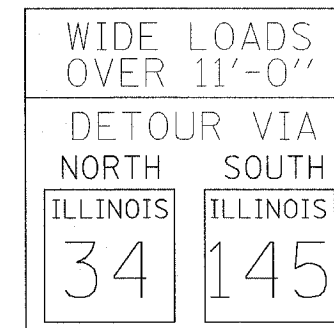

60" x 60"

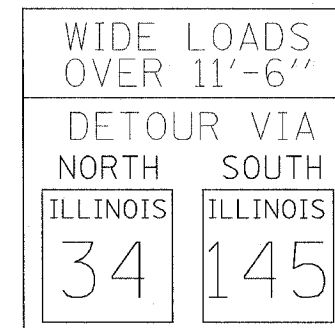

60" x 60"

DETOUR NOTES

1. The Contractor shall furnish the posts and erect the signs at the locations, as directed by the Resident Engr./Tech. All signs shall be post mounted.
2. The above noted work, including signs posts, hardware, and labor shall be included in the contract unit price, each, for Traffic Control and Protection Std. 701321 (Special) and no other compensation will be allowed.
3. The Resident Engineer shall give I.D.O.T. Bureau of Operations, permits section two weeks notice before implementing any lane width restrictions

WIDTH RESTRICTION SIGNING